

UNITED STATES
DEPARTMENT OF THE INTERIOR
BUREAU OF LAND MANAGEMENT

APPLICATION FOR PERMIT TO DRILL, DEEPEN, OR PLUG BACK

1a. TYPE OF WORK
DRILL ☒ DEEPEN ☐ PLUG BACK ☐

b. TYPE OF WELL
OIL WELL ☐ GAS WELL ☒ OTHER ☐
SINGLE ZONE ☒ MULTIPLE ZONE ☐

2. NAME OF OPERATOR
Robert L. Bayless

3. ADDRESS OF OPERATOR
P.O. Box 168, Farmington, NM 87499

4. LOCATION OF WELL (Report location clearly and in accordance with any State requirements.)
At surface 1550' FSL & 890' FEL
At proposed prod. zone Same

14. DISTANCE IN MILES AND DIRECTION FROM NEAREST TOWN OR POST OFFICE

15. DISTANCE FROM PROPOSED* LOCATION TO NEAREST PROPERTY OR LEASE LINE, FT.
(Also to nearest drlg. unit line, if any)

18. DISTANCE FROM PROPOSED LOCATION* TO NEAREST WELL, DRILLING, COMPLETED, OR APPLIED FOR, ON THIS LEASE, FT.

21. ELEVATIONS (Show whether DF, RT, GR, etc.)
6891' G.L.

23. PROPOSED CASING AND CEMENTING PROGRAM

SIZE OF HOLE	SIZE OF CASING	WEIGHT PER FOOT	SETTING DEPTH
9"	7"	23#/ft.	125'
6 1/4"	2-7/8"	6.5#/ft.	2620'

Will drill 9" hole to 125' and set 125' of 7", 23#/ft J-55 used casing with 41 ft³ Class B cement, circulated to surface. Will drill 6 1/4" hole to 2620' and run 2620' of 2-7/8" 6.5#/ft J-55 EUE casing and cement with 218 ft³ Class B cement circulated above the Ojo Alamo. Circulating medium will be clear water, natural mud and water loss control additives. No abnormal pressures or temperatures are anticipated. Will run Induction and Density Logs. Blowout preventer schematic is attached. The gas from this formation is dedicated to a gas contract.

ESTIMATED TOPS: Surface - Clays and Sand
1626' - Ojo Alamo
2241' - Fruitland
2471' - Pictured Cliffs

IN ABOVE SPACE DESCRIBE PROPOSED PROGRAM: If proposal is to deepen or plug back, give data on present productive zone and proposed new productive zone. If proposal is to drill or deepen directionally, give pertinent data on subsurface locations and measured and true vertical depths. Give blowout preventer program, if any.

SIGNED: [Signature] TITLE Operator

(This space for Federal State/County)

PERMIT NO. APPROVAL DATE

APPROVED BY: CONDITIONS OF APPROVAL, IF ANY: TITLE

RECEIVED
FEB 05 1985
OIL CON. DIV.
DIST. 3

NMOCC

*See Instructions On Reverse Side

Title 18 U.S.C. Section 1001, makes it a crime for any person knowingly and willfully to make to any department or agency of the

5. LEASE DESIGNATION AND SERIAL NO.
Contract 362
6. IF INDIAN, ALLOTTEE OR TRIBE NAME
Jicarilla
7. UNIT AGREEMENT NAME
8. FARM OR LEASE NAME
Jicarilla 362 B
9. WELL NO.
#2
10. FIELD AND POOL, OR WILDCAT
Ballard Pictured Cliffs
11. SEC., T., R., M., OR BLK. AND SURVEY OR AREA
I Sec. 7, T23N, R4W
12. COUNTY OR PARISH
Rio Arriba
13. STATE
NM

16. NO. OF ACRES IN LEASE
2560'

17. NO. OF ACRES ASSIGNED TO THIS WELL
160

19. PROPOSED DEPTH
2620'

20. ROTARY OR CABLE TOOLS
Rotary 0-TD

22. APPROX. DATE WORK WILL START*
ASAP

This action is subject to administrative appeal pursuant to 30 CFR 290.

QUANTITY OF CEMENT
41 ft³ Class B, circ. to surface
218 ft³ Class B

APPROVED

12-12-84
AS AMENDED

JAN 30 1985

(SGD.) MAT MILLERBACH

D AREA MANAGER
FARMINGTON RESOURCE AREA

OIL CONSERVATION DIVISION

P. O. BOX 2088

Form C-107
Revised 10-1-78STATE OF NEW MEXICO
ENERGY AND MINERALS DEPARTMENT

SANTA FE, NEW MEXICO 87501

All distances must be from the outer boundaries of the Section.

Operator R. L. BAYLESS		Lease JICARILLA 362		Well No. 2-B
Unit Letter I	Section 7	Township 23N	Range 4W	County Rio Arriba
Actual Footage Location of Well: 1550 feet from the South line and 890 feet from the East line				
Ground Level Elev. 6891	Producing Formation Pictured Cliffs	Pool Ballard Pictured Cliffs		Dedicated Acreage: 160 Acres
<p>1. Outline the acreage dedicated to the subject well by colored pencil or hachure marks on the plat below.</p> <p>2. If more than one lease is dedicated to the well, outline each and identify the ownership thereof (both as to working interest and royalty).</p> <p>3. If more than one lease of different ownership is dedicated to the well, have the interests of all owners been consolidated by communitization, unitization, force-pooling, etc?</p> <p><input type="checkbox"/> Yes <input type="checkbox"/> No If answer is "yes," type of consolidation _____</p> <p>If answer is "no," list the owners and tract descriptions which have actually been consolidated. (Use reverse side of this form if necessary.) _____</p> <p>No allowable will be assigned to the well until all interests have been consolidated (by communitization, unitization, forced-pooling, or otherwise) or until a non-standard unit, eliminating such interests, has been approved by the Commission.</p>				

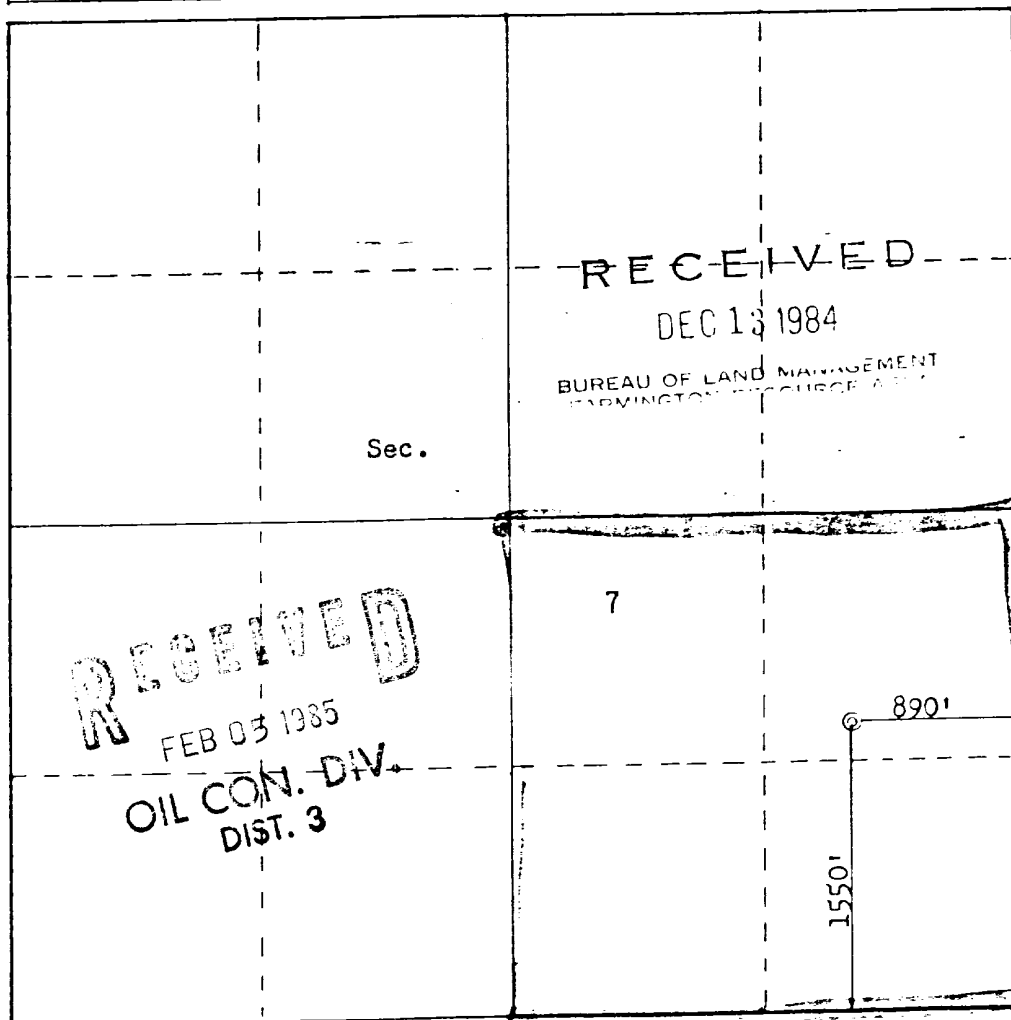

Scale: 1"=1000'

CERTIFICATION

I hereby certify that the information contained herein is true and complete to the best of my knowledge and belief.

Robert L. Bayless

Name
Robert L. BaylessPosition
OperatorCompany
Robert L. BaylessDate
12-12-84

I hereby certify that the well location shown on this plat was plotted from field notes of actual surveys made by me or under my supervision, and that the same is true and correct to the best of my knowledge and belief.

Date Surveyed
November 20, 1984Registered Professional Engineer
and Land Surveyor

Fred B. Kerr Jr.

Certificate No.
3950

