

UNITED STATES
DEPARTMENT OF THE INTERIOR
BUREAU OF LAND MANAGEMENT

APPLICATION FOR PERMIT TO DRILL, DEEPEN, OR PLUG BACK

1a. TYPE OF WORK

DRILL ☒

DEEPEN ☐

PLUG BACK ☐

b. TYPE OF WELL

OIL
WELL ☒

GAS
WELL ☐

OTHER

SINGLE
ZONE ☒

MULTIPLE
ZONE ☐

2. NAME OF OPERATOR

Jack A. Cole

3. ADDRESS OF OPERATOR

P. O. Box 191, Farmington, N.M. 87499

4. LOCATION OF WELL (Report location clearly and in accordance with any State requirements.)

At surface

2090' FSL, 360' FEL

At proposed prod. zone

Same

14. DISTANCE IN MILES AND DIRECTION FROM NEAREST TOWN OR POST OFFICE*

7 miles NW Counselors Trading Post

BUREAU OF LAND MANAGEMENT
FARMINGTON RESOURCE AREA

15. DISTANCE FROM PROPOSED*

LOCATION TO NEAREST
PROPERTY OR LEASE LINE, FT.
(Also to nearest drilg. unit line, if any)

16. NO. OF ACRES IN LEASE

2567.3

18. DISTANCE FROM PROPOSED LOCATION*
TO NEAREST WELL, DRILLING, COMPLETED,
OR APPLIED FOR, ON THIS LEASE, FT.

1080'

19. PROPOSED DEPTH

5800'

17. NO. OF ACRES ASSIGNED
TO THIS WELL

40 37.75

20. ROTARY OR CABLE TOOLS

Rotary

21. ELEVATIONS (Show whether DF, RT, GR, etc.)

6982' GR

DRILLING OPERATIONS AUTHORIZED ARE

22. APPROX. DATE WORK WILL START*

May 1, 1986

23. SUBJECT TO COMPLIANCE WITH ATTACHED AND CEMENTING PROGRAM

This action is subject to technical and
procedural review pursuant to 43 CFR 3165.3
and appeal pursuant to 43 CFR 3165.4.

SIZE OF HOLE	GENERAL REQUIREMENTS SIZE OF CASING	WEIGHT PER FOOT	SETTING DEPTH	QUANTITY OF CEMENT
12 1/4"	8 5/8"	24.0 J-55	250'	250 sks
7 7/8"	4 1/2"	10.50 K-55	5800'	To be determined after logging.

All producing intervals in Gallup formation will be stimulated as necessary.

Exhibits:

- "A" Location and elevation plot
- "B" Ten point compliance program
- "C" Blowout preventor diagram
- "D" Multi-point requirements of APD

- "E" Access road to location
- "F" Drill rig layout
- "G" Fracturing program layout
- "H" Location profile
- "I" Proposed gas line

The gas for this well is committed.

IN ABOVE SPACE DESCRIBE PROPOSED PROGRAM: If proposal is to deepen or plug back, give data on present productive zone and proposed new productive zone. If proposal is to drill or deepen directionally, give pertinent data on subsurface locations and measured and true vertical depths. Give blowout preventer program, if any.

24. SIGNED DeWayne Blissett TITLE Production Superintendent DATE March 19, 1986

(This space for Federal or State office use)

PERMIT NO.

APPROVAL DATE

APPROVED BY TITLE

DATE

CONDITIONS OF APPROVAL, IF ANY:

APPROVED AS AMENDED

NMOCC

*See Instructions On Reverse Side

OIL CONSERVATION DIVISION

STATE OF NEW MEXICO
ENERGY AND MINERALS DEPARTMENTP. O. BOX 2088
SANTA FE, NEW MEXICO 87501Form C-102
Revised 10-1-78

All distances must be from the outer boundaries of the Section.

Operator JACK A. COLE		Lease MARCUS <i>A</i>		Well No. 11 # 10	
Unit Letter I	Section 1	Township 23 NORTH	Range 7 WEST	County RIO ARRIBA	
Actual Footage Location of Wells 2090 feet from the SOUTH line and 360 feet from the EAST line					
Ground Level Elev. 6982	Producing Formation Gallup	Pool Lybrook Gallup <i>EXT</i>		Dedicated Acreage <i>40</i> 37.78 Acres	

1. Outline the acreage dedicated to the subject well by colored pencil or hatchure marks on the plat below.
2. If more than one lease is dedicated to the well, outline each and identify the ownership thereof (both as to working interest and royalty).
3. If more than one lease of different ownership is dedicated to the well, have the interests of all owners been consolidated by communitization, unitization, force-pooling, etc?

☐ Yes ☐ No If answer is "yes," type of consolidation _____

If answer is "no," list the owners and tract descriptions which have actually been consolidated. (Use reverse side of this form if necessary.) _____

No allowable will be assigned to the well until all interests have been consolidated (by communitization, unitization, forced-pooling, or otherwise) or until a non-standard unit, eliminating such interests, has been approved by the Division.

<div>RECEIVED MAR 21 1986 BUREAU OF LAND MANAGEMENT EASTMONTON RESOURCE AREA</div>		<div>RECEIVED MAY 07 1986 OIL CON. DIV. DIST. 3</div>

CERTIFICATION

I hereby certify that the information contained herein is true and complete to the best of my knowledge and belief.

Dewayne Blancett
Name

Dewayne Blancett
Position

Production Superintendent
Company

Cole Production Co.
Date

March 19, 1986

I hereby certify that the location shown on this plat was plotted from field notes of actual surveys made by me or under my supervision, and that the same is true and correct to the best of my knowledge and belief.

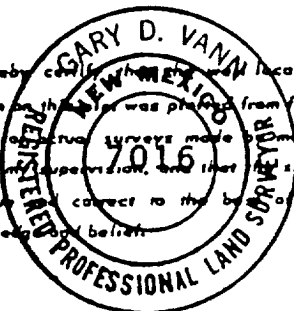

Date Surveyed

January 13, 1986

Registered Professional Engineer
and/or Land Surveyor

Gary D. Vann
Gary D. Vann

Certificate No.

7016

0 330 660 990 1320 1650 1980 2310 2640 2970 3300 3630 3960 4290 4620 4950 5280 5610 5940 6270 6600 6930 7260 7590 7920 8250 8580 8910 9240 9570 9900

[illegible]

JACK A. COLE
MARCUS # 10 A
2090' F/SL 360' F/EL
SEC.1, T23N, R7W, NMPM
RIO ARRIBA COUNTY, NM