

OIL CONSERVATION DIVISION

P. O. BOX 2088

SANTA FE, NEW MEXICO 87501

STATE OF NEW MEXICO

ENERGY AND MINERALS DEPARTMENT

Form C-102
Revised 10-1-78

All distances must be from the outer boundaries of the Section.

Operator Amoco Production Company		Lease Badland Flats Federal		Well No. 1
Well Letter E	Section 3	Township 23N	Range 1W	County Rio Arriba
Actual Footage Location of Well: 2000 feet from the North line and 790 feet from the West line				
Ground Level Elev. 7356	Producing Formation Gallup	Pool West Puerto Chiquito Manco	Dedicated Acreage: 640 643.32 Acres	

1. Outline the acreage dedicated to the subject well by colored pencil or hatchure marks on the plat below.
2. If more than one lease is dedicated to the well, outline each and identify the ownership thereof (both as to working interest and royalty).
3. If more than one lease of different ownership is dedicated to the well, have the interests of all owners been consolidated by communitization, unitization, force-pooling, etc?

☐ Yes ☐ No If answer is "yes," type of consolidation _____

If answer is "no," list the owners and tract descriptions which have actually been consolidated. (Use reverse side of this form if necessary.) _____

No allowable will be assigned to the well until all interests have been consolidated (by communitization, unitization, forced-pooling, or otherwise) or until a non-standard unit, eliminating such interests, has been approved by the Division.

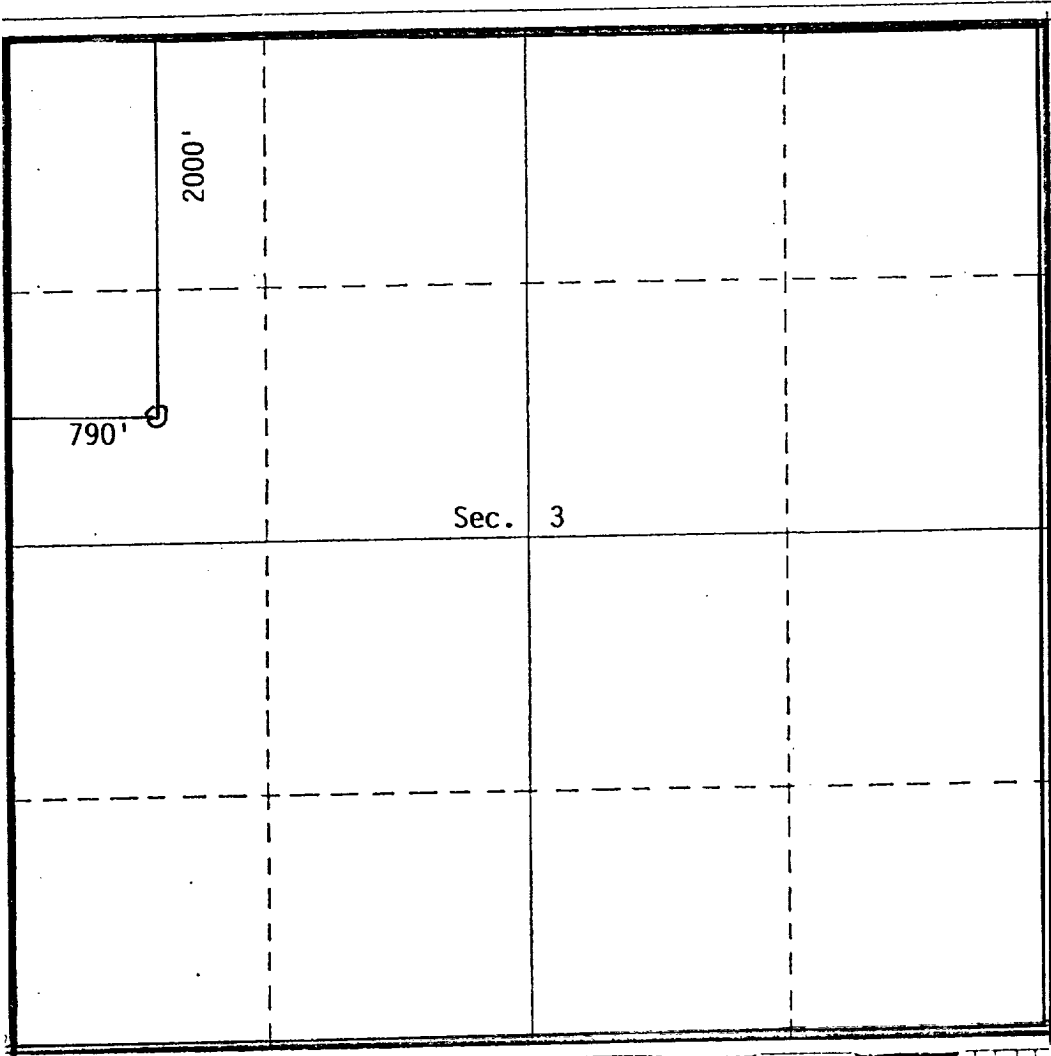

CERTIFICATION

I hereby certify that the information contained herein is true and complete to the best of my knowledge and belief.

Name

Doug W. Whaley

Position

Staff Admin. Supervisor

Company

Amoco Production Co.

Date

9/13/90

I hereby certify that the well location shown on this plat was plotted from field notes of actual surveys made by me or under my supervision, and that the same is true and correct to the best of my knowledge and belief.

On file

Date Surveyed

Registered Professional Engineer
and/or Land Surveyor

Certificate No.