

UNITED STATES
DEPARTMENT OF THE INTERIOR
BUREAU OF LAND MANAGEMENT

APPLICATION FOR PERMIT TO DRILL, DEEPEN, OR PLUG BACK

1a. TYPE OF WORK DRILL <input checked="" type="checkbox"/> DEEPEN <input type="checkbox"/> PLUG BACK <input type="checkbox"/>				5. LEASE DESIGNATION AND SERIAL NO. SF-078359	
b. TYPE OF WELL OIL WELL <input checked="" type="checkbox"/> GAS WELL <input type="checkbox"/> OTHER <input type="checkbox"/>				6. IF INDIAN, ALLOTTEE OR TRIBE NAME	
2. NAME OF OPERATOR Jack A. Cole				7. UNIT AGREEMENT NAME	
3. ADDRESS OF OPERATOR P. O. Box 191, Farmington, New Mexico 87499				8. FARM OR LEASE NAME Rincon <i>MARCUS</i>	
4. LOCATION OF WELL (Report location clearly and in accordance with any State requirements.) At surface <i>36'</i> FNL, 1680' FEL At proposed prod. zone Same				9. WELL NO. 12	
14. DISTANCE IN MILES AND DIRECTION FROM NEAREST TOWN OR POST OFFICE* 3 1/4 miles W. Counselors Trading Post				10. FIELD AND POOL, OR WILDCAT Lybrook Gallup <i>ET</i>	
13. DISTANCE FROM PROPOSED* LOCATION TO NEAREST PROPERTY OR LEASE LINE, FT. (Also to nearest drlg. unit line, if any)		16. NO. OF ACRES IN LEASE 2461.69		17. NO. OF ACRES ASSIGNED TO THIS WELL 40	
18. DISTANCE FROM PROPOSED LOCATION* TO NEAREST WELL, DRILLING, COMPLETED, OR APPLIED FOR, ON THIS LEASE, FT.		19. PROPOSED DEPTH 5640		20. ROTARY OR CABLE TOOLS Rotary	
21. ELEVATIONS (Show whether DF, RT, GR, etc.) 6869 GR				22. APPROX. DATE WORK WILL START* May 1, 1989	
23. PROPOSED CASING AND CEMENTING PROGRAM					
This action is subject to technical and procedural review pursuant to 43 CFR 3165.3 and appeal pursuant to 43 CFR 3165.4.					
SIZE OF HOLE	SIZE OF CASING	WEIGHT PER FOOT	SETTING DEPTH		
12 1/4	8 5/8	24.0 J-55	250	250 sacks	
7 7/8	4 1/2	10.50 K-55	5640	875 sacks	

All producing intervals in Gallup formation will be stimulated as necessary.

EXHIBITS:

- "A" Location and Elevation Plat
- "B" Ten Point Compliance Program
- "C" Blowout Preventor Diagram
- "D" Multi-Point Requirements of APD

- "E" Access Road to Location
- "F" Drill Rig Layout
- "G" Fracturing Program Layout
- "H" Location Profile
- "I" Proposed Pipeline

The gas for this well is committed.

IN ABOVE SPACE DESCRIBE PROPOSED PROGRAM: If proposal is to deepen or plug back, give data on present productive zone and proposed zone. If proposal is to drill or deepen directionally, give pertinent data on subsurface locations and measured and true vertical depths. Give blowout preventer program, if any.

SIGNED *Dwayne Blum* TITLE Production Superintendent DATE February 7, 1989

(This space for Federal or State office use)

PERMIT NO. APPROVAL DATE

APPROVED BY TITLE

CONDITIONS OF APPROVAL, IF ANY:

APPROVED
AS AMENDED

MAY 26 1989
John Kell
AREA MANAGER

*See Instructions On Reverse Side

OIL CONSERVATION DIVISION

STATE OF NEW MEXICO
ENERGY AND MINERALS DEPARTMENTP. O. BOX 2088
SANTA FE, NEW MEXICO 87501Form C-102
Revised 10-1-78

All distances must be from the outer boundaries of the Section.

Operator JACK A. COLE		Lease MARCUS		Well No. 12	
Unit Lett. B	Section 18	Township 23 NORTH	Range 6 WEST	County RIO ARriba	
Actual Footage Location of Well: 965 feet from the NORTH line and 1680 feet from the EAST line					
Ground Level Elev. 8959	Producing Formation GALLUP		Pool LYBROOK EXT	Dedicated Acreage 40 Acres	

1. Outline the acreage dedicated to the subject well by colored pencil or hashure marks on the plat below.
2. If more than one lease is dedicated to the well, outline each and identify the ownership thereof (both as to working interest and royalty).
3. If more than one lease of different ownership is dedicated to the well, have the interests of all owners been consolidated by communitization, unitization, force-pooling, etc?

☐ Yes ☐ No If answer is "yes," type of consolidation _____

If answer is "no," list the owners and tract descriptions which have actually been consolidated. (Use reverse side of this form if necessary.) _____

No allowable will be assigned to the well until all interests have been consolidated (by communitization, unitization, forced-pooling, or otherwise) or until a non-standard unit, eliminating such interests, has been approved by the Division.

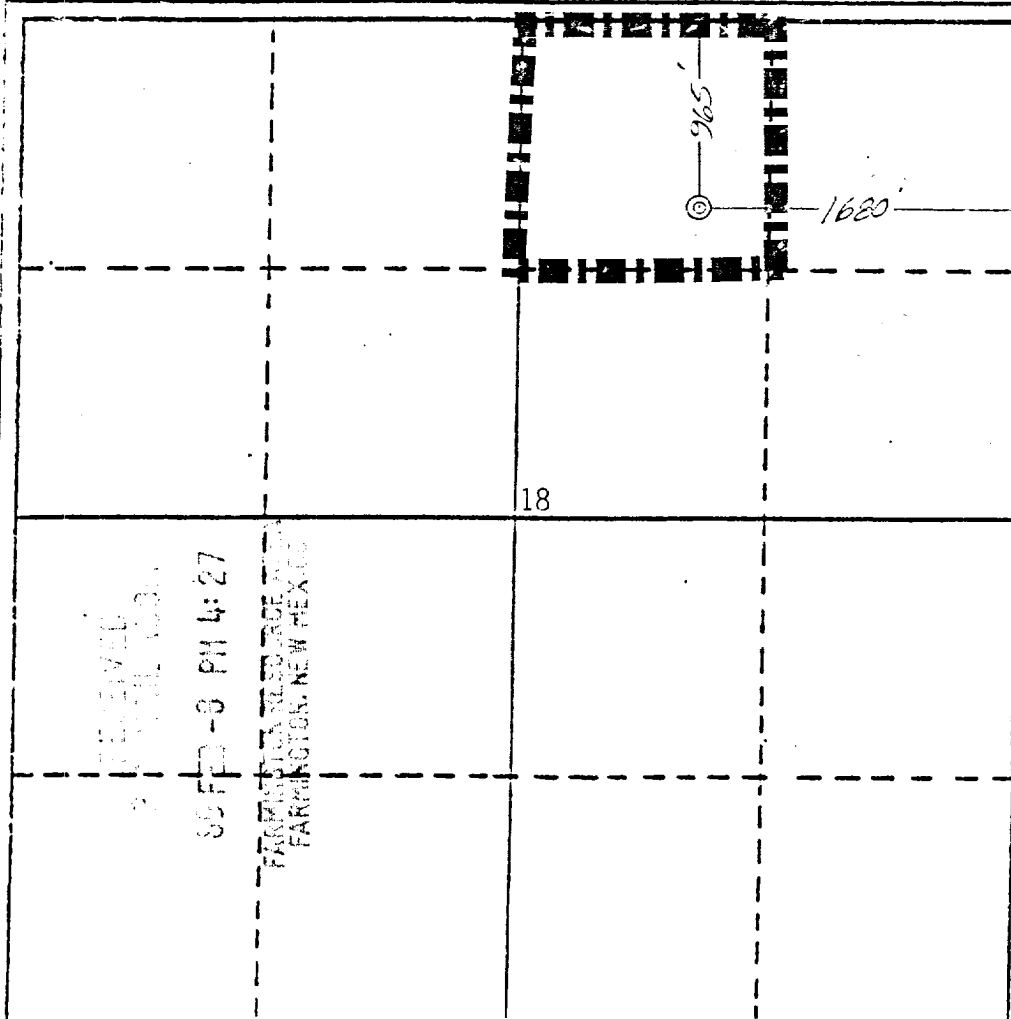

CERTIFICATION

I hereby certify that the information contained herein is true and complete to the best of my knowledge and belief.

Dwayne Blanchett

Name
Dwayne Blanchett

Position
Production Superintendent

Company
Cole Production Co.

Date
February 7, 1989

I hereby certify that the location shown on this plat was plotted from field notes of actual surveys made by me or under my supervision, and that same is true and correct to the best of my knowledge and belief.

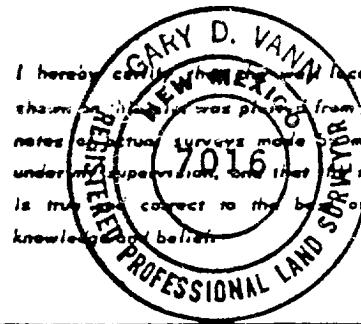

Date Surveyed
January 27, 1986

Registered Professional Engineer
and/or Land Surveyor

Gary D. Vann
Gary D. Vann

Certificate No.
7016

