

Submit to Appropriate
District Office
State Lease - 6 copies
Fee Lease - 5 copies

State of New Mexico
Energy, Minerals and Natural Resources Department

Form C-101
Revised 1-1-89

DISTRICT I
P.O. Box 1980, Hobbs, NM 88240

DISTRICT II
P.O. Drawer DD, Artesia, NM 88210

DISTRICT III
1000 Rio Brazos Rd., Aztec, NM 87410

OIL CONSERVATION DIVISION
P.O. Box 2088
Santa Fe, New Mexico 87504-2088

API NO. (assigned by OCD on New Wells)

5. Indicate Type of Lease

STATE ☒

FEE ☐

6. State Oil & Gas Lease No.
E-1207-1

APPLICATION FOR PERMIT TO DRILL, DEEPEN, OR PLUG BACK

1a. Type of Work:

DRILL ☒

RE-ENTER ☐

DEEPEN ☐

PLUG BACK ☐

b. Type of Well:

OIL
WELL ☒

GAS
WELL ☐

OTHER ☐

SINGLE
ZONE ☐

MULTIPLE
ZONE ☐

7. Lease Name or Unit Agreement Name

STATE 16

8. Well No.

6

9. Pool name or Wildcat

Counselors Gallup Dakota

2. Name of Operator

Bannon Energy, Inc. c/o Holcomb Oil & Gas, Inc.

3. Address of Operator

P.O. Box 2058, Farmington, NM 87499

4. Well Location

Unit Letter

P

: 1302

Feet From The South

Line and

815

Feet From The East

Line

Section 16

Township 23N

Range 6W

NMPM

Rio Arriba

County

10. Proposed Depth

5900'

11. Formation

Gallup

12. Rotary or C.T.

Rotary

13. Elevations (Show whether DF, RT, GR, etc.)

6965.5' GR

14. Kind & Status Plug. Bond

15. Drilling Contractor

16. Approx. Date Work will start

12-15-89

17.

PROPOSED CASING AND CEMENT PROGRAM

SIZE OF HOLE	SIZE OF CASING	WEIGHT PER FOOT	SETTING DEPTH	SACKS OF CEMENT	EST. TOP
12 1/2"	8 5/8"	24.0 lb. J-55	300'	Cement to surface	
7 7/8"	4 1/2"	10.5 lb. K-55	5900'	800 sx-volume to be	
				calculated subsequent to	
				logging.	

Well to be drilled to penetrate the Gallup Formation. All producing intervals in the Gallup will be stimulated as necessary.

EXHIBITS:

"A" Topo map

APPROVAL EXPIRES 5-30-90
UNLESS DRILLING IS COMMENCED.
SPUD NOTICE MUST BE SUBMITTED
WITHIN 10 DAYS.

RECEIVED

NOV 20 1989

OIL CON. DIV
DIST. 3

IN ABOVE SPACE DESCRIBE PROPOSED PROGRAM: IF PROPOSAL IS TO DEEPEN OR PLUG BACK, GIVE DATA ON PRESENT PRODUCTIVE ZONE AND PROPOSED NEW PRODUCTIVE ZONE. GIVE BLOWOUT PREVENTER PROGRAM, IF ANY.

I hereby certify that the information above is true and complete to the best of my knowledge and belief.

SIGNATURE W. J. Holcomb TITLE Agent, Bannon Energy, Inc. DATE 11-20-89

TYPE OR PRINT NAME W. J. Holcomb

TELEPHONE NO. 326-0550

(This space for State Use)

DEPUTY OIL & GAS INSPECTOR, DIST. #3

APPROVED BY [Signature] TITLE [Signature] DATE NOV 30 1989

CONDITIONS OF APPROVAL, IF ANY:

Held c-104 Fee NSL

Submit to Appropriate
District Office
State Lease - 4 copies
Fee Lease - 3 copies

State of New Mexico
Energy, Minerals and Natural Resources Department

Form C-102
Revised 1-1-89

OIL CONSERVATION DIVISION

P.O. Box 2088
Santa Fe, New Mexico 87504-2088

DISTRICT I
P.O. Box 1980, Hobbs, NM 88240

DISTRICT II
P.O. Drawer DD, Artesia, NM 88210

DISTRICT III
1000 Rio Brazos Rd., Aztec, NM 87410

WELL LOCATION AND ACREAGE DEDICATION PLAT

All Distances must be from the outer boundaries of the section

Operator BANNON ENERGY, INC.			Lease STATE 16		Well No. 6
Unit Letter P	Section 16	Township T.23 N.	Range R.6 W.	County RIO ARRIBA	
Actual Footage Location of Well: 1302 feet from the SOUTH line and 815 feet from the EAST line					
Ground level Elev. 6965.6	Producing Formation Gallup		Pool Counselors Dakota	Dedicated Acreage: 160 Acres	

1. Outline the acreage dedicated to the subject well by colored pencil or hatchure marks on the plat below.

2. If more than one lease is dedicated to the well, outline each and identify the ownership thereof (both as to working interest and royalty).

3. If more than one lease of different ownership is dedicated to the well, have the interest of all owners been consolidated by communitization, unitization, force-pooling, etc.?

☐ Yes ☐ No If answer is "yes" type of consolidation

If answer is "no" list the owners and tract descriptions which have actually been consolidated. (Use reverse side of this form if necessary.)

No allowable will be assigned to the well until all interests have been consolidated (by communitization, unitization, forced-pooling, or otherwise) or until a non-standard unit, eliminating such interest, has been approved by the Division.

OPERATOR CERTIFICATION

I hereby certify that the information contained herein is true and complete to the best of my knowledge and belief.

Signature
W. J. Holcomb
Printed Name
W. J. Holcomb
Position
Agent
Company
Bannon Energy, Inc.
Date

SURVEYOR CERTIFICATION

I hereby certify that the well location shown on this plat was plotted from field notes of actual surveys made by me or under my supervision, and that the same is true and correct to the best of my knowledge and belief.

Date Surveyed
NOV 20 1989
Signature and Seal of Professional Surveyor
R. HOWARD DAGGETT
Certificate No.
9878
Registered Professional Land Surveyor

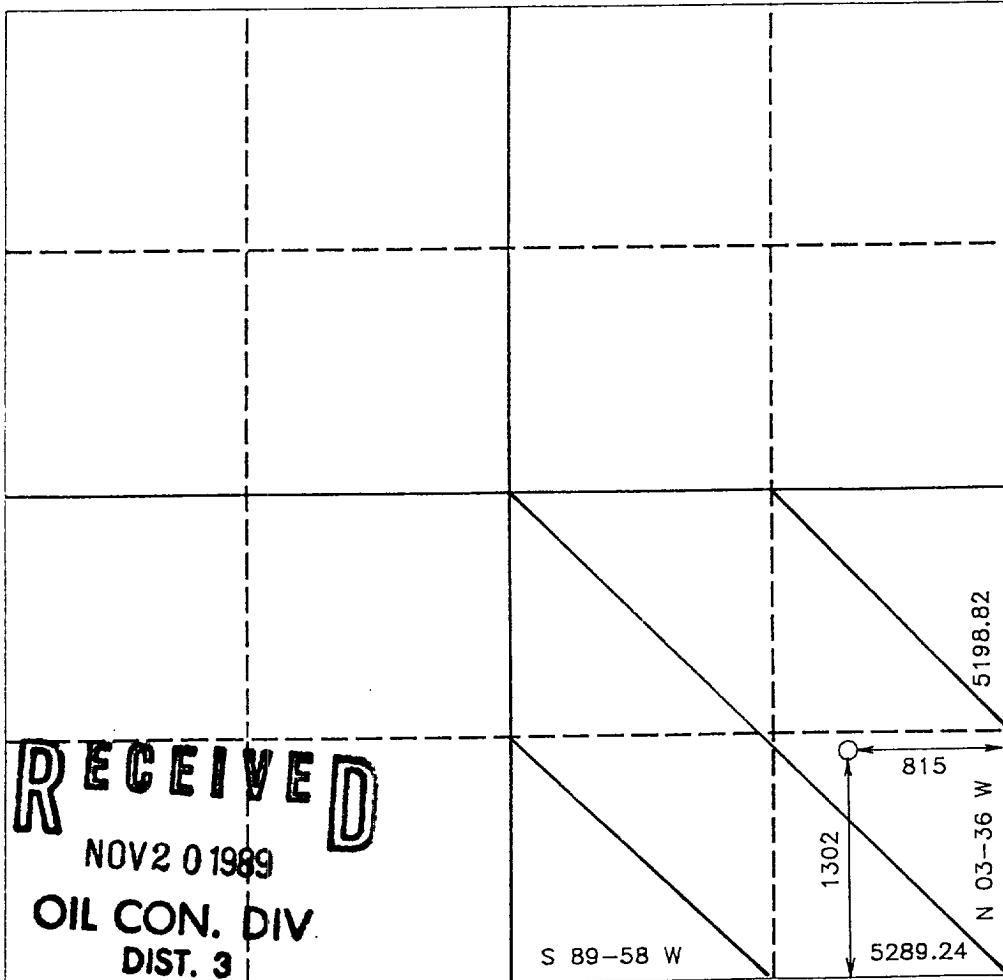

0 330 660 990 1320 1650 1980 2310 2640 2000 1500 1000 500 0

State 16-6
1302' FSL x 815' FEL
Sec. 16 T23N R6W
Rio Arriba Co., NM

2M SYSTEM

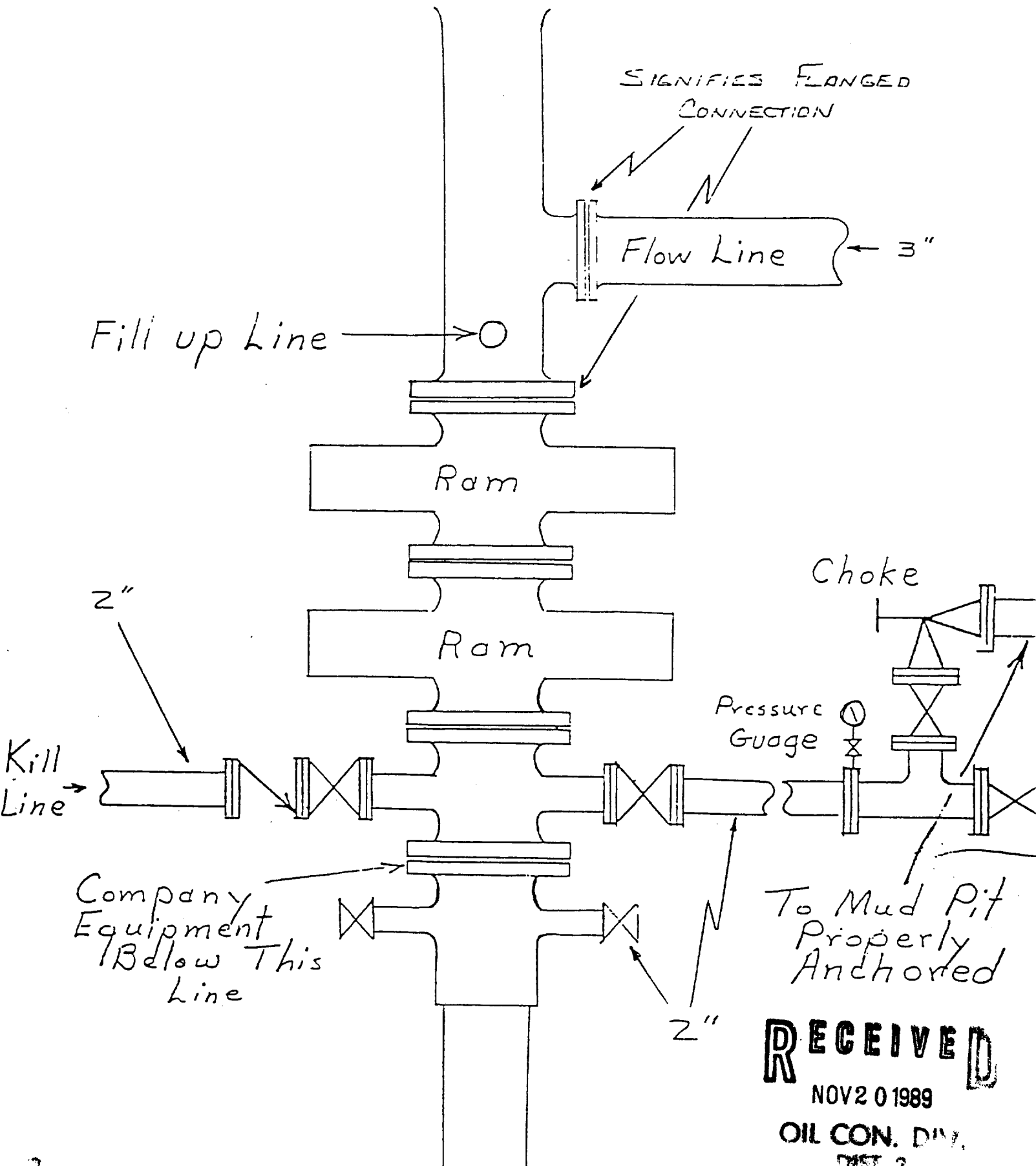

RECEIVED

NOV 20 1989

OIL CON. DIV.
DIST. 2