

UNITED STATES  
DEPARTMENT OF THE INTERIOR  
BUREAU OF LAND MANAGEMENT

APPLICATION FOR PERMIT TO DRILL, DEEPEN, OR PLUG BACK

1a. TYPE OF WORK  
DRILL ☒ DEEPEN ☐ PLUG BACK ☐

b. TYPE OF WELL  
OIL WELL ☒ GAS WELL ☐ OTHER ☐  
SINGLE ZONE ☐ MULTIPLE ZONE ☒

2. NAME OF OPERATOR  
Bannon Energy, Inc. c/o Holcomb Oil & Gas

3. ADDRESS OF OPERATOR  
P.O. Box 2058, Farmington, NM 87499

4. LOCATION OF WELL (Report location clearly and in accordance with any State requirements.)\*  
At surface

Unit 0 805' FSL x 1889' FEL  
At proposed prod. zone

14. DISTANCE IN MILES AND DIRECTION FROM NEAREST TOWN OR POST OFFICE\*

1 1/2 - 3 1/2 miles SE of Lybrook

15. DISTANCE FROM PROPOSED\*  
LOCATION TO NEAREST  
PROPERTY OR LEASE LINE, FT.  
(Also to nearest drig. unit line, if any)

16. NO. OF ACRES IN LEASE

2560

17. NO. OF ACRES ASSIGNED  
TO THIS WELL

40

18. DISTANCE FROM PROPOSED LOCATION\*  
TO NEAREST WELL, DRILLING, COMPLETED,  
OR APPLIED FOR, ON THIS LEASE, FT.

19. PROPOSED DEPTH

5800'

20. ROTARY OR CABLE TOOLS

Rotary

21. SITUATIONS (Show whether DF, ET, GR, etc.)

6961' GR

22. APPROX. DATE WORK WILL START\*

April 1, 1990

PROPOSED CASING AND CEMENTING PROGRAM

SIZE OF HOLE	SIZE OF CASING	WEIGHT PER FOOT	SETTING DEPTH	DRILLING OPERATIONS AUTHORIZED ARE SUBJECT TO COMPLIANCE WITH ATTACHED "GENERAL REQUIREMENTS"
12 1/4"	8 5/8"	24.0 lb. J-55	300'	Cement to surface
7 7/8"	4 1/2"	11.6 Lb. K-55	5800'	800 sx-volume to be calculated subsequent to logging & circulated to surface.

Well to be drilled to penetrate the Gallup formation. All producing intervals  
in the Gallup will be stimulated as necessary.

EXHIBITS:

"A" Location & Elevation Plat  
"B" Ten Point Compliance Program  
"C" Blowout Preventor Diagram  
"D" Multi-point requirements of APD  
"E" Site specific checklist for roads  
(Attachment to "E" - Topo map)

"F" Drill Rig Layout  
"G" Completion Program Layout  
"H" Location Profile

The gas from this lease is  
committed.

RECEIVED  
APR 24 1990  
OIL CON. DIV  
DIST. 3

IN ABOVE SPACE DESCRIBE PROPOSED PROGRAM: If proposal is to deepen or plug back, give data on present productive zone and proposed new productive zone. If proposal is to drill or deepen directionally, give pertinent data on subsurface locations and measured and true vertical depths. Give blowout preventer program, if any.

24. W. J. HOLCOMB

SIGNED *[Signature]*

Agent, Bannon Energy

TITLE

(This space for Federal or State office use)

PERMIT NO.

APPROVAL DATE

APPROVED BY

TITLE

CONDITIONS OF APPROVAL, IF ANY:

NMOCD

APPROVED  
AS AMENDED

APR 20 1990  
AREA MANAGER

Federal 13-4  
805' FSL x 1889' FEL  
Sec. 13 T23N R7W  
Rio Arriba Co., NM

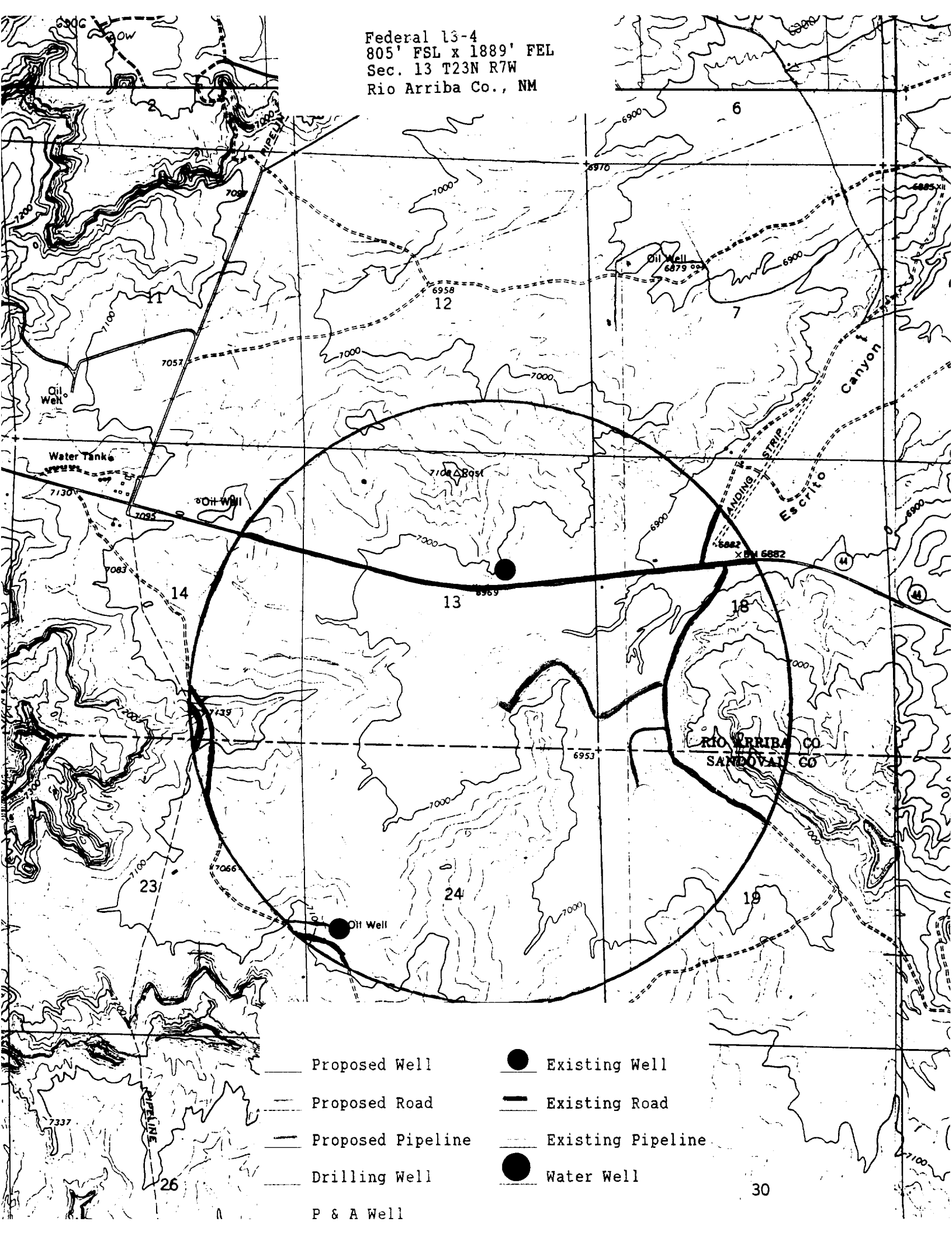

- |                     |                     |
|---------------------|---------------------|
| — Proposed Well     | ● Existing Well     |
| — Proposed Road     | — Existing Road     |
| — Proposed Pipeline | — Existing Pipeline |
| — Drilling Well     | ● Water Well        |
| P & A Well          |                     |

Submit to Appropriate  
District Office  
State Lease - 4 copies  
Fee Lease - 3 copies

State of New Mexico  
Energy, Minerals and Natural Resources Department

Form C-102  
Revised 1-1-89

OIL CONSERVATION DIVISION

P.O. Box 2088  
Santa Fe, New Mexico 87504-2088

DISTRICT I  
P.O. Box 1980, Hobbs, NM 88240

DISTRICT II  
P.O. Drawer DD, Artesia, NM 88210

DISTRICT III  
1000 Rio Brazos Rd., Aztec, NM 87410

WELL LOCATION AND ACREAGE DEDICATION PLAT

All Distances must be from the outer boundaries of the section

Operator <b>BANNON ENERGY, INC.</b>		Lease <b>FEDERAL 13</b>		Well No. <b>4</b>
Unit Letter <b>0</b>	Section <b>13</b>	Township <b>1.23 N.</b>	Range <b>R.7 W.</b>	County <b>RIO ARriba COUNTY</b>
Actual Footage Location of Well: <b>805</b> feet from the <b>SOUTH</b> line and <b>1889</b> feet from the <b>EAST</b> line				
Ground level Elev. <b>6961</b>	Producing Formation <b>GALLUP</b>	Pool <b>LYBROOK GALLUP</b>	Dedicated Acreage: <b>40</b> Acres	

1. Outline the acreage dedicated to the subject well by colored pencil or hachure marks on the plat below.
2. If more than one lease is dedicated to the well, outline each and identify the ownership thereof (both as to working interest and royalty).
3. If more than one lease of different ownership is dedicated to the well, have the interest of all owners been consolidated by communization, unitization, force-pooling, etc.?  
☐ Yes ☐ No If answer is "yes" type of consolidation \_\_\_\_\_  
If answer is "no" list the owners and tract descriptions which have actually been consolidated. (Use reverse side of this form if necessary.)  
No allowable will be assigned to the well until all interests have been consolidated (by communization, unitization, forced-pooling, or otherwise) or until a non-standard unit, eliminating such interest, has been approved by the Division.

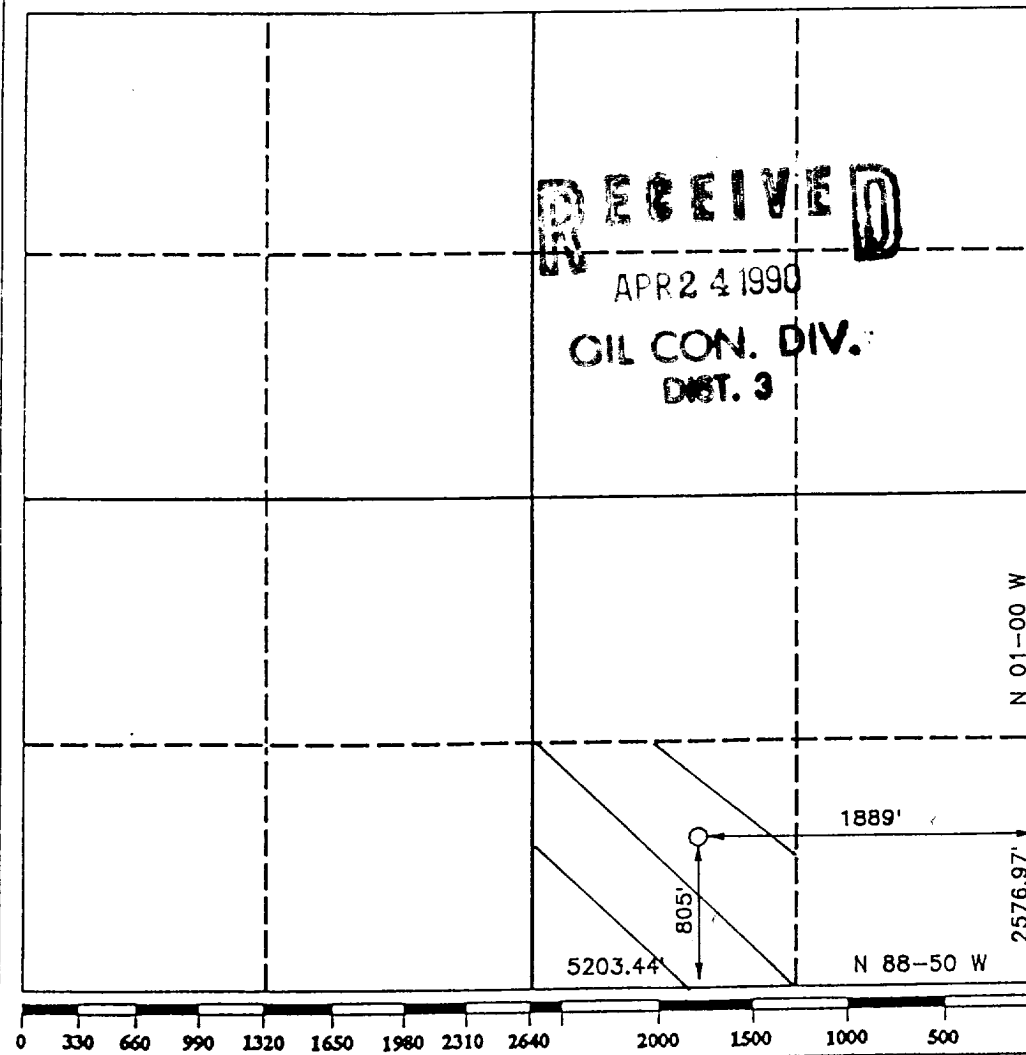

OPERATOR CERTIFICATION

I hereby certify that the information contained herein is true and complete to the best of my knowledge and belief.

Signature  
*W. J. Holcomb*

Printed Name  
**W. J. HOLCOMB**

Position  
**AGENT**

Company  
**BANNON ENERGY, INC.**

Date  
**2-2-90**

SURVEYOR CERTIFICATION

I hereby certify that the well location shown on this plat was plotted from field notes of actual surveys made by me or under my supervision, and that the same is true and correct to the best of my knowledge and belief.

Date Surveyed  
**JANUARY 1990**

Signature & Seal of Professional Surveyor  
*R. Howard Daggett*  
**R. HOWARD DAGGETT**  
0078  
NEW MEXICO  
REGISTERED PROFESSIONAL LAND SURVEYOR

Registered Professional  
Land Surveyor