

(SUBMIT IN TRIPLICATE)

Indian Agency Siouxville

UNITED STATES  
DEPARTMENT OF THE INTERIOR  
GEOLOGICAL SURVEY

Allottee Siouxville Tribal

Lease No. 39

			<input checked="" type="checkbox"/>

### SUNDRY NOTICES AND REPORTS ON WELLS

NOTICE OF INTENTION TO DRILL	<input checked="" type="checkbox"/>	SUBSEQUENT REPORT OF WATER SHUT-OFF	
NOTICE OF INTENTION TO CHANGE PLANS		SUBSEQUENT REPORT OF SHOOTING OR ACIDIZING	
NOTICE OF INTENTION TO TEST WATER SHUT-OFF		SUBSEQUENT REPORT OF ALTERING CASING	
NOTICE OF INTENTION TO REDRILL OR REPAIR WELL		SUBSEQUENT REPORT OF REDRILLING OR REPAIR	
NOTICE OF INTENTION TO SHOOT OR ACIDIZE		SUBSEQUENT REPORT OF ABANDONMENT	
NOTICE OF INTENTION TO PULL OR ALTER CASING		SUPPLEMENTARY WELL HISTORY	
NOTICE OF INTENTION TO ABANDON WELL			

**RECEIVED**  
NOV 18 1959  
U. S. GEOLOGICAL SURVEY  
FARMINGTON, NEW MEXICO

(INDICATE ABOVE BY CHECK MARK NATURE OF REPORT, NOTICE, OR OTHER DATA)

November 16th, 19 59

Well No. C-9 is located 990 ft. from N line and 990 ft. from E line of sec. 3  
NE 1/4 NE 1/4 Sec. 3      23N      5W      N. H. P. M.  
(1/4 Sec. and Sec. No.)      (Twp.)      (Range)      (Meridian)  
Ballard PG      Rio Arriba      New Mexico  
(Field)      (County or Subdivision)      (State or Territory)

The elevation of the derrick floor above sea level is 6707 ft.

#### DETAILS OF WORK

(State names of and expected depths to objective sands; show sizes, weights, and lengths of proposed casings; indicate mudding jobs, cementing points, and all other important proposed work)

**Pictured Cliffs Sand Test. Estimated total depth 2400'.**

**Surface Casing: 90' of 8-5/8" OD 24# J-55 cemented to surface.  
Production " : Approximately 2400' of 5-1/2" OD 14# J-55 cemented with 100 sacks.**

**If commercial production is indicated the producing section will be sand-water fractured.**

**RECEIVED**  
NOV 19 1959  
GEOLOGICAL SURVEY  
FARMINGTON, N.M.

I understand that this plan of work must receive approval in writing by the Geological Survey before operations may be commenced.

Company Arizona Explorations, Inc.

Address 418 Meadows Building  
Dallas 6, Texas

By C. W. Posey Jr  
Title Vice-President



NEW MEXICO OIL CONSERVATION COMMISSION

Well Location and Acreage Dedication Plat

Section A.

Date November 16, 1959

Operator Arizona Explorations, Incorporated Lease Jicarilla  
Well No. 0-9 Unit Letter A Section 3 Township 23 North Range 5 West N.M.P.S.  
Located 990 Feet From North Line, 990 Feet From East Line  
County La Brea G. L. Elevation 6679 Dedicated Acreage 160 Acres  
Name of Producing Formation Pictured Cliffs Pool Ballard

1. Is the Operator the only owner\* in the dedicated acreage outlined on the plat below?  
Yes E No \_\_\_\_\_
2. If the answer to question one is "no," have the interests of all the owners been consolidated by communitization agreement or otherwise? Yes \_\_\_\_\_ No \_\_\_\_\_. If answer is "yes,"  
Type of Consolidation \_\_\_\_\_
3. If the answer to question two is "no," list all the owners and their respective interests below:

<u>Owner</u>	<u>Land Description</u>

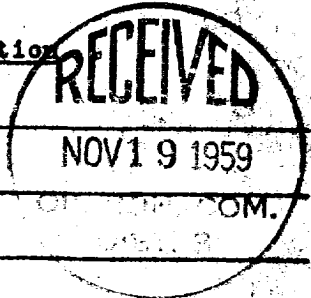

Section B

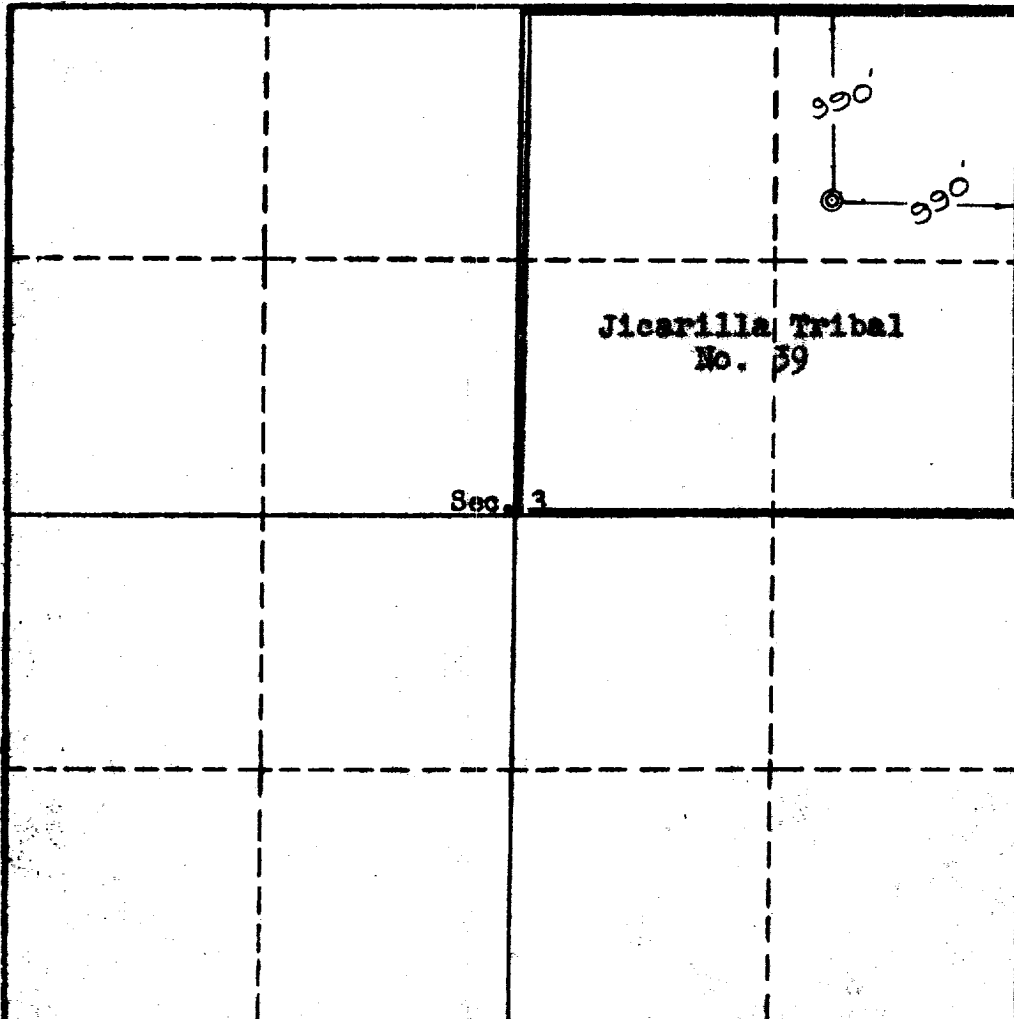

This is to certify that the information in Section A above is true and complete to the best of my knowledge and belief.

Arizona Explorations Inc.  
(Operator)

C.W. Foreyer  
(Representative)

418 Meadows Building  
Address

Dallas 6, Texas

This is to certify that the well location on the plat in Section B was located from field notes and actual surveys made by me or under my supervision and that the same is true to the best of my knowledge and belief.

Date Surveyed Nov. 11, 1959

Ernest V. Echohawk  
Registered Land Surveyor.

Certificate No. 1545

