

NEW MEXICO OIL CONSERVATION COMMISSION
Santa Fe, New Mexico

NOTICE OF INTENTION TO DRILL OR RECOMPLETE

Notice must be given to the District Office of the Oil Conservation Commission and approval obtained before drilling or recompletion begins. If changes in the proposed plan are considered advisable, a copy of this notice showing such changes will be returned to the sender. Submit this notice in **QUINTUPLICATE**. One copy will be returned following approval. See additional instructions in Rules and Regulations of the Commission.

P. O. Box 1860, Midland, Texas

March 28, 1953

(Place)

(Date)

OIL CONSERVATION COMMISSION
SANTA FE, NEW MEXICO

Gentlemen:

ILLEGIBLE

You are hereby notified that it is our intention to commence the (Drilling) (Recompletion) of a well to be known as

P. F. Kelly

(Company or Operator)

State

(Lease)

Well No. **1**

in

(Unit)

The well is

located **660** feet from the **North** line and **1980** feet from the

East

line of Section **32**

T. **18-N**

R. **4-W**

NMPM.

(GIVE LOCATION FROM SECTION LINE)

Wildest

Pool,

Sandoval

County

5-10196

If State Land the Oil and Gas Lease is No. **-**

If patented land the owner is **-**

Address **-**

We propose to drill well with drilling equipment as follows:

Rotary Tools to total depth

The status of plugging bond is

P. F. Kelly - \$5,000.00 - Maryland Casualty Co.

Drilling Contractor

J. P. Gibbins, Midland, Texas.

We intend to complete this well in the

Mesa Verde Sand

1000

formation at an approximate depth of **1000** feet.

CASING PROGRAM

We propose to use the following strings of Casing and to cement them as indicated:

Size of Hole	Size of Casing	Weight per Foot	New or Second Hand	Depth	Sacks Cement
13 3/4"	10 3/4"	32#	New	100	100
10 3/4"	7 5/8"	24#	New	1000	100

If changes in the above plans become advisable we will notify you immediately.

ADDITIONAL INFORMATION (If recompletion give full details of proposed plan of work.)

Approved **31 March**, 19**53**
Except as follows:

Sincerely yours,

P. F. KELLY

(Company or Operator)

By

Position

Send Communications regarding well to

Name

P. F. Kelly

Address

Box 1860

Midland, Texas.

OIL CONSERVATION COMMISSION

By

Title

Company ~~REMOVED OIL COMPANY~~ F. F. KELLY
Lease **F. F. Kelly, State** Well No. **1**
Section **32** Township **15 N.** Range **4 W.** N. M. P. M.
Location **1980** feet from **East** line and **660** feet from
North line of Section

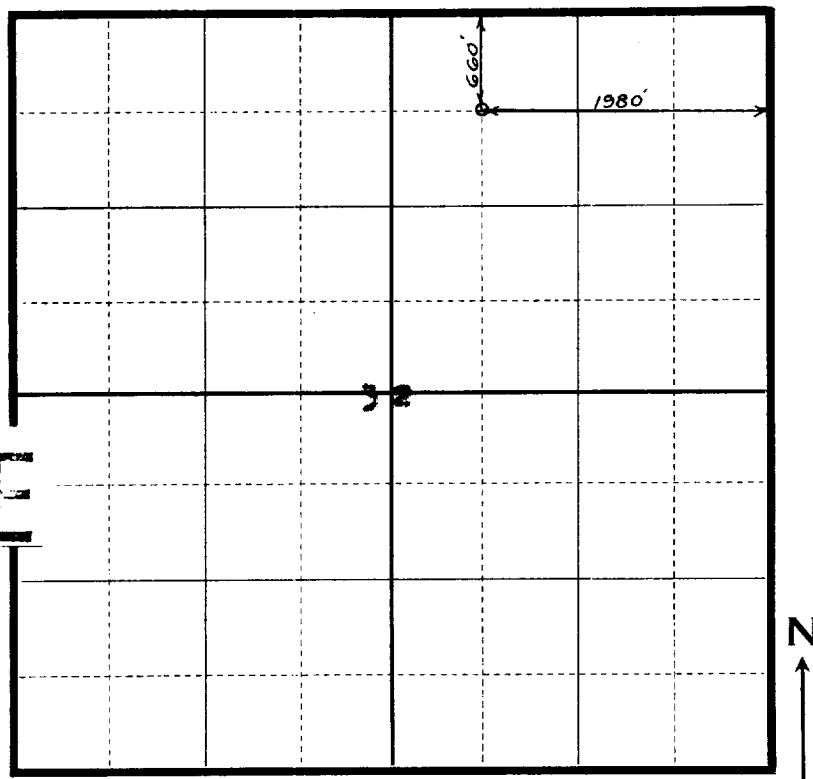

~~Sandoval~~ County, New Mexico. Scale: 4 Inches = 1 Mile.

This is to certify that the above plat was made from field notes of actual surveys made by me or under my supervision and that the representations thereon set forth are true and correct to the best of my knowledge and belief.

Edmund Ross

NEW MEXICO REGISTERED PROFESSIONAL ENGINEER

AND/OR LAND SURVEYOR NO. **81**

Seal:

Surveyed **March 27.**, 195**3**