

(SUBMIT IN TRIPLICATE)

UNITED STATES
DEPARTMENT OF THE INTERIOR
GEOLOGICAL SURVEY

Land Office Santa Fe, New Mexico
Lease No. NM 0830
Unit Delhi-Federal Goodner

SUNDRY NOTICES AND REPORTS ON WELLS

NOTICE OF INTENTION TO DRILL	<input checked="" type="checkbox"/>	SUBSEQUENT REPORT OF WATER SHUT-OFF	
NOTICE OF INTENTION TO CHANGE PLANS		SUBSEQUENT REPORT OF SHOOTING OR ACIDIZING	
NOTICE OF INTENTION TO TEST WATER SHUT-OFF		SUBSEQUENT REPORT OF ALTERING CASING	
NOTICE OF INTENTION TO RE-DRILL OR REPAIR WELL		SUBSEQUENT REPORT OF RE-DRILLING OR REPAIR	
NOTICE OF INTENTION TO SHOOT OR ACIDIZE		SUBSEQUENT REPORT OF ABANDONMENT	
NOTICE OF INTENTION TO PULL OR ALTER CASING		SUPPLEMENTARY WELL HISTORY	
NOTICE OF INTENTION TO ABANDON WELL			

(INDICATE ABOVE BY CHECK MARK NATURE OF REPORT, NOTICE, OR OTHER DATA)

March 8, 1962

Delhi Federal Goodner

Well No. 1 is located 1980 ft. from N line and 1980 ft. from E line of sec. 28

NE/4 28

(1/4 Sec. and Sec. No.)

18N

(Twp.)

2W

(Range)

NMPM

(Meridian)

Wildest

(Field)

Sandoval

(County or Subdivision)

New Mexico

(State or Territory)

The elevation of the derrick floor above sea level is 6923 ft.

DETAILS OF WORK

(State names of and expected depths to objective sands; show sizes, weights, and lengths of proposed casings; indicate mudding jobs, cementing points, and all other important proposed work)

Propose to set 7 5/8" csg @ 30 feet with 5 sacks cement; drill 6 1/4" hole to 1000 feet or Mesa Verde pay, whichever is shallower; set 4 1/2" csg w/100 sx cement if justified; expect first pay sand interval @ 540' and second at 900'. Will test intervals if justified and will core pays if possible. After setting 4 1/2" csg plan to perforate pays and frac if necessary. Mahew 1900 Rotary will be used. Plan to drill with air until too much water is encountered then drill on to T.D. with as little mud as possible. Surface and total depth will both be of Mesa Verde age.

I understand that this plan of work must receive approval in writing by the Geological Survey before operations may be commenced.

Company John K. Petty et al

Address 211 1/2 West Main Room 203

Farlington, New Mexico

By John K. Petty

Title Operator

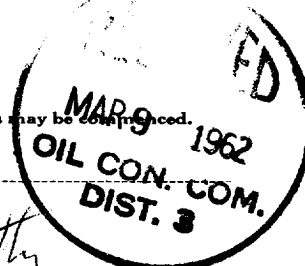

NEW MEXICO CONSERVATION COMMISSION
Well Location and Acreage Dedication Plat

Section A.

Date March 8, 1962

Operator John K. Petty, et al Lease Delhi Federal Goodner
Well No. 1 Unit Letter G Section 28 Township 18 North Range 2 West NMPM
Located 1980 Feet From North Line, 1980 Feet From East Line
County Sandoval G. L. Elevation _____ Dedicated Acreage 40 Acres
Name of Producing Formation Mesaverde Pool Wildcat

1. Is the Operator the only owner* in the dedicated acreage outlined on the plat below?
Yes ☒ No ☐.
2. If the answer to question one is "no," have the interests of all the owners been consolidated by communitization agreement or otherwise? Yes ☐ No ☐. If answer is "yes," Type of Consolidation _____
3. If the answer to question two is "no," list all the owners and their respective interests below:

Owner

Land Description

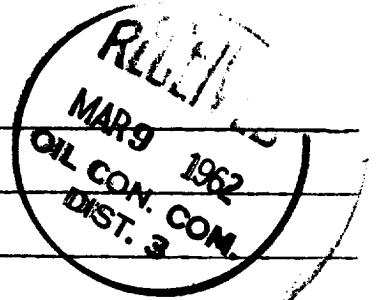

Section B

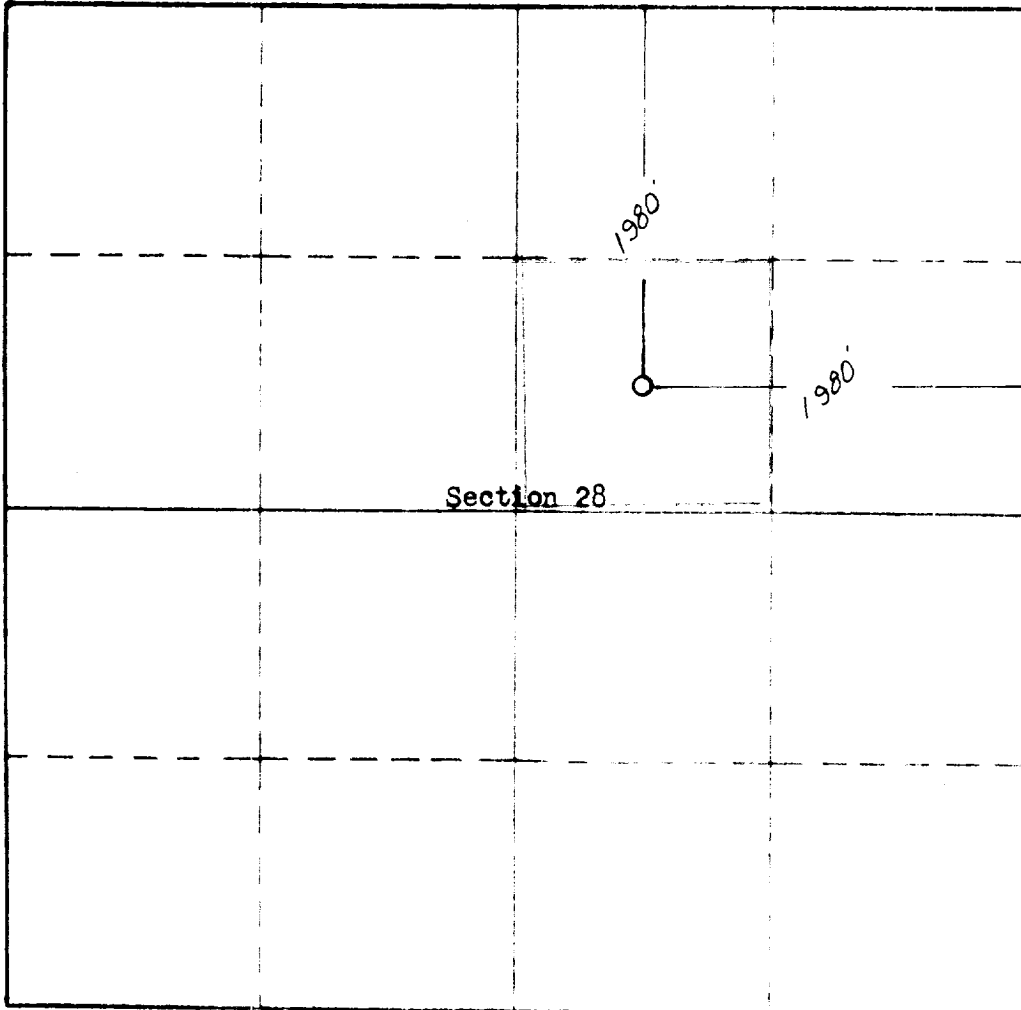

This is to certify that the information in Section A above is true and complete to the best of my knowledge and belief.

John K. Petty, et al
(Operator)

(Representative)
211 1/2 W. Main, Rm 208
Farmington, New Mexico
Address

This is to certify that the well location shown on the plat in Section B was plotted from field notes of actual surveys made by me or under my supervision and that the same is true and correct to the best of my knowledge and belief.

Date Surveyed Jan. 21, 1962

[Signature]
Registered Professional
Engineer and/or Land Surveyor.

Certificate No. 3084