

(SUBMIT IN TRIPLICATE)

UNITED STATES
DEPARTMENT OF THE INTERIOR
GEOLOGICAL SURVEY

Land Office Santa Fe, New Mex.
Lease No. S. F. 081160-F
Unit J

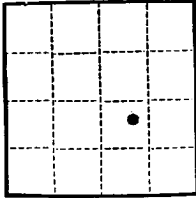

SUNDRY NOTICES AND REPORTS ON WELLS

NOTICE OF INTENTION TO DRILL.....	<input checked="" type="checkbox"/>	SUBSEQUENT REPORT OF WATER SHUT-OFF.....	
NOTICE OF INTENTION TO CHANGE PLANS.....		SUBSEQUENT REPORT OF SHOOTING OR ACIDIZING.....	
NOTICE OF INTENTION TO TEST WATER SHUT-OFF.....		SUBSEQUENT REPORT OF ALTERING CASING.....	
NOTICE OF INTENTION TO RE-DRILL OR REPAIR WELL.....		SUBSEQUENT REPORT OF RE-DRILLING OR REPAIR.....	
NOTICE OF INTENTION TO SHOOT OR ACIDIZE.....		SUBSEQUENT REPORT OF ABANDONMENT.....	
NOTICE OF INTENTION TO PULL OR ALTER CASING.....		SUPPLEMENTARY WELL HISTORY.....	
NOTICE OF INTENTION TO ABANDON WELL.....			

(INDICATE ABOVE BY CHECK MARK NATURE OF REPORT, NOTICE, OR OTHER DATA)

December 2, 1960

Well No. 3 is located 1862 ft. from S line and 2171 ft. from E line of sec. 21
Sec. 21 13N Sandoval 10W
(1/4 Sec. and Sec. No.) (Twp.) (Range) (Meridian)
Wildest New Mexico
(Field) (County or Subdivision) (State or Territory)

The elevation of the derrick floor above sea level is 6685 ft.

DETAILS OF WORK

(State names of and expected depths to objective sands; show sizes, weights, and lengths of proposed casings; indicate mudding jobs, cementing points, and all other important proposed work)

Expect to top Mesa Verde sand at 1300 feet using rotary core drill drilling 6 5/8 hole. If oil is found, will set 4 1/2" casing through the sand and cement and perforate. Expect to core and also run an electric log. Will set 40 feet 8 5/8" surface casing and circulate cement to set properly

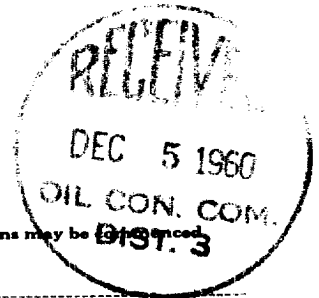

I understand that this plan of work must receive approval in writing by the Geological Survey before operations may be commenced.

Company Francis L. Harvey
Box 990,
Address Wichita Falls, Texas.

By Operator
Title _____

**NEW MEXICO OIL CONSERVATION COMMISSION
WELL LOCATION AND ACREAGE DEDICATION PLAT**

FORM C-128
Revised 5/1/57

SEE INSTRUCTIONS FOR COMPLETING THIS FORM ON THE REVERSE SIDE

SECTION A

Operator <i>Francis L. Harvey</i>		Lease <i>U. P. COLLECT</i>		Well No. <i>10</i>
Unit Letter	Section <i>21</i>	Township <i>18 N</i>	Range <i>3 W</i>	County <i>Sandoval</i>
Actual Footage Location of Well: <i>1862</i> feet from the <i>South</i> line and <i>2171</i> feet from the <i>east</i> line				
Ground Level Elev. <i>6685</i>	Producing Formation <i>Alamo Forté</i>	Pool <i>Alamo</i>	Dedicated Acreage: <i>10</i> Acres	

- Is the Operator the only owner in the dedicated acreage outlined on the plat below? YES _____ NO . ("Owner" means the person who has the right to drill into and to produce from any pool and to appropriate the production either for himself or for himself and another. (65-3-29 (e) NMSA 1935 Comp.)
- If the answer to question one is "no," have the interests of all the owners been consolidated by communitization agreement or otherwise? YES _____ NO . If answer is "yes," Type of Consolidation _____
- If the answer to question two is "no," list all the owners and their respective interests below:

Owner	Land Description
<i>Walter H. Harvey, Lyric L. Harvey, U. P. Collect, Harold L. Harvey</i>	

SECTION B

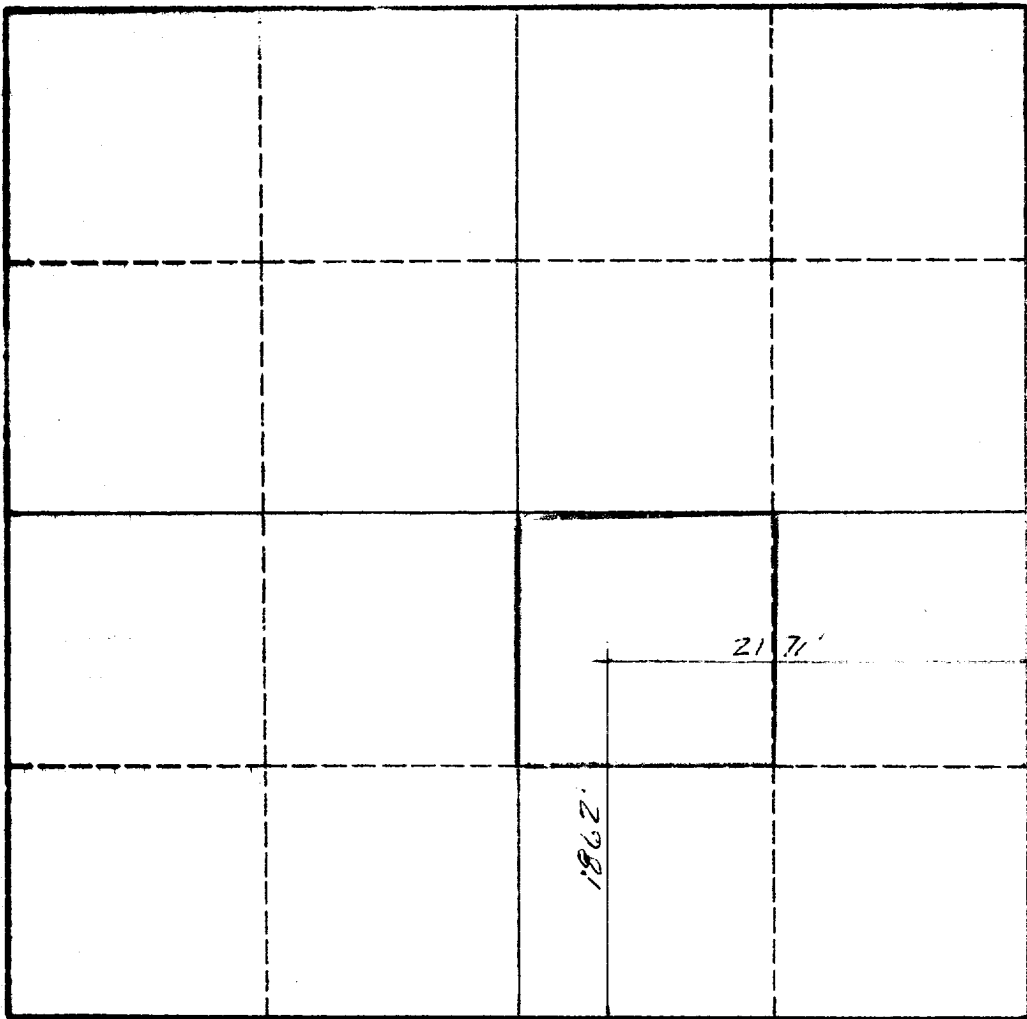

CERTIFICATION

I hereby certify that the information in SECTION A above is true and complete to the best of my knowledge and belief.

Name <i>F. L. Harvey</i>
Position <i>Operator</i>
Company
Date <i>November 30, 1960</i>

I hereby certify that the well location shown on the plat in SECTION A is plotted from field notes of actual surveys made by me or under my supervision, and that the same is true and correct to the best of my knowledge and belief.

Date Surveyed <i>21 NOV '60</i>
Registered Professional Engineer and/or Land Surveyor <i>Walter H. Harvey</i>
Certificate No. <i>N.Mex. P.E. & L.S. No 95</i>

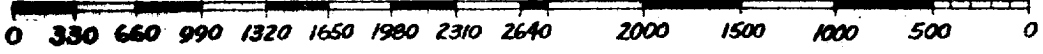

INSTRUCTIONS FOR COMPLETION OF FORM C-128

1. Operator shall furnish and certify to the information called for in Section A.
2. Operator shall outline the dedicated acreage for both oil and gas wells on the plat in Section B.
3. A registered professional engineer or land surveyor registered in the State of New Mexico or approved by the Commission shall show on the plat the location of the well and certify this information in the space provided.
4. All distances shown on the plat must be from the outer boundaries of the Section.
5. If additional space is needed for listing owners and their respective interests as required in question 3 of Section A, please use space below.