

(SUBMIT IN TRIPLICATE)

UNITED STATES
DEPARTMENT OF THE INTERIOR
GEOLOGICAL SURVEY

Budget Bureau No. 42-R368.4
Approval expires 12-31-60.

New Mexico

Land Office _____
Lease No. **NM 01378**
Unit **Holmes-Ped 01378**

SUNDRY NOTICES AND REPORTS ON WELLS

NOTICE OF INTENTION TO DRILL.....	<input checked="" type="checkbox"/>	SUBSEQUENT REPORT OF WATER SHUT-OFF.....
NOTICE OF INTENTION TO CHANGE PLANS.....		SUBSEQUENT REPORT OF SHOOTING OR ACIDIZING.....
NOTICE OF INTENTION TO TEST WATER SHUT-OFF.....		SUBSEQUENT REPORT OF ALTERING CASING.....
NOTICE OF INTENTION TO RE-DRILL OR REPAIR WELL.....		SUBSEQUENT REPORT OF RE-DRILLING OR REPAIR.....
NOTICE OF INTENTION TO SHOOT OR ACIDIZE.....		SUBSEQUENT REPORT OF ABANDONMENT.....
NOTICE OF INTENTION TO PULL OR ALTER CASING.....		SUPPLEMENTARY WELL HISTORY.....
NOTICE OF INTENTION TO ABANDON WELL.....		

(INDICATE ABOVE BY CHECK MARK NATURE OF REPORT, NOTICE, OR OTHER DATA)

February 26, 1961, 19__

Well No. **1** is located **2310** ft. from **[S]** line and **190** ft. from **[E]** line of sec. **14**
SE 1/4 Section 14 **13 N., 3 W., N.M.P.M.,**
(1/4 Sec. and Sec. No.) (Twp.) (Range) (Meridian)
Unknown **Sandoval County** **New Mexico**
(Field) (County or Subdivision) (State or Territory)

The elevation of the derrick floor above sea level is **6660** ft. (Ground)

DETAILS OF WORK

(State names of and expected depths to objective sands; show sizes, weights, and lengths of proposed casings; indicate mudding jobs, cementing points, and all other important proposed work)

Rotary Rig to T.D.
Est. T.D. 1200 - 1300' (Mesa Verde)

20'(est) 8 5/8" 23# surface casing set
If productive will run 4 1/2" casing to T.D. and cement to surface
and perforate opposite pay zone.

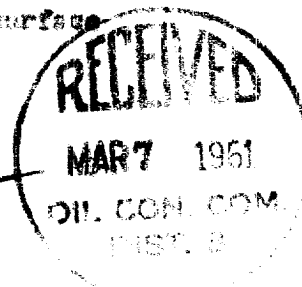

I understand that this plan of work must receive approval in writing by the Geological Survey before operations may be commenced.

Company **W. L. Holmes**
Address **P.O. Box 567**
Amarillo, Texas
By **John L. Burton**
Title **Agent, P.O. Box 1594**
Santa Fe, N.M.

NEW MEXICO OIL CONSERVATION COMMISSION

Well Location and Acreage Dedication Plat

SECTION A.

Date February 28, 1961

Operator W. W. Holmes Lease Holmes-Fed 01378
 Well No. 1 Unit Letter I Section 14 Township 18N Range 3W NMPM
 Located 2310 Feet From South Line, 190 Feet From East Line
 County Sandoval G. L. Elevation 6667' Dedicated Acreage _____ Acres
 Name of Producing Formation Mesa Verde Pool Unknown

1. Is the Operator the only owner* in the dedicated acreage outlined on the plat below? Yes ☒ No _____
2. If the answer to question One is "No," have the interests of all the owners been consolidated by communitization agreement or otherwise? Yes _____ No _____ If answer is "Yes," Type of Consolidation _____
3. If the answer to question Two is "No," list all the owners and their respective interests below:

OWNER

LAND DESCRIPTION

SECTION B.

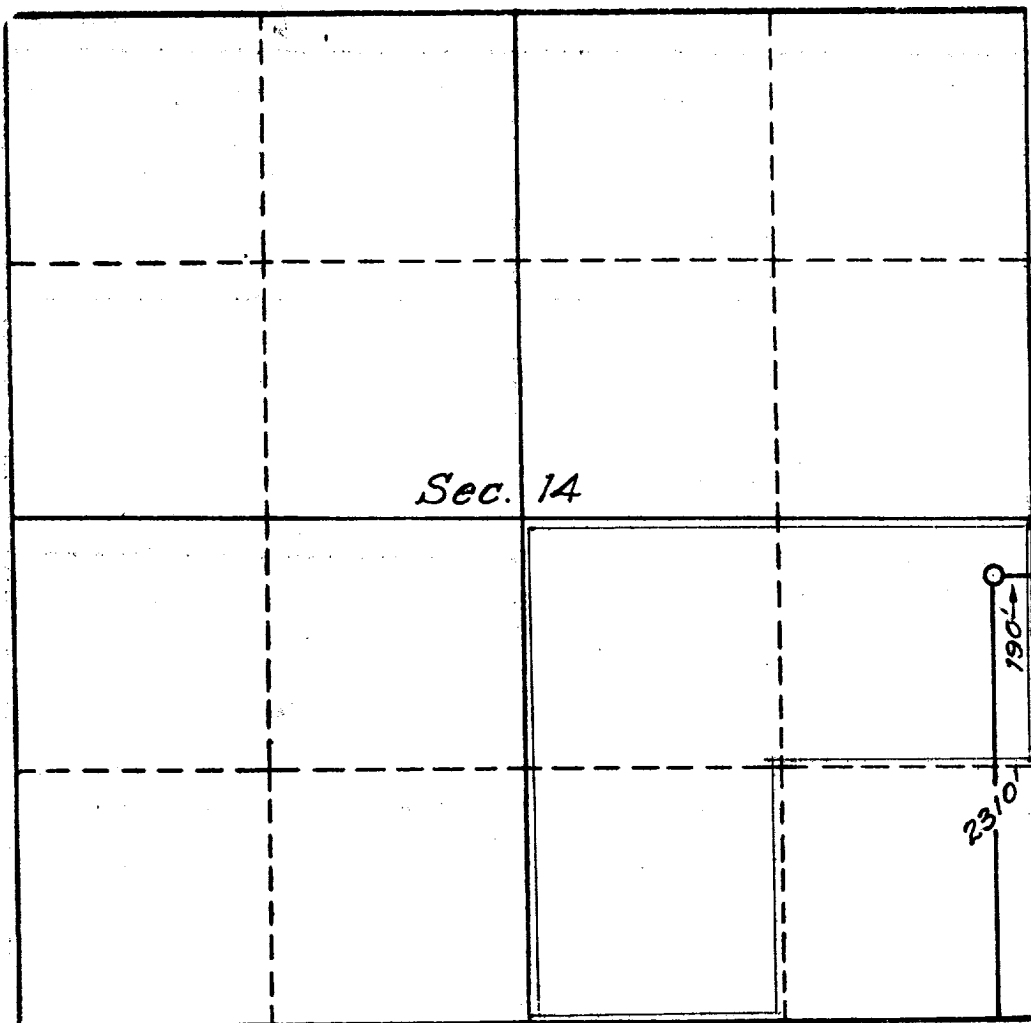

This is to certify that the information in Section A above is true and complete to the best of my knowledge and belief.

W. W. Holmes
P.O. Box 567, Amarillo, Texas
 (OPERATOR)

John H. Burton
 (REPRESENTATIVE) Burton

P.O. Box 1594, Santa Fe, N.M.
 (ADDRESS)

This is to certify that the well location shown on the plat in Section B was plotted from field notes of actual surveys made by me or under my supervision and that the same is true and correct to the best of my knowledge and belief.

Date Surveyed 2-9-10-11-12-61

Four States Engineering Co.
 FARMINGTON, NEW MEXICO

C. L. Poter
 REGISTERED ENGINEER OR
 LAND SURVEYOR

Certificate No. 3084