

(SUBMIT IN TRIPLICATE)

UNITED STATES
DEPARTMENT OF THE INTERIOR
GEOLOGICAL SURVEY

Land Office **New Mexico**
Lease No. **NM 006679**
Unit **Harvey-Federal**

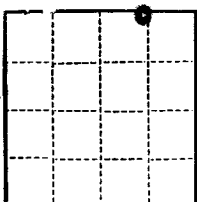

SUNDRY NOTICES AND REPORTS ON WELLS

NOTICE OF INTENTION TO DRILL.....	<input checked="" type="checkbox"/>	SUBSEQUENT REPORT OF WATER SHUT-OFF.....	
NOTICE OF INTENTION TO CHANGE PLANS.....		SUBSEQUENT REPORT OF SHOOTING OR ACIDIZING.....	
NOTICE OF INTENTION TO TEST WATER SHUT-OFF.....		SUBSEQUENT REPORT OF ALTERING CASING.....	
NOTICE OF INTENTION TO RE-DRILL OR REPAIR WELL.....		SUBSEQUENT REPORT OF RE-DRILLING OR REPAIR.....	
NOTICE OF INTENTION TO SHOOT OR ACIDIZE.....		SUBSEQUENT REPORT OF ABANDONMENT.....	
NOTICE OF INTENTION TO PULL OR ALTER CASING.....		SUPPLEMENTARY WELL HISTORY.....	
NOTICE OF INTENTION TO ABANDON WELL.....			

(INDICATE ABOVE BY CHECK MARK NATURE OF REPORT, NOTICE, OR OTHER DATA)

May 22, 19 61

Well No. 1 is located 330 ft. from {N} line and 1650 ft. from {E} line of sec. 15
NE $\frac{1}{4}$ of Section 15 18 North 3 W., nm NMP
($\frac{1}{4}$ Sec. and Sec. No.) (Twp.) (Range) (Meridian)
Unknown Sandoval County New Mexico
(Field) (County or Subdivision) (State or Territory)

The elevation of the derrick floor above sea level is 6682 ft. (Ground)

DETAILS OF WORK

(State names of and expected depths to objective sands; show sizes, weights, and lengths of proposed casings; indicate mudding jobs, cementing points, and all other important proposed work)

Rotary Tools to T.D.
Estimated Total Depth 1400
Approx 18' of 8 5/8" surface casing set,
If production is obtained will run 4 1/2" casing to T.D. and cement to Surf.
Perforate opposite pay zone.

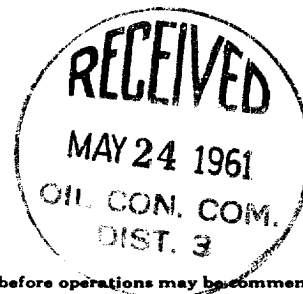

I understand that this plan of work must receive approval in writing by the Geological Survey before operations may be commenced.

Company W. W. HOLMES

Address P.O.Box 567,
Amarillo, Texas

By John H. Burton
John H. Burton, Agent
Title P.O.Box 1594, Santa Fe, NM

NEW MEXICO OIL CONSERVATION COMMISSION

Well Location and Acreage Dedication Plat

SECTION A.

Date **May 22, 1961**Operator **W. W. HOLMES**Lease **Harvey-Federal**Well No. **1** Unit Letter **"B"** Section **15** Township **18 NORTH** Range **3 WEST** NMPMLocated **330** Feet From **THE NORTH** Line, **1650** Feet From **THE EAST** LineCounty **Sandoval** G. L. Elevation **6682** Dedicated Acreage **40.00** AcresName of Producing Formation **Mesa Verde** Pool **Unknown**

1. Is the Operator the only owner* in the dedicated acreage outlined on the plat below? Yes ☒ No ☒
2. If the answer to question One is "No," have the interests of all the owners been consolidated by communitization agreement or otherwise? Yes ☐ No ☐ If answer is "Yes," Type of Consolidation _____
3. If the answer to question Two is "No," list all the owners and their respective interests below:

OWNER

LAND DESCRIPTION

Clyde B. Harvey

All rights below Gallup Sandstone
This tract to test Mesa Verde Formation

SECTION B.

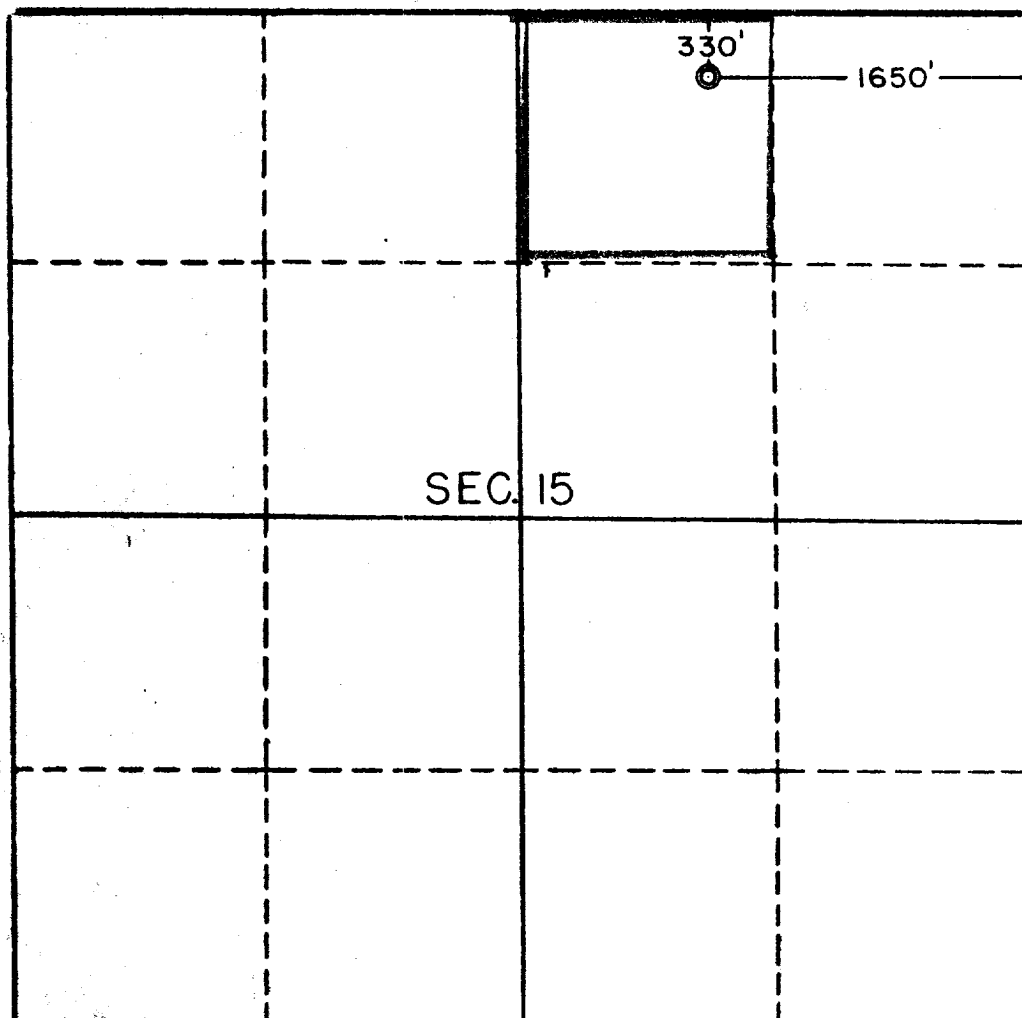

RECEIVED

MAY 24 1961

OIL CON. CO.
DIST. 9

This is to certify that the information in Section A is true and complete to the best of my knowledge and belief.

W. W. HOLMES,
P.O. Box 547, Amarillo, Texas

(OPERATOR)

John H. Burton
John H. Burton, (AGENT) **Agent**
P.O. Box 1594,
Santa Fe, N.M.

(ADDRESS)

This is to certify that the well location shown on the plat in Section B was plotted from best available actual survey data and that the same is true and correct to the best of my knowledge and belief.

Date Surveyed **MAY 15, 1961**

Four States Engineering Co.
 FARMINGTON, NEW MEXICO

E. J. Echols
E. J. Echols
 REGISTERED ENGINEER OR
 LAND SURVEYOR

Certificate No. **2090**