

(SUBMIT IN TRIPLICATE)

UNITED STATES
DEPARTMENT OF THE INTERIOR
GEOLOGICAL SURVEY

Budget Bureau No. 42-R358.4.
Approval expires 12-31-60.
Land Office **New Mexico**
Lease No. **NM 088995**
Unit **Spencer-Federal**

SUNDRY NOTICES AND REPORTS ON WELLS

NOTICE OF INTENTION TO DRILL	<input checked="" type="checkbox"/>	SUBSEQUENT REPORT OF WATER SHUT-OFF
NOTICE OF INTENTION TO CHANGE PLANS		SUBSEQUENT REPORT OF SHOOTING OR ACIDIZING
NOTICE OF INTENTION TO TEST WATER SHUT-OFF		SUBSEQUENT REPORT OF ALTERING CASING
NOTICE OF INTENTION TO RE-DRILL OR REPAIR WELL		SUBSEQUENT REPORT OF RE-DRILLING OR REPAIR
NOTICE OF INTENTION TO SHOOT OR ACIDIZE		SUBSEQUENT REPORT OF ABANDONMENT
NOTICE OF INTENTION TO PULL OR ALTER CASING		SUPPLEMENTARY WELL HISTORY
NOTICE OF INTENTION TO ABANDON WELL		

(INDICATE ABOVE BY CHECK MARK NATURE OF REPORT, NOTICE, OR OTHER DATA)

U. S. GEOLOGICAL SURVEY
FARMINGTON, NEW MEXICO

June 27

Well No. **11** is located **1945** ft. from **N** line and **1140** ft. from **E** line of sec. **11**

NW 1/4 of Sec. 11 (1/4 Sec. and Sec. No.) **18 N** (Twp.) **3 W** (Range) **N.M.P.** (Meridian)

Unknown (Field) **Sandoval** (County or Subdivision) **New Mexico** (State or Territory)

The elevation of the derrick floor above sea level is **6709** ft. (Ground)

DETAILS OF WORK

(State names of and expected depths to objective sands; show sizes, weights, and lengths of proposed casings; indicate mudding jobs, cementing points, and all other important proposed work)

Rotary Tools to T.D.
estimated Total Depth 1300'
20' 8 5/8" conductor pipe
If productive will run 4 1/2" casing to T.D. & cement to surface;
perforate and test.
Will test through Mesa Verde.

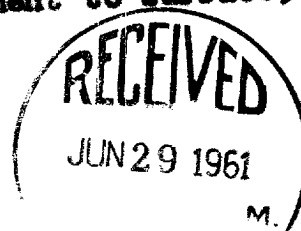

I understand that this plan of work must receive approval in writing by the Geological Survey before operations may be commenced.

Company **W. W. Holmes**

Address **P.O. Box 567**

Amarillo, Texas

By **John H. Burton, Agent**

Title **Box 1594, Santa Fe, N.M.**

NEW MEXICO OIL CONSERVATION COMMISSION

Well Location and Acreage Dedication Plat

SECTION A.

Date **June 27, 1961**

Operator **W. W. Holmes** Lease **Spencer-Federal**
Well No. **11** Unit Letter **E** Section **11** Township **18 North** Range **3 West** MAPM
Located **1945** Feet From **North** Line, **1140** Feet From **West** Line
County **Sandoval** G. L. Elevation **6709** Dedicated Acreage **40** Acres
Name of Producing Formation **Mesa Verde** Pool **Unknown**

1. Is the Operator the only owner* in the dedicated acreage outlined on the plat below? Yes ☒ No ☐
2. If the answer to question One is "No," have the interests of all the owners been consolidated by communitization agreement or otherwise? Yes ☐ No ☐ If answer is "Yes," Type of Consolidation _____
3. If the answer to question Two is "No," list all the owners and their respective interests below:

OWNER

LAND DESCRIPTION

SECTION B.

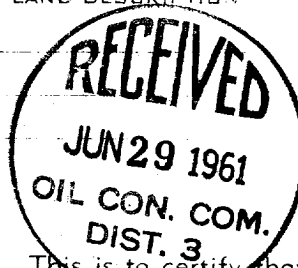
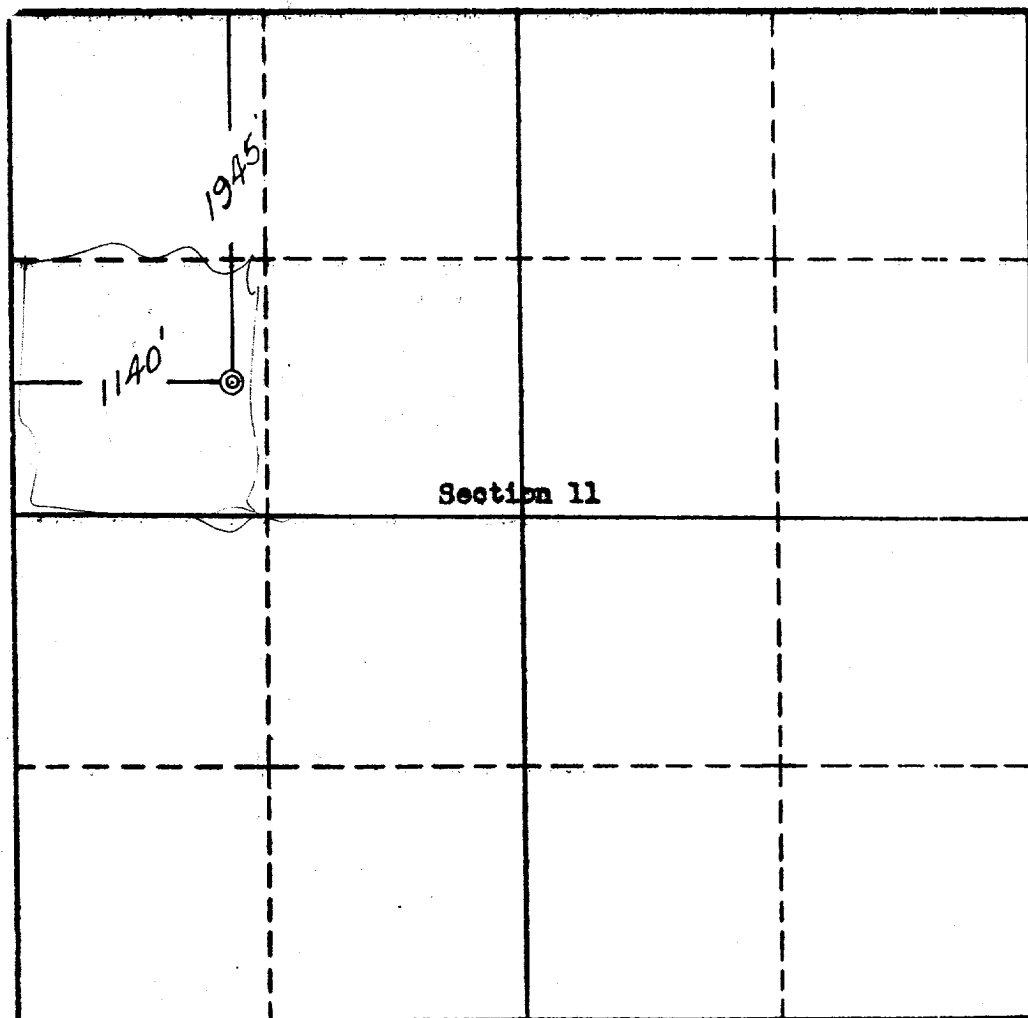

This is to certify that the information in Section A above is true and complete to the best of my knowledge and belief.

W. W. HOLMES
P.O. Box 567, Amarillo, Texas

John H. Burton
John H. Burton, Agent

Box 1594, Santa Fe, N.M.

(ADDRESS)

This is to certify that the well location shown on the plat in Section B was plotted from field actual survey made by my supervisor and is true and correct to the best of my knowledge and belief.



Date Surveyed **June 19, 1961**

Four States Engineering Co.
FARMINGTON, NEW MEXICO

E. L. Potest
REGISTERED ENGINEER OR
LAND SURVEYOR

Certificate No **3084**

