

(SUBMIT IN TRIPLICATE)

UNITED STATES  
DEPARTMENT OF THE INTERIOR  
GEOLOGICAL SURVEY

Budget Bureau No. 42-R338.4  
Approval expires 12-31-60.

Land Office **New Mexico**  
Lease No. **NM 088995**  
Unit **Spencer-Federal**

SUNDRY NOTICES AND REPORTS ON WELLS

NOTICE OF INTENTION TO DRILL	SUBSEQUENT REPORT OF WATER SHUT-OFF
NOTICE OF INTENTION TO CHANGE PLANS	SUBSEQUENT REPORT OF SHOOTING OR ACIDIZING
NOTICE OF INTENTION TO TEST WATER SHUT-OFF	SUBSEQUENT REPORT OF ALTERING CASING
NOTICE OF INTENTION TO RE-DRILL OR REPAIR WELL	SUBSEQUENT REPORT OF RE-DRILLING OR REPAIR
NOTICE OF INTENTION TO SHOOT OR ACIDIZE	SUBSEQUENT REPORT OF ABANDONMENT
NOTICE OF INTENTION TO PULL OR ALTER CASING	SUPPLEMENTARY WELL HISTORY
NOTICE OF INTENTION TO ABANDON WELL	

(INDICATE ABOVE BY CHECK MARK NATURE OF REPORT, NOTICE, OR OTHER DATA)

February 27, 1961

Well No. ~~11~~ is located 1650 ft. from N line and 990 ft. from E line of sec. 11  
NW 1/4 Section 11 18 N., 3 W., N.M.P.  
(1/4 Sec. and Sec. No.) (Twp.) (Range) (Meridian)  
Wilcoats Sandoval New Mexico  
(Field) (County or Subdivision) (State or Territory)

The elevation of the derrick floor above sea level is 6708 ft. Ground

DETAILS OF WORK

(State names of and expected depths to objective sands; show sizes, weights, and lengths of proposed casings; indicate mudding jobs, cementing points, and all other important proposed work)

Rotary Rig  
 Approximately 20' of 8 5/8" 28# Surface case to be set  
 If Productive will run  
 1 1/2" Casing to T.D. and cement to surface  
 and perforate opposite pay zone.

Estimated T. D. 1200' to 1300'



I understand that this plan of work must receive approval in writing by the Geological Survey before operations may be commenced.

Company W. W. Holmes  
 Address P.O. Box 567,  
Amarillo, Texas  
 By John H. Burton  
 Title Agent, P.O. Box 1594  
Santa Fe, N.M.

## NEW MEXICO OIL CONSERVATION COMMISSION

## Well Location and Acreage Dedication Plat

## SECTION A.

Date 2-27-61

Operator W. W. Holmes Lease Spencer - Federal  
 Well No. 4 Unit Letter E Section 11 Township 18N Range 3N NMPM  
 Located 1650 Feet From North Line, 990 Feet From West Line  
 County Sandoval G. L. Elevation 6708' Dedicated Acreage 40 Acres  
 Name of Producing Formation Mesa Verde Pool Wildcat

1. Is the Operator the only owner\* in the dedicated acreage outlined on the plat below? Yes ☒ No ☐
2. If the answer to question One is "No," have the interests of all the owners been consolidated by communitization agreement or otherwise? Yes ☐ No ☐ If answer is "Yes," Type of Consolidation \_\_\_\_\_
3. If the answer to question Two is "No," list all the owners and their respective interests below

OWNER

LAND DESIGNATION



## SECTION B.

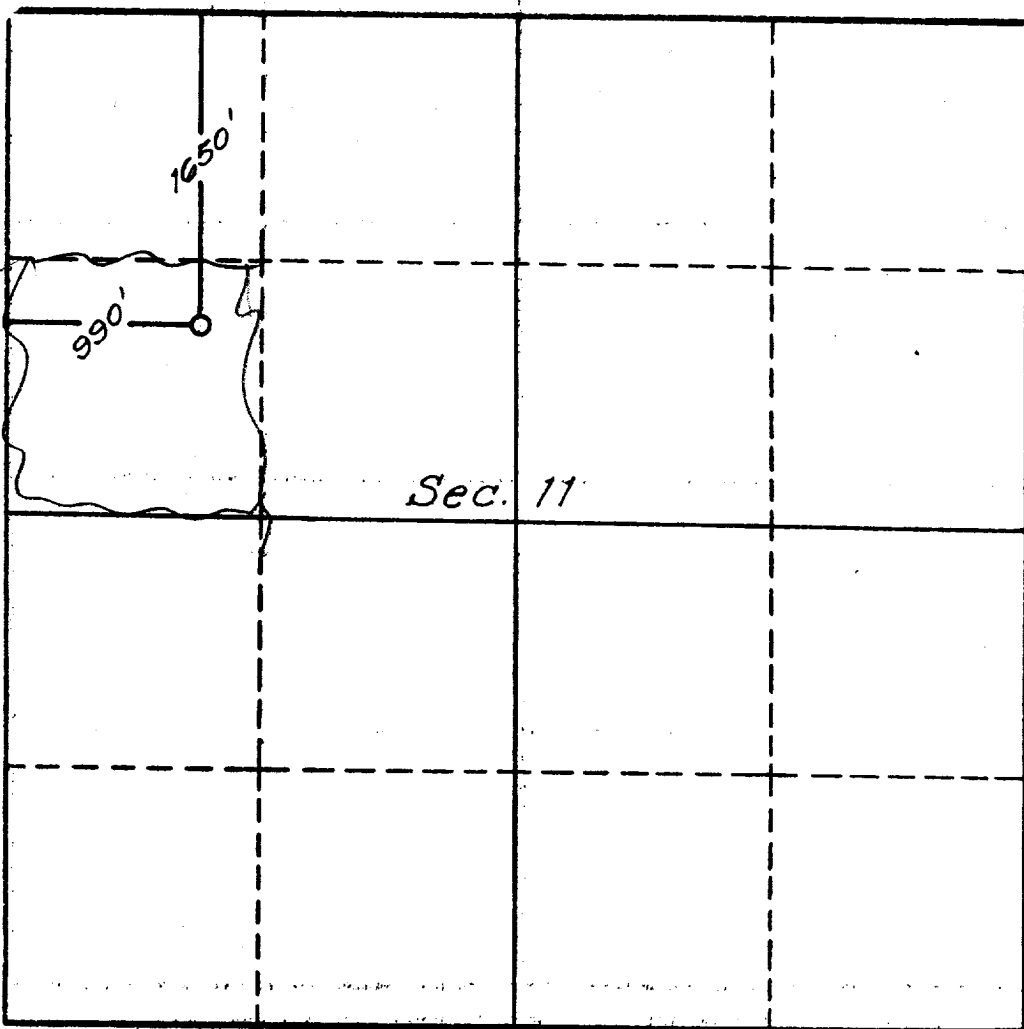

This is to certify that the information in Section A above is true and complete to the best of my knowledge and belief.

Mr. W. W. Holmes  
 P.O. Box 567, Amarillo, Texas

(OPERATOR)  
*John H. Burton*  
 John H. Burton, Agent  
 Box 1594 (REPRESENTATIVE)  
 Santa Fe, New Mexico

(ADDRESS)

This is to certify that the well location shown on the plat in Section B was plotted from field notes of actual surveys made by me or under my supervision and that the same is true and correct to the best of my knowledge and belief.

Date Surveyed 2-9-10-11-12-61

Four States Engineering Co.  
 FARMINGTON, NEW MEXICO

*C. L. Poter*  
 REGISTERED ENGINEER OR  
 LAND SURVEYOR

Certificate No. 3084