

Land Office Santa Fe
Lease No. MM-081213
Unit _____

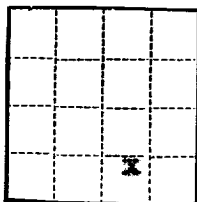

DEPARTMENT OF THE INTERIOR
GEOLOGICAL SURVEY

SUNDRY NOTICES AND REPORTS ON WELLS

NOTICE OF INTENTION TO DRILL	X	SUBSEQUENT REPORT OF WATER SHUT-OFF	RECEIVED
NOTICE OF INTENTION TO CHANGE PLANS		SUBSEQUENT REPORT OF SHOOTING OR ACIDIZING	
NOTICE OF INTENTION TO TEST WATER SHUT-OFF		SUBSEQUENT REPORT OF ALTERING CASING	
NOTICE OF INTENTION TO RE-DRILL OR REPAIR WELL		SUBSEQUENT REPORT OF RE-DRILLING OR REPAIR	MAR 27 1965
NOTICE OF INTENTION TO SHOOT OR ACIDIZE		SUBSEQUENT REPORT OF ABANDONMENT	
NOTICE OF INTENTION TO PULL OR ALTER CASING		SUPPLEMENTARY WELL HISTORY	U. S. GEOLOGICAL SURVEY
NOTICE OF INTENTION TO ABANDON WELL			

(INDICATE ABOVE BY CHECK MARK NATURE OF REPORT, NOTICE, OR OTHER DATA)

March 21, 1963

Well No. 1 is located 940 ft. from S line and 1565 ft. from E line of sec. 21

SW/4 SE/4 Sec 21	19N	1 W	100N
(¼ Sec. and Sec. No.)	(Twp.)	(Range)	(Meridian)

Wildcat

(Field)

Sandoval

(County or Subdivision)

NEW YORK
(State or Territory)

(State or Territory)

The elevation of the ~~deck floor~~ ^{ground level} above sea level is 6739 ft.

DETAILS OF WORK

(State names of and expected depths to objective sands; show sizes, weights, and lengths of proposed casings; indicate mudding and cementing points, and all other important proposed work)

An 8 3/4" hole will be drilled to a depth of approx. 300' and 7" surface casing run and cemented.

A 6 1/4" hole will then be drilled with air to a total depth of approximately 1650' to test the Gallup formation. If commercial production is encountered 4 1/2" production casing will be run and cemented.

I understand that this plan of work must receive approval in writing by the Geological Survey before operations may be commenced.

Company Neese and Van Dyke

Address P.O. Box 3117

Albuquerque, New Mexico

Original signed by T. A. Dugan

By

Title Consulting Engineer

NEW MEXICO OIL CONSERVATION COMMISSION

Well Location and Acreage Dedication Plat

SECTION A.

Date March 21, 1963

Operator Reese and Van Dyke Lease Benn and McKay
 Well No. 1 Unit Letter 0 Section 21 Township 19 North Range 1 West NMPM
 Located 940 Feet From South Line, 1565 Feet From East Line
 County Sandoval G. L. Elevation 6739 Dedicated Acreage 40 Acres
 Name of Producing Formation Gallup Pool Wildcat

1. Is the Operator the only owner* in the dedicated acreage outlined on the plat below? Yes X No _____
2. If the answer to question One is "No," have the interests of all the owners been consolidated by communitization agreement or otherwise? Yes _____ No _____. If answer is "Yes," Type of Consolidation _____
3. If the answer to question Two is "No," list all the owners and their respective interests below:

OWNER

LAND DESCRIPTION

SECTION B.

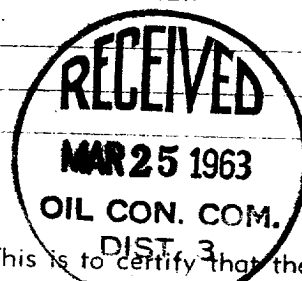
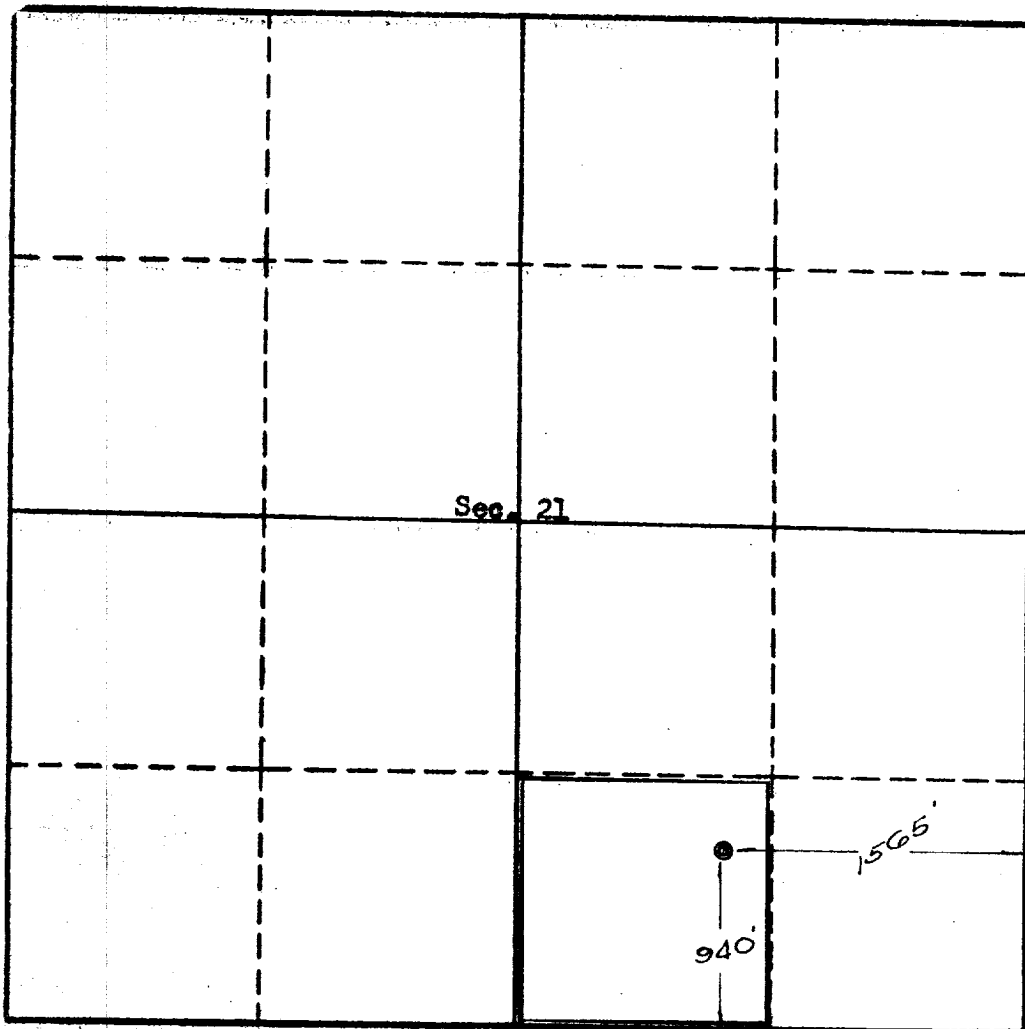

This is to certify that the information in Section A above is true and complete to the best of my knowledge and belief.

Reese & Van Dyke
 (OPERATOR)

Original signed by T. A. Dugan

(REPRESENTATIVE)

709 Bloomfield Highway
 Farmington, New Mexico

This is to certify that the well location shown on the plat in Section B was plotted from field notes of actual surveys made by me or under my supervision and that the same is true and correct to the best of my knowledge and belief.

Date Surveyed March 20, 1963

Four States Engineering Co.
 FARMINGTON, NEW MEXICO

Emmett V. Cochran
 REGISTERED ENGINEER OR
 LAND SURVEYOR

Certificate No. 3602