

COPY FOR  
STATE OF NEW MEXICO  
OIL CONSERVATION  
COMMISSION  
SUBMIT IN TRIPLICATE TO  
DISTRICT OFFICE

UNITED STATES  
DEPARTMENT OF THE INTERIOR  
GEOLOGICAL SURVEY

Land Office \_\_\_\_\_  
Lease No. \_\_\_\_\_  
Unit **SP 001 078939-D**

SUNDRY NOTICES AND REPORTS ON WELLS

NOTICE OF INTENTION TO DRILL _____	<input checked="" type="checkbox"/>	SUBSEQUENT REPORT OF WATER SHUT-OFF _____	
NOTICE OF INTENTION TO CHANGE PLANS _____		SUBSEQUENT REPORT OF SHOOTING OR ACIDIZING _____	
NOTICE OF INTENTION TO TEST WATER SHUT-OFF _____		SUBSEQUENT REPORT OF ALTERING CASING _____	
NOTICE OF INTENTION TO RE-DRILL OR REPAIR WELL _____		SUBSEQUENT REPORT OF REDRILLING OR REPAIR _____	
NOTICE OF INTENTION TO SHOOT OR ACIDIZE _____		SUBSEQUENT REPORT OF ABANDONMENT _____	
NOTICE OF INTENTION TO PULL OR ALTER CASING _____		SUPPLEMENTARY WELL HISTORY _____	
NOTICE OF INTENTION TO ABANDON WELL _____			

(INDICATE ABOVE BY CHECK MARK NATURE OF REPORT, NOTICE, OR OTHER DATA)

August 15, 1955

Renkoff "D"  
Well No. **1** is located **1900** ft. from **NE** line and **1900** ft. from **DE** line of sec. **17**

**NE SW - 17** (1/4 Sec. and Sec. No.) **19N** (Twp.) **4W** (Range) **100E** (Meridian) **N.M.D.V.**  
**Wildest** (Field) **Sandoval** (County or Subdivision) **New Mexico** (State or Territory)

The elevation of the derrick floor above sea level is \_\_\_\_\_ ft. To be furnished later

DETAILS OF WORK

(State names of and expected depths to objective sands; show sizes, weights, and lengths of proposed casings; indicate muddling jobs, cementing points, and all other important proposed work)

**It is intended to test Hosta formation with TD expected to be around 2300'.**

Casing Program;

Approximately 35' of 13-3/8" with 35 sks.  
Approximately 2200' of 7" with 100 sks.



I understand that this plan of work must receive approval in writing by the Geological Survey before operations may be commenced.

**Tim G. Lowry** *dm*

Company **Lowry et al Operating Account**

Address **616 E. Central**  
**Albuquerque, New Mexico**

By **Tim G. Lowry**  
*[Signature]*  
Title **General Manager**

Company.....Lowry et al Operating Account.....

Lease.....Well No.....

Sec.....17....., T.....19 N....., R.....4 W.,.....N.M.P.M.....

Location.....1980' from the South line and 1980' from  
the West line.

Sandoval County

New Mexico

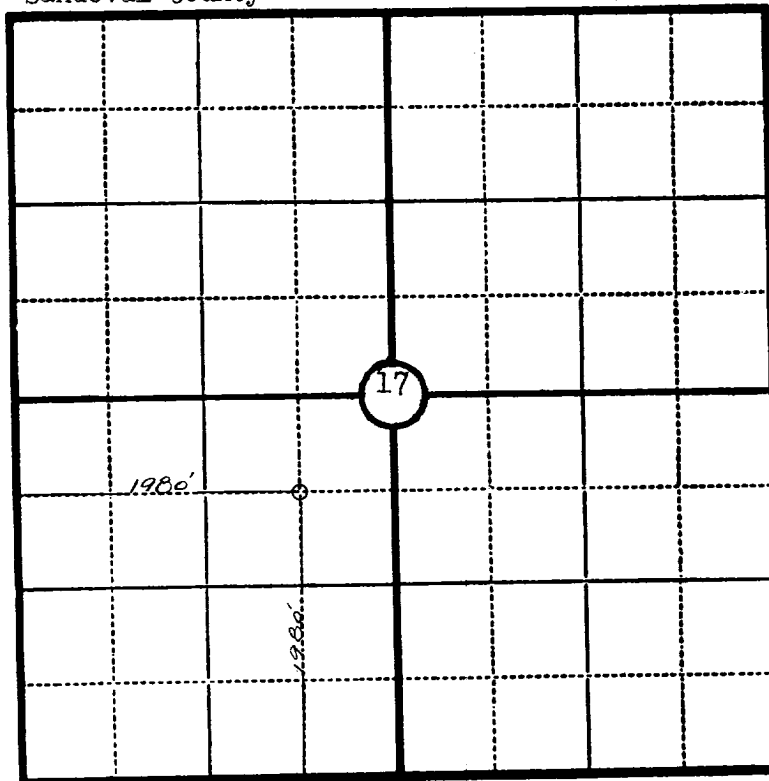

Scale—4 inches equal 1 mile.

This is to certify that the above plat was prepared from field notes of actual surveys made by me or under my supervision and that the same are true and correct to the best of my knowledge and belief.

Seal:

*James P. Leese*  
Registered Professional  
Engineer and Land Surveyor.

James P. Leese  
N. Mex. Reg. No. 1463

Surveyed .....August 14....., 19.53.....

RECEIVED

U.S. GEOLOGICAL SURVEY  
WASHINGTON, D.C.

