

(SUBMIT IN TRIPLICATE)

UNITED STATES
DEPARTMENT OF THE INTERIOR
GEOLOGICAL SURVEY

Budget Bureau No. 42-R358.4.
Approval expires 12-31-60.

Land Office Santa Fe
Lease No. NA 0117361
Unit _____

SUNDRY NOTICES AND REPORTS ON WELLS

NOTICE OF INTENTION TO DRILL	<input checked="" type="checkbox"/>	SUBSEQUENT REPORT OF WATER SHUT-OFF	
NOTICE OF INTENTION TO CHANGE PLANS		SUBSEQUENT REPORT OF SHOOTING OR ACIDIZING	
NOTICE OF INTENTION TO TEST WATER SHUT-OFF		SUBSEQUENT REPORT OF ALTERING CASING	
NOTICE OF INTENTION TO RE-DRILL OR REPAIR WELL		SUBSEQUENT REPORT OF RE-DRILLING OR REPAIR	
NOTICE OF INTENTION TO SHOOT OR ACIDIZE		SUBSEQUENT REPORT OF ABANDONMENT	
NOTICE OF INTENTION TO PULL OR ALTER CASING		SUPPLEMENTARY WELL HISTORY	
NOTICE OF INTENTION TO ABANDON WELL			

(INDICATE ABOVE BY CHECK MARK NATURE OF REPORT, NOTICE, OR OTHER DATA)

Well No. Torreón 1 is located 1980 ft. from S line and 1980 ft. from W line of sec. 27
N 27 Sec 27 T-20-N R-3-W 1917M
 (1/4 Sec. and Sec. No.) (Twp.) (Range) (Meridian)
Wildcat Sandoval New Mexico
 (Field) (County or Subdivision) (State or Territory)

The elevation of the ~~ground surface~~ ground above sea level is 6799.0 ft.

DETAILS OF WORK

(State names of and expected depths to objective sands; show sizes, weights, and lengths of proposed casings; indicate mudding, cementing points, and all other important proposed work)

We propose to drill a hole at the above location to an approximate depth of 4000' in an attempt to gain stratigraphic information about the Gallup sand. 300' of 10 3/4" O.D. surface casing will be set and cemented to surface. Should any commercial shows of hydrocarbons be encountered a 4 1/2" O.D. oil string will be set.

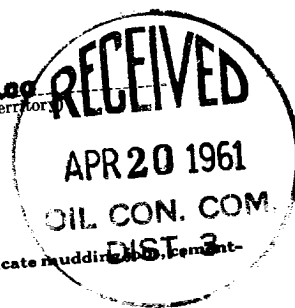

U. S. GEOLOGICAL SURVEY
SANTA FE, NEW MEXICO

I understand that this plan of work must receive approval in writing by the Geological Survey before operations may be commenced.

Company The Atlantic Refining Company

Address P. O. Box 520
Casper, Wyoming

By A. O. Keating
 Title Regional Drilling Manager

NEW MEXICO OIL CONSERVATION COMMISSION

Well Location and Acreage Dedication Plat

Section A.

Date 4/18/61

Operator THE ATLANTIC REFINING COMPANY Lease TORREON
 Well No. 1 Unit Letter K Section 27 Township 28 NORTH Range 3 WEST, NMPM
 Located 1980 Feet From the SOUTH Line, 1980 Feet From the WEST Line
 County SANDOVAL G. L. Elevation 6799.0 Dedicated Acreage 40.0 Acres
 Name of Producing Formation Mildart Pool _____

1. Is the Operator the only owner in the dedicated acreage outlined on the plat below?

Yes X No _____

2. If the answer to question one is "no", have the interests of all the owners been consolidated by communitization agreement or otherwise? Yes _____ No _____. If answer is "yes", Type of Consolidation.

3. If the answer to question two is "no", list all the owners and their respective interests below:

Owner

Land Description

RECEIVED

APR 20 1961

OIL CON. COM.

DIST. 3

Section B.

This is to certify that the information
 in Section A above is true and complete
 to the best of my knowledge and belief.

The Atlantic Refining Company

(Operator)

B. J. Sartin

(Representative)

P.O. Box 520

(Address)

Casper, Wyoming

Note: All distances must be from outer boundaries of section.

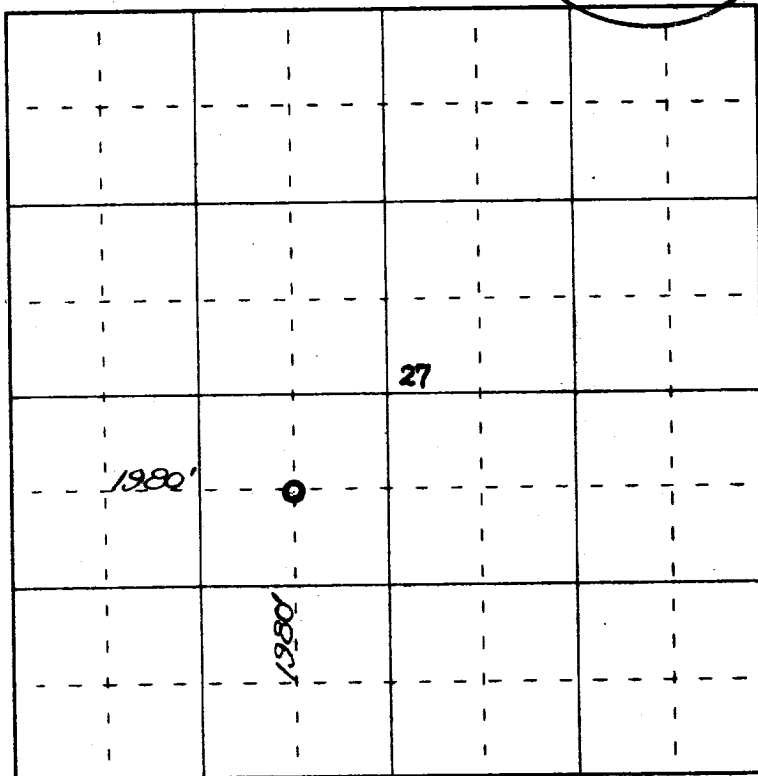

0 320 640 960 1280 1600 1920 2240 2560 2880 3200 3520 3840 4160 4480 4800 5120 5440 5760 6080 6400

Scale 4 inches equal 1 mile



(Seal)

Farmington, New Mexico

This is to certify that the above plat was prepared from field notes of actual surveys
 by me or under my supervision and that the same are true and correct to the best
 of my knowledge and belief.

Date Surveyed 15 April 1961

James P. Loose
 Registered Professional Engineer and/or Land Surveyor
 James P. Loose N. Mex. Reg. No. 1463
 601 New Mexico Highway