

Form 9-331a  
(Feb. 1951)

(SUBMIT IN TRIPLICATE)

Land Office Santa Fe  
Lease No. 0769  
Unit \_\_\_\_\_

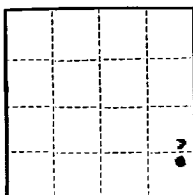

UNITED STATES  
DEPARTMENT OF THE INTERIOR  
GEOLOGICAL SURVEY

SUNDRY NOTICES AND REPORTS ON WELLS

NOTICE OF INTENTION TO DRILL.....	<input checked="" type="checkbox"/>	SUBSEQUENT REPORT OF WATER SHUT-OFF.....
NOTICE OF INTENTION TO CHANGE PLANS.....	<input type="checkbox"/>	SUBSEQUENT REPORT OF SHOOTING OR ACIDIZING.....
NOTICE OF INTENTION TO TEST WATER SHUT-OFF.....	<input type="checkbox"/>	SUBSEQUENT REPORT OF ALTERING CASING.....
NOTICE OF INTENTION TO RE-DRILL OR REPAIR WELL.....	<input type="checkbox"/>	SUBSEQUENT REPORT OF RE-DRILLING OR REPAIR.....
NOTICE OF INTENTION TO SHOOT OR ACIDIZE.....	<input type="checkbox"/>	SUBSEQUENT REPORT OF ABANDONMENT.....
NOTICE OF INTENTION TO PULL OR ALTER CASING.....	<input type="checkbox"/>	SUPPLEMENTARY WELL HISTORY.....
NOTICE OF INTENTION TO ABANDON WELL.....	<input type="checkbox"/>	

(INDICATE ABOVE BY CHECK MARK NATURE OF REPORT, NOTICE, OR OTHER DATA)

May 5, 1961

Well No. 5074 is located 660 ft. from S line and 660 ft. from W line of sec. 14  
21 N 4 1/2 N 2 1/2 W  
(Twp.) (Range) (Meridian)  
53rd and Sec. 14 Bandera Co New Mexico  
(Field) (County or Subdivision) (State or Territory)

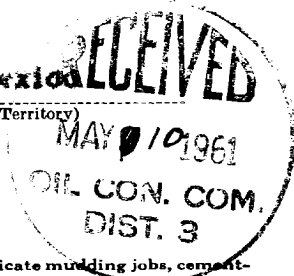

The elevation of the derrick floor above sea level is 7134 ft.

DETAILS OF WORK

(State names of and expected depths to objective sands; show sizes, weights, and lengths of proposed casings; indicate mudding jobs, cementing points, and all other important proposed work)

Propose to drill 10-3/4" hole to 150'. Will set 8-5/8" surfacing casing at 150' and cement to surface. Propose to drill 7-7/8" hole to 4500'. Will set 5-1/2" casing at 4500' and cement with 200 sacks. Propose to drill to 8000' with either air or cable tools. If oil or gas is encountered in commercial quantities, will set liner and complete.

I understand that this plan of work must receive approval in writing by the Geological Survey before operations may be commenced.

Company Boy Furr  
Address Box 1650  
Hublock, Texas

By Harrell Budd  
Title Consulting Geologist

NEW MEXICO OIL CONSERVATION COMMISSION  
Well Location and Acreage Dedication Plat

Section A.

Date \_\_\_\_\_

Operator ROY FURR Lease SUN FEDERAL  
Well No. 1 Unit Letter \_\_\_\_\_ Section 14 Township 21N Range 4W NMPN:  
Located 660 Feet From south Line, 660 Feet From east Line  
County Sandoval G. L. Elevation 7124 Dedicated Acreage \_\_\_\_\_ Acres  
Name of Producing Formation \_\_\_\_\_ Pool \_\_\_\_\_

1. Is the Operator the only owner\* in the dedicated acreage outlined on the plat below?  
Yes \_\_\_\_\_ No \_\_\_\_\_.
2. If the answer to question one is "no," have the interests of all the owners been consolidated by communitization agreement or otherwise? Yes \_\_\_\_\_ No \_\_\_\_\_. If answer is "yes," Type of Consolidation \_\_\_\_\_
3. If the answer to question two is "no," list all the owners and their respective interests below:

<u>Owner</u>	<u>Land Description</u>



Section B

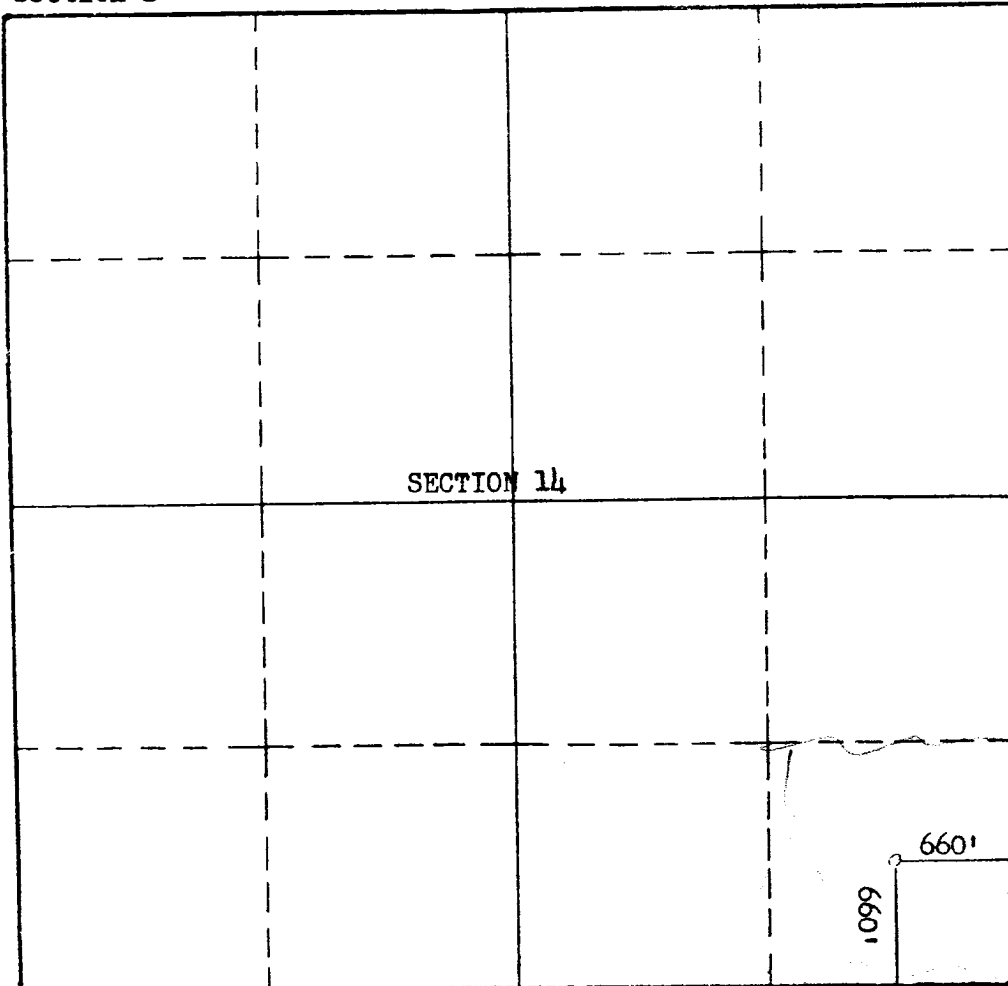

This is to certify that the information in Section A above is true and complete to the best of my knowledge and belief.

Roy Furr  
(Operator)

Lawell Budd  
(Representative)

Farmington, N.M.  
Address

This is to certify that the well location shown on the plat in Section B was plotted from field notes of actual surveys made by me or under my supervision and that the same is true and correct to the best of my knowledge and belief.

Date Surveyed May 10, 1961

Stephen E. Riney  
STEPHEN E. RINEY  
Registered Professional  
Engineer and/or Land Surveyor.

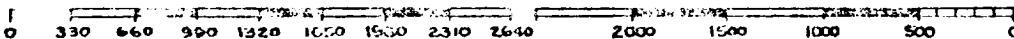

Certificate No. 803

(See instructions for completing this form on the reverse side)