

(SUBMIT IN TRIPLICATE)

UNITED STATES
DEPARTMENT OF THE INTERIOR
GEOLOGICAL SURVEY

Land Office Santa Fe
Lease No. S.F. 079335
Unit E.C. White

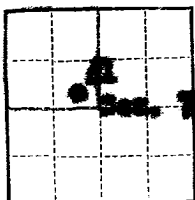

SUNDRY NOTICES AND REPORTS ON WELLS

NOTICE OF INTENTION TO DRILL	<input checked="" type="checkbox"/>	SUBSEQUENT REPORT OF WATER SHUT-OFF	
NOTICE OF INTENTION TO CHANGE PLANS		SUBSEQUENT REPORT OF SHOOTING OR ACIDIZING	
NOTICE OF INTENTION TO TEST WATER SHUT-OFF		SUBSEQUENT REPORT OF ALTERING CASING	
NOTICE OF INTENTION TO RE-DRILL OR REPAIR WELL		SUBSEQUENT REPORT OF RE-DRILLING OR REPAIR	
NOTICE OF INTENTION TO SHOOT OR ACIDIZE		SUBSEQUENT REPORT OF ABANDONMENT	
NOTICE OF INTENTION TO PULL OR ALTER CASING		SUPPLEMENTARY WELL HISTORY	
NOTICE OF INTENTION TO ABANDON WELL			

(INDICATE ABOVE BY CHECK MARK NATURE OF REPORT, NOTICE, OR OTHER DATA)

E.C. White

September 4, 1956

Well No. 1 is located 1900 ft. from N line and 1900 ft. from W line of sec. 7

N 1/4 Section 7 (1/4 Sec. and Sec. No.)
21N (Twp.)
4N (Range)
E.C. White (Name)
Wildcat (Dakota) (Field)
Sandoval (County or Subdivision)
New Mexico (State or Territory)

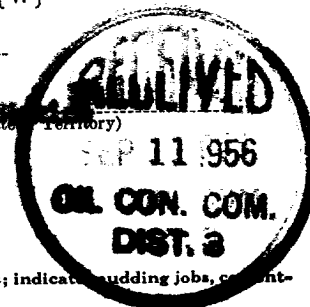

The elevation of the derrick floor above sea level is _____ ft.

DETAILS OF WORK

(State names of and expected depths to objective sands; show sizes, weights, and lengths of proposed casings; indicate clogging jobs, cementing points, and all other important proposed work)

It is our intention to drill well No. 1 to approximately 6400' to test the Dakota formation. Our casing program is as follows:

300' of surface casing (10-3/4") - cemented with 300 lbs. reg. cement - circulated.

6400' of 5-1/2" OD casing - cemented with 300 lbs. reg. cement.

The designated drilling unit is the N 1/4 of Section 7 - 21N - 4N, Sandoval County, New Mexico.

I understand that this plan of work must receive approval in writing by the Geological Survey before operations may be commenced.

Company Shelly Oil Company

Address Box 426

Farmington, New Mexico

By J. E. Boyer

Title District Foreman

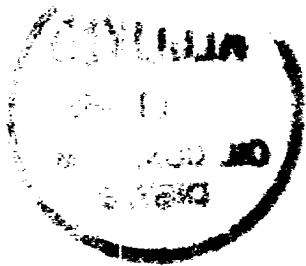

NEW MEXICO
OIL CONSERVATION COMMISSION

Form C-128

Well Location and/or Gas Proration Plat

Date September 4, 1956

Operator SKELLY OIL COMPANY Lease R. C. WHITE

Well No. 1 Section 7 Township 21 NORTH Range 4 WEST, NMPM

Located 1980 Feet From the NORTH Line, 1980 Feet From the WEST Line,

SANDOVAL County, New Mexico. G. L. Elevation _____

Name of Producing Formation Dakota Pool Wildcat Dedicated Acreage 160

(Note: All distances must be from outer boundaries of Section)

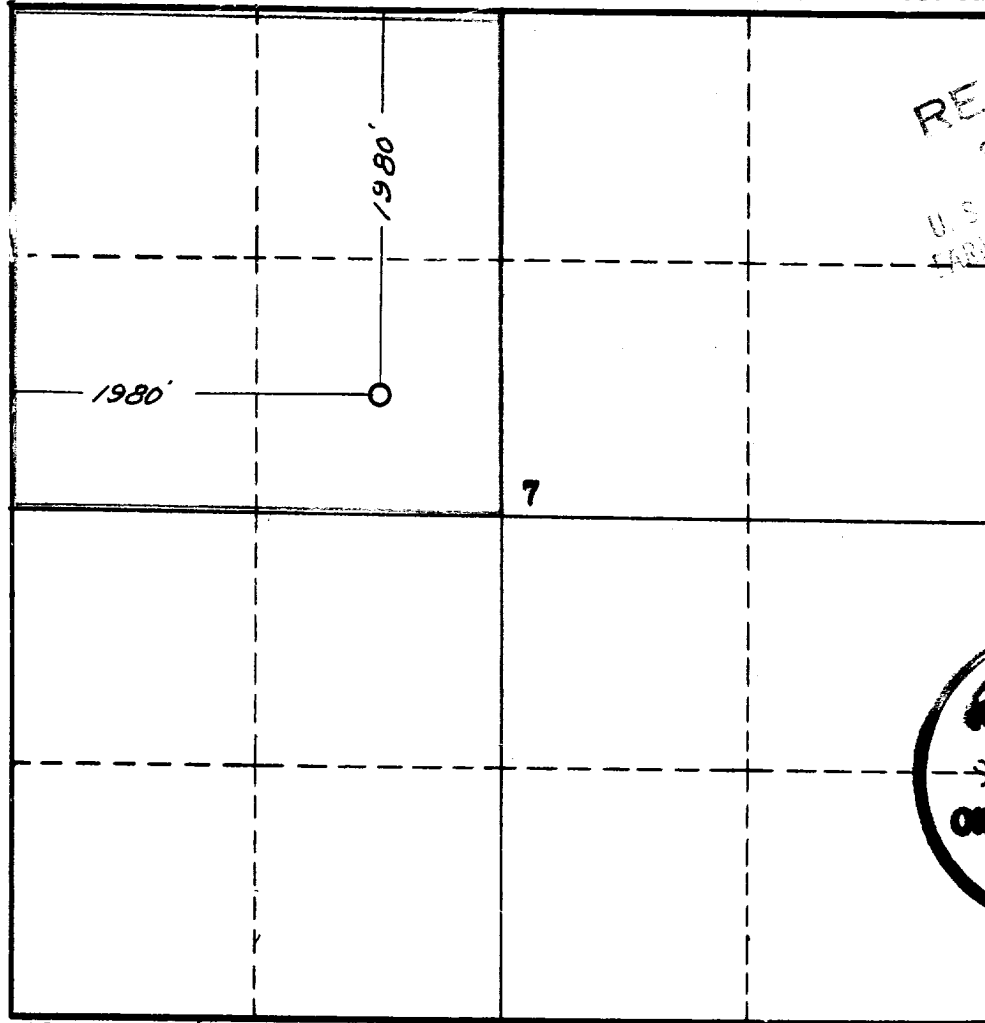

NOTE

This section of form is to be used for gas wells only.



1. Is this Well a Dual Comp. ? Yes ___ No X.
2. If the answer to Question 1 is yes, are there any other dually completed wells within the dedicated acreage ? Yes ___ No ___.

Name P. E. Leese
Position District Foreman
Representing Skelly Oil Company
Address Box 426, Farmington, New Mexico

This is to certify that the above plat was prepared from field notes of actual surveys made by me or under my supervision and that the same are true and correct to the best of my knowledge and belief.

Date Surveyed 29 AUGUST 1956
James P. Leese
Registered Professional Engineer and/or
Land Surveyor James P. Leese
N. Mex. Reg. No. 1463