

(SUBMIT IN TRIPLICATE)

Indian Agency

Ticacilla Tribal

UNITED STATES  
DEPARTMENT OF THE INTERIOR  
GEOLOGICAL SURVEY

Allottee

Lease No.

Contract No. 18  
Tract No. 26

## SUNDRY NOTICES AND REPORTS ON WELLS

NOTICE OF INTENTION TO DRILL	<input checked="" type="checkbox"/>	SUBSEQUENT REPORT OF WATER SHUT-OFF
NOTICE OF INTENTION TO CHANGE PLANS	<input type="checkbox"/>	SUBSEQUENT REPORT OF SHOOTING OR ACIDIZING
NOTICE OF INTENTION TO TEST WATER SHUT-OFF	<input type="checkbox"/>	SUBSEQUENT REPORT OF ALTERING
NOTICE OF INTENTION TO REDRILL OR REPAIR WELL	<input type="checkbox"/>	SUBSEQUENT REPORT OF REDRILLING OR REPAIR
NOTICE OF INTENTION TO SHOOT OR ACIDIZE	<input type="checkbox"/>	SUBSEQUENT REPORT OF ABANDONMENT
NOTICE OF INTENTION TO PULL OR ALTER CASING	<input type="checkbox"/>	SUPPLEMENTARY WELL HISTORY
NOTICE OF INTENTION TO ABANDON WELL	<input type="checkbox"/>	

(INDICATE ABOVE BY CHECK MARK NATURE OF REPORT, NOTICE, OR OTHER DATA)

November 6, 1954

Well No. 1 is located 990 ft. from N line and 990 ft. from E line of sec. 32  
NE 1/4 32 23-N R-4-W N.M.P.M.  
(1/4 Sec. and Sec. No.) (Twp.) (Range) (Meridian)  
Wildcat Sandoval New Mexico  
(Field) (County or Subdivision) (State or Territory)

The elevation of the derrick floor above sea level is 6958 ft. Ungraded Ground Elev. 6946'

## DETAILS OF WORK

(State names of and expected depths to objective sands; show sizes, weights, and lengths of proposed casings; indicate mudlogging jobs, cementing points, and all other important proposed work)

Will drill a well to approximately 7850' to test the Entrada Formation unless oil or gas in paying quantities is encountered at a lesser depth, in which event the well be completed at the lesser depth. Will set 300' of 13-3/8" surface casing cement to be circulated. If commercial production is indicated in the Entrada, will set approximately 7850' of 5-1/2" production casing, cemented with 500 sax. If production is encountered at a lesser depth casing will be set and cemented to said lesser depth.

I understand that this plan of work must receive approval in writing by the Geological Survey before operations may be commenced.

Company FRED TURNER, JR.Address Box 910 - Midland, Texas

By

Title

Company FRED TURNER, JR.

Lease \_\_\_\_\_ Well No. \_\_\_\_\_

Sec. 32, T. 23 N, R. 4 W, N.M.P.M.

Location 990' from the North line and 990' from the East line.

Elevation 6946 Ungraded ground.

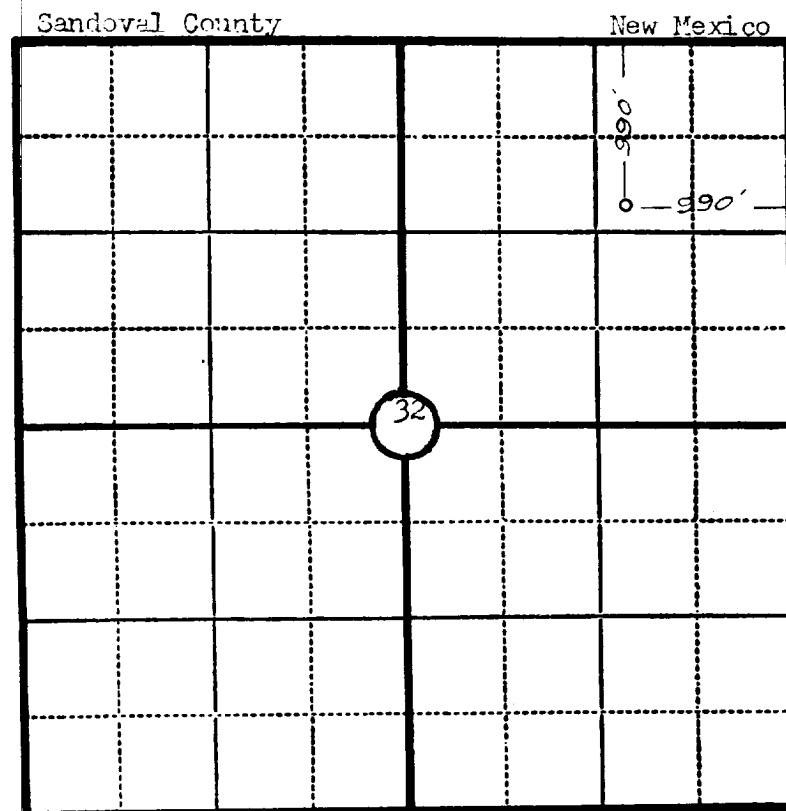

Scale—4 inches equal 1 mile.

This is to certify that the above plat was prepared from field notes of actual surveys made by me or under my supervision and that the same are true and correct to the best of my knowledge and belief.

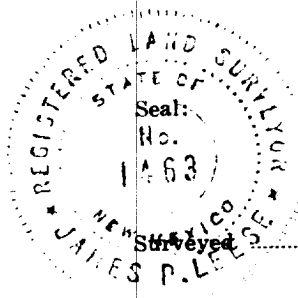

*James P. Leese*  
Registered Professional  
Engineer and Land Surveyor.

James P. Leese  
N. Mex. Reg. No. 1463

28 October 1954