



COPY TO O.C.G.

IN REPLY REFER TO:

UNITED STATES
DEPARTMENT OF THE INTERIOR
GEOLOGICAL SURVEY
P. O. Box 945
Farmington, New Mexico

May 8, 1956

Caswell Silver
323 Simms Building
Albuquerque, New Mexico

Re: Jicarilla Contract 54
Tract 104

Gentlemen:

Receipt is acknowledged of your "Notice of Intention to Drill" dated May 8, 1956 covering your well No. 1-33 Jicarilla in SE 1/4 sec. 33, T. 23 N., R. 3 W., N. M. P. M., Sandoval County, New Mexico, Unnamed pool.

Your proposed work is hereby approved subject to compliance with the provisions of the "Oil and Gas Leasing Regulations" revised May 28, 1942, a copy of which will be sent to you on request, and subject to the following conditions:

1. Drilling operations so authorized are subject to the attached sheet for general conditions of approval.
2. Furnish copies of all logs.

Very truly yours,

Jerry W. Long
Acting District Engineer



J. Long:ac
cc - Jicarilla Agency

UNITED STATES
DEPARTMENT OF THE INTERIOR
GEOLOGICAL SURVEY



(SUBMIT IN TRIPLICATE)

UNITED STATES
DEPARTMENT OF THE INTERIOR
GEOLOGICAL SURVEY

Indian Agency _____

Jicarilla Apache

Allottee _____

Lease ~~Contract~~ No. **14**
Tract No. **14**

SUNDRY NOTICES AND REPORTS ON WELLS

NOTICE OF INTENTION TO DRILL.....	<input checked="" type="checkbox"/>	SUBSEQUENT REPORT OF WATER SHUT-OFF.....	
NOTICE OF INTENTION TO CHANGE PLANS.....		SUBSEQUENT REPORT OF SHOOTING OR ACIDIZING.....	
NOTICE OF INTENTION TO TEST WATER SHUT-OFF.....		SUBSEQUENT REPORT OF ALTERING CASING.....	
NOTICE OF INTENTION TO REDRILL OR REPAIR WELL.....		SUBSEQUENT REPORT OF REDRILLING OR REPAIR.....	
NOTICE OF INTENTION TO SHOOT OR ACIDIZE.....		SUBSEQUENT REPORT OF ABANDONMENT.....	
NOTICE OF INTENTION TO PULL OR ALTER CASING.....		SUPPLEMENTARY WELL HISTORY.....	
NOTICE OF INTENTION TO ABANDON WELL.....			

(INDICATE ABOVE BY CHECK MARK NATURE OF REPORT, NOTICE, OR OTHER DATA)

May 2, 1956

Jicarilla

Well No. **1-33** is located **790** ft. from **N** line and **990** ft. from **E** line of sec. **33**

SW NE NE, Sec. 33
(1/4 Sec. and Sec. No.)

23N
(Twp.)

3W
(Range)

NMPM
(Meridian)

Unmanned
(Field)

Sandoval
(County or Subdivision)

New Mexico
(State or Territory)

The elevation of the derrick floor above sea level is **7357** ft.

DETAILS OF WORK

(State names of and expected depths to objective sands; show sizes, weights, and lengths of proposed casings; indicate mudding jobs, cementing points, and all other important proposed work)

Pictured Cliffs Test--Drill 12 inch surface hole, set 100 feet of 8 5/8 inch surface pipe circulated to surface with 90 sacks cement. Drill 6 3/4 inch hole to depth of approximately 3200 feet. Run 3200 feet 4 1/2 inch O. D. 9 1/2 lb. casing to total depth, cemented with 100 sacks of cement. Perforate Pictured Cliffs horizon, fracture formation with 30,000 gallons of water and 25,000 lbs. of sand. Clean out, run tubing and complete.

I understand that this plan of work must receive approval in writing by the Geological Survey before operations may be commenced.

Company **CASWELL SILVER**

Address **323 Simms Building**
Albuquerque, New Mexico

Caswell Silver
By *M. J. Lawrence*

Title **Operator**

NEW MEXICO
OIL CONSERVATION COMMISSION

Form C-128

Well Location and/or Gas Proration Plat

Date May 7, 1956

Operator Caswell Silver Lease Jicarilla Tribal Lease, Contract No. 54
Tract No. 104

Well No. 1-33 Section 33 Township 23N Range 3W NMPM

Located 990 Feet From East Line, 790 Feet From North Line,

Sandoval County, New Mexico. G. L. Elevation 7350

Name of Producing Formation Pictured Cliffs Pool Unnamed Dedicated Acreage 160

(Note: All distances must be from outer boundaries of Section)

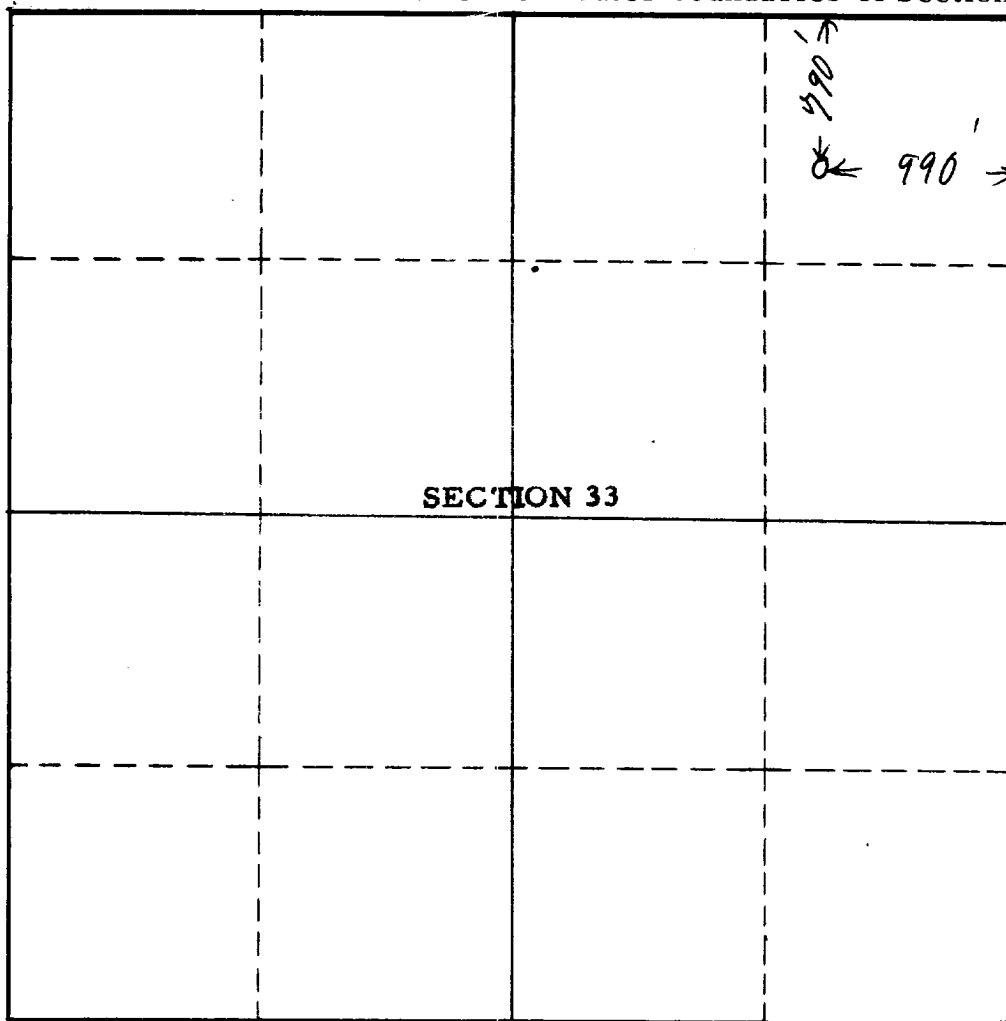

SCALE: 1"=1000'

1. Is this Well a Dual Comp. ? Yes ___ No x.
2. If the answer to Question 1 is yes, are there any other dually completed wells within the dedicated acreage? Yes ___ No ___.

This is to certify that the above plat was prepared from field notes of actual surveys made by me or under my supervision and that the same are true and correct to the best of my knowledge and belief.

Name Caswell Silver
Position Operator
Representing _____
Address 323 Simms Building
Albuquerque, New Mexico

Date Surveyed May 6, 1956
[Signature]
Registered Professional Engineer and/or
Land Surveyor