

(SUBMIT IN TRIPLICATE)

UNITED STATES  
DEPARTMENT OF THE INTERIOR  
GEOLOGICAL SURVEY

Indian Agency Jicarilla

Salas, New Mexico

Allottee \_\_\_\_\_

Lease No. Jicarilla Tribal  
Lease No. 163

SUNDRY NOTICES AND REPORTS ON WELLS

NOTICE OF INTENTION TO DRILL	<input checked="" type="checkbox"/>	SUBSEQUENT REPORT OF WATER SHUT-OFF	<div style="text-align: right;"> <b>RECEIVED</b>  <b>APR 5 1963</b>  <b>U. S. GEOLOGICAL SURVEY</b>  <b>FARMINGTON, NEW MEXICO</b> </div>
NOTICE OF INTENTION TO CHANGE PLANS	<input type="checkbox"/>	SUBSEQUENT REPORT OF SHOOTING OR ACIDIZING	
NOTICE OF INTENTION TO TEST WATER SHUT-OFF	<input type="checkbox"/>	SUBSEQUENT REPORT OF ALTERING CASING	
NOTICE OF INTENTION TO REDRILL OR REPAIR WELL	<input type="checkbox"/>	SUBSEQUENT REPORT OF REDRILLING OR REPAIR	
NOTICE OF INTENTION TO SHOOT OR ACIDIZE	<input type="checkbox"/>	SUBSEQUENT REPORT OF ABANDONMENT	
NOTICE OF INTENTION TO PULL OR ALTER CASING	<input type="checkbox"/>	SUPPLEMENTARY WELL HISTORY	
NOTICE OF INTENTION TO ABANDON WELL	<input type="checkbox"/>		

(INDICATE ABOVE BY CHECK MARK NATURE OF REPORT, NOTICE, OR OTHER DATA)

April 3, 1963

Jicarilla "T" No. 163  
Well No. 1 is located 1830 ft. from [N] line and 1450 ft. from [E] line of sec. 27  
NE/4 Section 27 23 North 2 West  
(1/4 Sec. and Sec. No.) (Twp.) (Range) (Meridian)  
Undesignated PG Sandoval County New Mexico  
(Field) (County or Subdivision) (State or Territory)

The elevation of the ground floor above sea level is 7322 ft.

DETAILS OF WORK

(State names of and expected depths to objective sands; show sizes, weights, and lengths of proposed casings; indicate mudding logs, ing points, and all other important proposed work)

To set approximately 100 feet of 8 5/8" surface casing and cement with approximately 60 sacks. To drill with rotary tools to an approximate depth of 3400'. To run an electric log and if productive, to set approximately 3400' of 4 1/2" new casing and cement with approximately 100 sacks. To perforate the Pictured Cliffs pay zone and sand-water frac same. To run approximately 3350' of 1 1/4" EUE tubing and to complete and produce as a Pictured Cliffs Gas Producer.

To comply with the rules and regulations of the U.S. G. S. and New Mexico Oil and Gas Commission.

I understand that this plan of work must receive approval in writing by the Geological Survey before operations may be commenced.

Company Sher-Alan Oil Company

Address 1402 Denver U. S. National Center

Denver, Colorado

By \_\_\_\_\_

Richard S. Hunt  
Title Mgr. of Lands & Explorations

ORIGINAL SIGNED BY  
RICHARD S. HUNT

## NEW MEXICO OIL CONSERVATION COMMISSION

## Well Location and Acreage Dedication Plat

Section A.

Date **April 3, 1963**

Operator **SHAR ALAN OIL COMPANY** Lease **JICARILLA "P"**  
 Well No. **1** Unit Letter **G** Section **27** Township **23 NORTH** Range **2 WEST** NMPM  
 Located **1850** Feet From **the NORTH** Line, **1450** Feet From **the EAST** Line  
 County **SANDOVAL** G. L. Elevation **7322.1** Dedicated Acreage **160** Acres  
 Name of Producing Formation **Pictured Cliffs** Pool **Undesignated PC**

1. Is the Operator the only owner in the dedicated acreage outlined on the plat below?  
 Yes ☒ No ☐
2. If the answer to question one is "no", have the interests of all the owners been consolidated by communitization agreement or otherwise? Yes ☐ No ☐ If answer is "yes", Type of Consolidation.
3. If the answer to question two is "no", list all the owners and their respective interests below:

Owner

Land Description

Section B.

Note: All distances must be from outer boundaries of aquifer.

This is to certify that the information in Section A above is true and complete to the best of my knowledge and belief.

**Shar-Alan Oil Company** ORIGINAL SIGNED BY

(Operator) **RICHARD S. HUNT**

**Richard S. Hunt, Mgr. of Lands &**

(Representative) **Explorations**

**1401 Denver U. S. Nat'l Center**

(Address)

**Denver, Colorado**

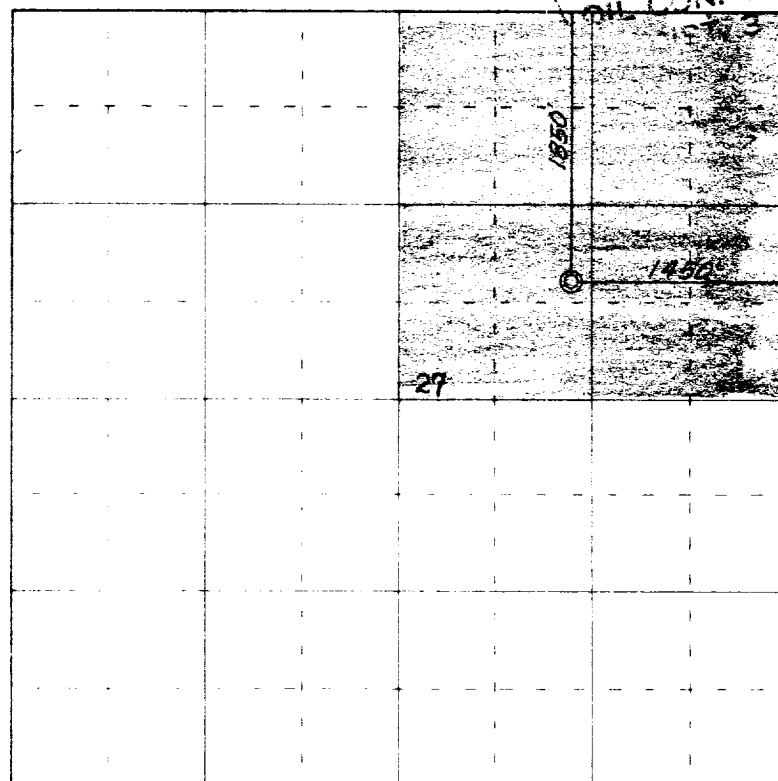

0 330 660 990 1320 1650 1980 2310 2640 2000 1500 1000 500 0

Scale 4 inches equal 1 mile

This is to certify that the above plat was prepared from field notes of actual surveys made by me or under my supervision and that the same are true and correct to the best of my knowledge and belief.

Date Surveyed **28 March 1963**

**James P. Leese**  
 Registered Professional Engineer and/or Land Surveyor  
 James P. Leese, N. Mex. Reg. No. 1463

Farmington, New Mexico