

(SUBMIT IN TRIPLICATE)

UNITED STATES
DEPARTMENT OF THE INTERIOR
GEOLOGICAL SURVEY

Budget Bureau 42-R358.3
Approval expires 12-31-55.

Land Office Santa Fe

Lease No. 078360

Unit Federal Rogers Block

Santa Fe 078360

Sec. 24

SUNDRY NOTICES AND REPORTS ON WELLS

NOTICE OF INTENTION TO DRILL	<input checked="" type="checkbox"/>	SUBSEQUENT REPORT OF WATER SHUT-OFF
NOTICE OF INTENTION TO CHANGE PLANS	<input type="checkbox"/>	SUBSEQUENT REPORT OF SHOOTING OR ACIDIZING
NOTICE OF INTENTION TO TEST WATER SHUT-OFF	<input type="checkbox"/>	SUBSEQUENT REPORT OF ALTERING CASING
NOTICE OF INTENTION TO RE-DRILL OR REPAIR WELL	<input type="checkbox"/>	SUBSEQUENT REPORT OF RE-DRILLING OR REPAIR
NOTICE OF INTENTION TO SHOOT OR ACIDIZE	<input type="checkbox"/>	SUBSEQUENT REPORT OF ABANDONMENT
NOTICE OF INTENTION TO PULL OR ALTER CASING	<input type="checkbox"/>	SUPPLEMENTARY WELL HISTORY
NOTICE OF INTENTION TO ABANDON WELL	<input type="checkbox"/>	

(INDICATE ABOVE BY CHECK MARK NATURE OF REPORT, NOTICE, OR OTHER DATA)

November 16, 1956

Well No. 1 is located 1280 ft. from N line and 660 ft. from E line of sec. 24

Sec. 24 23 7 NA
(G. Sec. and Sec. No.) (Twp.) (Range) (Meridian)

Federal Rogers Block 078360 San Juan New Mexico
(Field) (County or Subdivision) (State or Territory)

The elevation of the derrick floor above sea level is _____ ft. will advise

DETAILS OF WORK

(State names of and expected depths to objective sands; show sizes, weights, and lengths of proposed casings; indicate mudlogging jobs, cementing points, and all other important proposed work)

It is proposed to drill this well with rotary tools to an approximate depth of 6500' to test the Gallup-Tacito and Dakota Sands. Approximately 300' of 10 3/4" 32# surface casing will be set and cemented to surface. If commercial production is encountered, a 5" O.S. production string will be set and cemented and the well completed in a conventional manner.

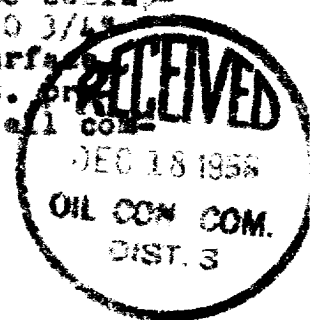

I understand that this plan of work must receive approval in writing by the Geological Survey before operations may be commenced.

Company Continental Oil Company

Address Box 206

Craig, Colorado

By _____

Title District Superintendent

NEW MEXICO
OIL CONSERVATION COMMISSION

Form C-128

Well Location and/or Gas Proration Plat

Date December 3, 1956

Operator Continental Oil Company Lease Federal Rodgers

Well No. C-1 Section 24 Township 23N Range 7W NMPM

Located 1980 Feet From north Line, 660 Feet From west Line,

Sandoval County, New Mexico. G. L. Elevation 6970

Name of Producing Formation _____ Pool _____ Dedicated Acreage _____

(Note: All distances must be from outer boundaries of Section)

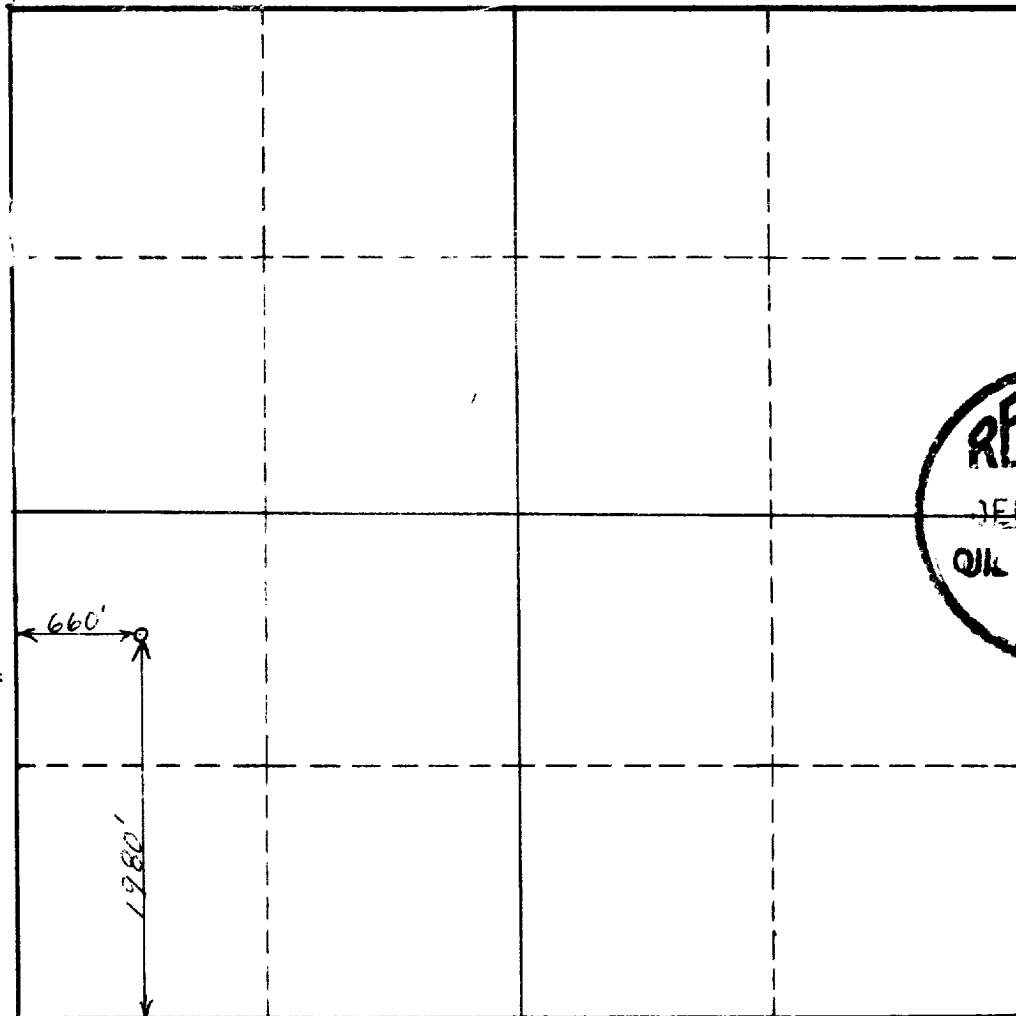

NOTE

This section of form is to be used for gas wells only.



SCALE: 1"=1000'

1. Is this Well a Dual Comp. ? Yes ___ No ___.
2. If the answer to Question 1 is yes, are there any other dually completed wells within the dedicated acreage? Yes ___ No ___.

Name _____
Position _____
Representing _____
Address _____

This is to certify that the above plat was prepared from field notes of actual surveys made by me or under my supervision and that the same are true and correct to the best of my knowledge and belief.

Date Surveyed Nov. 9, 1956
Harold W. Burd
Registered Professional Engineer and/or
Land Surveyor Wyo. No. 425