

Form 9-331b
(April 1952)

Sec. 20

(SUBMIT IN TRIPLICATE)

Indian Agency Marathon

County Marathon

Allottee _____

Lease No. Marathon 77

UNITED STATES
DEPARTMENT OF THE INTERIOR
GEOLOGICAL SURVEY

1		

SUNDRY NOTICES AND REPORTS ON WELLS

NOTICE OF INTENTION TO DRILL	SUBSEQUENT REPORT OF WATER SHUT-OFF
NOTICE OF INTENTION TO CHANGE PLANS	SUBSEQUENT REPORT OF SHOOTING OR ACIDIZING
NOTICE OF INTENTION TO TEST WATER SHUT-OFF	SUBSEQUENT REPORT OF ALTERING CASING
NOTICE OF INTENTION TO REDRILL OR REPAIR WELL	SUBSEQUENT REPORT OF REDRILLING OR REPAIR
NOTICE OF INTENTION TO SHOOT OR ACIDIZE	SUBSEQUENT REPORT OF ABANDONMENT
NOTICE OF INTENTION TO PULL OR ALTER CASING	SUPPLEMENTARY WELL HISTORY
NOTICE OF INTENTION TO ABANDON WELL	

(INDICATE ABOVE BY CHECK MARK NATURE OF REPORT, NOTICE, OR OTHER DATA)

September 24, 1958

Well No. 2 is located 990 ft. from N line and 990 ft. from W line of Sec. 20

Marathon
(4 Sec. and Sec. No.)

Marathon
(Twp.)

Marathon
(Range)

Marathon
(Meridian)

Marathon
(Field)

Marathon
(County or Subdivision)

Marathon
(State or Territory)

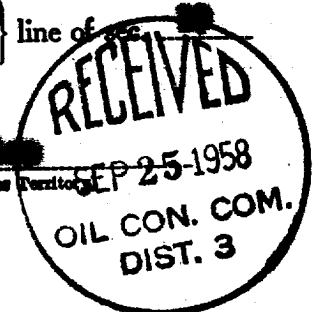

The elevation of the derrick floor above sea level is 940 ft.

DETAILS OF WORK

(State names of and expected depths to objective sands; show sizes, weights, and lengths of proposed casings; indicate mudding jobs, cementing points, and all other important proposed work)

We propose to drill the above well to a total depth of approximately 3,400' with rotary tools. We expect to test the following sands at the approximate depths:

Marathon Marathon
Marathon Marathon

Section 20, Marathon
Set approximately 300' of 2 1/2" surface casing with approximately 200 lbs cement.
Set approximately 3,400' of 2 1/2" casing with approximately 200 lbs. We propose to perforate and sand water flow for completion in the Marathon section. We expect to test any other sands that appear productive of oil or gas.

I understand that this plan of work must receive approval in writing by the Geological Survey before operations may be commenced.

Company Marathon Petroleum Company

Address Box 2406

Marathon, Texas

By [Signature]

Title Marathon Representative

NEW MEXICO OIL CONSERVATION COMMISSION

Well Location and Acreage Dedication Plat

Section A.

Date Sept. 22, 1958

Operator MAGNOLIA PETROLEUM COMPANY Lease JICARILLA "1"
Well No. 1 Unit Letter Section 12 Township 22N Range 22E NTPM
Located 280 Feet From North Line, 990 Feet From West Line
County Sandoval G. L. Elevation 7397 Dedicated Acreage 12.2 Acres
Name of Producing Formation Platoned Cliff's Pool Undesignated

1. Is the Operator the only owner in the dedicated acreage outlined on the plat below?
Yes X No .
2. If the answer to question one is "no," have the interests of all the owners been consolidated by communitization agreement or otherwise? Yes No . If answer is "yes," Type of Consolidation .
3. If the answer to question two is "no," list all the owners and their respective interests below:

Owner

Land Description

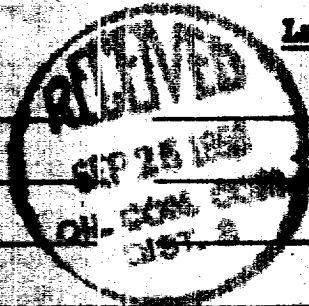

RECEIVED
SEP 24 1958
GEOLOGICAL SURVEY
NEW MEXICO

Section B.

East

Magnolia Pet. Co.
NM-1200

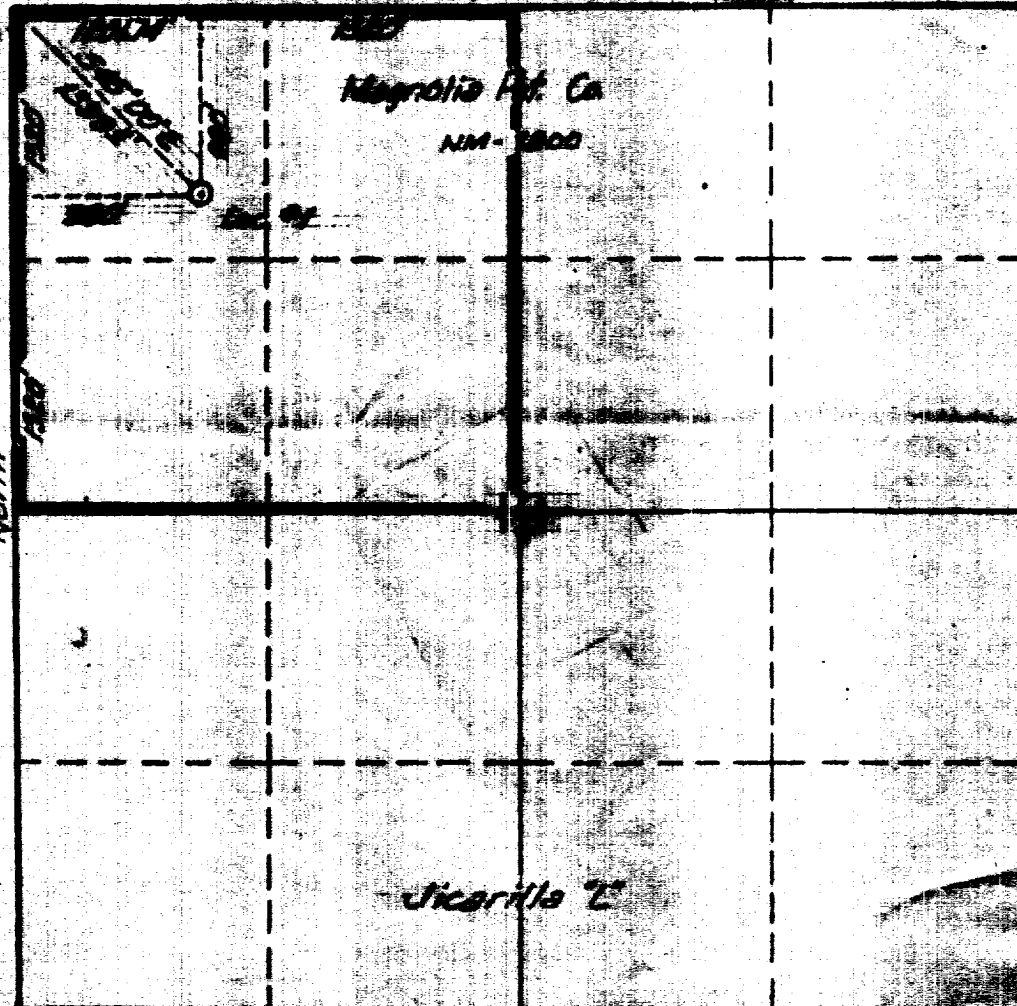

This is to certify that the information in Section A above is true and complete to the best of my knowledge and belief.

MAGNOLIA PETROLEUM COMPANY
(Operator)

Representative

Box 2405, Hobbs, New Mexico
Address

This is to certify that the well location shown on the plat in Section B was plotted from field notes of actual surveys made by me or under my supervision and that the same is true and correct to the best of my knowledge and belief.

State Surveyed State Pl. 1958
Registered Professional
Geologist and/or Land Surveyor.

Certificate No. 2490