

(SUBMIT IN TRIPLICATE)

UNITED STATES
DEPARTMENT OF THE INTERIOR
GEOLOGICAL SURVEYBudget Bureau No. 42-R358.4.
Approval expires 12-31-60.Land Office Santa Fe, New MexicoLease No. SP 979150Unit Duff Federal "B"

1		

SUNDRY NOTICES AND REPORTS ON WELLS

NOTICE OF INTENTION TO DRILL.....	<input checked="" type="checkbox"/>	SUBSEQUENT REPORT OF WATER SHUT-OFF.....
NOTICE OF INTENTION TO CHANGE PLANS.....		SUBSEQUENT REPORT OF SHOOTING OR ACIDIZING.....
NOTICE OF INTENTION TO TEST WATER SHUT-OFF.....		SUBSEQUENT REPORT OF ALTERING CASING.....
NOTICE OF INTENTION TO RE-DRILL OR REPAIR WELL.....		SUBSEQUENT REPORT OF RE-DRILLING OR REPAIR.....
NOTICE OF INTENTION TO SHOOT OR ACIDIZE.....		SUBSEQUENT REPORT OF ABANDONMENT.....
NOTICE OF INTENTION TO PULL OR ALTER CASING.....		SUPPLEMENTARY WELL HISTORY.....
NOTICE OF INTENTION TO ABANDON WELL.....		

RECEIVED
JUL 21 1959
U. S. GEOLOGICAL SURVEY
FARMINGTON, NEW MEXICO

(INDICATE ABOVE BY CHECK MARK NATURE OF REPORT, NOTICE, OR OTHER DATA)

July 26, 1959

Well No. 1 is located 990 ft. from N line and 990 ft. from W line of sec. 19

<u>NW 1/4 Sec. 19</u> (1/4 Sec. and Sec. No.)	<u>23N</u> (Twp.)	<u>1W</u> (Range)	<u>RPM</u> (Meridian)	<u>New Mexico</u> (State or Territory)
<u>Undesignated Pictured Cliffs</u> (Field)	<u>Sandoval</u> (County or Subdivision)			

The elevation of the 6.1 above sea level is 7346 ft.

DETAILS OF WORK

(State names of and expected depths to objective sands; show sizes, weights, and lengths of proposed casings; indicate mudlogging jobs, cementing points, and all other important proposed work)

Propose to drill the above located well to a total depth of approximately 3300' with rotary tools.

CASING PATTERN

Set approximately 350' of 8-5/8" csg., cement w/200 lbs. cement.

Set approximately 3300' of 4-1/2" csg., cement w/150 lbs. cement.

Propose to sand oil frac for completion and to test any other zone that appears productive of oil or gas.

Designation of Operator in triplicate and cond of Oil & Gas Lease are attached.

I understand that this plan of work must receive approval in writing by the Geological Survey before operations may be commenced.

Company Magnolia Petroleum CompanyAddress Box 2406Hobbs, New Mexico

By

Title District Superintendent

NEW MEXICO OIL CONSERVATION COMMISSION
Well Location and Acreage Dedication Plat

Section A.

Date July 26, 1959

Operator MAGNOLIA PETROLEUM COMPANY Lease Duff-Federal "B"
Well No. 1 Unit Letter Section 19 Township 23N Range 1W
Located 990 Feet From West Line, 990 Feet From North Line
County Sandoval G. L. Elevation 7346 Dedicated Acreage 151.74
Name of Producing Formation Pictured Cliffs Pool Undesignated

1. Is the Operator the only owner* in the dedicated acreage outlined on the plat below?
Yes No .
2. If the answer to question one is "no," have the interests of all the owners been consolidated by communitization agreement or otherwise? Yes No . If answer is "yes," Type of Consolidation
3. If the answer to question two is "no," list all the owners and their respective interests below:

Owner

Land Description

Section B.

East - 72.33 - 19

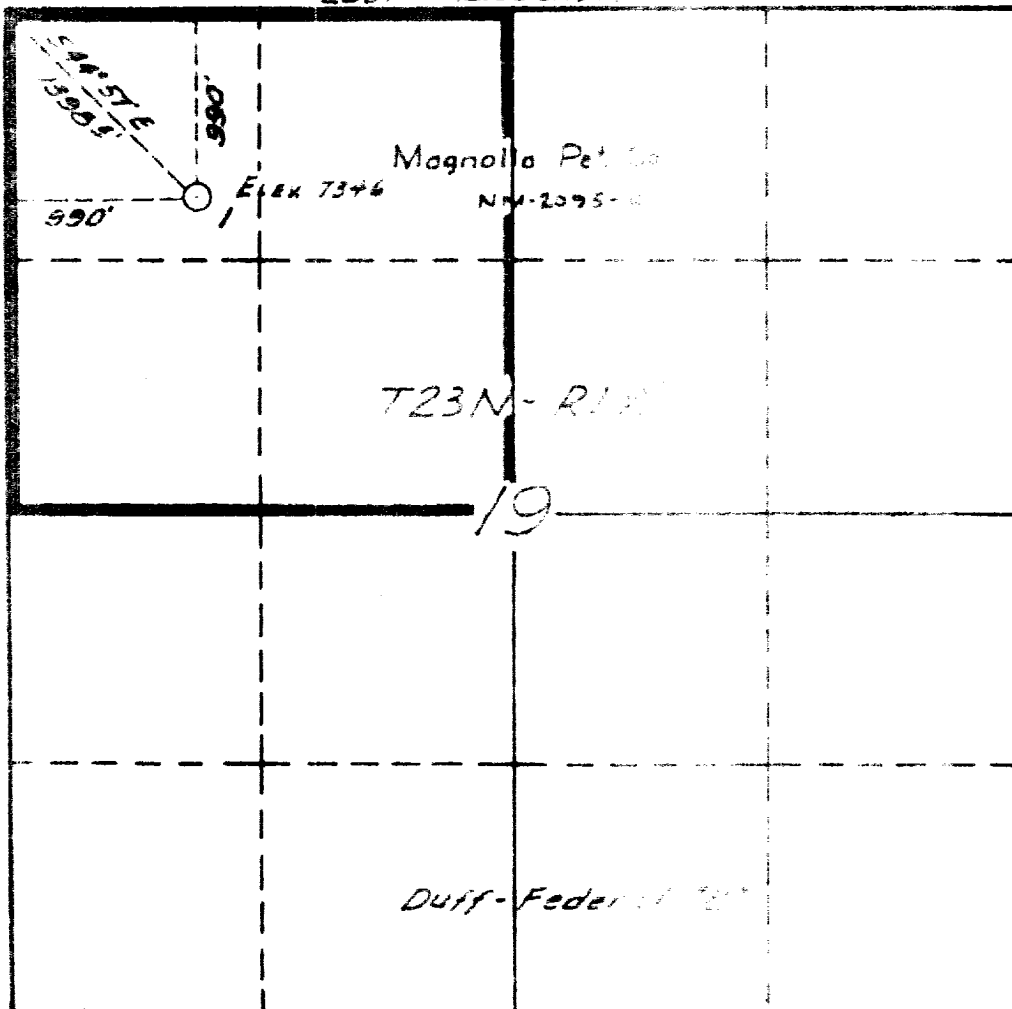

This is to certify that the information in Section A above is true and complete to the best of my knowledge and belief.

MAGNOLIA PETROLEUM COMPANY

(Operator)

W. Young, Jr.
(Representative)

Box 120, 1380, Santa Fe, N.M.

Address

This is to certify that the well location shown on the plat in Section B was plotted from field notes of actual surveys made by me or under my supervision and that the same is true and correct to the best of my knowledge and belief.

Date Surveyed July 26, 1959

Carl E. Turner
Registered Professional
Engineer and/or Land Surveyor.

Certified to be