

UNITED STATES  
DEPARTMENT OF THE INTERIOR  
GEOLOGICAL SURVEY

## APPLICATION FOR PERMIT TO DRILL, DEEPEN, OR PLUG BACK

## 1a. TYPE OF WORK

DRILL ☒DEEPEN ☐PLUG BACK ☐

## b. TYPE OF WELL

OIL  
WELL☒ orGAS  
WELL☒

OTHER

SINGLE  
ZONE ☒MULTIPLE  
ZONE

## 2. NAME OF OPERATOR

Bco., Inc.

Harry L. Bigbee

## 3. ADDRESS OF OPERATOR

P. O. Box 669, Santa Fe, New Mexico

4. LOCATION OF WELL (Report location clearly and in accordance with any State requirements.\*)  
At surface2310' FSL 990' FWL Sec. 13, T19N, R3W NMPM  
At proposed prod. zone

## 14. DISTANCE IN MILES AND DIRECTION FROM NEAREST TOWN OR POST OFFICE\*

Two miles from Johnson's Trading post, 17 miles from Cuba, N.M.

## 15. DISTANCE FROM PROPOSED\*

LOCATION TO NEAREST  
PROPERTY OR LEASE LINE, FT.  
(Also to nearest drlg. line, if any)

## 16. NO. OF ACRES IN LEASE

720

17. NO. OF ACRES ASSIGNED  
TO THIS WELL

40

## 18. DISTANCE FROM PROPOSED LOCATION\*

TO NEAREST WELL, DRILLING, COMPLETED,  
OR APPLIED FOR, ON THIS LEASE, FT.

## 19. PROPOSED DEPTH

5650

## 20. ROTARY OR CABLE TOOLS

Rotary

## 21. ELEVATIONS (Show whether DF, RT, GR, etc.)

7027 Gr.

## 22. APPROX. DATE WORK WILL START\*

10-28-1963

## 23.

## PROPOSED CASING AND CEMENTING PROGRAM

SIZE OF HOLE	SIZE OF CASING	WEIGHT PER FOOT	SETTING DEPTH	QUANTITY OF CEMENT
11"	8 5/8"	24	120	70 sacks 3/4 CaCl
6 3/4"	4 1/2"	9.5	5650	150 sacks 3/4 CaCl

Plan to drill a 11" hole to 120 feet. Set 8 5/8" casing at 120 feet, and cement to surface. Drill 6 3/4" hole to a total depth of 5600 feet to test the Entrada formation. If completion is made, 4 1/2" casing will be run to total depth.



IN ABOVE SPACE DESCRIBE PROPOSED PROGRAM: If proposal is to deepen or plug back, give data on present productive zone and proposed new productive zone. If proposal is to drill or deepen directionally, give pertinent data on subsurface locations and measured and true vertical depths. Give blowout preventer program, if any.

## 24.

SIGNED

Harry L. Bigbee

TITLE

Vice President

DATE

10-27-1963

(This space for Federal or State office use)

PERMIT NO.

APPROVAL DATE

APPROVED BY

TITLE

DATE

CONDITIONS OF APPROVAL, IF ANY:

\*See Instructions On Reverse Side

## NEW MEXICO OIL CONSERVATION COMMISSION

## Well Location and Acreage Dedication Plat

SECTION

Date

Operator Harry Bigbee Lease \_\_\_\_\_  
 Well No. \_\_\_\_\_ Unit Letter L Section 13 Township 19 North Range 3 West NMPM  
 Located 2310 Feet From South Line, 990 Feet From West Line  
 County Sandoval G. L. Elevation 7027 Dedicated Acreage 40 Acres  
 Name of Producing Formation Entrada Pool Wildcat

1. Is the Operator the only owner\* in the dedicated acreage outlined on the plat below? Yes X No \_\_\_\_\_
2. If the answer to question One is "No," have the interests of all the owners been consolidated by communitization agreement or otherwise? Yes \_\_\_\_\_ No \_\_\_\_\_. If answer is "Yes," Type of Consolidation \_\_\_\_\_
3. If the answer to question Two is "No," list all the owners and their respective interests below

OWNER

LAND DESCRIPTION

## SECTION B.

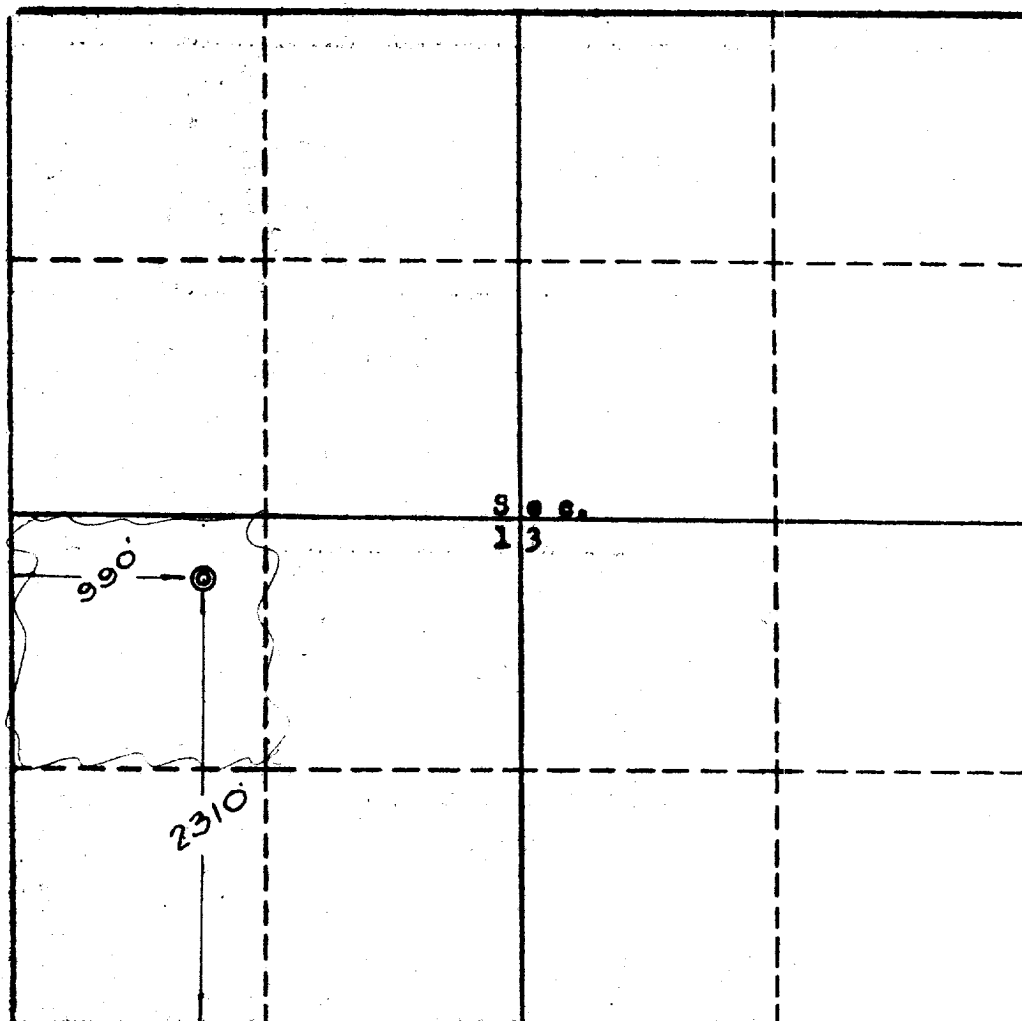

This is to certify that the information in Section A above is true and complete to the best of my knowledge and belief.

Harry L. Bigbee

(OPERATOR)

*Harry R. Bigbee*  
(REPRESENTATIVE)

Box 669

Santa Fe, New Mexico

(ADDRESS)

THIS IS TO CERTIFY THAT THE WELL LOCATION SHOWN ON THE PLAT IN SECTION B WAS PLOTTED FROM FIELD NOTES OF ACTUAL SURVEYING DONE BY OR UNDER MY SUPERVISION AND THAT THE SAME IS TRUE AND CORRECT TO THE BEST OF MY KNOWLEDGE AND BELIEF.

Date November 26, 1963

Four States Engineering Co.  
FARMINGTON, NEW MEXICO

*Edward E. Cawthorne*  
REGISTERED ENGINEER OR  
LAND SURVEYOR

Certificate No. 3602