

UNITED STATES
DEPARTMENT OF THE INTERIOR
GEOLOGICAL SURVEY

APPLICATION FOR PERMIT TO DRILL, DEEPEN, OR PLUG BACK

1a. TYPE OF WORK
 DRILL ☒ DEEPEN ☐ PLUG BACK ☐

b. TYPE OF WELL
 OIL WELL ☐ GAS WELL ☐ OTHER ☐ SINGLE ZONE ☐ MULTIPLE ZONE ☐

2. NAME OF OPERATOR
 Public Petroleum Company

3. ADDRESS OF OPERATOR
 400 30th Street, Bakersfield, California

4. LOCATION OF WELL (Report location clearly and in accordance with any State requirements.)*
 At surface 990 ft. fSL & 1650 ft. FWL of Sec. 35
 At proposed prod. zone As above

14. DISTANCE IN MILES AND DIRECTION FROM NEAREST TOWN OR POST OFFICE*
 25 miles south of Cuba, New Mexico

15. DISTANCE FROM PROPOSED* LOCATION TO NEAREST PROPERTY OR LEASE LINE, FT. (Also to nearest drig. unit line, if any) See 4

16. NO. OF ACRES IN LEASE 200

17. NO. OF ACRES ASSIGNED TO THIS WELL 10

18. DISTANCE FROM PROPOSED LOCATION* TO NEAREST WELL, DRILLING, COMPLETED, OR APPLIED FOR, ON THIS LEASE, FT.

19. PROPOSED DEPTH 900

20. ROTARY OR CABLE TOOLS Rotary

21. ELEVATIONS (Show whether DF, RT, GR, etc.) 6409 Gr

22. APPROX. DATE WORK WILL START* May 27, 1966

23. PROPOSED CASING AND CEMENTING PROGRAM				
SIZE OF HOLE	SIZE OF CASING	WEIGHT PER FOOT	SETTING DEPTH	QUANTITY OF CEMENT
6 1/2	4.5	9.5 lb	800	40 sks

Propose to drill a 900 foot well to test the Menefee sands of the Mesaverde formation. If production is encountered will run casing to total depth and complete by perforating. No pressure is present in the area and do not plan on setting surface casing.

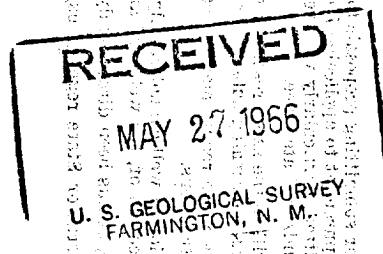

IN ABOVE SPACE DESCRIBE PROPOSED PROGRAM: If proposal is to deepen or plug back, give data on present productive zone and proposed new productive zone. If proposal is to drill or deepen directionally, give pertinent data on subsurface locations and measured and true vertical depths. Give blowout preventer program, if any.

24. SIGNED J. H. Fawcett TITLE President Public Pet. Co. DATE May 26, 1966

(This space for Federal or State office use)

PERMIT NO. FW 2-1003 APPROVAL DATE JUN 16 1966 OPERATIONS BY: ☐ RECORD LESSEE ☒ OF O. BY FILE JUN 16 1966

APPROVED BY P. T. McGrath TITLE SUPERVISOR DIST. #3 ☒ OF O. ATTACHED ☐ BOND COVERAGE: ☒ \$1000 ATTACHED ☐ \$5,000 ON FILE ☐ LESSEE'S NATION-WIDE ☐ OPERATOR'S NATION-WIDE

CONDITIONS OF APPROVAL, IF ANY: NOT ENGINEER

Enc: 3 copies of Designation of Operator

*See Instructions On Reverse Side

RECEIVED

MAY 27 1966

U. S. GEOLOGICAL SURVEY
FARMINGTON, N. M.

NEW MEXICO OIL CONSERVATION COMMISSION
WELL LOCATION AND ACERAGE DEDICATION PLAT

All distances must be from the outer boundaries of the Section

Operator Public Petroleum Company			Lease <i>Franklin</i>		Well No. 1
Unit Letter N	Section 35	Township 18 North	Range 3 West	County Sandoval	
Actual Footage Location of Well: 990 feet from the South line and 1650 feet from the West line					
Ground Level Elev. 6409	Producing Formation	Pool	Dedicated Acreage: 46 Acres		

1. Outline the acreage dedicated to the subject well by colored pencil or hachure marks on the plat below.
2. If more than one lease is dedicated to the well, outline each and identify the ownership thereof (both as to working interest and royalty).
3. If more than one lease of different ownership is dedicated to the well, have the interests of all owners been consolidated by communitization, unitization, force-pooling, etc?

() Yes () No If answer is "yes," type of consolidation

If answer is "no," list the owners and tract descriptions which have actually consolidated. (Use reverse side of this form if necessary.)

No allowable will be assigned to the well until all interests have been consolidated (by communitization, unitization, forced-pooling, or otherwise) or until a non standard unit, eliminating such interests, has been approved by the Commission.

CERTIFICATION

I hereby certify that the information contained herein is true and complete to the best of my knowledge and belief.

Name

Position

Company

Date

J. H. Lawry
President of Public Petroleum Company
May 25, 1966

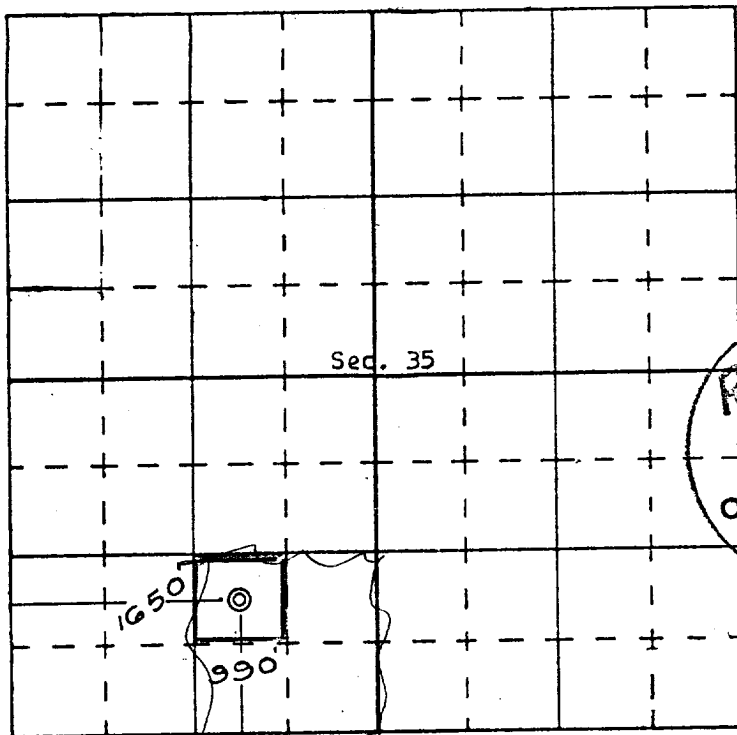

RECEIVED

JUN 16 1966

OIL CON. COM.
DIST. 3

I hereby certify that the well location shown on this plat was plotted from field notes of actual surveys made by me or under my supervision, and that the same is true and correct to the best of my knowledge and belief.

Date Surveyed

May 19, 1966

Registered Professional Engineer
and/or Land Surveyor

E. V. E. Hank
Certificate No. 3602