

Form 9-331a  
(Feb. 1951)

5 USGS  
1 Bigbee  
2 Val Reese  
1 File

Budget Bureau No. 42-R358.4.  
Form Approved.

Land Office Santa Fe

Lease No. NM 0103300

Unit \_\_\_\_\_

(SUBMIT IN TRIPLICATE)

UNITED STATES  
DEPARTMENT OF THE INTERIOR  
GEOLOGICAL SURVEY

SUNDRY NOTICES AND REPORTS ON WELLS

NOTICE OF INTENTION TO DRILL	<input checked="" type="checkbox"/>	SUBSEQUENT REPORT OF WATER SHUT-OFF
NOTICE OF INTENTION TO CHANGE PLANS	<input type="checkbox"/>	SUBSEQUENT REPORT OF SHOOTING OR ACIDIZING
NOTICE OF INTENTION TO TEST WATER SHUT-OFF	<input type="checkbox"/>	SUBSEQUENT REPORT OF ALTERING CASING
NOTICE OF INTENTION TO RE-DRILL OR REPAIR WELL	<input type="checkbox"/>	SUBSEQUENT REPORT OF RE-DRILLING OR REPAIR
NOTICE OF INTENTION TO SHOOT OR ACIDIZE	<input type="checkbox"/>	SUBSEQUENT REPORT OF ABANDONMENT
NOTICE OF INTENTION TO PULL OR ALTER CASING	<input type="checkbox"/>	SUPPLEMENTARY WELL HISTORY
NOTICE OF INTENTION TO ABANDON WELL	<input type="checkbox"/>	

(INDICATE ABOVE BY CHECK MARK NATURE OF REPORT, NOTICE, OR OTHER DATA)

November 1, 1962

Well No. Flint #1 is located 330 ft. from N line and 2310 ft. from W line of sec. 23

NW/4 NE/4 Sec. 23 T19N R3W NMPM  
(1/4 Sec. and Sec. No.) (Twp.) (Range) (Meridian)  
Wildcat Sandoval New Mexico  
(Field) (County or Subdivision) (State or Territory)

The elevation of the ~~derrick floor~~ <sup>ground level</sup> above sea level is 6843 ft.

DETAILS OF WORK

(State names of and expected depths to objective sands; show sizes, weights, and lengths of proposed casings; indicate mudding jobs, cementing points, and all other important proposed work)

Drill 12 1/4" hole to 120', run 8 5/8" O.D., 24#, J-55 Csg and cement w/65 sx.

Drill 7 7/8" O.D. hole to 2706', run 5 1/2" O.D., 14#, J-55 Csg and cement w/50 sx.

Drill 4 3/4" O.D. hole with air to 3111'.

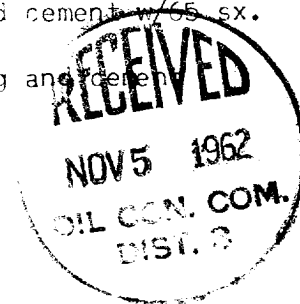

I understand that this plan of work must receive approval in writing by the Geological Survey before operations may be commenced.

Company Harry L. Bigbee

Address Box 669

Santa Fe, New Mexico

By [Signature]  
Title Production Superintendent

NEW MEXICO OIL CONSERVATION COMMISSION  
Well Location and Acreage Dedication Plat

## SECTION A.

Date October 31, 1962

Operator Harry L. Rigbee Lease Flint  
 Well No. 1 Unit Letter \_\_\_\_\_ Section 23 Township 19 North Range 3 West NMPM  
 Located 330 Feet From North Line, 2310 Feet From East Line  
 County Sandoval G. L. Elevation 6843 Dedicated Acreage 40 Acres  
 Name of Producing Formation Gallup Pool Wildcat

1. Is the Operator the only owner\* in the dedicated acreage outlined on the plat below? Yes X No \_\_\_\_\_
2. If the answer to question One is "No," have the interests of all the owners been consolidated by communization agreement or otherwise? Yes \_\_\_\_\_ No \_\_\_\_\_. If answer is "Yes," Type of Consolidation \_\_\_\_\_
3. If the answer to question Two is "No," list all the owners and their respective interests below:

OWNER

LAND DESCRIPTION

## SECTION B.

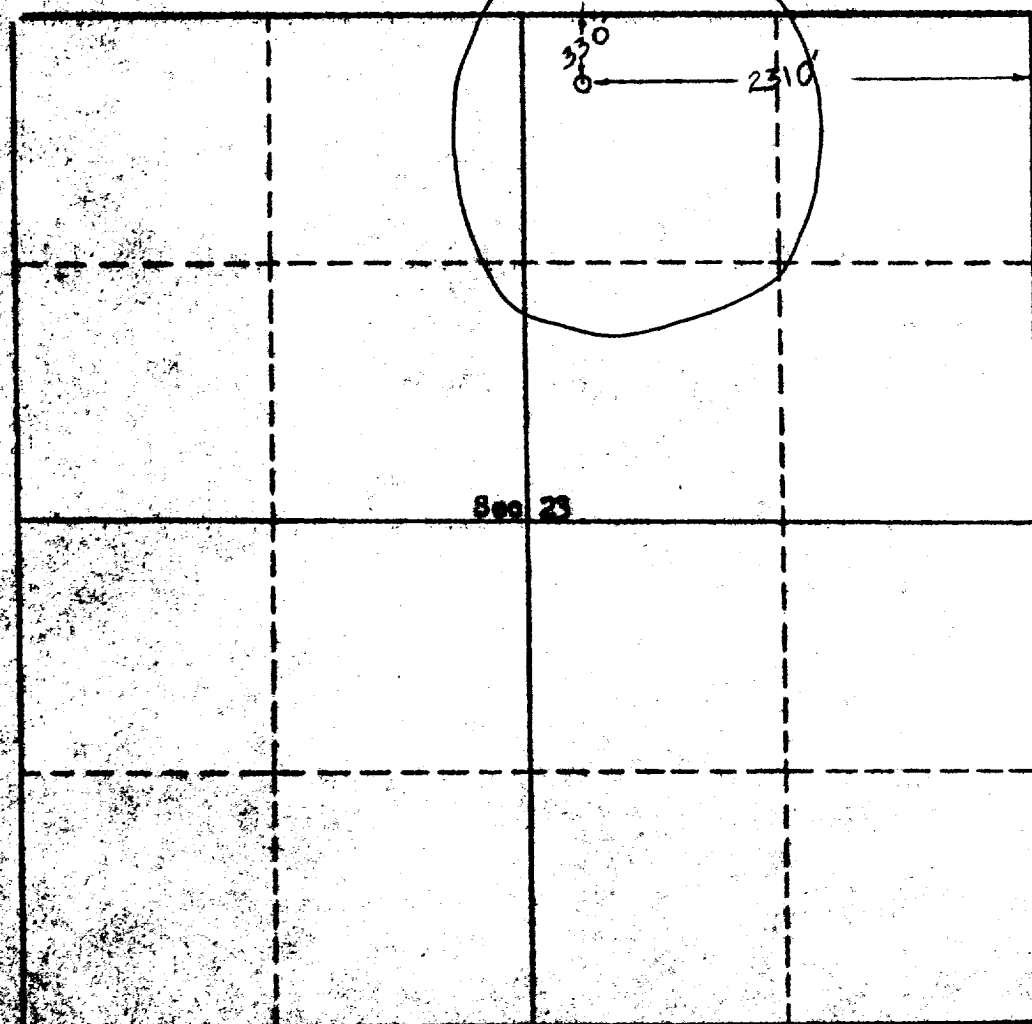

RECEIVED

NOV 5 1962

OIL CON. COM.  
DIST. 3

This is to certify that the information in Section A above is true and complete to the best of my knowledge and belief.

Harry L. Rigbee

(OPERATOR)

J. A. Flint, Jr.

(REPRESENTATIVE)

Box 669, Santa Fe, N.M.

(ADDRESS)

This is to certify that the well location shown on the plat in Section B was plotted from field notes of actual surveys made by me or under my supervision and that the same is true and correct to the best of my knowledge and belief.

Date Surveyed Oct. 10, 1962Four States Engineering Co.  
FARMINGTON, NEW MEXICO

Ernest H. Tebbel  
 REGISTERED ENGINEER OR  
 LAND SURVEYOR

Certificate No. 3602

