

UNITED STATES
DEPARTMENT OF THE INTERIOR
GEOLOGICAL SURVEY

APPLICATION FOR PERMIT TO DRILL, DEEPEN, OR PLUG BACK

1a. TYPE OF WORK

DRILL ☒DEEPEN ☐PLUG BACK ☐

b. TYPE OF WELL

OIL
WELL ☒GAS
WELL ☐

OTHER

SINGLE
ZONE ☒MULTIPLE
ZONE ☐

2. NAME OF OPERATOR

Union Oil Company of California

3. ADDRESS OF OPERATOR

P. O. Box 2620 - Casper, Wyoming 82601

4. LOCATION OF WELL (Report location clearly and in accordance with any State requirements.)*

At surface

990' FNL & 1650' FWL (NE NW), Sec. 25, T.22 N., R..3 W.

At proposed prod. zone

14. DISTANCE IN MILES AND DIRECTION FROM NEAREST TOWN OR POST OFFICE*

13 miles NW Cuba, New Mexico

10. DISTANCE FROM PROPOSED*

LOCATION TO NEAREST
PROPERTY OR LEASE LINE, FT.
(Also to nearest drlg. unit line, if any)

990'

18. DISTANCE FROM PROPOSED LOCATION*
TO NEAREST WELL, DRILLING, COMPLETED,
OR APPLIED FOR, ON THIS LEASE, FT.

2640'

16. NO. OF ACRES IN LEASE

2560

19. PROPOSED DEPTH

7100'

17. NO. OF ACRES ASSIGNED
TO THIS WELL

40

20. ROTARY OR CABLE TOOLS

Rotary

21. ELEVATIONS (Show whether DF, RT, GR, etc.)

7338' GR

22. APPROX. DATE WORK WILL START*

December 26, 1970

23.

PROPOSED CASING AND CEMENTING PROGRAM

SIZE OF HOLE	SIZE OF CASING	WEIGHT PER FOOT	SETTING DEPTH	QUANTITY OF CEMENT
12-1/4"	8-5/8"	24#	250'	Adequate to circ. to surface
7-7/8"	5-1/2"	15.5#	7100'	300 sx.

Plan of Procedure

Drill 12-1/4" hole to approximately 250'. Run and cement 8-5/8" casing. Drill 7-7/8" hole to T.D. Core and test at discretion of wellsite geologist. Run logs. Run and cement 5-1/2" casing. Perforate and complete using 2-7/8" tubing.

Double ram pressure operated BOP's will be installed on 8-5/8" casing and adequately and regularly tested and operated.

IN ABOVE SPACE DESCRIBE PROPOSED PROGRAM: If proposal is to deepen or plug back, give data on present productive zone and proposed zone. If proposal is to drill or deepen directionally, give pertinent data on subsurface locations and measured and true vertical depths. Give blowout preventer program, if any.

24.

SIGNED

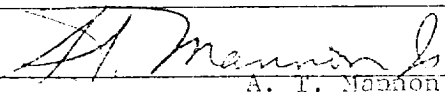

TITLE

District Drilling Supt.

DATE 12-14-70

(This space for Federal or State office use)

PERMIT NO.

APPROVAL DATE

APPROVED BY

TITLE

DATE

CONDITIONS OF APPROVAL, IF ANY:

*See Instructions On Reverse Side

20-443-20000

5. LEASE DESIGNATION AND SERIAL NO.

411

6. IF INDIAN, ALLOTTEE OR TRIBE NAME

Jicarilla Apache

7. UNIT AGREEMENT NAME

8. FARM OR LEASE NAME

Jicarilla 411

9. WELL NO.

1- (C-25)

10. FIELD AND POOL, OR WILDCAT

Undesignated

DK

11. SEC., T., R., M., OR BLK.
AND SURVEY OR AREA

Sec. 25, T.22N., R3W.

12. COUNTY OR PARISH

Sandoval

13. STATE

New Mexico

**NEW MEXICO OIL CONSERVATION COMMISSION
WELL LOCATION AND ACREAGE DEDICATION PLAT**

Form C-102
Supersedes C-128
Effective 1-1-65

All distances must be from the outer boundaries of the Section.

Operator Union Oil Company			Lease Jicarilla 411		Well No. 1
Unit Letter U	Section 25	Township 22 N	Range 3 W	County Sandoval	
Actual Footage Location of Well: 990 feet from the North line and 1650 feet from the West line					
Ground Level Elev. 7338	Producing Formation			Pool	Dedicated Acreage: 40 Acres

1. Outline the acreage dedicated to the subject well by colored pencil or hachure marks on the plat below.
2. If more than one lease is dedicated to the well, outline each and identify the ownership thereof (both as to working interest and royalty).
3. If more than one lease of different ownership is dedicated to the well, have the interests of all owners been consolidated by communitization, unitization, force-pooling, etc?

☐ Yes ☐ No If answer is "yes," type of consolidation _____

If answer is "no," list the owners and tract descriptions which have actually been consolidated. (Use reverse side of this form if necessary.) _____

No allowable will be assigned to the well until all interests have been consolidated (by communitization, unitization, forced-pooling, or otherwise) or until a non-standard unit, eliminating such interests, has been approved by the Commission.

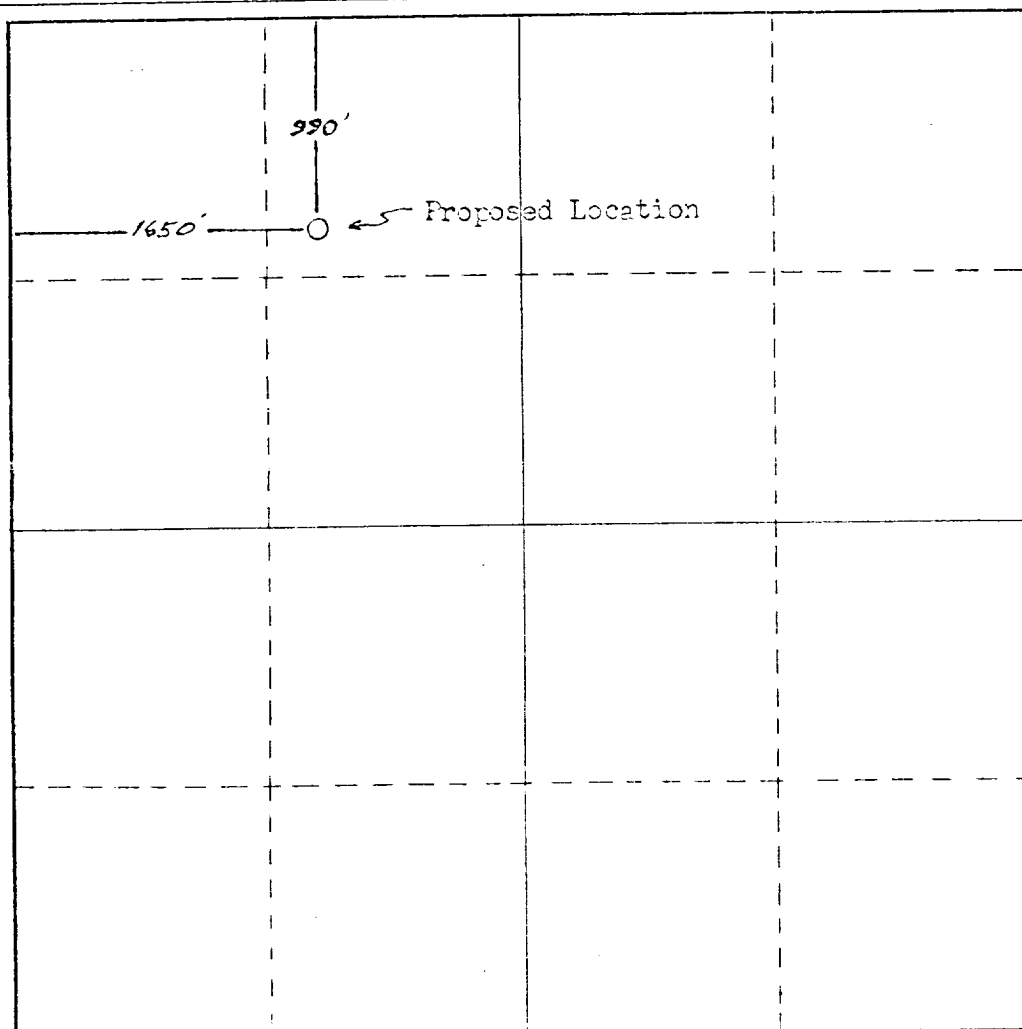

CERTIFICATION

I hereby certify that the information contained herein is true and complete to the best of my knowledge and belief.

Name **A. T. Mannon, Jr.**
 Position **District Drilling Supt.**
 Company **OIL CON. COM. Union Oil Company of Calif.**
 Date **December 14, 1970**

I hereby certify that the well location shown on this plat was plotted from field notes of actual surveys made by me or under my supervision, and that the same is true and correct to the best of my knowledge and belief.

Date Surveyed
Dec. 1, 1970
 Registered Professional Engineer
 and/or Land Surveyor

Frederick H. Reed
 Registered Professional Engineer
 and/or Land Surveyor

3235