

UNITED STATES
DEPARTMENT OF THE INTERIOR
GEOLOGICAL SURVEY

30-043-20081

5. LEASE DESIGNATION AND SERIAL NO.

NM-6681

6. IF INDIAN, ALLOTTEE OR TRIBE NAME

7. UNIT AGREEMENT NAME

8. FARM OR LEASE NAME

Federal C

9. WELL NO.

2

10. FIELD AND POOL, OR WILDCAT

Undesignated Gallup

11. SEC., T., R., M., OR BLK.
AND SURVEY OR AREA

31-23N-7W

12. COUNTY OR PARISH

Sandoval

13. STATE

NM

APPLICATION FOR PERMIT TO DRILL, DEEPEN, OR PLUG BACK

1a. TYPE OF WORK

DRILL ☒

DEEPEN ☐

PLUG BACK ☐

b. TYPE OF WELL

OIL WELL ☒

GAS WELL ☐

OTHER

SINGLE ZONE ☐

MULTIPLE ZONE ☐

2. NAME OF OPERATOR

Beo Inc.

3. ADDRESS OF OPERATOR

P.O. Box 669 Santa Fe, N.M. 87501

4. LOCATION OF WELL (Report location clearly and in accordance with any State requirements.)*

At surface

2310' FSL 790' FEL Sec 31 T23N R7W NMPM

At proposed prod. zone

SAME

14. DISTANCE IN MILES AND DIRECTION FROM NEAREST TOWN OR POST OFFICE*

18 miles Nageezi, N.M. 87037

15. DISTANCE FROM PROPOSED*

LOCATION TO NEAREST
PROPERTY OR LEASE LINE, FT.
(Also to nearest drlg. line, if any)

16. NO. OF ACRES IN LEASE

642.56

17. NO. OF ACRES ASSIGNED
TO THIS WELL

40

18. DISTANCE FROM PROPOSED LOCATION*

TO NEAREST WELL, DRILLING COMPLETED,
OR APPLIED FOR, ON THIS LEASE, FT.

19. PROPOSED DEPTH

5100

20. ROTARY OR CABLE TOOLS

Rotary

21. ELEVATIONS (Show whether DF, RT, GR, etc.)

GR 6891

22. APPROX. DATE WORK WILL START*

11-16-71

23. PROPOSED CASING AND CEMENTING PROGRAM

SIZE OF HOLE	SIZE OF CASING	WEIGHT PER FOOT	SETTING DEPTH	QUANTITY OF CEMENT
12 1/2"	8 5/8"	24#	120	Circulate
7 7/8"	4 1/2"	10.5#	5100	125 sacks

Propose to drill 12 1/2" hole to approximately 120'. Set 8 5/8" casing and circulate cement. Drill 7 7/8" hole to bottom of Gallup at approximately 5100'. Set 4 1/2" casing at T.D. and cement with 125 sacks cement. Perforate and sand oil frac Gallup formation.



IN ABOVE SPACE DESCRIBE PROPOSED PROGRAM: If proposal is to deepen or plug back, give data on present productive zone and proposed new productive zone. If proposal is to drill or deepen directionally, give pertinent data on subsurface locations and measured and true vertical depths. Give blowout preventer program, if any.

24.

SIGNED

Harry A. B...

TITLE

Vice President

DATE

11-15-71

(This space for Federal or State office use)

PERMIT NO.

APPROVAL DATE

APPROVED BY

M

TITLE

DATE

CONDITIONS OF APPROVAL, IF ANY:

RECEIVED NOV 20 1971

**NEW MEXICO OIL CONSERVATION COMMISSION
WELL LOCATION AND ACERAGE DEDICATION PLAT**

All distances must be from the outer boundaries of the Section

Operator ECO, Inc.			Lease Federal		Well No. C-2
Unit Letter 1	Section 31	Township 23 North	Range 7 West	County Sandoval	
Actual Footage Location of Well: 2310 feet from the South line and 790 feet from the East line					
Ground Level Elev. 6891	Producing Formation		Pool	Dedicated Acreage: 4.0 Acres	

1. Outline the acreage dedicated to the subject well by colored pencil or hatchure marks on the plat below.
2. If more than one lease is dedicated to the well, outline each and identify the ownership thereof (both as to working interest and royalty).
3. If more than one lease of different ownership is dedicated to the well, have the interests of all owners been consolidated by communitization, unitization, force-pooling, etc?
 () Yes () No If answer is "yes," type of consolidation _____

If answer is "no," list the owners and tract descriptions which have actually consolidated. (Use reverse side of this form if necessary.) _____

No allowable will be assigned to the well until all interests have been consolidated (by communitization, unitization, forced-pooling, or otherwise) or until a non standard unit, eliminating such interests, has been approved by the Commission.

CERTIFICATION

I hereby certify that the information contained herein is true and complete to the best of my knowledge and belief.

Harry R. Bryant
 Name
President
 Position
ECO, INC.
 Company
 DIST. 3
 11-22-71
 Date

I hereby certify that the well location shown on this plat was plotted from field notes of actual surveys made by me or under my supervision, and that the same is true and correct to the best of my knowledge and belief.

Date Surveyed

September 16, 1971
 Registered Professional Engineer
 and/or Land Surveyor

E. V. Echohawk
 Certificate No. 3602
 E. V. Echohawk LS

Sec. 31

790'
 2310'

Scale, 1 inch = 1,000 feet

NEW MEXICO OIL CONSERVATION COMMISSION

WELL LOCATION AND ACERAGE DEDICATION PLAT

All distances must be from the outer boundaries of the Section

Operator Bco, Inc.			Lease Federal C			Well No. 2		
Unit Letter 1	Section 31	Township 23 North	Range 7 West	County Sandoval				
Actual Footage Location of Well: 2310 feet from the South line and 790 feet from the East line								
Ground Level Elev. 6891	Producing Formation Unders. Gal.			Pool	Dedicated Acreage: Acres			

1. Outline the acreage dedicated to the subject well by colored pencil or hatchure marks on the plat below.
2. If more than one lease is dedicated to the well, outline each and identify the ownership thereof (both as to working interest and royalty),
3. If more than one lease of different ownership is dedicated to the well, have the interests of all owners been consolidated by communitization, unitization, force-pooling, etc?

() Yes () No If answer is "yes," type of consolidation

If answer is "no," list the owners and tract descriptions which have actually consolidated. (Use reverse side of this Form if necessary.)

No allowable will be assigned to the well until all interests have been consolidated (by communitization, unitization, forced-pooling, or otherwise) or until a non standard unit, eliminating such interests has been approved by the Commission.

CERTIFICATION

I hereby certify that the information contained herein is true and complete to the best of my knowledge and belief.

Name _____

Position _____

Company _____

Date _____

By _____
 I hereby certify that the well location shown on this plat is plotted from notes of actual survey made on or under my supervision, and that the same is true and correct to the best of my knowledge and belief.

Date Surveyed _____

September 16, 1971

Registered Professional Engineer

and/or Land Surveyor

E. V. Echowhawk
 Certificate No. **3602**
E. V. Echowhawk LS

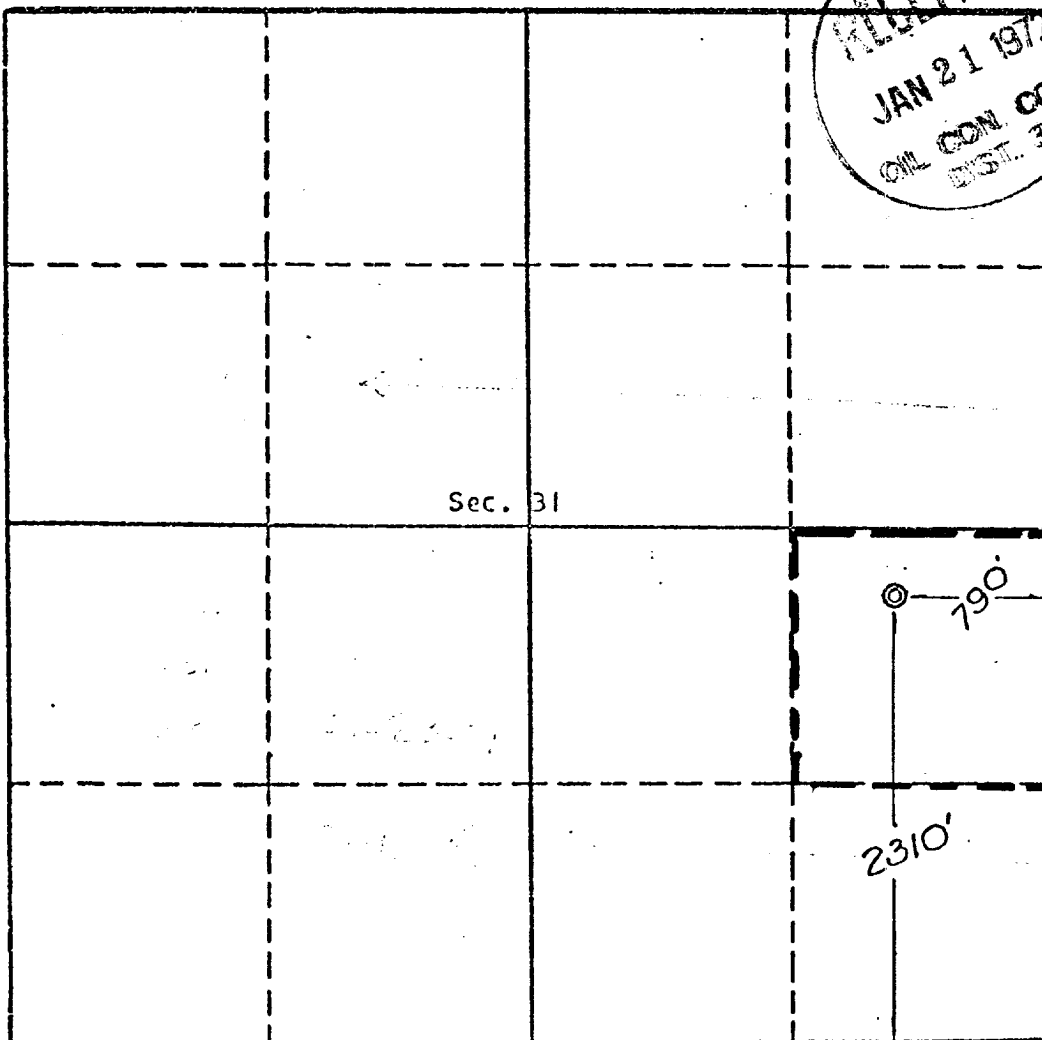

Scale, 1 inch = 1,000 feet