

UNITED STATES
DEPARTMENT OF THE INTERIOR
GEOLOGICAL SURVEY

APPLICATION FOR PERMIT TO DRILL, DEEPEN, OR PLUG BACK

1a. TYPE OF WORK DRILL <input checked="" type="checkbox"/> DEEPEN <input type="checkbox"/> PLUG BACK <input type="checkbox"/>		5. LEASE DESIGNATION AND SERIAL NO. Jicarilla Cont. #54		
b. TYPE OF WELL OIL WELL <input type="checkbox"/> GAS WELL <input checked="" type="checkbox"/> OTHER <input type="checkbox"/>		6. IF INDIAN, ALLOTTEE OR TRIBE NAME Jicarilla Apache		
2. NAME OF OPERATOR El Paso Natural Gas Company		7. UNIT AGREEMENT NAME		
3. ADDRESS OF OPERATOR PO Box 990, Farmington, NM 87401		8. FARM OR LEASE NAME Stromberg		
4. LOCATION OF WELL (Report location clearly and in accordance with any State requirements.)* At surface 1550'S, 1644'W At proposed prod. zone		9. WELL NO. 10		
14. DISTANCE IN MILES AND DIRECTION FROM NEAREST TOWN OR POST OFFICE*		10. FIELD AND POOL, OR WILDCAT Biller's Under. Pictured Cliffs EXT		
15. DISTANCE FROM PROPOSED* LOCATION TO NEAREST PROPERTY OR LEASE LINE, FT. (Also to nearest drilg. unit line, if any)		11. SEC., T., R., M., OR B.C. AND SURVEY OR AREA Sec. 34, T-23-N, R-3-W NMPM		
16. NO. OF ACRES IN LEASE		12. COUNTY OR PARISH Sandoval		
17. NO. OF ACRES ASSIGNED TO THIS WELL 160.00		13. STATE New Mexico		
18. DISTANCE FROM PROPOSED LOCATION* TO NEAREST WELL, DRILLING, COMPLETED, OR APPLIED FOR, ON THIS LEASE, FT.		20. ROTARY OR CABLE TOOLS Rotary		
19. PROPOSED DEPTH 2938'		22. APPROX. DATE WORK WILL START*		
21. ELEVATIONS (Show whether DF, RT, GR, etc.) 7238'GL				
23. PROPOSED CASING AND CEMENTING PROGRAM				
SIZE OF HOLE	SIZE OF CASING	WEIGHT PER FOOT	SETTING DEPTH	QUANTITY OF CEMENT
12 1/4"	8 5/8"	24#	120'	107 cu. ft. to circulate
6 3/4"	2 7/8"	6.4#	2938'	136 cu. ft. to cover Ojo Alamo

Selectively perforate and sandwater fracture the Pictured Cliffs formation.

The SW/4 of Section 34 is dedicated to this well.

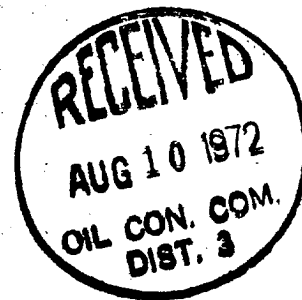

IN ABOVE SPACE DESCRIBE PROPOSED PROGRAM: If proposal is to deepen or plug back, give data on present productive zone and proposed new productive zone. If proposal is to drill or deepen directionally, give pertinent data on subsurface locations and measured and true vertical depths. Give blowout preventer program, if any.

24. TH Wood SIGNED Petroleum Engineer TITLE August 7, 1972 DATE
(This space for Federal or State office use)

PERMIT NO. _____ APPROVAL DATE _____

APPROVED BY AW TITLE _____ DATE _____

CONDITIONS OF APPROVAL, IF ANY:

NEW MEXICO OIL CONSERVATION COMMISSION
WELL LOCATION AND ACREAGE DEDICATION PLAT

Supervisor's Office
Albuquerque, N.M.

All distances must be from the outer boundaries of the section.

EL PASO NATURAL GAS COMPANY		STROMBERG (JICARILLA CON. #54)		10
E	34	23-N	3-W	SANDOVAL
1550	SOUTH	1644	WEST	
7238	PICTURED CLIFFS	UNDESIGNATED PICTURED CLIFFS <i>Ballant</i>		160.00

- Outline the acreage dedicated to the subject well by colored pencil or hatchure marks on the plat below.
- If more than one lease is dedicated to the well, outline each and identify the ownership thereof (both as to working interest and royalty).
- If more than one lease of different ownership is dedicated to the well, have the interests of all owners been consolidated by communitization, unitization, force-pooling, etc?

Yes ☐ No ☐ If answer is "yes" type of consolidation _____

If answer is "no" list the owners and tract descriptions which have actually been consolidated. (Use reverse side of this form if necessary.) _____

No allowable will be assigned to the well until all interests have been consolidated by communitization, unitization, force-pooling, or otherwise or until a non-standard unit, eliminating the well, has been approved by the Commission.

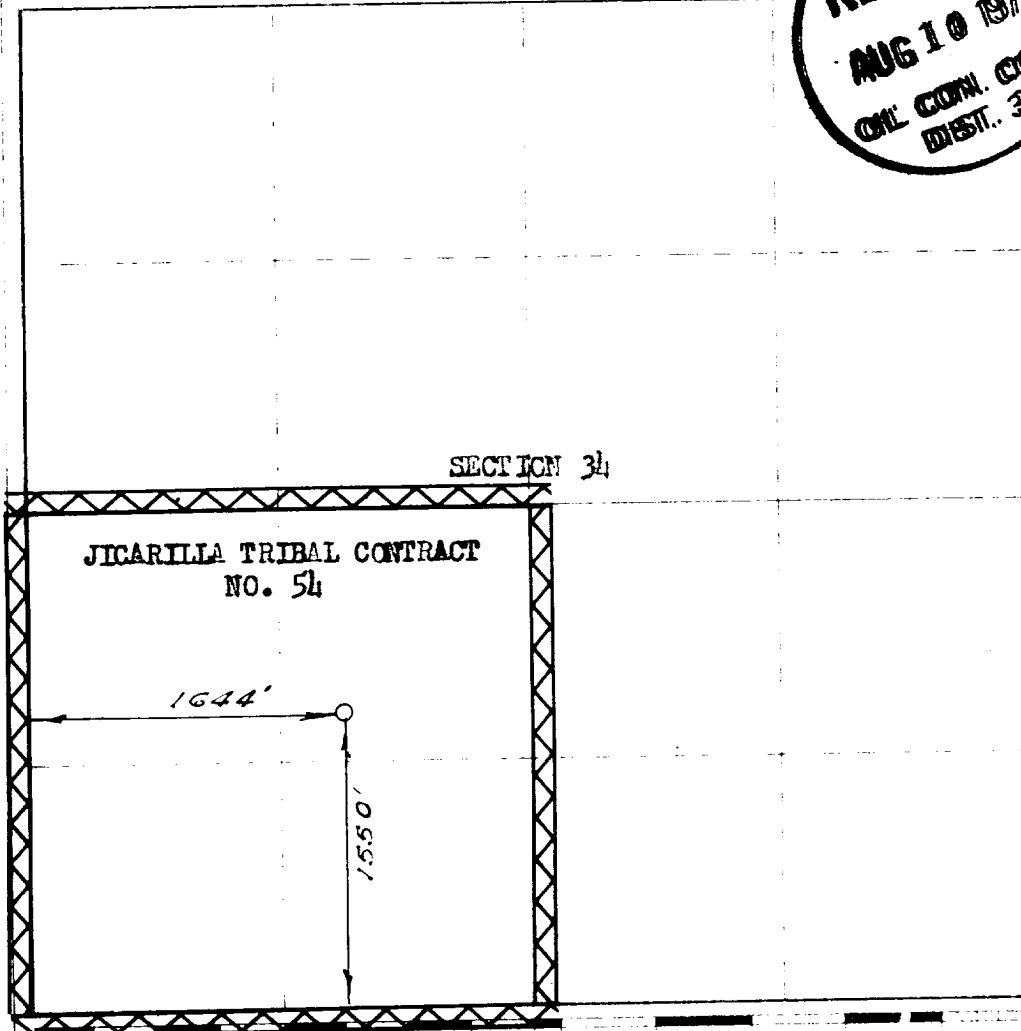
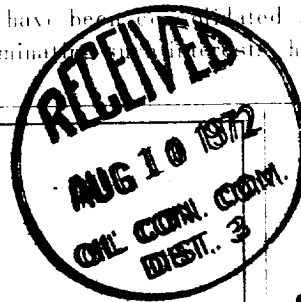

CERTIFICATION

I hereby certify that the information contained herein is true and complete to the best of my knowledge and belief.

Original Signed F. H. WOOD

Petroleum Engineer

El Paso Natural Gas Co.

August 7, 1972

I hereby certify that the well location shown on this plat was plotted from field notes of actual surveys made by me or under my supervision, and that the same is true and correct to the best of my knowledge and belief.

MARCH 22, 1972

David M. Kline
1760