

UNITED STATES
DEPARTMENT OF THE INTERIOR
GEOLOGICAL SURVEY

APPLICATION FOR PERMIT TO DRILL, DEEPEN, OR PLUG BACK

1a. TYPE OF WORK DRILL <input checked="" type="checkbox"/> DEEPEN <input type="checkbox"/> PLUG BACK <input type="checkbox"/>			5. LEASE DESIGNATION AND SERIAL NO. 413	
b. TYPE OF WELL OIL WELL <input type="checkbox"/> GAS WELL <input checked="" type="checkbox"/> OTHER <input type="checkbox"/>			6. IF INDIAN, ALLOTTEE OR TRIBE NAME Jicarilla	
2. NAME OF OPERATOR Keese & Thomas			7. UNIT AGREEMENT NAME	
3. ADDRESS OF OPERATOR P. O. Box 2026, Farmington, Farmington, New Mexico 87401			8. FARM OR LEASE NAME Chacon Jicarilla	
4. LOCATION OF WELL (Report location clearly and in accordance with any State requirements.) At surface 1850' FNL, 790' FW1 At proposed prod. zone Same			9. WELL NO. 5	
14. DISTANCE IN MILES AND DIRECTION FROM NEAREST TOWN OR POST OFFICE* 20 miles North of Cuba			10. FIELD AND POOL, OR WILDCAT Ballard P.C. ext	
15. DISTANCE FROM PROPOSED* LOCATION TO NEAREST PROPERTY OR LEASE LINE, FT. (Also to nearest drilg. unit line, if any) 790'			11. SEC., T., R., M., OR BLK. AND SURVEY OR AREA 23, T23N, R3W	
16. NO. OF ACRES IN LEASE 1280			12. COUNTY OR PARISH Sandoval	
17. DISTANCE FROM PROPOSED* LOCATION TO NEAREST WELL, DRILLING, COMPLETED, OR APPLIED FOR, ON THIS LEASE, FT. 4400'			13. STATE N.M.	
18. PROPOSED DEPTH 3500'			14. NO. OF ACRES ASSIGNED TO THIS WELL 160	
19. ROTARY OR CABLE TOOLS Rotary			15. APPROX. DATE WORK WILL START* 7-11-73	
20. ELEVATIONS (Show whether DF, RT, GR, etc.) 7355' Gr.				

PROPOSED CASING AND CEMENTING PROGRAM

SIZE OF HOLE	SIZE OF CASING	WEIGHT PER FOOT	SETTING DEPTH	QUANTITY OF CEMENT
12 1/4"	9 5/8"	32.30	120'	65 sacks
7 7/8"	4 1/2"	9.5	3500'	100 sacks

It is intended to drill this well to 3500', run 4 1/2" casing to total depth, perforate and sand water frac the Pictured Cliffs.



IN ABOVE SPACE DESCRIBE PROPOSED PROGRAM: If proposal is to deepen or plug back, give data on present productive zone and proposed new productive zone. If proposal is to drill or deepen directionally, give pertinent data on subsurface locations and measured and true vertical depths. Give blowout preventer program, if any.

24. SIGNED Steve M. Thomas TITLE Partner DATE 7-9-73

(This space for Federal or State office use)

PERMIT NO. _____ APPROVAL DATE _____
APPROVED BY [Signature] TITLE _____ DATE JUL 10 1973
CONDITIONS OF APPROVAL, IF ANY: _____

*See Instructions On Reverse Side

U. S. GEOLOGICAL SURVEY
DURANGO, COLO.

**NEW MEXICO OIL CONSERVATION COMMISSION
WELL LOCATION AND ACERAGE DEDICATION PLAT**

All distances must be from the outer boundaries of the Section

Operator Keesee & Thomas		Lease Chacon Jicarilla		Well No 5
Unit Letter E	Section 23	Township 23 North	Range 3 West	County Sandoval
Actual Footage Location of Well: 1850' feet from the North line and 790 feet from the West line				
Ground Level Elev. 7355.0	Producing Formation Pictured Cliffs	Pool Ballard P. C. EXT	Dedicated Acreage 160 Acres	

1. Outline the acreage dedicated to the subject well by colored pencil or hachure marks on the plat below.
2. If more than one lease is dedicated to the well, outline each and identify the ownership thereof (both as working interest and royalty).
3. If more than one lease of different ownership is dedicated to the well, have the interests of all owners been consolidated by communitization, unitization, force-pooling, etc?

() Yes () No If answer is "yes," type of consolidation _____
 If answer is "no," list the owners and tract descriptions which have actually consolidated. (Use reverse side of this form if necessary.) _____

No allowable will be assigned to the well until all interests have been consolidated (by communitization, unitization, forced-pooling, or otherwise) or until a non standard unit, eliminating such interests, has been approved by the Commission.

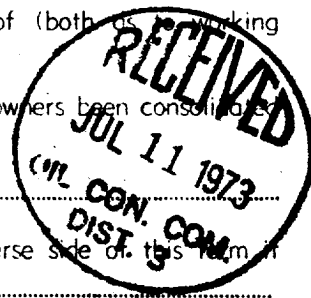

CERTIFICATION

I hereby certify that the information contained herein is true and complete to the best of my knowledge and belief.

Dave M. Thomas, Jr.

Name
Dave M. Thomas, Jr.
 Position

Partner

Company

Keesee & Thomas

Date

7-09-73

I hereby certify that the well location shown on this plat was plotted from field notes of actual surveys made by me or under my supervision, and that the same is true and correct to the best of my knowledge and belief.

Date Surveyed **July 11, 1973**
James P. Lee
 Registered Professional Engineer
 and/or Land Surveyor
James P. Lee
1463 MEXICO
 Certificate No. _____

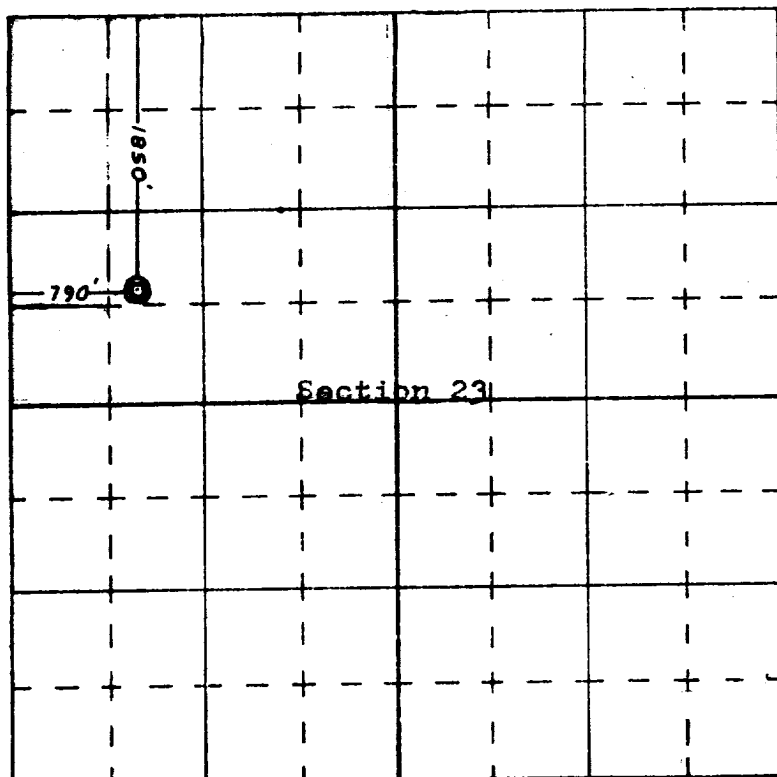

SCALE—4 INCHES EQUALS 1 MILE

