

UNITED STATES
DEPARTMENT OF THE INTERIOR
GEOLOGICAL SURVEY30-043-20138
5. FIELD DESIGNATION AND FEDERAL NO.

N00-C-14-20-5044

APPLICATION FOR PERMIT TO DRILL, DEEPEN, OR PLUG BACK

1a. TYPE OF WORK

DRILL ☒DEEPEN ☐PLUG BACK ☐

b. TYPE OF WELL

OIL
WELL ☐GAS
WELL ☒

OTHER

SINGLE
ZONE ☒MULTIPLE
ZONE ☐

2. NAME OF OPERATOR

Tesoro Petroleum Corporation

3. ADDRESS OF OPERATOR 1776 Lincoln Street

Suite 1012 Denver Center Bldg., Denver, Colorado 80203

4. LOCATION OF WELL (Report location clearly and in accordance with any State requirements.)*

At 790' FSL & 790' FEL Section 28, T22N, R6W

At proposed prod. zone

Same

14. DISTANCE IN MILES AND DIRECTION FROM NEAREST TOWN OR POST OFFICE*

8 miles south of Counselor, New Mexico

15. DISTANCE FROM PROPOSED*

LOCATION TO NEAREST
PROPERTY OR LEASE LINE, FT.
(Also to nearest drg. unit line, if any)

790'

16. NO. OF ACRES IN LEASE

160

17. NO. OF ACRES ASSIGNED
TO THIS WELL

40

18. DISTANCE FROM PROPOSED LOCATION*

TO NEAREST WELL, DRILLING, COMPLETED,
OR APPLIED FOR, ON THIS LEASE, FT.

790'

19. PROPOSED DEPTH

6300'

20. ROTARY OR CABLE TOOLS

Rotary

21. ELEVATIONS (Show whether DP, RT, GR, etc.)

6926' GR

22. APPROX. DATE WORK WILL START*

December 26, 1973

23.

PROPOSED CASING AND CEMENTING PROGRAM

SIZE OF HOLE	SIZE OF CASING	WEIGHT PER FOOT	SETTING DEPTH	QUANTITY OF CEMENT
12-1/4"	8-5/8"	24	300'	200 sx
7-7/8"	4-1/2"	10.5 & 11.6	6300'	1st stage: 300 sx 2nd stage: 550 sx

Plan to drill 12-1/4" surface hole to a minimum depth of 300' and set 8-5/8" OD surface casing. A 7-7/8" hole will then be drilled through the 8-5/8" casing from 300' to 6300' ± to evaluate the Dakota "A" formation. If commercial hydrocarbon production is established 4-1/2" OD casing will be run to total depth and cemented in two stages with a D.V. tool at approx. 3800'. The 4-1/2" casing will be perforated in the commercially productive horizon for horizontal and the well completed in an approved manner.

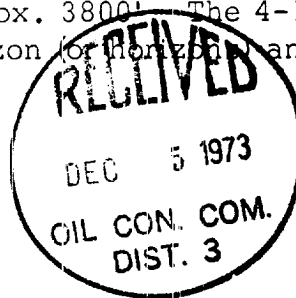

IN ABOVE SPACE DESCRIBE PROPOSED PROGRAM: If proposal is to deepen or plug back, give data on present productive zone and proposed new productive zone. If proposal is to drill or deepen directionally, give pertinent data on subsurface locations and measured and true vertical depths. Give blowout prevention program, if any.

24.

SIGNED L. Charles Marquart
(This space for Federal or State office use)TITLE District EngineerDATE November 30, 1973

PERMIT NO. _____

APPROVAL DATE _____

APPROVED BY _____

TITLE _____

CONDITIONS OF APPROVAL, IF ANY:

DATE

DEC 4 1973

*See Instructions On Reverse Side

U. S. GEOLOGICAL SURVEY
DURANGO, COLO

NEW MEXICO OIL CONSERVATION COMMISSION
WELL LOCATION AND ACREAGE DEDICATION PLAT

Form C-102
Supersedes C-128
Effective 1-1-65

All distances must be from the outer boundaries of the Section.

Operator Tesoro Petroleum Corporation			Lease Navajo Allotted		Well No. 1
Unit Letter P	Section 28	Township 22N	Range 6W	County Sandoval	
Actual Footage Location of Well: 790 feet from the South line and 790 feet from the East line					
Ground Level Elev: 6926	Producing Formation Dakota		Pool Wildcat ✓	Dedicated Acreage: 40 ✓ Acres	

1. Outline the acreage dedicated to the subject well by colored pencil or hatchure marks on the plat below.
2. If more than one lease is dedicated to the well, outline each and identify the ownership thereof (both as to working interest and royalty).
3. If more than one lease of different ownership is dedicated to the well, have the interests of all owners been consolidated by communitization, unitization, force-pooling, etc?

☐ Yes ☐ No If answer is "yes," type of consolidation _____

If answer is "no," list the owners and tract descriptions which have actually been consolidated. (Use reverse side of this form if necessary.) _____

No allowable will be assigned to the well until all interests have been consolidated (by communitization, unitization, forced-pooling, or otherwise) or until a non-standard unit, eliminating such interests, has been approved by the Commission.

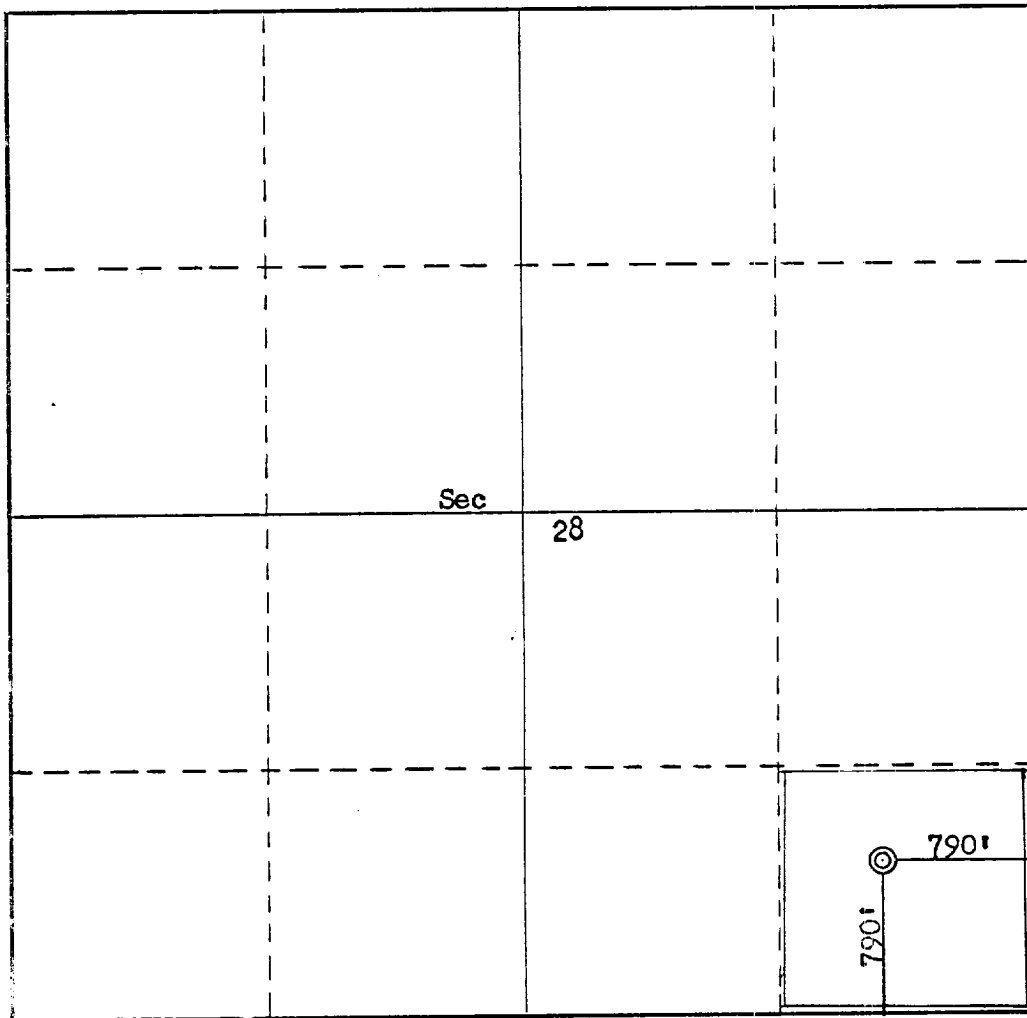
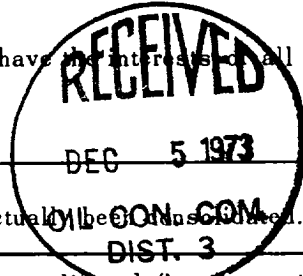

CERTIFICATION

I hereby certify that the information contained herein is true and complete to the best of my knowledge and belief.

L. Charles Marquart
Name

L. Charles Marquart

Position
District Engineer

Company
Tesoro Petroleum Corp.

Date
November 20, 1973

I hereby certify that the well location shown on this plat was plotted from field notes of actual surveys made by me or under my supervision, and that the same is true and correct to the best of my knowledge and belief.

Date Surveyed
November 15, 1973

Registered Professional Engineer and/or Land Surveyor

Fred B. Kerr Jr.
Fred B. Kerr Jr.

Certificate No.

3950

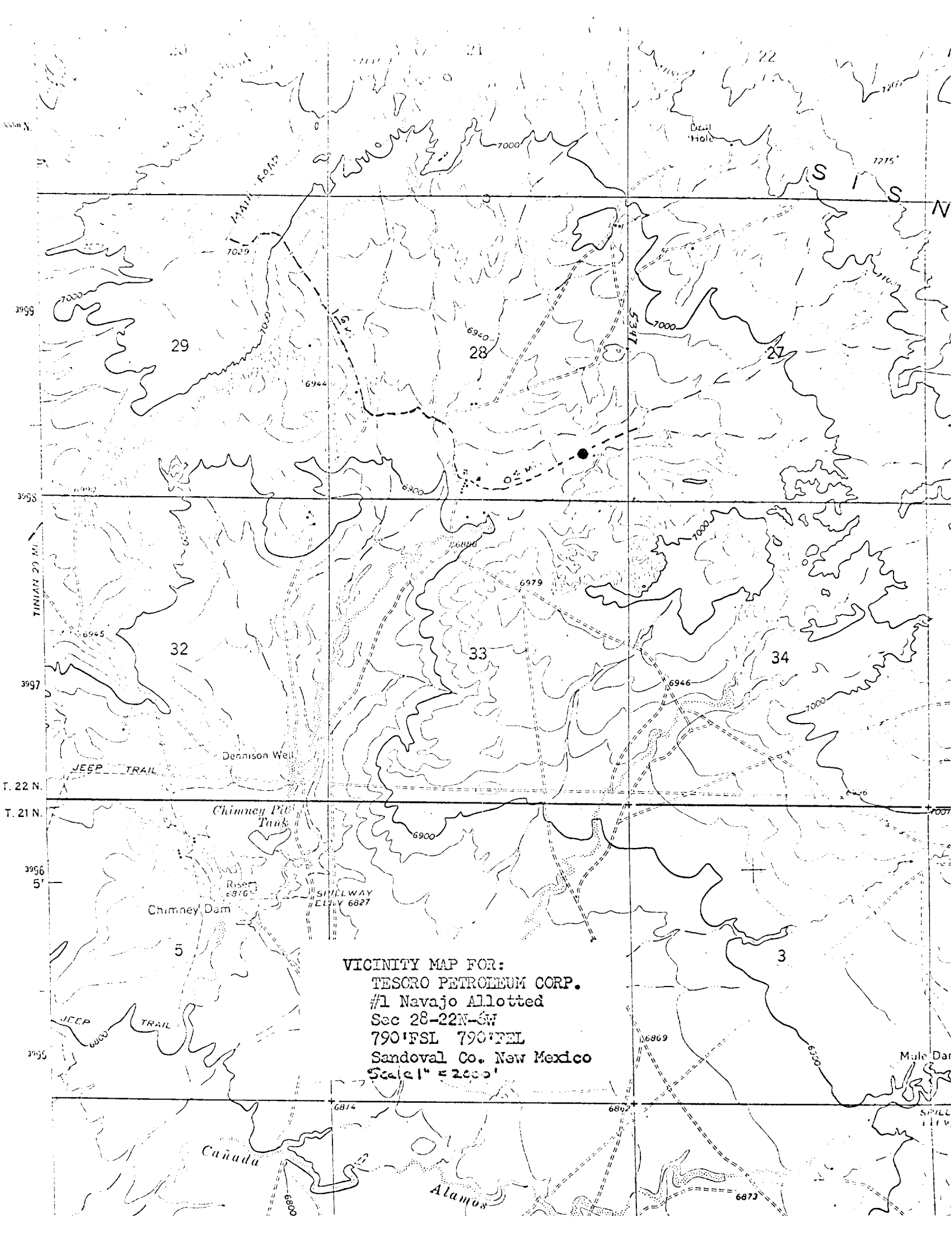

VICINITY MAP FOR:
TESORO PETROLEUM CORP.
#1 Navajo Allotted
Sec 28-22N-6W
790'FSL 790'FEL
Sandoval Co. New Mexico
Scale 1" = 2000'

DESIGNATION OF OPERATOR

The undersigned is, on the records of the Navajo Tribe, holder of lease

DISTRICT LAND OFFICE: Navajo Area Office; Window Rock, Arizona 86515
SERIAL No. Contract No. N00-C-14-20-5044

and hereby designates

NAME: Tesoro Petroleum Corporation
ADDRESS: Suite 1012; 1776 Lincoln Street
Denver, Colorado 80203 Attention: Mr. John V. Brock

as his operator and local agent, with full authority to act in his behalf in complying with the terms of the lease and regulations applicable thereto and on whom the supervisor or his representative may serve written or oral instructions in securing compliance with the Operating Regulations with respect to (describe acreage to which this designation is applicable):

~~SW/4 Sec. 27~~, T22N-R6W, N.M.P.M., Sandoval County, New Mexico
SE/4 Sec 28 E-7H

It is understood that this designation of operator does not relieve the lessee of responsibility for compliance with the terms of the lease and the Operating Regulations. It is also understood that this designation of operator does not constitute an assignment of any interest in the lease.

In case of default on the part of the designated operator, the lessee will make full and prompt compliance with all regulations, lease terms, or orders of the Secretary of the Interior or his representative.

The lessee agrees promptly to notify the supervisor of any change in the designated operator.

AQUITAINE OIL CORPORATION

SUN OIL COMPANY (DELAWARE)

[Signature] WGS
By: P. Chalcopy, Executive Vice President
5333 Westheimer
Houston, Texas 77027

[Signature] R.F.M.
By: Agent and Attorney-in-Fact
12850 Hillcrest Road
Dallas, Texas 75230

Date: October 22, 1973

Date: October 5, 1973

NATURAL GAS PIPELINE COMPANY OF AMERICA

By: [Signature]
VICE PRESIDENT
Post Office Box 283
Houston, Texas 77001

Date: 11-1-73

APPROVED	
GEOL.	<i>[Signature]</i>
G.S.	<i>[Signature]</i>
LEAD	<i>[Signature]</i>



United States Department of the Interior
NATIONAL PARK SERVICE

P. O. Box 8327
Albuquerque, New Mexico 87108

COPY

IN REPLY REFER TO:

Nov. 26, 1973

Memorandum

To: Area Director, Navajo Area Office, B.I.A.
Attn: Real Property Management

From: Archeologist, Albuquerque Office, N.P.S.

Subject: Archeological clearance, Tesoro #1 Navajo Allotted.

Archeological clearance is granted to Tesoro Petroleum Corporation for a well, the #1 Navajo Allotted, to be located 790' FSL and 790' FEL, Section 28, T 22 N, R 6 W, Sandoval County, New Mexico. Lease number for this well is N00-C-14-20-5044.

Archeologist

copies:

— Tesoro Petroleum Corp., Denver
U.S. Geological Survey, Farmington
The Navajo Tribe, Window Rock
file

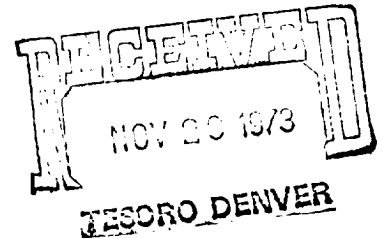

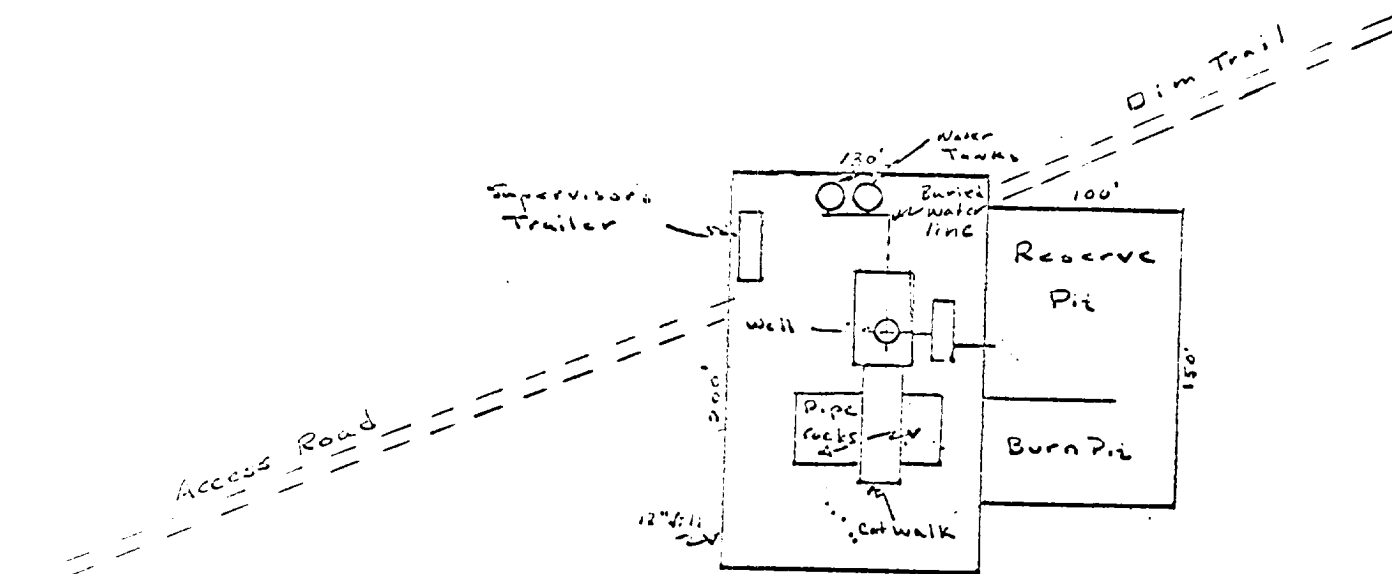

Location Plat for:

Tesoro Petroleum Corporation
 #1 Navajo Allotted (Wildcat)
 790' FSL & 790' FWL Section 28, T22N, R6W
 Sandoval County, New Mexico
 Scale - None