

UNITED STATES
DEPARTMENT OF THE INTERIOR
GEOLOGICAL SURVEY

APPLICATION FOR PERMIT TO DRILL, DEEPEN, OR PLUG BACK

1a. TYPE OF WORK DRILL <input checked="" type="checkbox"/> DEEPEN <input type="checkbox"/> PLUG BACK <input type="checkbox"/>			5. LEASE DESIGNATION AND SERIAL NO. Cont 413	
b. TYPE OF WELL OIL WELL <input type="checkbox"/> GAS WELL <input checked="" type="checkbox"/> OTHER <input type="checkbox"/>			6. IF INDIAN, ALLOTTEE OR TRIBE NAME Jicarilla	
2. NAME OF OPERATOR KEESE & THOMAS			7. UNIT AGREEMENT NAME	
3. ADDRESS OF OPERATOR P. O. Box 2026, Farmington, New Mexico 87401			8. FARM OR LEASE NAME Chacon Jicarilla Apache "D"	
4. LOCATION OF WELL (Report location clearly and in accordance with any State requirements.) At surface 875' FNL, 1140' FEL At proposed prod. zone same			9. WELL NO. 1	
14. DISTANCE IN MILES AND DIRECTION FROM NEAREST TOWN OR POST OFFICE* 20 miles north of Cuba, New Mexico			10. FIELD AND POOL, OR WILDCAT Wildcat	
15. DISTANCE FROM PROPOSED* LOCATION TO NEAREST PROPERTY OR LEASE LINE, FT. (Also to nearest drlg. unit line, if any) 875'			11. SEC., T., R., M., OR B.L. AND SURVEY OR AREA Sec. 23, T23N, R3W	
16. DISTANCE FROM PROPOSED* LOCATION TO NEAREST WELL, DRILLING, COMPLETED, OR APPLIED FOR, ON THIS LEASE, FT. 3400'			12. COUNTY OR PARISH Sandoval	
17. NO. OF ACRES IN LEASE 1920			13. STATE N.M.	
18. PROPOSED DEPTH 8000'			14. ROTARY OR CABLE TOOLS Rotary	
21. ELEVATIONS (Show whether DF, RT, GR, etc.) 7374 GR			22. APPROX. DATE WORK WILL START* 5/15/74	

PROPOSED CASING AND CEMENTING PROGRAM

SIZE OF HOLE	SIZE OF CASING	WEIGHT PER FOOT	SETTING DEPTH	QUANTITY OF CEMENT
12 1/4	8 5/8	24.00	300	200
7 7/8	4 1/2	10.5 - 11.6	8000	600-100

It is intended to drill this well to 8,000' with rotary tools. Mud will be used as a circulating medium. 4 1/2" casing will be run to total depth and cement will be brought above the Gallup Formation. The Pictured Cliffs Formations will also be covered with cement. The Dakota and Gallup Formations will be perforated and sand-water fractured.

IN ABOVE SPACE DESCRIBE PROPOSED PROGRAM: If proposal is to deepen or plug back, give data on present productive zone and proposed new productive zone. If proposal is to drill or deepen directionally, give pertinent data on subsurface locations and measured and true vertical depths. Give blowout preventer program, if any.

24. SIGNED Steve M. Thomas TITLE Partner DATE 4/8/74

(This space for Federal or State office use)

PERMIT NO. _____ APPROVAL DATE _____

TITLE _____ DATE _____

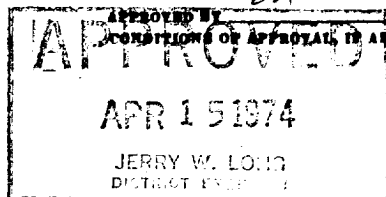

held e-104 for
commencing work
*See Instructions On Reverse Side

**NEW MEXICO OIL CONSERVATION COMMISSION
WELL LOCATION AND ACREAGE DEDICATION PLAT**

Form C-102
Supersedes C-128
Effective 1-1-65

All distances must be from the outer boundaries of the Section.

Operator KEESEEE AND THOMAS			Lease CHACON JICARILLA APACHE "D"		Well No. 1
Unit Letter A	Section 23	Township 23 NORTH	Range 3 WEST	County SANDOVAL	
Actual Footage Location of Well: 875 feet from the NORTH line and 1140 feet from the EAST line					
Ground Level Elev. 7374	Producing Formation DAKOTA		Pool Wildcat		Dedicated Acreage: 320 Acres

1. Outline the acreage dedicated to the subject well by colored pencil or hachure marks on the plat below.
2. If more than one lease is dedicated to the well, outline each and identify the ownership thereof (both as to working interest and royalty).
3. If more than one lease of different ownership is dedicated to the well, have the interests of all owners been consolidated by communitization, unitization, force-pooling, etc?

☐ Yes ☐ No If answer is "yes," type of consolidation _____

If answer is "no," list the owners and tract descriptions which have actually been consolidated. (Use reverse side of this form if necessary.) _____

No allowable will be assigned to the well until all interests have been consolidated (by communitization, unitization, forced-pooling, or otherwise) or until a non-standard unit, eliminating such interests, has been approved by the Commission.

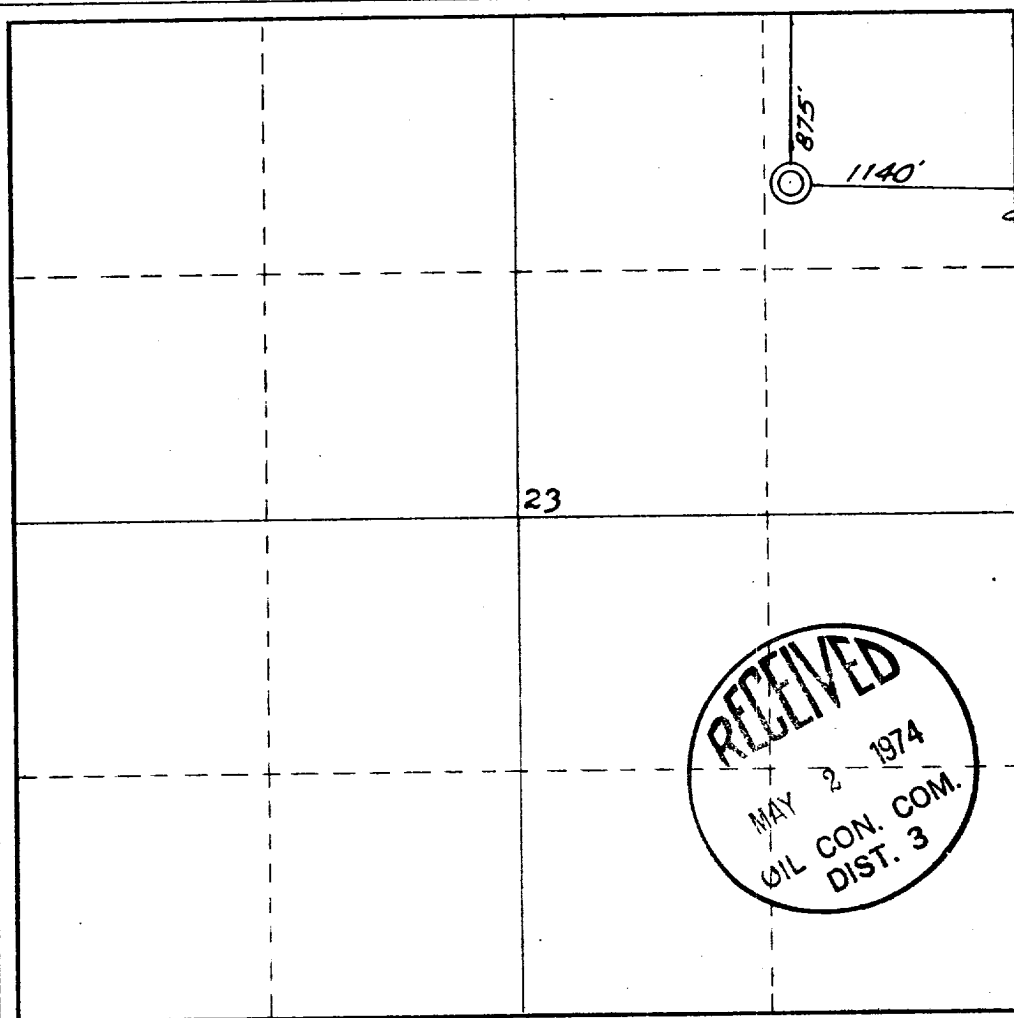

CERTIFICATION

I hereby certify that the information contained herein is true and complete to the best of my knowledge and belief.

Dave M. Thomas Jr.

Name

Dave M. Thomas Jr.

Position

Partner

Company

Keesee & Thomas

Date

April 8, 1974

I hereby certify that the well location shown on this plat was plotted from field notes of actual surveys made by me or under my supervision, and that the same is true and correct to the best of my knowledge and belief.

Date Surveyed

2 April 1974

Registered Professional Engineer and/or Land Surveyor

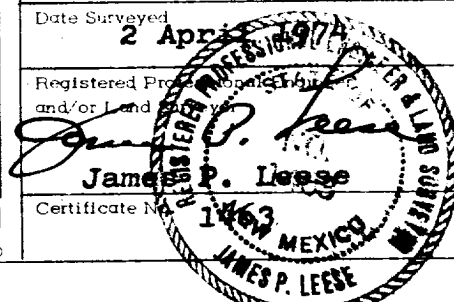

Certificate No.

1463

0 330 660 990 1320 1650 1980 2310 2640 2970 3300 3630 3960 4290 4620 4950 5280 5610 5940 6270 6600

