

UNITED STATES
DEPARTMENT OF THE INTERIOR
GEOLOGICAL SURVEY

APPLICATION FOR PERMIT TO DRILL, DEEPEN, OR PLUG BACK

1a. TYPE OF WORK

DRILL ☒DEEPEN ☐PLUG BACK ☐

b. TYPE OF WELL

OIL
WELL ☒GAS
WELL ☐OTHER ☐SINGLE
ZONE ☒MULTIPLE
ZONE ☐

2. NAME OF OPERATOR

FILON EXPLORATION CORPORATION c/o Minerals Management

3. ADDRESS OF OPERATOR

501 Airport Dr., Suite 210, Farmington, New Mexico 87401

4. LOCATION OF WELL (Report location clearly and in accordance with any State requirements.*)
At surface330 FSL, 1650 FEL, Sec. 33, T21N, R5W
At proposed prod. zone

14. DISTANCE IN MILES AND DIRECTION FROM NEAREST TOWN OR POST OFFICE*

15 Miles SE of Counselors, New Mexico

15. DISTANCE FROM PROPOSED*

LOCATION TO NEAREST
PROPERTY OR LEASE LINE, FT.
(Also to nearest drlg. unit line, if any)

330'

18. DISTANCE FROM PROPOSED LOCATION*
TO NEAREST WELL, DRILLING, COMPLETED,
OR APPLIED FOR, ON THIS LEASE, FT.

21. ELEVATIONS (Show whether DF, RT, GR, etc.)

7014 GR

23.

PROPOSED CASING AND CEMENTING PROGRAM

SIZE OF HOLE	SIZE OF CASING	WEIGHT PER FOOT	SETTING DEPTH	QUANTITY OF CEMENT
15	10 3/4	40.5	200'	200 SX
8 3/4	5 1/2 or 7"	-	6700	300-500 SX

Filon Exploration Corporation (Operator) proposes to drill well to 6700' to test Entrada formation. Completion to be determined from logs. A Series 900 (300 psi WP) blowout preventer will be used.



IN ABOVE SPACE DESCRIBE PROPOSED PROGRAM: If proposal is to deepen or plug back, give data on present productive zone and proposed new productive zone. If proposal is to drill or deepen directionally, give pertinent data on subsurface locations and measured and true vertical depths. Give blowout preventer program, if any.

24.

SIGNED

Area Manager

TITLE Minerals Management Inc. DATE 8-1-75

(This space for Federal or State office use)

PERMIT NO.

APPROVAL DATE

APPROVED BY

CONDITIONS OF APPROVAL, IF ANY:

TITLE

DATE

**NEW MEXICO OIL CONSERVATION COMMISSION
WELL LOCATION AND ACREAGE DEDICATION PLAT**

Form C-102
Supersedes C-128
Effective 1-1-65

All distances must be from the outer boundaries of the Section.

Operator Filon Exploration			Lease Federal 33		Well No. 2
Unit Letter 0	Section 33	Township 21N	Range 5W	County Sandoval	
Actual Footage Location of Well: 330 feet from the South line and 1650 feet from the East line					
Ground Level Elev. 7014	Producing Formation Entrada		Pool Wildcat	Dedicated Acreage: 40 Acres	

1. Outline the acreage dedicated to the subject well by colored pencil or hachure marks on the plat below.
2. If more than one lease is dedicated to the well, outline each and identify the ownership thereof (both as to working interest and royalty).
3. If more than one lease of different ownership is dedicated to the well, have the interests of all owners been consolidated by communitization, unitization, force-pooling, etc?

☐ Yes ☐ No If answer is "yes," type of consolidation _____

If answer is "no," list the owners and tract descriptions which have actually been consolidated. (Use reverse side of this form if necessary.) _____

No allowable will be assigned to the well until all interests have been consolidated (by communitization, unitization, forced-pooling, or otherwise) or until a non-standard unit, eliminating such interests, has been approved by the Commission.

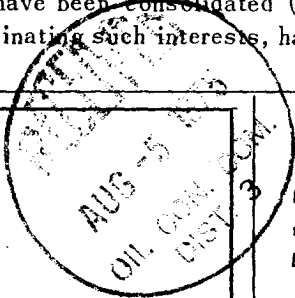
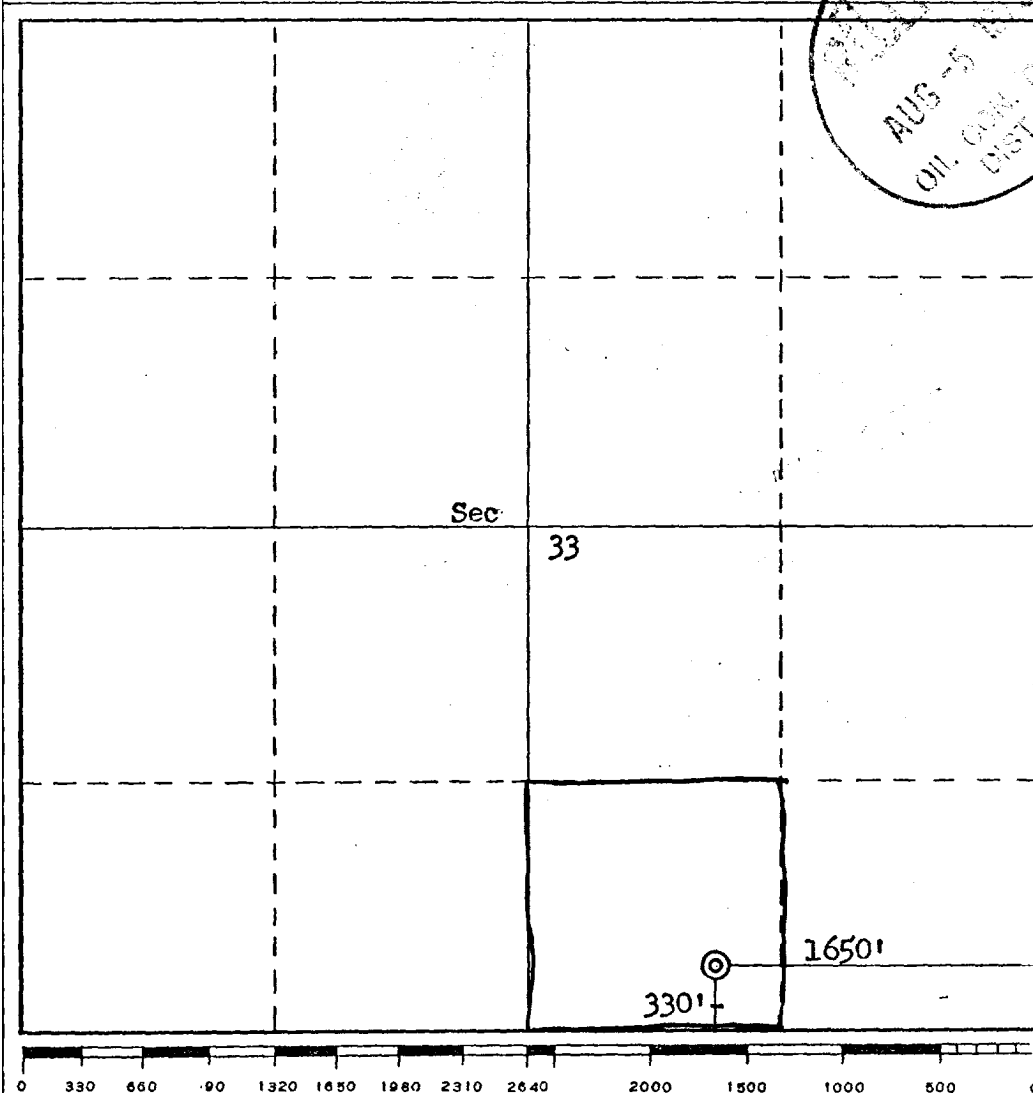

CERTIFICATION

I hereby certify that the information contained herein is true and complete to the best of my knowledge and belief.

Name
J. Arnold Snell

Position

Area Manager

Company

Mineral Management Inc.

Date

August 1, 1975

I hereby certify that the well location shown on this plat was plotted from field notes of actual surveys made by me or under my supervision, and that the same is true and correct to the best of my knowledge and belief.

Date Surveyed

July 29, 1975

Registered Professional Engineer and/or Land Surveyor

Fred B. Kern, Jr.
Fred B. Kern, Jr.

Certificate No.

3950

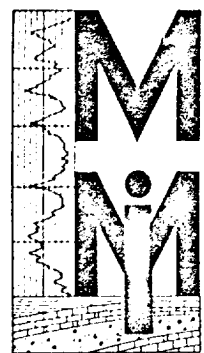

MINERALS
MANAGEMENT INC.

TELEPHONE (505) 327-4441
501 AIRPORT DRIVE—PETROLEUM CENTER BUILDING
SUITE 210
FARMINGTON, NEW MEXICO 87401

DEVELOPMENT PLAN FOR SURFACE USE

FILON EXPLORATION CORPORATION.

FEDERAL 33 WELL NO. 2

330 FSL, 1650 FEL, SEC. 33 T21N, R5W

SANDOVAL COUNTY, NEW MEXICO



1. Existing Roads

The main road in the immediate area is the road from Counselors Trading Post to Ojo Encino School.

2. Planned Access Road

- (a) Road will be utilized from main road to Filon's Federal 33 #1, (P & A) location.
- (b) Approximately 3/4 miles new road to be built from location pad as per drawing on topographic map.

3. Location of Existing Wells

P & A - 990 FSL, 790 FWL, SEC. 33, T21N, R5W
P & A - 1750 FSL, 2280 FWL, SEC. 33, T21, R5W

4. Lateral Roads

As per topographic map.

5. Location of Tank Batteries and Flowlines

Will be initially located on the drill pad approximately 150 feet from the well if production is encountered.

6. Water Supply

Water will be hauled to the well site from B.L.M. Encino construction Well #5, NE/4, Sec. 31, T21N, R4W, 1965 Project 3R-641-E. Road to water well will be improved in order to haul water. Approval will be obtained from Albuquerque.

7. Method of Handling Waste Disposal

Waste will be buried in the reserve pit on completion of the well. The reserve pit will be backfilled. Toilet facilities will be provided.

8. Location of Camp

No camp will be used.

9. Location of Airstrip

None

10. Diagram of Well Location

See attached diagram

11. Plans for Restoration of Surface

The surface will be restored and reseeded as directed by the Bureau of Land Management.

12. Impact on the Environment

Impact on the environment will be minimal. The access road and well location is sparsely vegetated and minimum trees and sage will be disturbed.

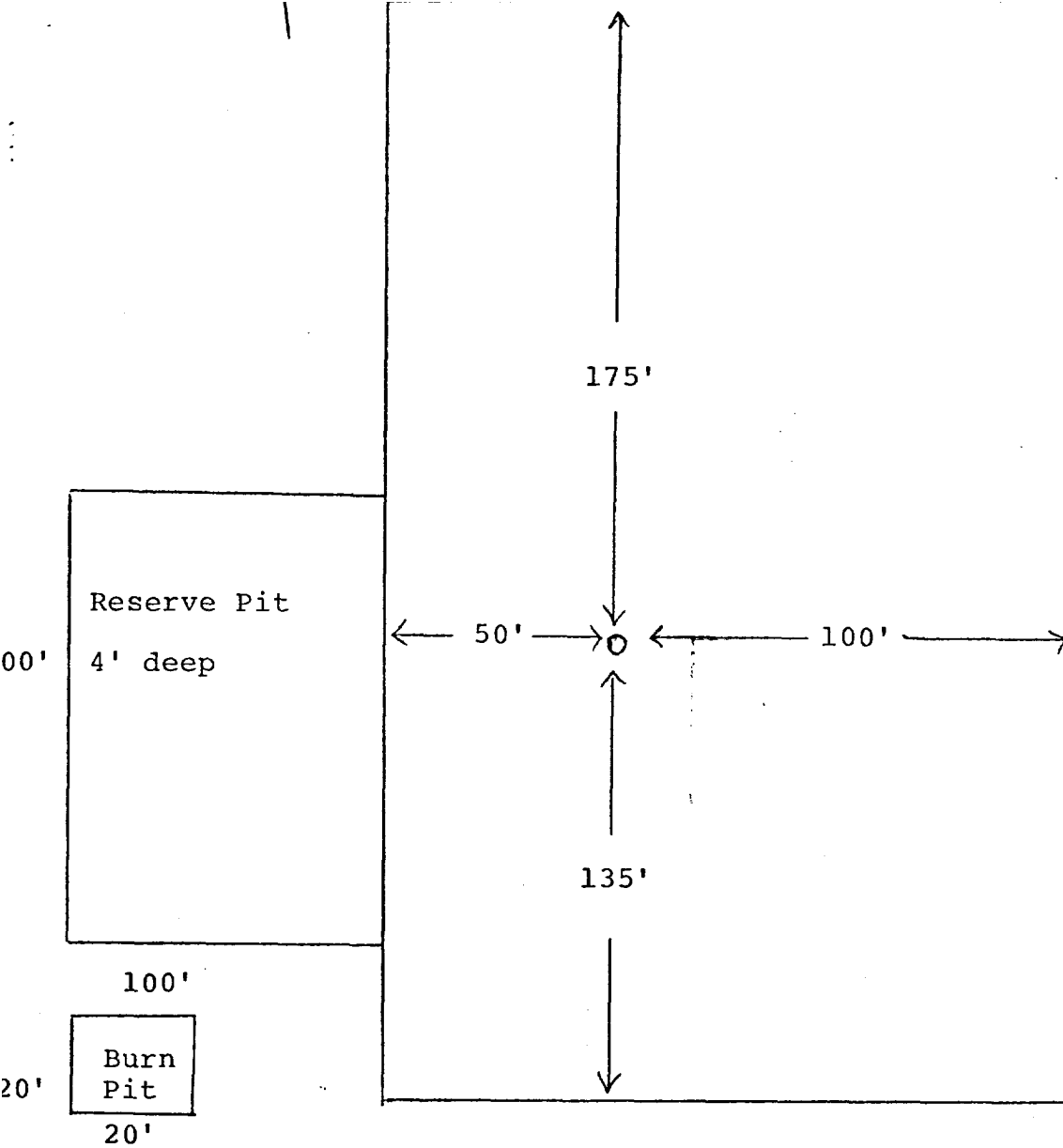

DIAGRAM OF WELL LOCATION

