

UNITED STATES  
DEPARTMENT OF THE INTERIOR  
GEOLOGICAL SURVEY

30-043-20186

APPLICATION FOR PERMIT TO DRILL, DEEPEN, OR PLUG BACK

1a. TYPE OF WORK

DRILL ☐

DEEPEN ☐

PLUG BACK ☐

b. TYPE OF WELL

OIL  
WELL ☒

GAS  
WELL ☐

OTHER

SINGLE  
ZONE ☐

MULTIPLE  
ZONE ☐

2. NAME OF OPERATOR

Chace Oil Company, Inc.

3. ADDRESS OF OPERATOR

313 Washington, S.E., Albuquerque, N.M. 87108

4. LOCATION OF WELL (Report location clearly and in accordance with any State requirements.)\*  
At surface

Unit "G" 1850' NL & 900' EL

At proposed prod. zone

14. DISTANCE IN MILES AND DIRECTION FROM NEAREST TOWN OR POST OFFICE\*

Regina, N.M. 10 miles N.W.

15. DISTANCE FROM PROPOSED\*

LOCATION TO NEAREST  
PROPERTY OR LEASE LINE, FT.  
(Also to nearest drlg. unit line, if any)

900'

16. NO. OF ACRES IN LEASE

2560

17. NO. OF ACRES ASSIGNED  
TO THIS WELL

320

18. DISTANCE FROM PROPOSED LOCATION\*

TO NEAREST WELL, DRILLING, COMPLETED,  
OR APPLIED FOR, ON THIS LEASE, FT.

1000'

19. PROPOSED DEPTH

7500

20. ROTARY OR CABLE TOOLS

Rotary

21. ELEVATIONS (Show whether DF, RT, GR, etc.)

7235' GR

22. APPROX. DATE WORK WILL START\*

Nov. 1, 1975

23.

PROPOSED CASING AND CEMENTING PROGRAM

| SIZE OF HOLE | SIZE OF CASING | WEIGHT PER FOOT | SETTING DEPTH | QUANTITY OF CEMENT |
|--------------|----------------|-----------------|---------------|--------------------|
| 12 1/2"      | 8-5/8"         | 24#             | 250'          | 160 sxs            |
|              |                |                 |               |                    |
|              |                |                 |               |                    |

Plan to drill to 7500' - Use low water loss mud system, Log with Induction and Density logs. Run in approximately 7400' 4 1/2" 11.6# csg. Cement with approximately 1800 sxs A & B cement. Perforate and frac with 200,000# of 20-40 sand and 4700 bbls. slick water.

IN ABOVE SPACE DESCRIBE PROPOSED PROGRAM: If proposal is to deepen or plug back, give data on present productive zone and proposed new productive zone. If proposal is to drill or deepen directionally, give pertinent data on subsurface locations and measured and true vertical depths. Give blowout preventer program, if any.

24.

SIGNED

*Ray W. McCarty*

TITLE

President

DATE

Sept. 8, 1975

(This space for Federal or State office use)

PERMIT NO.

APPROVAL DATE

APPROVED BY

TITLE

DATE

CONDITIONS OF APPROVAL, IF ANY:

*Okal*

*St*

\*See Instructions On Reverse Side

**NEW MEXICO OIL CONSERVATION COMMISSION  
WELL LOCATION AND ACREAGE DEDICATION PLAT**

Form 1-1-1  
Supersedes C-128  
Effective 1-1-65

All distances must be from the outer boundaries of the Section

|  |                                       |                             |                                       |                           |                      |
|--|---------------------------------------|-----------------------------|---------------------------------------|---------------------------|----------------------|
| Operator<br><b>CHACE OIL COMPANY</b>   |                                       |                             | Lease<br><i>Chace Apache 54</i>       |                           | Well No.<br><i>2</i> |
| Tract Letter<br><b>G</b>   | Section<br><b>34</b>                  | Township<br><b>23 NORTH</b> | Range<br><b>3 WEST</b>                | County<br><b>SANDOVAL</b> |                      |
| Actual Postage Location of Well:<br><div style="display: flex; justify-content: space-between; align-items: center;"> <span><b>1850</b> feet from the <b>NORTH</b> line and</span> <span><b>900</b> feet from the <b>EAST</b> line</span> </div> |                                       |                             |                                       |                           |                      |
| Ground Level Elev.<br><b>7235</b>  | Producing Formation<br><i>Alakata</i> | Pool<br><i>Basin</i>        | Dedicated Acreage<br><b>320</b> Acres |                           |                      |

1. Outline the acreage dedicated to the subject well by colored pencil or hatchure marks on the plat below.
2. If more than one lease is dedicated to the well, outline each and identify the ownership thereof (both as to working interest and royalty).
3. If more than one lease of different ownership is dedicated to the well, have the interests of all owners been consolidated by communitization, unitization, force-pooling, etc?

☐ Yes   ☐ No   If answer is "yes," type of consolidation \_\_\_\_\_

If answer is "no," list the owners and tract descriptions which have actually been consolidated. (Use reverse side of this form if necessary.) \_\_\_\_\_

No allowable will be assigned to the well until all interests have been consolidated (by communitization, unitization, forced-pooling, or otherwise) or until a non-standard unit, eliminating such interests, has been approved by the Commission.

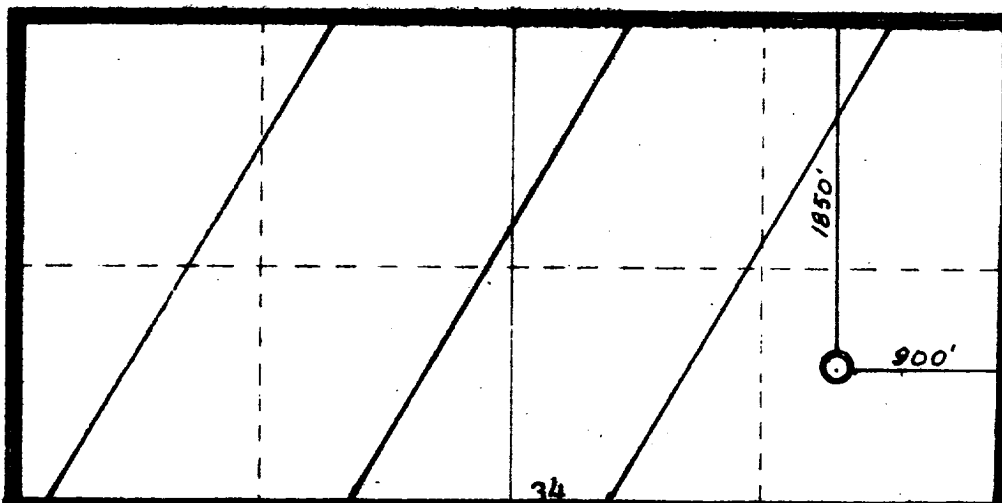

**CERTIFICATION**

I hereby certify that the information contained herein is true and complete to the best of my knowledge and belief.

*Royce McCary*  
\_\_\_\_\_  
Royce McCary

President

Chace Oil Company, Inc.

Sept. 8, 1975

I hereby certify that the well location shown on this plat was located from field notes of a real survey made by me under my supervision, and that the same is true and correct to the best of my knowledge and belief.

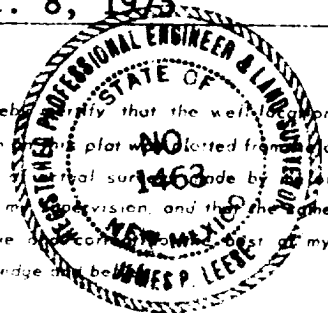

25 August 1975

*James P. Lease*  
\_\_\_\_\_  
James P. Lease

1463

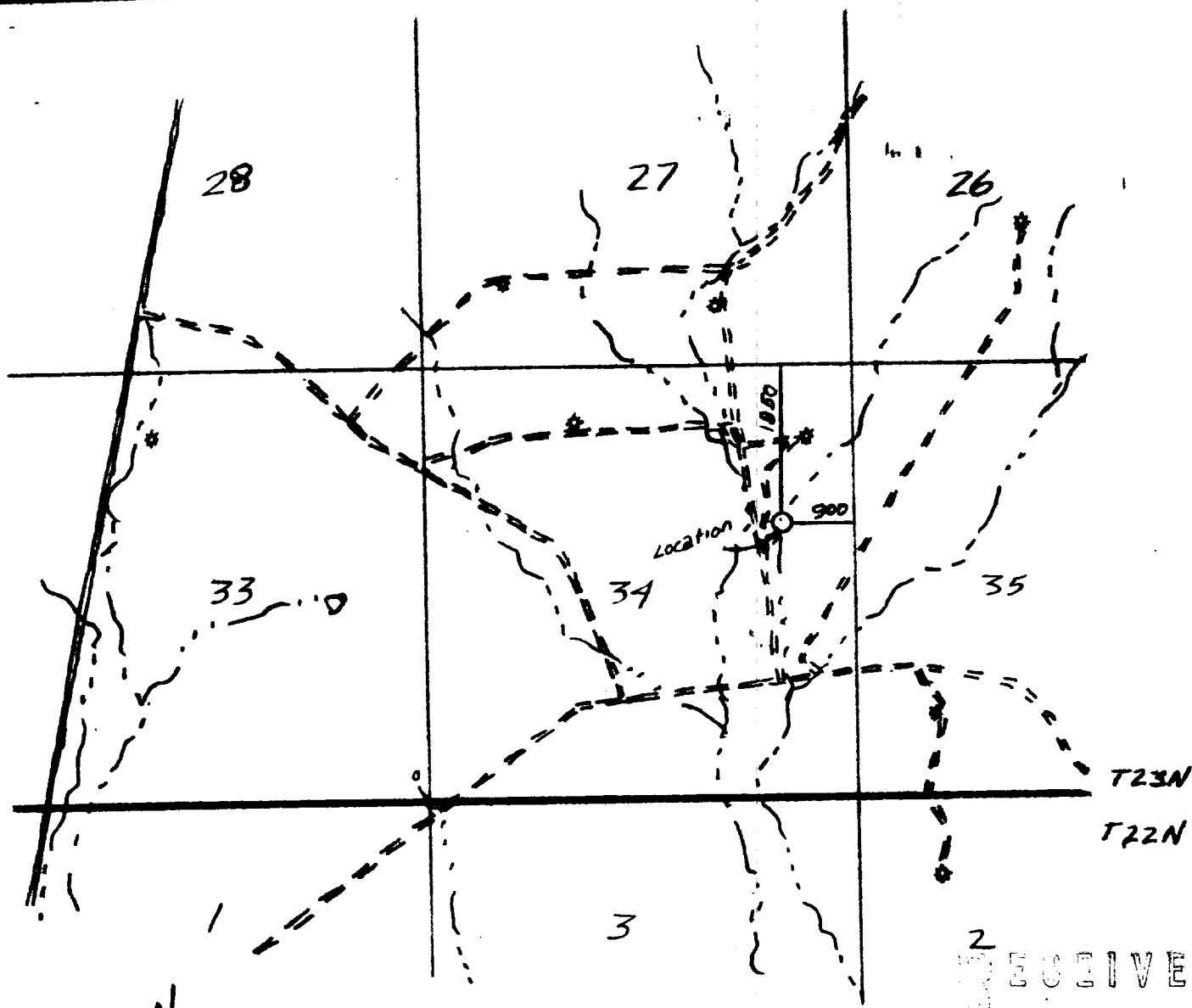

R3W

2  
RECEIVED

SEP 12 1975

U. S. GEOLOGICAL SURVEY  
DURANGO, COLO.

VICINITY MAP FOR

CHACE OIL COMPANY

Showing locations in the  
SE1/4 NE1/4, Sec. 34, T23N,  
R3W, N.M.P.M., Sandoval  
County, New Mexico.

Date: 25 August, 1975 Scale: 1" = 2000'

SAN JUAN ENGINEERING CO.