

UNITED STATES
DEPARTMENT OF THE INTERIOR
GEOLOGICAL SURVEY

APPLICATION FOR PERMIT TO DRILL, DEEPEN, OR PLUG BACK

1a. TYPE OF WORK

DRILL ☒DEEPEN ☐PLUG BACK ☐

b. TYPE OF WELL

OIL
WELL ☒GAS
WELL ☐

OTHER

SINGLE
ZONE ☒MULTIPLE
ZONE ☐

2. NAME OF OPERATOR

Filon Exploration Corporation

3. ADDRESS OF OPERATOR

c/o Minerals Management Inc.

501 Airport Dr., Suite 105, Farmington, New Mex. 87401

4. LOCATION OF WELL (Report location clearly and in accordance with any State requirements.)*

At surface

2090' FSL, 365' FEL, Sec. 7, T20N, R2W

At proposed prod. zone

14. DISTANCE IN MILES AND DIRECTION FROM NEAREST TOWN OR POST OFFICE*

9 miles Southwest of Cuba, New Mexico

15. DISTANCE FROM PROPOSED*

LOCATION TO NEAREST

PROPERTY OR LEASE LINE, FT.

(Also to nearest drlg. unit line, if any) 365'

16. NO. OF ACRES IN LEASE

1920

18. DISTANCE FROM PROPOSED LOCATION*

TO NEAREST WELL, DRILLING, COMPLETED,
OR APPLIED FOR, ON THIS LEASE, FT.

19. PROPOSED DEPTH

6400

17. NO. OF ACRES ASSIGNED
TO THIS WELL

40

20. ROTARY OR CABLE TOOLS

Rotary

21. ELEVATIONS (Show whether DF, RT, GR, etc.)

7010 GR

22. APPROX. DATE WORK WILL START*

December 20, 1975

23. PROPOSED CASING AND CEMENTING PROGRAM

SIZE OF HOLE	SIZE OF CASING	WEIGHT PER FOOT	SETTING DEPTH	QUANTITY OF CEMENT
15"	10 3/4"	40.50#	200	200 sx
8 3/4"	7"	23-26#	6400	300-500 sx

Filon Exploration Corporation (operator) proposes to drill a Jurassic test to 6400'. Completion to be determined from logs. A Series 900 (3000 PSI), Blowout preventer will be used.

NOTE: This is a tight hole.

IN ABOVE SPACE DESCRIBE PROPOSED PROGRAM: If proposal is to deepen or plug back, give data on present productive zone and proposed new productive zone. If proposal is to drill or deepen directionally, give pertinent data on subsurface locations and measured and true vertical depths. Give blowout preventer program, if any.

24.

SIGNED

TITLE

Area Manager

Minerals Management Inc.

DATE

12-9-75

(This space for Federal or State office use)

PERMIT NO.

APPROVAL DATE

APPROVED BY

TITLE

DATE

CONDITIONS OF APPROVAL, IF ANY:

*See Instructions On Reverse Side

NEW MEXICO OIL CONSERVATION COMMISSION
WELL LOCATION AND ACREAGE DEDICATION PLAT

Form C-102
Supersedes C-128
Effective 1-1-65

All distances must be from the outer boundaries of the Section.

Operator Filon Exploration		Lease Federal 7		Well No. 1
Unit Letter I	Section 7	Township 20N	Range 2W	County Sandoval
Actual Footage Location of Well: 2090 feet from the South line and 365 feet from the East line				
Ground Level Elev. 7010	Producing Formation Jurassic Entrada	Pool Wildcat	Dedicated Acreage: 40 Acres	

1. Outline the acreage dedicated to the subject well by colored pencil or hachure marks on the plat below.
2. If more than one lease is dedicated to the well, outline each and identify the ownership thereof (both as to working interest and royalty).
3. If more than one lease of different ownership is dedicated to the well, have the interests of all owners been consolidated by communitization, unitization, force-pooling, etc?

☐ Yes ☐ No If answer is "yes," type of consolidation _____

If answer is "no," list the owners and tract descriptions which have actually been consolidated. (Use reverse side of this form if necessary.) _____

No allowable will be assigned to the well until all interests have been consolidated (by communitization, unitization, forced-pooling, or otherwise) or until a non-standard unit, eliminating such interests, has been approved by the Commission.

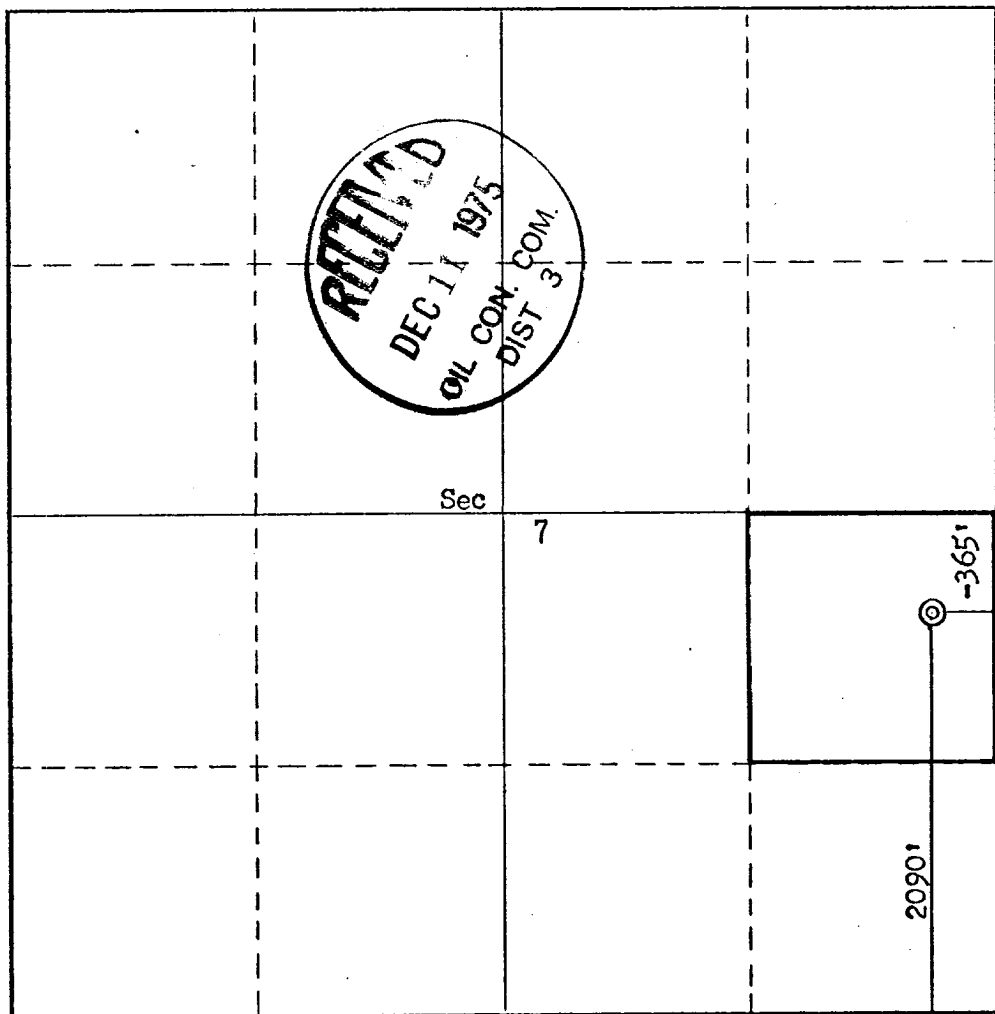

CERTIFICATION

I hereby certify that the information contained herein is true and complete to the best of my knowledge and belief.

Name *J. Arnold Snell*
Position
Area Manager
Company
Minerals Management Inc.
Date
December 9, 1975

I hereby certify that the well location shown on this plat was plotted from field notes of actual surveys made by me or under my supervision, and that the same is true and correct to the best of my knowledge and belief.

Date Surveyed
December 6, 1975
Registered Professional Engineer and/or Land Surveyor
Fred B. Kerr Jr.
Certificate No.
3950

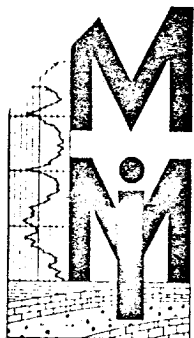

MINERALS
MANAGEMENT INC.

TELEPHONE (505) 327-4441
501 AIRPORT DRIVE—PETROLEUM CENTER BUILDING
SUITE 210
FARMINGTON, NEW MEXICO 87401

DEVELOPMENT PLAN FOR SURFACE USE

FILON EXPLORATION CORPORATION

FEDERAL 7 WELL NO. 1

2090' FSL, 365' FEL, SEC. 7, T20N, R2W

SANDOVAL COUNTY, NEW MEXICO

1. Existing Roads

The main road in the area is Torreon Highway #197 (shown on the attached topographic map).

2. Planned Access Road

The existing road to Filon's Federal 18 Well No. 1 will be utilized as per topographic map with the new portion of the road to be minimal.

3. Location of Existing Road

Filon's Federal 18 Well No. 1, Plugged and Abandoned, 2310' FNL, 2000' FEL, Sec. 18 T20N, R2W.

4. Lateral Roads

Shown on topographic map, approximately 2 miles of road to be built. Road to be 20' wide and bar ditched to prevent erosion.

5. Location of Tank Batteries and Flowlines

Will be initially located on drill pad approximately 150' from well if production is encountered.

6. Water Supply

Water will be hauled to the wellsite. Water to be hauled from BLM Encino water well.

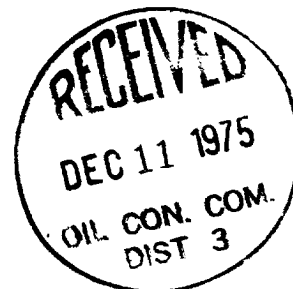

7. Method of Handling Waste Disposal

Waste will be buried in the reserve pit on completion of the well. The reserve pit will be backfilled. Toilet facilities will be provided.

8. Location of Camp

No camp will be used.

9. Location of Airstrip

None

10. Diagram of Well Location

See attached diagram

11. Restoration of Surface

Surface to be restored as directed by Bureau of Land Management.

12. Impact on the Environment

Impact to be minimal. The access road will follow seismic trail with location in Pinon and Juniper trees. Damage to be kept to a minimum.



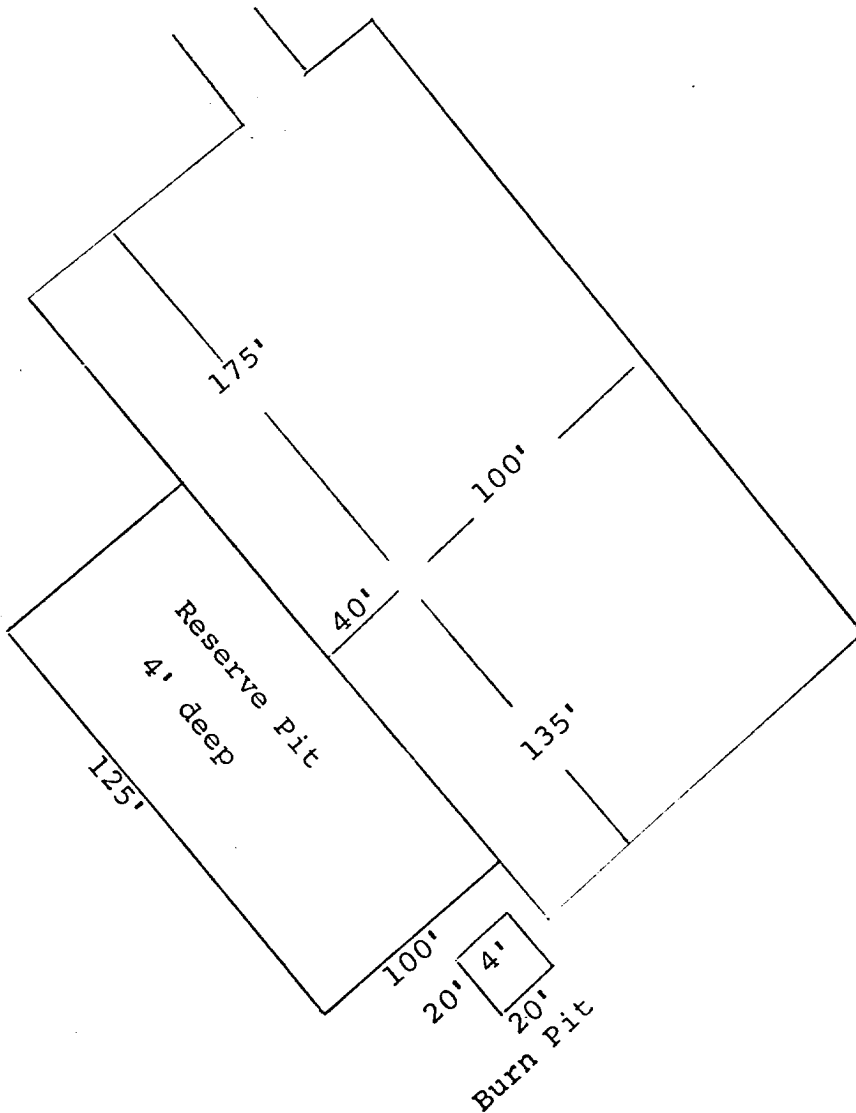

WELL DIAGRAM

