

SURFACE USE AND OPERATION PLAN
FOR
SAN JOSE #1 SW $\frac{1}{4}$ Section 14 T22N R2W
SANDOVAL COUNTY, NEW MEXICO

Enclosed is a copy of the U.S.G.S. Topographic map covering the area of the captioned well. Existing roads are shown on this map. The acreage dedicated to this well is shown in yellow while the location and proposed access roads are colored red.

Water for drilling will be obtained from a local rancher North of the location approximately 10 miles.

Waste disposal will be either burned in the burn pit, latrine or reserve pit as applicable.

There will be no air strip or camp associated with the drilling of this test.

Enclosed is a map of the rig and well site layout,

Upon completion or abandonment of the well, the location will be cleaned, leveled and restored and a dry hole marker placed if applicable.

Surface ownership is the Jicarilla-Apache Indians. The terrain at the well site is nearly flat with only minor relief. Vegetation consists of mainly sage brush and sparse range grass.

Other BLM stipulations will be followed.

Lynco's Field Representative is:

James M. Ray
2001 Western Avenue
Farmington, New Mexico 87401
PHONE (505) 325-8083

CERTIFICATION

I hereby certify that I, or persons under my direct supervision, have inspected the proposed drill site and access route; that I am familiar with the conditions which presently exist; that the statements made in this plan are, to the best of my knowledge are true and correct; and that the work associated with the operations proposed herein will be performed by Lynco Oil Corporation and its contractors and subcontractors in conformity with this plan and the terms and conditions under which it is approved.

August 3, 1976
Date

James M. Ray
James M. Ray - Field Manager

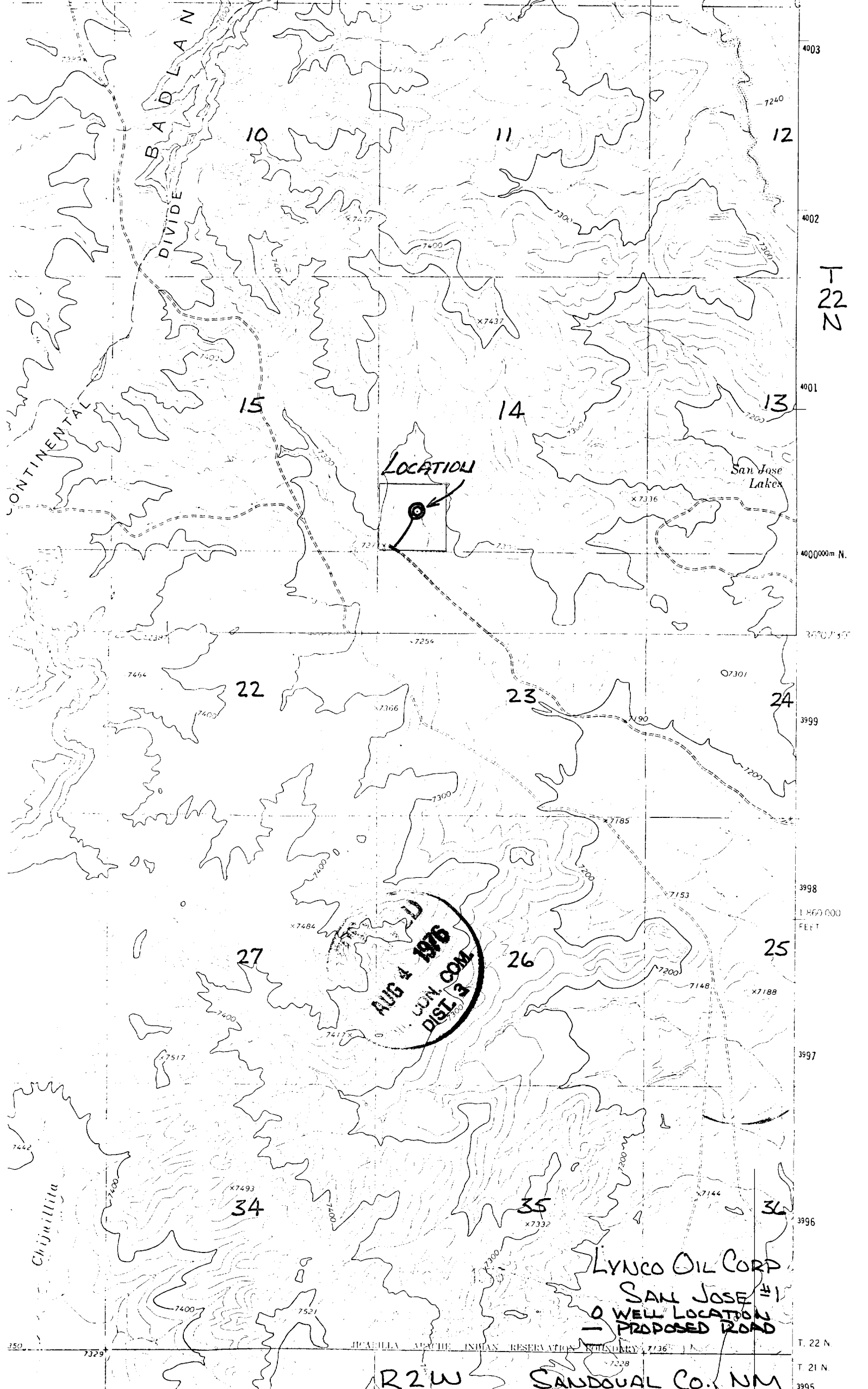

4003

4002

4001

4000000m N.

3999

3998

1860000

FEET

3997

3996

T. 22 N.

T. 21 N.

3995

T
22
N

LOCATION

AUG 4 1976
U.S. CON. COM.
DIST. 2

LYNCO OIL CORP.
SAN JOSE #1
WELL LOCATION
PROPOSED ROAD

R2W

SANDOVAL CO., NM

CHICILLA APACHE INDIAN RESERVATION BOUNDARY

350 7329

7136

7228

- 1. Infringe
- 2. Mud Ramp
- 3. Propane Tank

WELL SITE LAYOUT

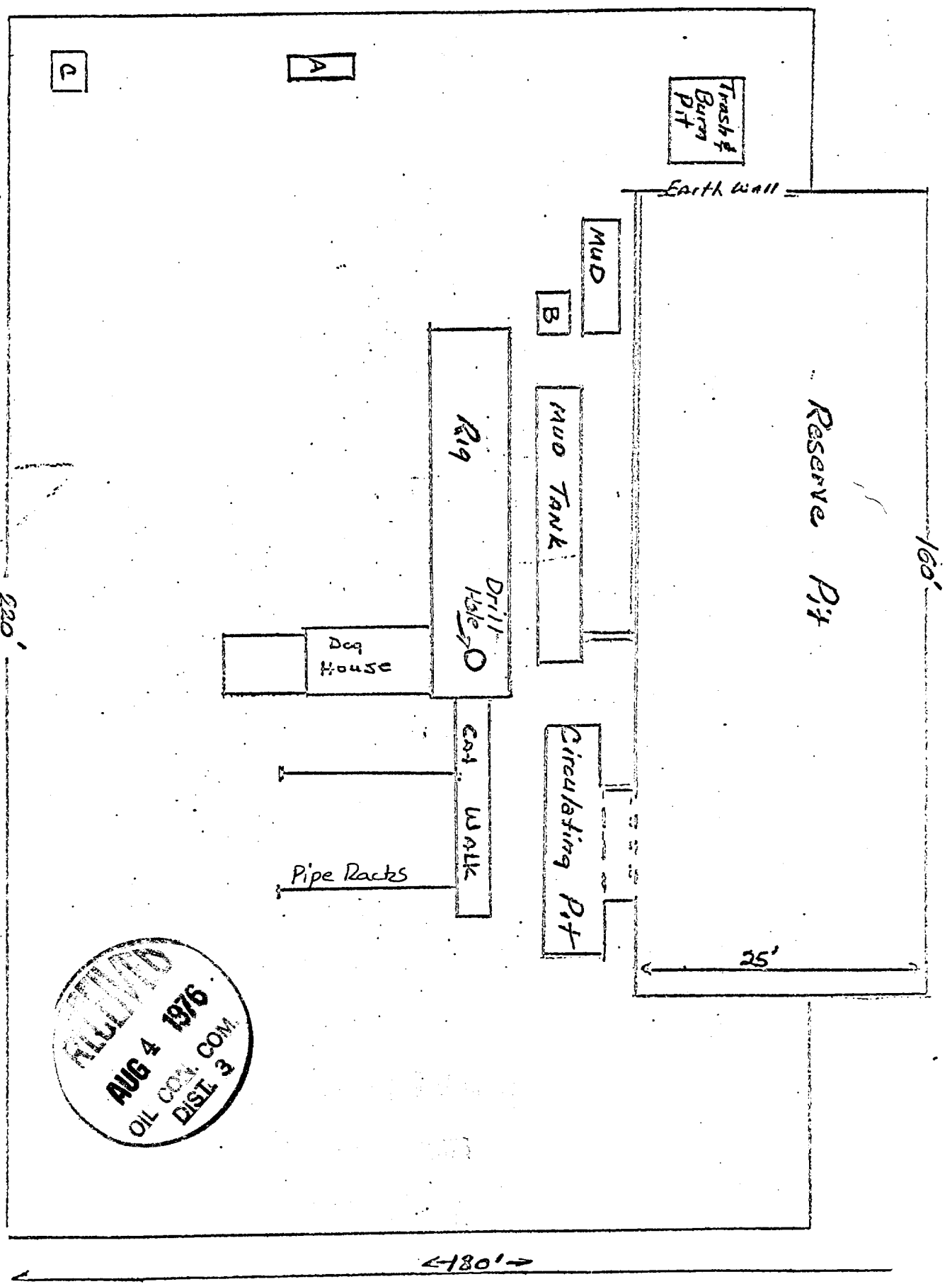

LYNCO OIL CORP
SNA JOSE #1