

UNITED STATES
DEPARTMENT OF THE INTERIOR
GEOLOGICAL SURVEY

APPLICATION FOR PERMIT TO DRILL, DEEPEN, OR PLUG BACK

1a. TYPE OF WORK
DRILL ☒ DEEPEN ☐ PLUG BACK ☐

b. TYPE OF WELL
OIL WELL ☒ GAS WELL ☐ OTHER ☐ SINGLE ZONE ☒ MULTIPLE ZONE ☐

2. NAME OF OPERATOR
CHACE OIL COMPANY, INC.

3. ADDRESS OF OPERATOR
313 Washington, S.E., Albuquerque, New Mex. 87108

4. LOCATION OF WELL (Report location clearly and in accordance with any State requirements.)*
At surface Unit "A" 790' NL & 790' EL
At proposed prod. zone Same

14. DISTANCE IN MILES AND DIRECTION FROM NEAREST TOWN OR POST OFFICE*
Regina, New Mexico - 13 miles NE

15. DISTANCE FROM PROPOSED*
LOCATION TO NEAREST
PROPERTY OR LEASE LINE, FT.
(Also to nearest drlg. unit line, if any)
790'

16. NO. OF ACRES IN LEASE
1600

17. NO. OF ACRES ASSIGNED
TO THIS WELL
40

18. DISTANCE FROM PROPOSED LOCATION*
TO NEAREST WELL, DRILLING COMPLETED
OR APPLIED FOR, ON THIS LEASE, FT.
2670'

19. PROPOSED DEPTH
7800'

20. ROTARY OR CABLE TOOLS
Rotary

21. ELEVATIONS (Show whether DF, RT, GR, etc.)
7324' GR

22. APPROX. DATE WORK WILL START*

5. LEASE DESIGNATION AND SERIAL NO.
30-043-20253

6. IF INDIAN, ALLOTTEE OR TRIBE NAME
Jicarilla 15

7. UNIT AGREEMENT NAME
Jicarilla Apache

8. FARM OR LEASE NAME
Chace Apache 15

9. WELL NO.
1

10. FIELD AND POOL, OR WILDCAT
Chacon Dakota Exr

11. SEC., T., R., M., OR BLK.
AND SURVEY OR AREA
Sec. 20, T23N-R3W

12. COUNTY OR PARISH
Sandoval

13. STATE
New Mex.

23. PROPOSED CASING AND CEMENTING PROGRAM				
SIZE OF HOLE	SIZE OF CASING	WEIGHT PER FOOT	SETTING DEPTH	QUANTITY OF CEMENT
13½	8-5/8	24#	250'	225 sxs

Drill 265' 13½ surface hole, set 250' 8-5/8" csg. Cement to surface with 225 sxs. Using oil base mud (15%) oil and adequate BOP drill a 7-7/8" hole to 7800' to test the Dakota formation. If productive run 4½" 10.5# or heavier csg. to total depth and cement in stages to cover the producing zones including the Pictured Cliffs formation. If non-productive plug and abandon.

IN ABOVE SPACE DESCRIBE PROPOSED PROGRAM: If proposal is to deepen or plug back, give data on present productive zone and proposed new productive zone. If proposal is to drill or deepen directionally, give pertinent data on subsurface locations and measured and true vertical depths. Give blowout preventer program, if any.

24. SIGNED Lyle M. Cary TITLE President DATE 10-19-76
(This space for Federal or State office use)

PERMIT NO. _____ APPROVAL DATE _____

APPROVED BY _____ TITLE _____ DATE _____
CONDITIONS OF APPROVAL, IF ANY:

*See Instructions On Reverse Side

NEW MEXICO OIL CONSERVATION COMMISSION WELL LOCATION AND ACERAGE DEDICATION PLAT

All distances must be from the outer boundaries of the Section

Operator CHACE OIL COMPANY			Lease CHACE APACHE 15		Well No 1
Unit Letter 21	Section 20	Township 23 NORTH	Range 3 WEST	County SANDOVAL	
Actual Footage Location of Well: 790 feet from the NORTH line and 790 feet from the EAST line					
Ground Level Elev. 7324	Producing Formation DAKOTA		Pool CHACON DAKOTA EXT	Dedicated Acreage 40	Acres

1. Outline the acreage dedicated to the subject well by colored pencil or hachure marks on the plat below.
2. If more than one lease is dedicated to the well, outline each and identify the ownership thereof (both as to working interest and royalty).
3. If more than one lease of different ownership is dedicated to the well, have the interests of all owners been consolidated by communitization, unitization, force-pooling, etc?

☐ Yes ☐ No If answer is "yes," type of consolidation

If answer is "no," list the owners and tract descriptions which have actually consolidated. (Use reverse side of this form if necessary.)

No allowable will be assigned to the well until all interests have been consolidated (by communitization, unitization, forced-pooling, or otherwise) or until a non standard unit, eliminating such interests, has been approved by the Commission.

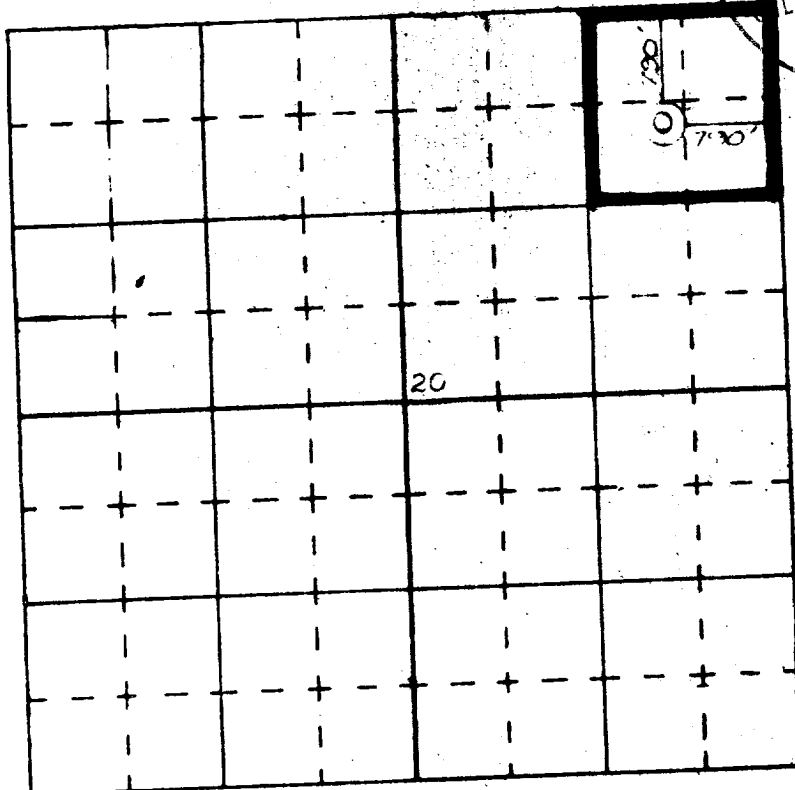

CERTIFICATION

I hereby certify that the information contained herein is true and complete to the best of my knowledge and belief.

Royce McCary
Name
Position **President**
Company **Chace Oil Co., Inc.**

Date
10-19-76

I hereby certify that the well location shown on this plat was plotted from field notes of actual surveys made by me or under my supervision, and that the same is true and correct to the best of my knowledge and belief.

Date Surveyed **14 October 1976**
James P. Lee
Registered Professional Engineer
and/or Land Surveyor **James P. Lee**

Certificate No. **1463**