

UNITED STATES  
DEPARTMENT OF THE INTERIOR  
GEOLOGICAL SURVEY

## APPLICATION FOR PERMIT TO DRILL, DEEPEN, OR PLUG BACK

1a. TYPE OF WORK

DRILL ☒DEEPEN ☐PLUG BACK ☐

b. TYPE OF WELL

OIL  
WELL ☐GAS  
WELL ☒OTHER ☐SINGLE  
ZONE ☒MULTIPLE  
ZONE ☐

2. NAME OF OPERATOR

CHACE OIL COMPANY, INC.

3. ADDRESS OF OPERATOR

313 Washington, SE Albuquerque, NM 87108

4. LOCATION OF WELL (Report location clearly and in accordance with any State requirements.)\*

At surface

Unit "D" 790' SL 1190 EL

At proposed prod. zone

Same

14. DISTANCE IN MILES AND DIRECTION FROM NEAREST TOWN OR POST OFFICE\*

Counselors, NM 14 miles E-NE

15. DISTANCE FROM PROPOSED\*

LOCATION TO NEAREST  
PROPERTY OR LEASE LINE, FT.  
(Also to nearest drilg. unit line, if any)

1190'

18. DISTANCE FROM PROPOSED LOCATION\*

TO NEAREST WELL, DRILLING COMPLETED,  
OR APPLIED FOR, ON THIS LEASE, FT.

2900'

16. NO. OF ACRES IN LEASE

160

19. PROPOSED DEPTH

2000'

21. ELEVATIONS (Show whether DF, RT, GR, etc.)

6758 GR

23.

## PROPOSED CASING AND CEMENTING PROGRAM

SIZE OF HOLE

12 3/4"

SIZE OF CASING

8 5/8"

WEIGHT PER FOOT

24#

SETTING DEPTH

100'

QUANTITY OF CEMENT

100 sxs

Drill 12 3/4" hole to 103', Set 8 5/8" csg. to approx. 100'  
Cement to surface. Using adequate mud system and BOP drill a  
7 7/8" hole to 2000' - Log with Induction & Density logs. If  
productive run 4 1/2" - 9.5# csg to TD and complete as gas well.

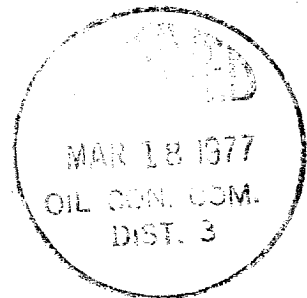

IN ABOVE CASE, DESCRIBE PROPOSED PROGRAM. If proposal is to deepen or plug back, give data on present productive zone and proposed new productive zone. If proposal is to drill or deepen directionally, give pertinent data on subsurface locations and measured and true vertical depths. Give flowout prevention program, if any.

24.

SIGNED

*Raymond M. Cary*

President

DATE

3-14-77

(This space for Federal or State office use)

PERMIT NO.

APPROVAL DATE

APPROVED BY

TITLE

DATE

CONDITIONS OF APPROVAL, IF ANY.

\*See Instructions On Reverse Side

# NEW MEXICO OIL CONSERVATION COMMISSION WELL LOCATION AND ACERAGE DEDICATION PLAT

All distances must be from the outer boundaries of the Section

Operator <b>CHACE OIL COMPANY</b>		Lease <b>RUSTY NAVAJO</b>		Well No <b>8</b>	
Unit Letter <b>P</b>	Section <b>22</b>	Township <b>22 NORTH</b>	Range <b>7 WEST</b>	County <b>SANDOVAL</b>	
Actual Footage Location of Well: <b>790</b> feet from the <b>SOUTH</b> line and <b>1190</b> feet from the <b>EAST</b> line					
Ground Level Elev. <b>6758</b>	Producing Formation <b>Chacra</b>		Pool <b>Rusty</b>	Dedicated Acreage <b>16.0</b>	Acres

- Outline the acreage dedicated to the subject well by colored pencil or hatchure marks on the plat below.
- If more than one lease is dedicated to the well, outline each and identify the ownership thereof (both as to working interest and royalty).
- If more than one lease of different ownership is dedicated to the well, have the interests of all owners been consolidated by communitization, unitization, force-pooling, etc?

( ) Yes ( ) No If answer is "yes," type of consolidation \_\_\_\_\_

If answer is "no," list the owners and tract descriptions which have actually consolidated (Use reverse side of this form if necessary.) \_\_\_\_\_

No allowable will be assigned to the well until all interests have been consolidated (by communitization, unitization, forced-pooling, or otherwise) or until a non standard unit, eliminating such interests, has been approved by the Commission

## CERTIFICATION

I hereby certify that the information contained herein is true and complete to the best of my knowledge and belief.

*Royce McCary*  
Name  
**Royce McCary**

Position  
**President**

Company  
**Chace Oil Co.**

Date  
**3-14-77**

I hereby certify that the well location shown on this plat was plotted from field notes of actual surveys made by me or under my supervision, and that the same is true and correct to the best of my knowledge and belief.

**2 March 1977**  
Date Surveyed  
*James P. Leese*  
Registered Professional Engineer  
and/or Land Surveyor **James P. Leese**

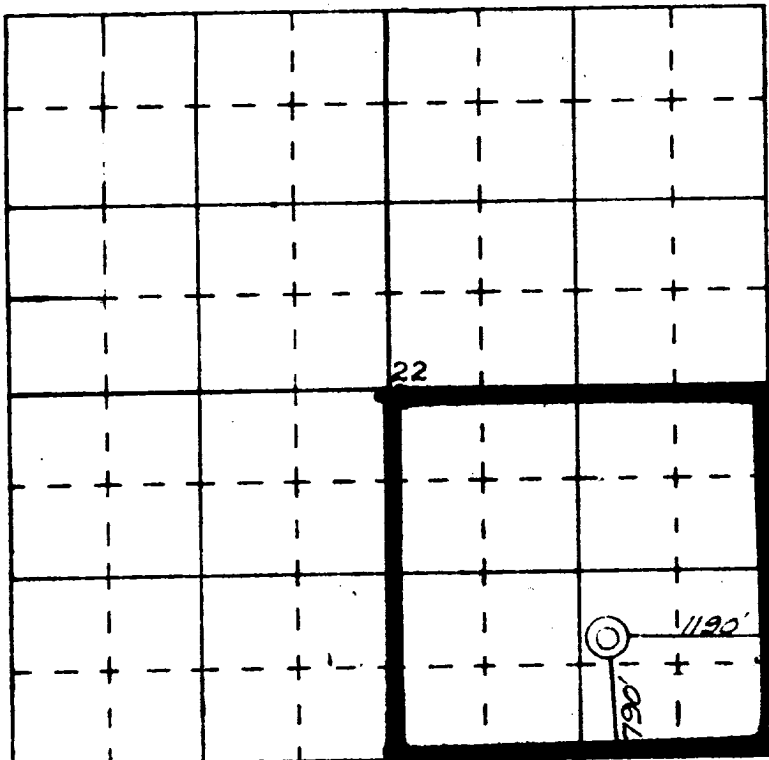

SCALE—4 INCHES EQUALS 1 MILE

SAN JUAN ENGINEERING COMPANY, FARMINGTON, N. M.

**1463**  
Certificate No.