

UNITED STATES
DEPARTMENT OF THE INTERIOR
GEOLOGICAL SURVEY

APPLICATION FOR PERMIT TO DRILL, DEEPEN, OR PLUG BACK

1a. TYPE OF WORK

DRILL ☒DEEPEN ☐PLUG BACK ☐

b. TYPE OF WELL

OIL
WELL ☐GAS
WELL ☒

OTHER

SINGLE
ZONE ☐MULTIPLE
ZONE ☐

2. NAME OF OPERATOR

Dome Petroleum Corp.

3. ADDRESS OF OPERATOR Minerals Management Inc., Suite 105,
501 Airport Drive, Farmington, New Mexico 87401

4. LOCATION OF WELL (Report location clearly and in accordance with any State requirements.)*

At surface

M 950' FSL, 830' FWL, SEC. 7, T22N, R6W

At proposed prod. zone

14. DISTANCE IN MILES AND DIRECTION FROM NEAREST TOWN OR POST OFFICE*

6 miles southwest of Counselor

15. DISTANCE FROM PROPOSED*

LOCATION TO NEAREST
PROPERTY OR LEASE LINE, FT.
(Also to nearest drlg. unit line, if any)

830'

16. NO. OF ACRES IN LEASE

1606.96

18. DISTANCE FROM PROPOSED LOCATION*
TO NEAREST WELL, DRILLING, COMPLETED,
OR APPLIED FOR, ON THIS LEASE, FT.

19. PROPOSED DEPTH

2500'

17. NO. OF ACRES ASSIGNED
TO THIS WELL

1606.96

20. ROTARY OR CABLE TOOLS

Rotary

21. ELEVATIONS (Show whether DF, RT, GR, etc.)

6965' GR

22. APPROX. DATE WORK WILL START*

April 15, 1978

23.

PROPOSED CASING AND CEMENTING PROGRAM

SIZE OF HOLE	SIZE OF CASING	WEIGHT PER FOOT	SETTING DEPTH	QUANTITY OF CEMENT
12 1/4	8 5/8	23.75	90	100 sx
6 3/4	4 1/2	10.5	2500	To surface by caliper log

Operator proposes to drill an upper cretaceous test to 2500'. Completion will be determined from logs. A Series 900 (3000 psi WP) blowout preventer will be used. The BOP will be tested to 500 psi before drilling surface plug. Pertinent formation tops are estimated as Pictured Cliffs at 1150' and the Point Lookout at 1500'. Drill stem test will be taken when necessary for evaluation. No abnormal pressures or temperatures are anticipated. Drilling should require approximately 3 days.

IN ABOVE SPACE DESCRIBE PROPOSED PROGRAM: If proposal is to deepen or plug back, give data on present productive zone and proposed new productive zone. If proposal is to drill or deepen directionally, give pertinent data on subsurface locations and measured and true vertical depths. Give blowout preventer program, if any.

24.

SIGNED

W. E. Landry

TITLE

W. E. Landry
Area Manager

DATE 3-3-78

(This space for Federal or State office use)

PERMIT NO.

APPROVAL DATE

APPROVED BY

TITLE

DATE

CONDITIONS OF APPROVAL, IF ANY:

Chal

ST

**NEW MEXICO OIL CONSERVATION COMMISSION
WELL LOCATION AND ACREAGE DEDICATION PLAT**

Form C-102
Supersedes C-128
Effective 1-1-65

All distances must be from the outer boundaries of the Section.

Operator Dome Petroleum Corporation			Lease Dome-Rusty 7-22-6		Well No. 1
Unit Letter M	Section 7	Township 22N	Range 6W	County Sandoval	

Actual Footage Location of Well:

950	feet from the South	line and	830	feet from the West	line
Ground Level Elev. 6965	Producing Formation Chacra-Chacra		Pool Rusty Chacra Extension		Dedicated Acreage: 160 / 61.76 Acres

1. Outline the acreage dedicated to the subject well by colored pencil or hatchure marks on the plat below.
2. If more than one lease is dedicated to the well, outline each and identify the ownership thereof (both as to working interest and royalty).
3. If more than one lease of different ownership is dedicated to the well, have the interests of all owners been consolidated by communitization, unitization, force-pooling, etc?

☐ Yes ☐ No If answer is "yes," type of consolidation _____

If answer is "no," list the owners and tract descriptions which have actually been consolidated. (Use reverse side of this form if necessary.) _____

No allowable will be assigned to the well until all interests have been consolidated (by communitization, unitization, forced-pooling, or otherwise) or until a non-standard unit, eliminating such interests, has been approved by the Commission.

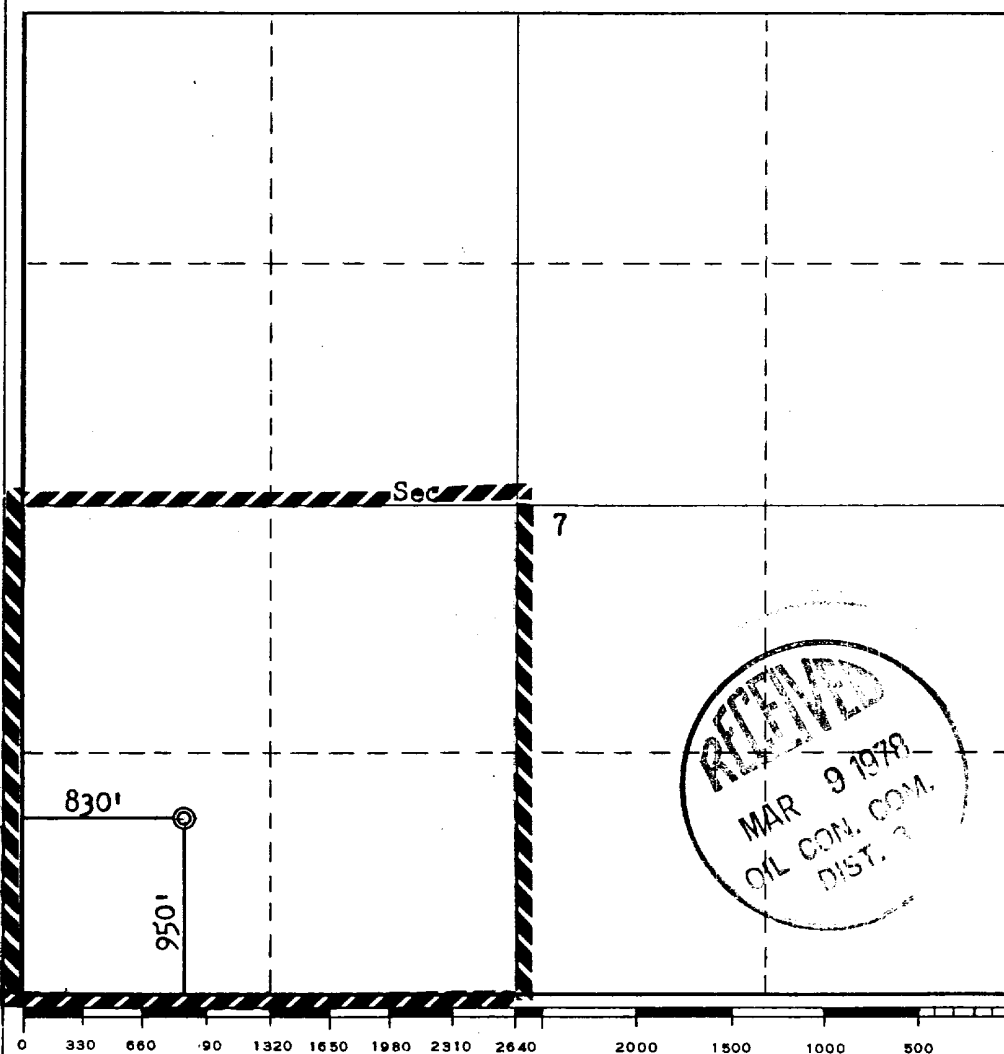

CERTIFICATION

I hereby certify that the information contained herein is true and complete to the best of my knowledge and belief.

[Signature]
 Name
W. E. Landry
 Position
Area Manager
 Company
Minerals Management Inc.
 Date
3-3-78

I hereby certify that the well location shown on this plat was plotted from field notes of actual surveys made by me or under my supervision, and that the same is true and correct to the best of my knowledge and belief.

Date Surveyed
March 1, 1978
 Registered Professional Engineer and/or Land Surveyor
[Signature]
Fred B. Kerr Jr.
 Certificate No.
3950

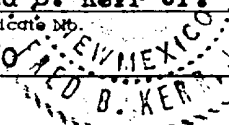

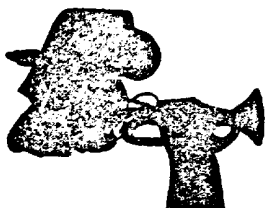

MINERALS MANAGEMENT INCORPORATED

A Division of SCIENTIFIC SOFTWARE CORPORATION

DEVELOPMENT PLAN FOR SURFACE USE

DOME PETROLEUM CORPORATION

DOME RUSTY 7-22-6 WELL NO. 1

SW/4 SW/4 SEC. 7, T22N, R6W

SANDOVAL COUNTY, NEW MEXICO

1. Existing Roads

The main road to location is that from Counselor Trading Post to Pueblo Pintado, leaving this road approximately seven miles south of Counselors and using existing side.

2. Planned Access Roads

The access road, to be routed as shown on the attached map, will be 18' wide with adequate ditch and water bars.

3. Location of Existing Wells

Existing wells within one mile of location are shown on the attached topographic map.

4. Location of Proposed Facilities

Development of commercial gas production will require separation facilities on the location pad. Equipment and pits will be fenced as required for protection of livestock and wildlife. Above-ground facilities will be painted brown or grey to blend with the surrounding area as specified by the BLM. The disturbed areas no longer needed for operations after well completion will be restored to natural contour and reseeded.

5. Location and Type of Water Supply

To be hauled from Escrito, approximately 25 miles to the north.

6. Source of Construction Materials

Not applicable.

7. Method of Handling Waste Material

All garbage and trash that can be burned shall be burned. All trash that cannot be burned will be contained in a trash pit and covered with a minimum of 24 inches of dirt. All drilling waste such as cuttings, overflows of oil, water and drilling fluids will be contained in the reserve pit and buried with adequate cover upon completion of operations. The reserve pit will be fenced until cleanup operations are commenced. Toilet facilities will be provided.

8. Ancillary Facilities

No camps or airstrips are proposed for this location.

9. Well Site Layout

See the attached diagram.

10. Plans for Restoration of Surface

Cleanup of the location will commence immediately following the removal of the drilling equipment. The reserve pit will be fenced until restoration operations are commenced. The location will be returned to original contour if the well is not productive. Both the road and location will be reseeded in accordance with BLM specifications.

11. Other Information

This location is on sparsely vegetated sandy slope. Vegetation consists principally of sagebrush and native grasses. There is no water source in the immediate area.

12. Lessee's or Operator's Representative

Minerals Management Division, Scientific Software Corporation,
501 Airport Drive, Suite 105, Farmington, New Mexico 87401.

13. Certification

I hereby certify that I, or persons under my direct supervision, have inspected the proposed drillsite and access route; that I am familiar with the conditions which presently exist; that the statements made in the plan are, to the best of my knowledge, true and correct; and that the work associated with the operations proposed herein will be performed by Dome Petroleum Corporation and its contractors and subcontractors in conformity with this plan and the terms and conditions under which it is approved.

March 3, 1978
Date

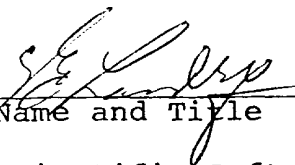
Name and Title Area Manager
Scientific Software Corporation
Minerals Management Division
Company

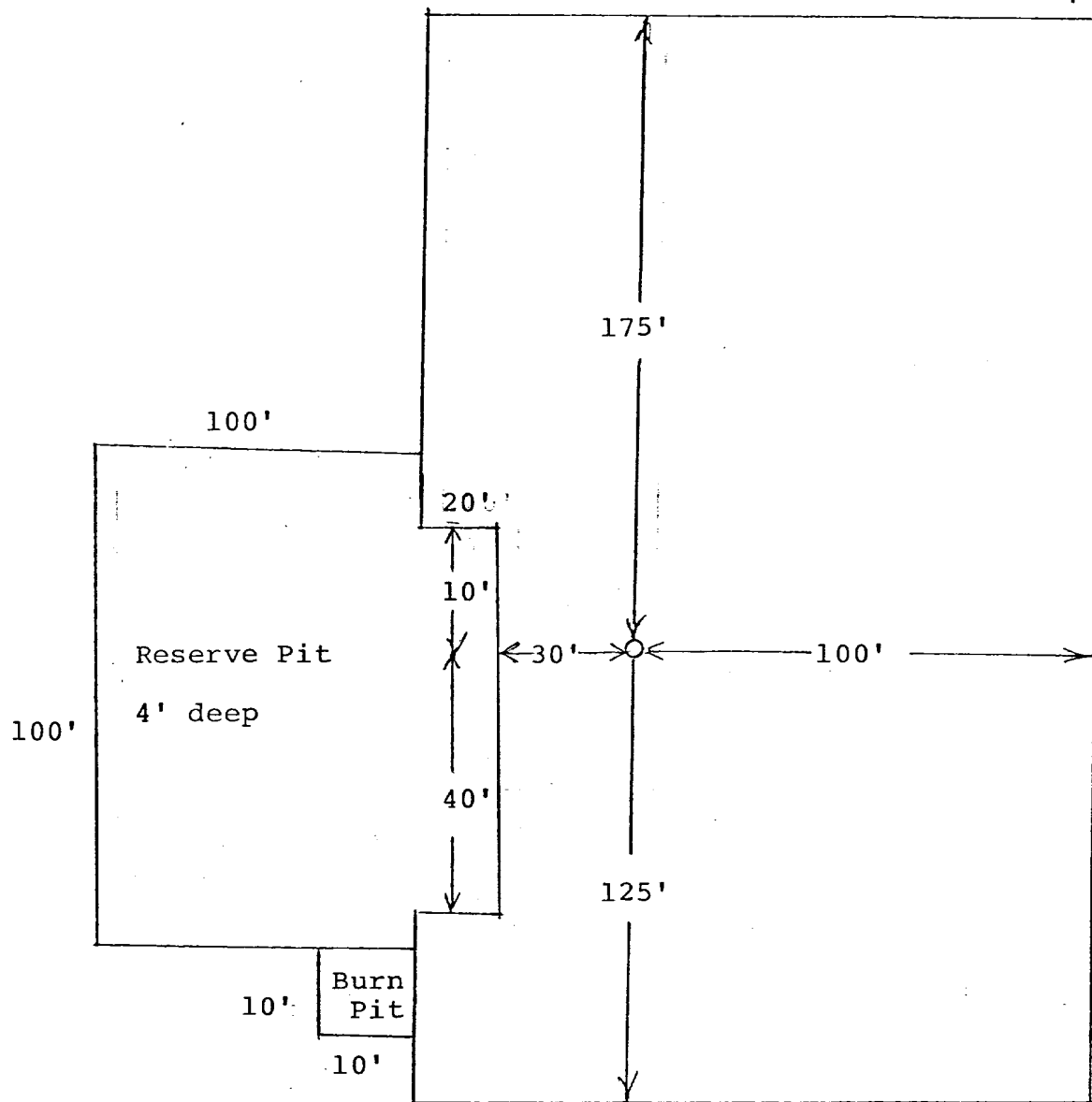

DIAGRAM OF WELL LOCATION

