

UNITED STATES
DEPARTMENT OF THE INTERIOR
GEOLOGICAL SURVEY30-043-20319
5. LEASE DESIGNATION AND SERIAL NO.NM 7262
6. IF INDIAN, ALLOTTEE OR TRIBE NAME

7. UNIT AGREEMENT NAME

8. FARM OR LEASE NAME

Dome Rusty 20-22-7

9. WELL NO.

1

10. FIELD AND POOL, OR WILDCAT

Rusty Chacra Extension

11. SEC., T., R., M., OR BLK.

SEC. 20, T22N, R7W
NMPM

12. COUNTY OR PARISH

Sandoval

13. STATE

N.M.

APPLICATION FOR PERMIT TO DRILL, DEEPEN, OR PLUG BACK

1a. TYPE OF WORK

DRILL ☒DEEPEN ☐PLUG BACK ☐

b. TYPE OF WELL

OIL
WELL ☐

GAS

WELL ☒

OTHER

SINGLE
ZONE ☐MULTIPLE
ZONE ☐

2. NAME OF OPERATOR

Dome Petroleum Corp

3. ADDRESS OF OPERATOR Minerals Management Inc., Suite 105
501 Airport Drive, Farmington, New Mexico 874014. LOCATION OF WELL (Report location clearly and in accordance with any State requirements.)*
At surfaceP 790' FSL, 790' FEL, SEC. 20, T22N, R7W
At proposed prod. zone

14. DISTANCE IN MILES AND DIRECTION FROM NEAREST TOWN OR POST OFFICE*

8 miles south, southwest of Counselor

15. DISTANCE FROM PROPOSED*

LOCATION TO NEAREST
PROPERTY OR LEASE LINE, FT.
(Also to nearest drlg. unit line, if any)

790'

16. NO. OF ACRES IN LEASE

640

17. NO. OF ACRES ASSIGNED
TO THIS WELL

160

18. DISTANCE FROM PROPOSED LOCATION*
TO NEAREST WELL, DRILLING, COMPLETED,
OR APPLIED FOR, ON THIS LEASE, FT.

19. PROPOSED DEPTH

2500'

20. ROTARY OR CABLE TOOLS

Rotary

21. ELEVATIONS (Show whether DF, RT, GR, etc.)

6796' GR

22. APPROX. DATE WORK WILL START*

April 15, 1978

23.

PROPOSED CASING AND CEMENTING PROGRAM

| SIZE OF HOLE | SIZE OF CASING | WEIGHT PER FOOT | SETTING DEPTH | QUANTITY OF CEMENT |
|--------------|----------------|-----------------|---------------|---------------------------|
| 12 1/4 | 8 5/8 | 23.75 | 90 | 100 sx |
| 6 3/4 | 4 1/2 | 10.5 | 2500 | To surface by caliper log |

Operator proposes to drill an upper cretaceous test to 2500'. Completion will be determined from logs. A Series 900 (3000 psi WP) blowout preventer will be used. The BOP will be tested to 500 psi before drilling surface plug. Pertinent formation tops are estimated as Pictured Cliffs at 1150' and the Point Lookout at 1500'. Drill stem test will be taken when necessary for evaluation. No abnormal pressures or temperatures are anticipated. Drilling should require approximately 3 days.

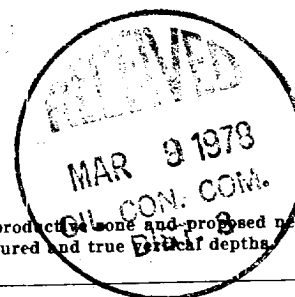
*Gas not dedicated*

IN ABOVE SPACE DESCRIBE PROPOSED PROGRAM: If proposal is to deepen or plug back, give data on present production zone and proposed new productive zone. If proposal is to drill or deepen directionally, give pertinent data on subsurface locations and measured and true vertical depths. Give blowout preventer program, if any.

24.

SIGNED

TITLE

W. E. Landry
Area Manager

DATE 3-3-78

(This space for Federal or State office use)

PERMIT NO.

APPROVAL DATE

APPROVED BY

TITLE

DATE

CONDITIONS OF APPROVAL, IF ANY:

OK

*See Instructions On Reverse Side

ST

**NEW MEXICO OIL CONSERVATION COMMISSION
WELL LOCATION AND ACREAGE DEDICATION PLAT**

Form C-102
Supersedes C-128
Effective 1-1-65

All distances must be from the outer boundaries of the Section.

| | | | | | |
|---|---|---------------------------------------|--|---------------------------|----------------------|
| Operator Dome Petroleum Corporation | | | Lease Dome-Rusty 20-22-7 | | Well No. 1 |
| Unit Letter P | Section 20 | Township 22N | Range 7W | County Sandoval | |
| Actual Footage Location of Well: | | | | | |
| 790 feet from the South line and | | 790 feet from the East line | | | |
| Ground Level Elev. 6796 | Producing Formation Grass Chacra | Pool Rusty Chacra Extension | Dedicated Acreage: 160 Acres | | |

1. Outline the acreage dedicated to the subject well by colored pencil or hachure marks on the plat below.
2. If more than one lease is dedicated to the well, outline each and identify the ownership thereof (both as to working interest and royalty).
3. If more than one lease of different ownership is dedicated to the well, have the interests of all owners been consolidated by communitization, unitization, force-pooling, etc?

☐ Yes ☐ No If answer is "yes," type of consolidation _____

If answer is "no," list the owners and tract descriptions which have actually been consolidated. (Use reverse side of this form if necessary.) _____

No allowable will be assigned to the well until all interests have been consolidated (by communitization, unitization, forced-pooling, or otherwise) or until a non-standard unit, eliminating such interests, has been approved by the Commission.

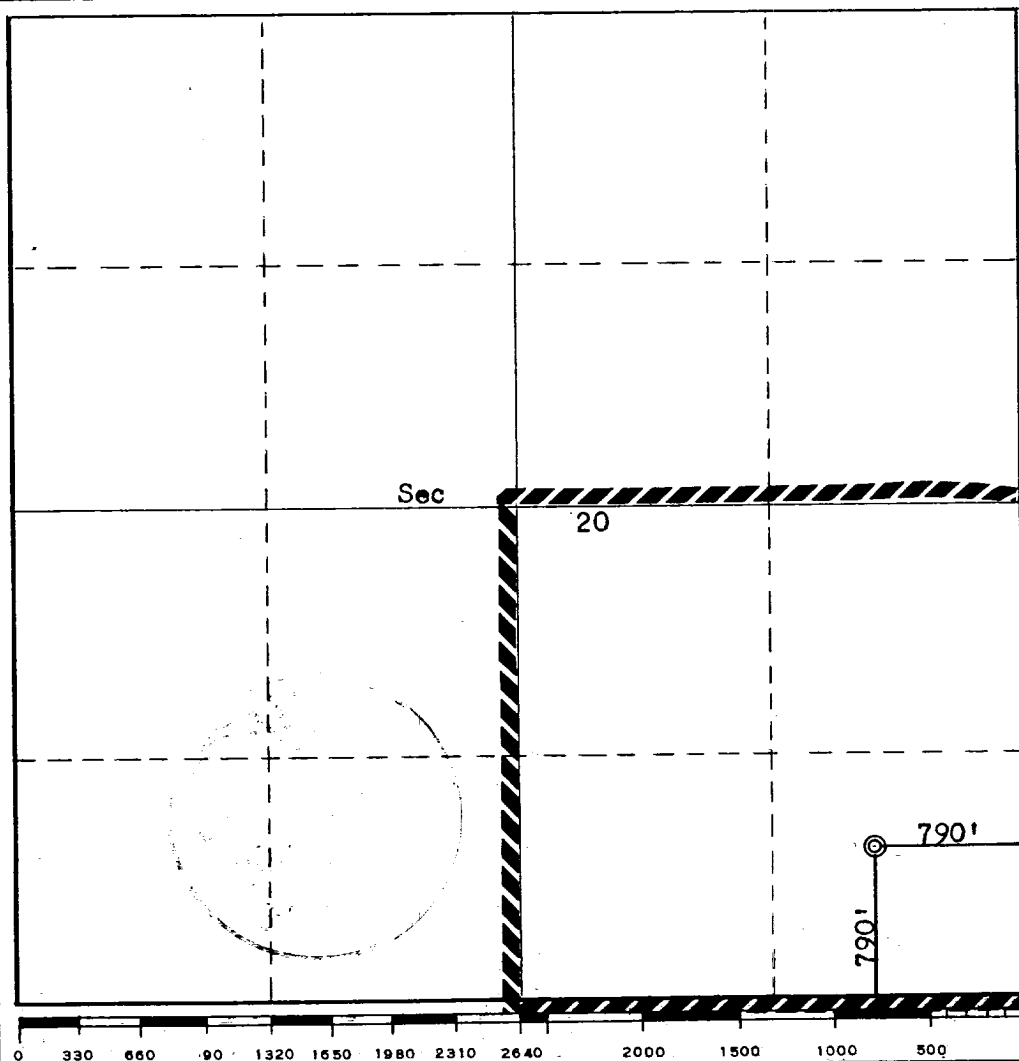

CERTIFICATION

I hereby certify that the information contained herein is true and complete to the best of my knowledge and belief.

W. E. Landry
 Name
W. E. Landry
 Position
Area Manager
 Company
Minerals Management Inc.
 Date
3-3-78

I hereby certify that the well location shown on this plat was plotted from field notes of actual surveys made by me or under my supervision, and that the same is true and correct to the best of my knowledge and belief.

Date Surveyed
March 1, 1978
 Registered Professional Engineer and/or Land Surveyor
Fred B. Kerr Jr.
Fred B. Kerr Jr.
 Certificate No.
3950