

APPROVED BY Frank E. Long TITLE DEPUTY CHIEF OF POLICE DATE JUN 30 1978

**NEW MEXICO OIL CONSERVATION COMMISSION
WELL LOCATION AND ACREAGE DEDICATION PLAT**

Form C-102
Supersedes C-128
Effective 1-1-65

All distances must be from the outer boundaries of the Section.

Operator Helton Engineering & Geological Services			Lease Diamond Trail Ranch		Well No. 5
Unit Letter C	Section 19	Township 13N	Range 6E	County Sandoval	
Actual Footage Location of Well: See Plat Below					
feet from the		line and		feet from the line	
Ground Level Elev. 5693'	Producing Formation Entrada		Pool Wildcat		Dedicated Acreage: 40 Acres

1. Outline the acreage dedicated to the subject well by colored pencil or hachure marks on the plat below.
2. If more than one lease is dedicated to the well, outline each and identify the ownership thereof (both as to working interest and royalty). **Only one lease**
3. If more than one lease of different ownership is dedicated to the well, have the interests of all owners been consolidated by communitization, unitization, force-pooling, etc? **Only one lease**

☐ Yes ☐ No If answer is "yes," type of consolidation _____

If answer is "no," list the owners and tract descriptions which have actually been consolidated. (Use reverse side of this form if necessary.) _____

No allowable will be assigned to the well until all interests have been consolidated (by communitization, unitization, forced-pooling, or otherwise) or until a non-standard unit, eliminating such interests, has been approved by the Commission.

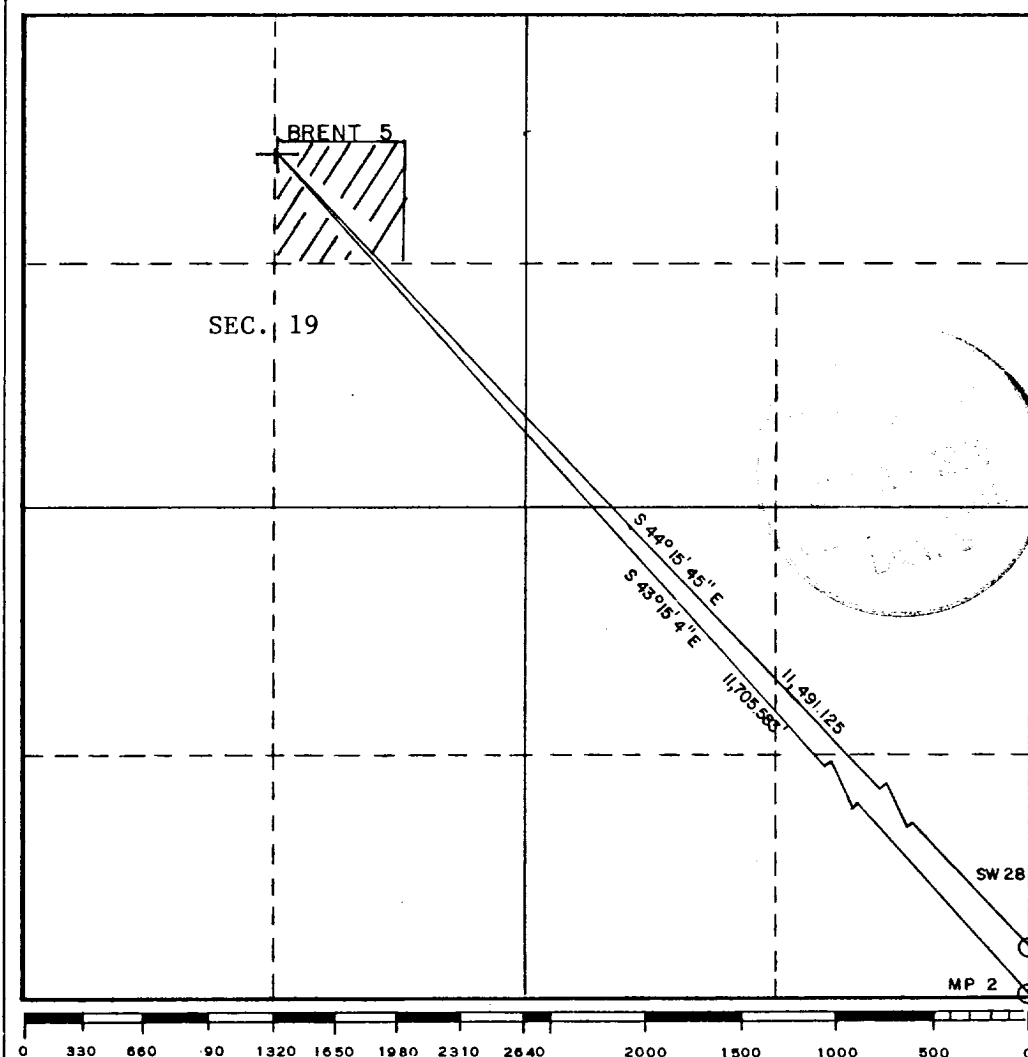

CERTIFICATION

I hereby certify that the information contained herein is true and complete to the best of my knowledge and belief.

Name *Jerome B. Weber*
Jerome B. Weber
 Position
Operations Mgr.
 Company
Helton Engineering
 Date
6/7/78

I hereby certify that the well location shown on this plat was plotted from field notes of actual surveys made by me or under my supervision, and that the same is true and correct to the best of my knowledge and belief.

Date Surveyed
May 30, 1978
 Registered Professional Engineer and/or Land Surveyor
Samuel F. Frank
 Certificate No.
N.M.L.S. # 4995