

UNITED STATES
DEPARTMENT OF THE INTERIOR
GEOLOGICAL SURVEY

APPLICATION FOR PERMIT TO DRILL, DEEPEN, OR PLUG BACK

1a. TYPE OF WORK

DRILL ☒DEEPEN ☐PLUG BACK ☐

b. TYPE OF WELL

OIL
WELL ☒GAS
WELL ☐OTHER ☐SINGLE
ZONE ☒MULTIPLE
ZONE ☐

2. NAME OF OPERATOR

Dave M. Thomas Jr.

3. ADDRESS OF OPERATOR

P.O. Box 2026, Farmington, New Mexico 87401

4. LOCATION OF WELL (Report location clearly and in accordance with any State requirements.*)

At surface 1850' FSL, 790' FWL

At proposed prod. zone

Same

14. DISTANCE IN MILES AND DIRECTION FROM NEAREST TOWN OR POST OFFICE*

Not Applicable

15. DISTANCE FROM PROPOSED*

LOCATION TO NEAREST
PROPERTY OR LEASE LINE, FT.
(Also to nearest drlg. unit line, if any)

790'

18. DISTANCE FROM PROPOSED LOCATION*

TO NEAREST WELL, DRILLING, COMPLETED,
OR APPLIED FOR, ON THIS LEASE, FT.

19. PROPOSED DEPTH

7590'

17. NO. OF ACRES ASSIGNED
TO THIS WELL

160.05

20. ROTARY OR CABLE TOOLS

Rotary

21. ELEVATIONS (Show whether DF, RT, GR, etc.)

7373' GR

22. APPROX. DATE WORK WILL START*

Sept. 10, 1978

23. PROPOSED CASING AND CEMENTING PROGRAM

SIZE OF HOLE	SIZE OF CASING	WEIGHT PER FOOT	SETTING DEPTH	QUANTITY OF CEMENT
12-1/4"	8-5/8"	24.0	250'	250 Sacks
7-7/8"	4-1/2"	10.50&11.60	7590'	To be determined

It is proposed to drill this well with rotary tools, using oil base mud as circulation medium, through the Dakota Formation. Possible productive zones in the Dakota Formation will be completed. Production casing will be cemented in such a manner as to protect the Pictured Cliffs Formation.

Estimated Formation Tops

Pictured Cliffs

3020'

Cliff House

4590'

Gallup

6130'

Green horn

7110'

Graneros

7170'

Dakota

7190'

The SW/4 Section 26 is dedicated to this well.
The natural gas produced from this well is committed.

IN ABOVE SPACE DESCRIBE PROPOSED PROGRAM: If proposal is to deepen or plug back, give data on present productive zone and proposed new productive zone. If proposal is to drill or deepen directionally, give pertinent data on subsurface locations and measured and true vertical depths. Give blowout preventer program, if any.

24. For: Dave M. Thomas Jr.

SIGNED

Ewell N. Walsh, P.E.

President, Walsh Engin.

TITLE & Production Corp.

DATE 8-10-78

PERMIT NO.

APPROVAL DATE

APPROVED BY

TITLE

DATE

CONDITIONS OF APPROVAL, IF ANY:

ok Frank

*See Instructions On Reverse Side

U. S. GEOLOGICAL SURVEY
DURANGO, COLO.

30-043-20366

Contract No. 55-A

6. IF INDIAN, ALL OTHER OR TRIBE NAME

Jicarilla Apache

7. UNIT AGREEMENT NAME

8. FARM OR LEASE NAME

Chacon Jicarilla

Apache "D"

9. WELL NO.

101

10. FIELD AND POOL, OR WILDCAT

Chacon Dakota

Associated Pool ext

11. SEC., T., R., M., OR BLK.
AND SURVEY OR AREA

Sec. 26-T23N-R3W

N.M.P.M.

12. COUNTY OR PARISH

13. STATE

Sandoval

N.M.

DAVE M. THOMAS JR.

CHACON JIM JULIA APACHE "D"

101

L

26

23N

3W

Sandoval

Actual Footage Location of well:

1850

feet from the

South

line and

790

feet from the

West

line

Ground Level Elev.

7373

Producing Formation

Dakota

Pool

Chacon Dakota Associated

Dedicated Acreage

160.05

Acres

1. Outline the acreage dedicated to the subject well by colored pencil or hatchure marks on the plat below.
2. If more than one lease is dedicated to the well, outline each and identify the ownership thereof (both as to working interest and royalty).
3. If more than one lease of different ownership is dedicated to the well, have the interests of all owners been consolidated by communitization, unitization, force-pooling, etc?

☐ Yes ☐ No If answer is "yes," type of consolidation _____

If answer is "no," list the owners and tract descriptions which have actually been consolidated. (Use reverse side of this form if necessary.) _____

No allowable will be assigned to the well until all interests have been consolidated (by communitization, unitization, forced-pooling, or otherwise) or until a non-standard unit, eliminating such interests, has been approved by the Commission.

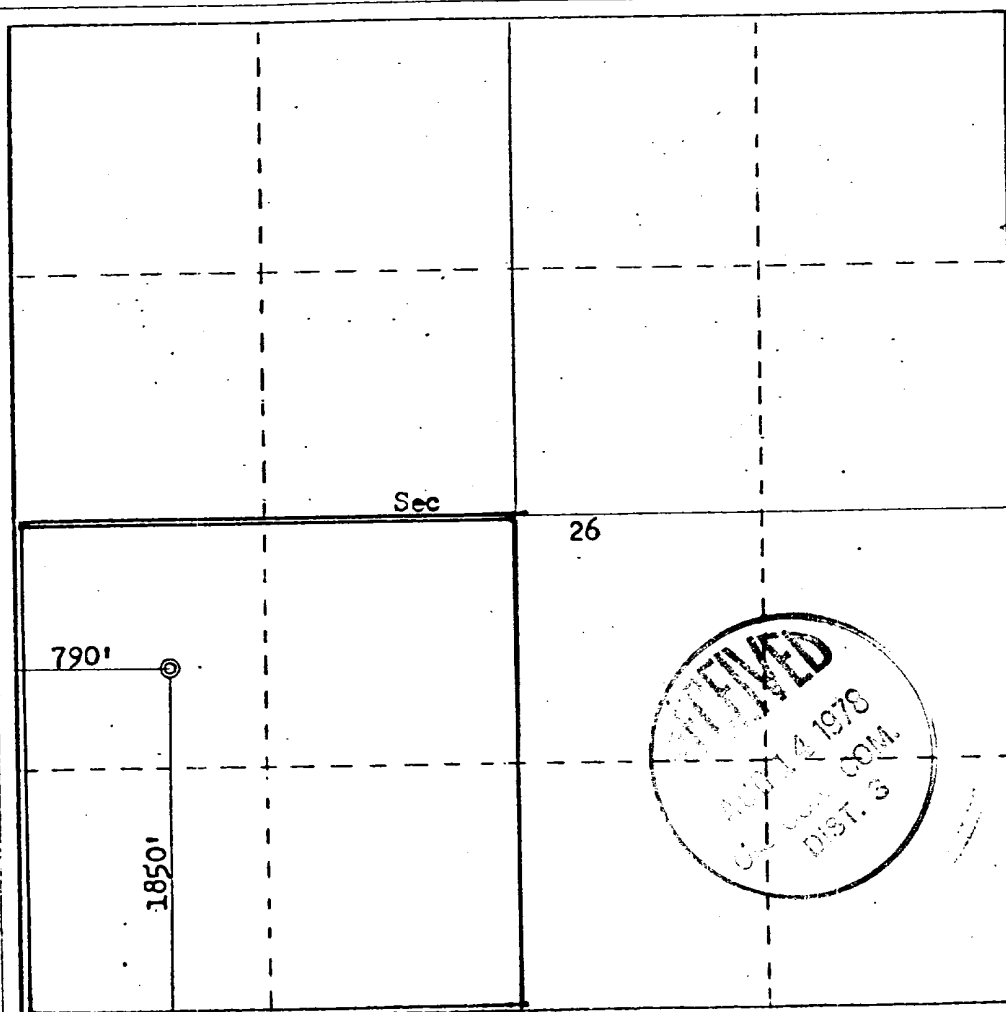

CERTIFICATION

I hereby certify that the information contained herein is true and complete to the best of my knowledge and belief.

For: Dave M. Thomas Jr.
Name: Ewell N. Walsh, P.E.
President,

Position

Walsh Engineering &

Company

Production Corp.

Date

August 10, 1978

I hereby certify that the well location shown on this plat was plotted from field notes of actual surveys made by me or under my supervision, and that the same is true and correct to the best of my knowledge and belief.

Date Surveyed

July 27, 1978

Registered Professional Engineer
and or Land Surveyor

Fred B. Kerr Jr.
No. 2350

Certificate No. 3950
FRED B. KERR, JR.

0 330 660 990 1320 1650 1980 2310 2640 2000 1800 1600 1400 1200 1000 800 600

