

UNITED STATES
DEPARTMENT OF THE INTERIOR
GEOLOGICAL SURVEY

30-043-20370

APPLICATION FOR PERMIT TO DRILL, DEEPEN, OR PLUG BACK

1a. TYPE OF WORK

DRILL ☒DEEPEN ☐PLUG BACK ☐

b. TYPE OF WELL

OIL
WELL ☐GAS
WELL ☒

OTHER

SINGLE
ZONE ☒MULTIPLE
ZONE ☐

2. NAME OF OPERATOR

Southland Royalty Company

3. ADDRESS OF OPERATOR

P. O. Drawer 570, Farmington, New Mexico

4. LOCATION OF WELL (Report location clearly and in accordance with any State requirements.)*

At surface

820' FNL & 830' FWL

At proposed prod. zone

10-22N-4W

14. DISTANCE IN MILES AND DIRECTION FROM NEAREST TOWN OR POST OFFICE*

15 miles East of Counselors, New Mexico

15. DISTANCE FROM PROPOSED*

LOCATION TO NEAREST
PROPERTY OR LEASE LINE, FT.
(Also to nearest drlg. unit line, if any)

16. NO. OF ACRES IN LEASE

17. NO. OF ACRES ASSIGNED
TO THIS WELL

160

18. DISTANCE FROM PROPOSED LOCATION*

TO NEAREST WELL, DRILLING, COMPLETED,
OR APPLIED FOR, ON THIS LEASE, FT.

19. PROPOSED DEPTH

2180'

20. ROTARY OR CABLE TOOLS

Rotary

21. ELEVATIONS (Show whether DF, RT, GR, etc.)

6880' GR

22. APPROX. DATE WORK WILL START*

November 1, 1978

23.

PROPOSED CASING AND CEMENTING PROGRAM

SIZE OF HOLE	SIZE OF CASING	WEIGHT PER FOOT	SETTING DEPTH	QUANTITY OF CEMENT
12-1/4"	8-5/8"	24#	120'	100.3 cu. ft.
6-3/4"	2-7/8"	6.5#	2180'	599.2 cu. ft.

Top of Pictured Cliffs sand is estimated at 2030'.
Fresh water mud will be used to drill from surface to total depth.
It is anticipated that an IES and GR-Density log be run at total depth.
No poisonous gases or abnormal pressures are anticipated in this well.
It is expected that this well be drilled before November 15, 1978.
Gas is not dedicated.

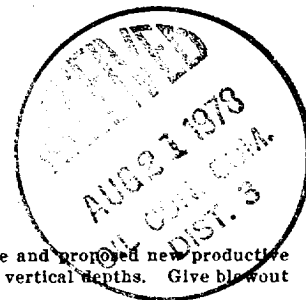

IN ABOVE SPACE DESCRIBE PROPOSED PROGRAM: If proposal is to deepen or plug back, give data on present productive zone and proposed new productive zone. If proposal is to drill or deepen directionally, give pertinent data on subsurface locations and measured and true vertical depths. Give blowout preventer program, if any.

24.

SIGNED

TITLE

District Production Mgr.

DATE

August 16, 1978

(This space for Federal or State office use)

PERMIT NO.

APPROVAL DATE

AUG 16 1978

APPROVED BY

TITLE

DATE

CONDITIONS OF APPROVAL, IF ANY:

or Frank

U. S. GEOLOGICAL SURVEY
BULLETIN 1450-D

NEW MEXICO OIL CONSERVATION COMMISSION
WELL LOCATION AND ACREAGE DEDICATION PLAT

Form C-102
Supersedes C-12a
Effective 1-1-69

All distances must be from the outer boundaries of the Section.

Operator SOUTHLAND ROYALTY COMPANY			Location JICARILLA 435		Well No. #1
Unit Letter D	Section 10	Township 22N	Range 4W	County Sandoval	
Actual Footage Location of Well: 820 feet from the North line and 830 feet from the West line. Ground Level Elev. 6830 Producing Formation Pictured Cliffs Pool Will Cat Dedicated Acreage 160					

1. Outline the acreage dedicated to the subject well by colored pencil or hachure marks on the plat below.
2. If more than one lease is dedicated to the well, outline each and identify the ownership thereof (both as to working interest and royalty).
3. If more than one lease of different ownership is dedicated to the well, have the interests of all owners been consolidated by communitization, unitization, force-pooling, etc?

☐ Yes ☐ No If answer is "yes," type of consolidation _____

If answer is "no," list the owners and tract descriptions which have actually been consolidated. (Use reverse side of this form if necessary.) _____

No allowable will be assigned to the well until all interests have been consolidated (by communitization, unitization, forced-pooling, or otherwise) or until a non-standard unit, eliminating such interests, has been approved by the Commission.

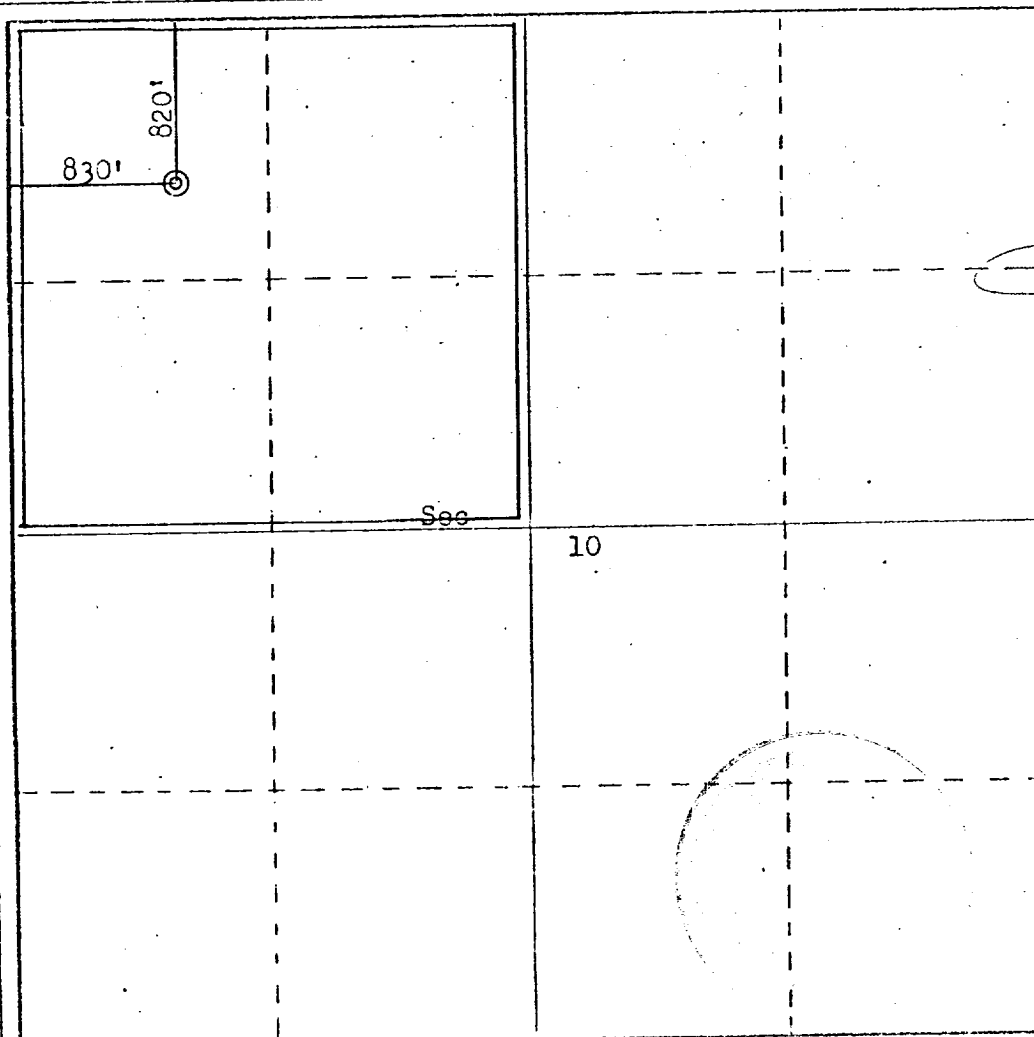

CERTIFICATION

I hereby certify that the information contained herein is true and complete to the best of my knowledge and belief.

Name _____
 Position
District Production Manager
 Company
Southland Royalty Company
 Date
August 16, 1978

I hereby certify that the well location shown on this plat was plotted from field notes of actual surveys made by me or under my supervision, and that the same is true and correct to the best of my knowledge and belief.

Date Surveyed
June 1978
 Registered Land Surveyor
 and of the State of New Mexico
3956
FRED KERR, JR.
3950

DRILLING SCHEDULE - JICARILLA 435 #1

Location: 820'FNL & 830'FWL, Section 10, T22N, R4W, Sandoval, New Mexico

Field: Undesignated Pictured Cliffs

Elevation: 6880' GL

Geology: Formation Tops: Pictured Cliffs 2030'
Total Depth 2180'

Logging Program: IES & GR Density at Total Depth.

Coring Program: None

Natural Gauges: None

Drilling: Contractor-
SRC Representative: Max Larson

Tool Pusher:
SRC Ans. Svc. 325-1841
Dispatch No. 325-7391

Mud Program: Fresh water mud from surface to Total Depth.

Materials: Casing Program

<u>Hole Size</u>	<u>Depth</u>	<u>Casing Size</u>	<u>Wt. & Grade</u>
12-1/4"	120'	8-5/8"	24# K-55
6-3/4"	2180'	2-7/8"	6.5# J-55

Float Equipment:

8-5/8" Surface Casing: Pathfinder Type A Guide Shoe.

2-7/8" Production Casing: Notched collar guide shoe. Howco 2-7/8" latchdown baffle. Two 3-1/16" rubber balls. Howco 2-7/8" Omega plug. Use 3-1/4" I.D. plug container head. 6 B & W stabilizers on bottom 6 joints.

Tubing:

Wellhead Equipment: 8-5/8" x 2-7/8" threaded head (Rector).

Cementing:

8-5/8" Surface Casing: 85sx (100.3 cu. ft.) C1 B with 1/4# gel flake per sk and 3% CaCl₂. WOC 12 hours. Test to 600 psi prior to drilling out.

Drilling Schedule-Jicarilla 435 #1
Page Two

Cementing-Continued:

2-7/8" Production Casing: 365 sx 50/50 C1 B poz w/6% gel mixed w/7.2
gallons water/sk followed by 50 sx C1 B
w/2% CaCl_2 . (599.2 cu.ft.) Run temperature
survey 12 hours after plug down.

L. O. Van Ryan

REF/mb
8-10-78



Southland Royalty Company

August 16, 1978

United States Geological Survey
P. O. Box 1809
Durango, Colorado

Attention: Mr. Jerry Long

Re: Blowout Preventer Plan

Dear Sir:

All drilling and completion rigs will be equipped with 8" or larger double gate hydraulic blowout preventers and a hydraulic operated closing unit with steel lines.

The preventer is 3000# working pressure and 6000# test.

All crews will be thoroughly trained in the operation of this preventer. The preventer will be tested frequently enough to insure proper operation.

Yours truly,

L. O. Van Ryan
District Production Manager

LOVR/dg

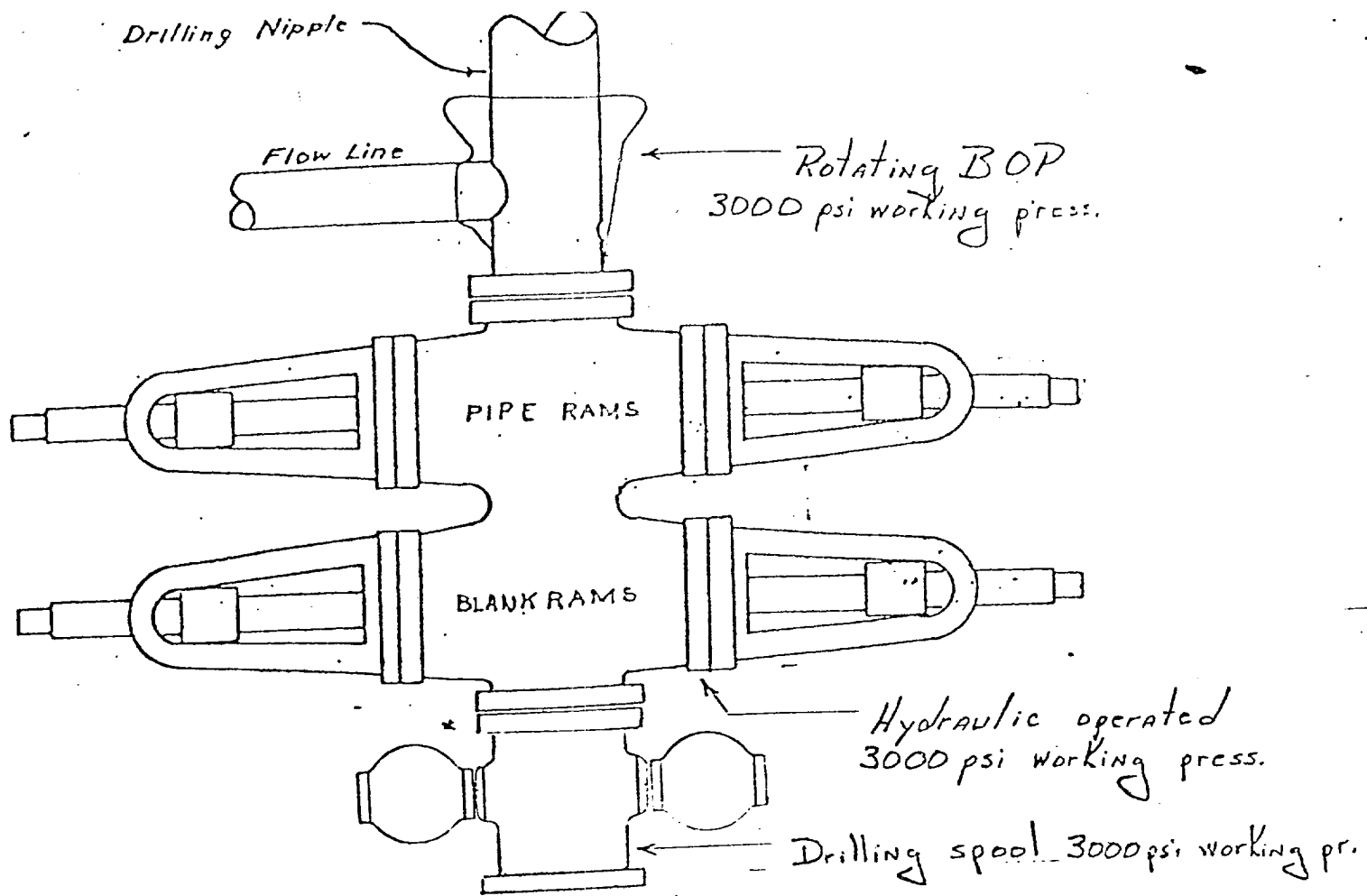

Preventers and spools are to have
through bore of 8" - 3000# PSI or larger.



Southland Royalty Company

August 16, 1978

United States Geological Survey
P. O. Box 1809
Durango, Colorado

Attention: Mr. Jerry Long

Dear Sir:

Enclosed please find map showing existing roads and planned access roads to Southland Royalty Company's Jicarilla 435 #1 well. The location of tank batteries and flow lines will be on location with well. A burn pit will be provided for disposal of trash. Cuttings, drilling fluid and produced fluids will be put into the reserve pit and properly disposed of depending on amount and type of fluids.

Contractor will furnish restroom facilities on location.

There will be no air strips or camps.

Also, enclosed is a location layout showing approximate location of rig, pits, pipe racks and cut required to build this location.

Water supply will be water holes along Largo Wash.. All water will be transported by truck and stored on location.

The location will be restored according to Bureau of Indian Affairs standards. This work will begin when all related construction is finished.

Mr. Max Larson will be Southland Royalty Company's field representative supervising these operations.

Yours truly,

L. O. Van Ryan
District Production Manager

LOVR/dg



Southland Royalty Company

United States Geological Survey
P. O. Box 1809
Durango, Colorado

Attention: Mr. Jerry Long

Dear Sir:

I hereby certify that I, or persons under my direct supervision, have inspected the proposed drillsite and access route; that I am familiar with the conditions which presently exist; that the statements made in this plan are, to the best of my knowledge, true and correct; and, that the work associated with the operations proposed herein be performed by Southland Royalty Company and its contractors and subcontractors in conformity with this plan and the terms and conditions under which it is approved.

Date: August 16, 1978

Name: CC Parsons
Title: District Engineer