

UNITED STATES
DEPARTMENT OF THE INTERIOR
GEOLOGICAL SURVEY

APPLICATION FOR PERMIT TO DRILL, DEEPEN, OR PLUG BACK

1a. TYPE OF WORK

DRILL ☒DEEPEN ☐PLUG BACK ☐

b. TYPE OF WELL

OIL
WELL ☐GAS
WELL ☒

OTHER

SINGLE
ZONE ☒MULTIPLE
ZONE ☐

2. NAME OF OPERATOR

Benson Mineral Group, Inc.

3. ADDRESS OF OPERATOR

3200 Anaconda Tower, 555 17th St., Denver, CO 80202

4. LOCATION OF WELL (Report location clearly and in accordance with any State requirements.*)

At surface

1470' FSL & 1550' FEL Section 31-T22N-R6W

At proposed prod. zone

14. DISTANCE IN MILES AND DIRECTION FROM NEAREST TOWN OR POST OFFICE*

9 miles southwest of Counselor, New Mexico

15. DISTANCE FROM PROPOSED*

LOCATION TO NEAREST

PROPERTY OR LEASE LINE, FT.

(Also to nearest drlg. unit line, if any)

1470'

18. DISTANCE FROM PROPOSED LOCATION*

TO NEAREST WELL, DRILLING, COMPLETED,

OR APPLIED FOR, ON THIS LEASE, FT.

None

16. NO. OF ACRES IN LEASE

1606

19. PROPOSED DEPTH

1950

17. NO. OF ACRES ASSIGNED
TO THIS WELL

160

20. ROTARY OR CABLE TOOLS

Rotary

21. ELEVATIONS (Show whether DF, RT, GR, etc.)

6952 GR

22. APPROX. DATE WORK WILL START*

As soon as permitted

23.

PROPOSED CASING AND CEMENTING PROGRAM

SIZE OF HOLE	SIZE OF CASING	WEIGHT PER FOOT	SETTING DEPTH	QUANTITY OF CEMENT
9-5/8	7" used	23	100	50 sx. circ.
6 1/4	4 1/2" new	9.5	1950	205 sx. circ.

The above well is being drilled to evaluate the Chacra formation. Completion intervals and stimulation program will be determined from the study of logs. This acreage is not dedicated to a gas purchaser. Additional information required by NTL-6 for the application to drill and a Multi-Point Surface Use Plan are attached.

IN ABOVE SPACE DESCRIBE PROPOSED PROGRAM: If proposal is to deepen or plug back, give data on present productive zone and proposed new productive zone. If proposal is to drill or deepen directionally, give pertinent data on subsurface locations and measured and true vertical depths. Give blowout preventer program, if any.

24.

SIGNED

Paul C. Ellison

TITLE Production Manager

DATE August 30, 1978

(This space for Federal or State office use)

PERMIT NO.

APPROVAL DATE

APPROVED BY

TITLE

CONDITIONS OF APPROVAL, IF ANY:

ok Frank

*See Instructions On Reverse Side

RECEIVED
SEP 5 1978
U. S. GEOLOGICAL SURVEY
DURANGO, COLO.

NEW MEXICO OIL CONSERVATION COMMISSION
WELL LOCATION AND ACREAGE DEDICATION PLAT

Form C-102
Supersedes C-128
Effective 1-1-65

All distances must be from the outer boundaries of the Section.

Operator BENSON MINERAL GROUP, INC.			Lease FEDERAL 31-22-6		Well No. 1
Unit Letter J	Section 31	Township 22N	Range 6W	County SANDOVAL	
Actual Footage Location of Well: 1470 feet from the South line and 1550 feet from the East line					
Ground Level Elev. 6952	Producing Formation Chacra		Pool Wildcat Undesignated	Dedicated Acreage: 160 Acres	

1. Outline the acreage dedicated to the subject well by colored pencil or hachure marks on the plat below.
2. If more than one lease is dedicated to the well, outline each and identify the ownership thereof (both as to working interest and royalty).
3. If more than one lease of different ownership is dedicated to the well, have the interests of all owners been consolidated by communitization, unitization, force-pooling, etc?

☐ Yes ☐ No If answer is "yes," type of consolidation _____

If answer is "no," list the owners and tract descriptions which have actually been consolidated. (Use reverse side of this form if necessary.) _____

No allowable will be assigned to the well until all interests have been consolidated (by communitization, unitization, forced-pooling, or otherwise) or until a non-standard unit, eliminating such interests, has been approved by the Commission.

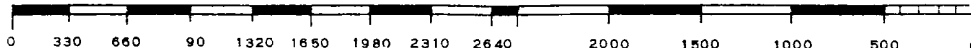
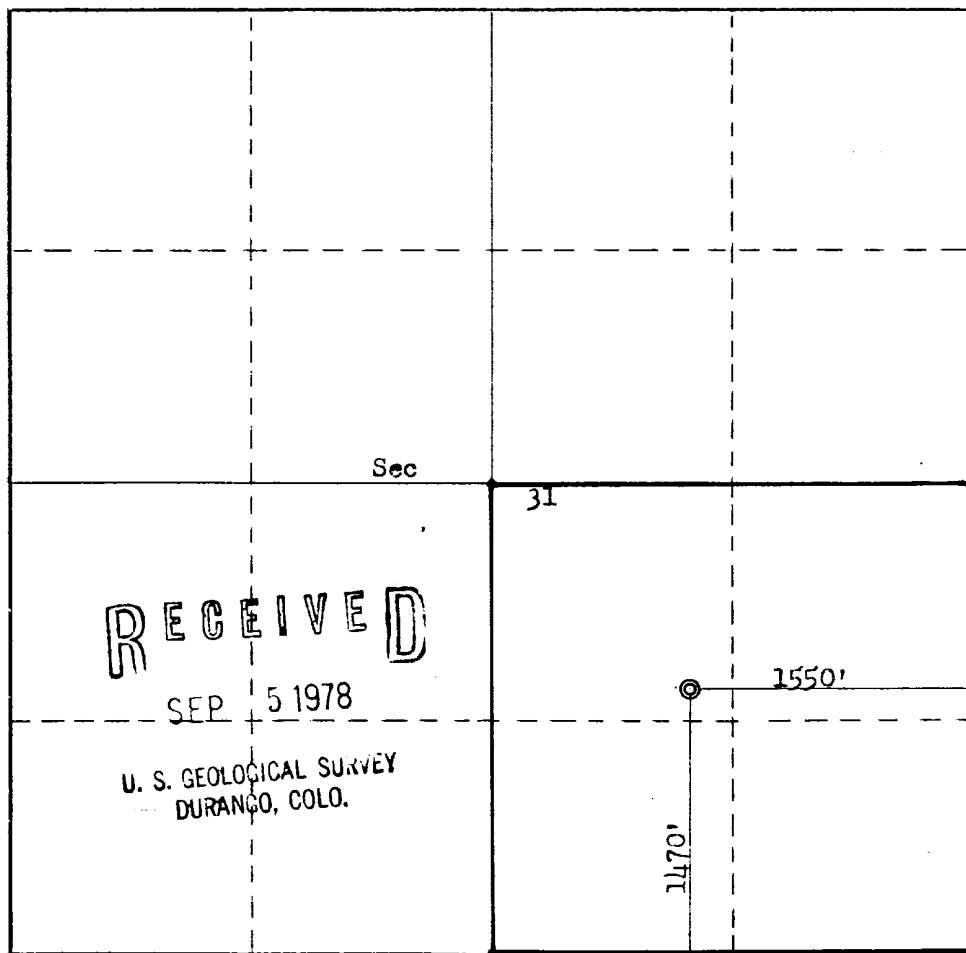

CERTIFICATION

I hereby certify that the information contained herein is true and complete to the best of my knowledge and belief.

Paul C. Ellison
Name
Paul C. Ellison
Position
Production Manager
Company
Benson Mineral Group, Inc
Date
August 30, 1978

I hereby certify that the well location shown on this plat was plotted from field notes of actual surveys made by me or under my supervision, and that the same is true and correct to the best of my knowledge and belief.

Date Surveyed
August 18, 1978
Registered Professional Engineer and/or Land Surveyor
Fred B. Kerr Jr.
Fred B. Kerr Jr.
Certificate No.
3950

SUPPLEMENTAL INFORMATION TO FORM 9-331C
REQUIRED BY NTL-6

Federal 31-22-6 Well #1
1470' FSL & 1550' FEL Section 31-T22N-R6W
Sandoval County, New Mexico

The geologic name of the surface formation is: Tertiary San Jose

The estimated tops of important geological formations bearing hydrocarbons to be drilled are:

<u>Formation</u>	<u>Depth</u>	<u>Elevation</u>
Chacra	1642	+5310
Total Depth	1950	

Estimated K.B. elevation: 6952 GR

<u>Estimated Depth</u>	<u>Casing Size</u>	<u>Casing Weight</u>	<u>Hole Size</u>	<u>Sacks Cement</u>	<u>Type</u>
100	7" Used	23	9 5/8"	50	Class "B" 2% CaCl ₂
1950	4½" New	9.5	6¼"	50 155	Class "B" Class "B" 50-50 Poz mix, 6% gel with ¼# Celloflake/sack

Benson Mineral Group Inc.'s standard blowout prevention will be employed, see the attached drawing of the preventor design.

Drilling fluid to be a low solids non-dispersed mud system.

The logging program will be as follows: Induction-Electric and Compensated Density-Gamma Ray from surface casing point to total depth.

Past experience in this area has shown that no abnormal pressures, temperatures, or hydrogen sulfide gas will be encountered.

RECEIVED

SEP 5 1978

U. S. GEOLOGICAL SURVEY
DURANGO, COLO.

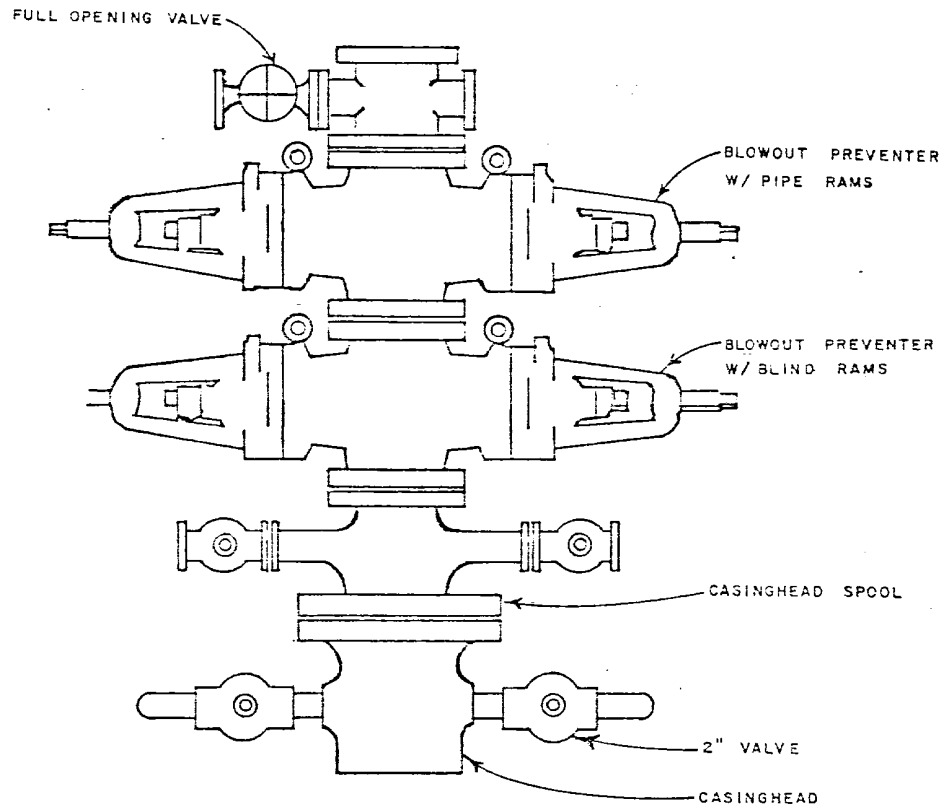

RECEIVED

SEP 5 1978

U. S. GEOLOGICAL SURVEY
DURANGO, COLO.

**BENSON
MINERAL
GROUP, INC.**

3200 Anaconda Tower
555 17th Street
Denver, Colorado 80202

STANDARD BLOWOUT PREVENTER
ASSEMBLY
6" 900 SERIES

GEOLOGY BY	DATE	POSTED	APPROVED BY	DRAFTING BY
				G W R

MULTI-POINT SURFACE USE PLAN

Federal 31-22-6 Well #1
1470' FSL & 1550' FEL Section 31-T22N-R6W
Sandoval County, New Mexico

1. The attached road map and sketch show the proposed route to the location and distances from towns.
2. An access road of 850 feet will be constructed as a new permanent road to location.
3. Existing oil and gas wells within a one-mile radius of our proposed well have been spotted on the vicinity map.
4. There are no storage tanks or facilities located within a one-mile radius of our proposed location.
5. Water will be hauled by truck from various existing private water sources over existing permanent roads.
6. No construction materials will be hauled in for this location. Material from high points on location will be used to level location for proper drilling.
7. A 20' X 120' pit will be built on location to hold all drilling waste. Upon completion of well, all waste and liquid will be hauled by truck and bladed into existing roads. All other waste will be covered in 20' X 120' reserve pit.
8. There are neither airstrips nor camps in the vicinity.
9. The well site layout, reserve, burn and trash pits are shown on the attached Drill Site Specification Sheet.
10. Restoration of the surface will be accomplished by cleaning up and leveling upon completion of the well. Upon completion the reserve pit will be fenced and the drilling mud allowed to dry. The pits will then be back filled and seeded. Reseeding of the site will be carried out as detailed by the Surface Management Agency at the site examination.
11. The general topography and soil characteristics consist of fairly level terrain with vegetation of sagebrush and a few small pinion trees.

Representatives of the U.S. Geological Survey's Durango Office and Bureau of Land Management's Farmington Office will inspect the site. Cultural resources inspection will be conducted by an archaeologist from San Juan College or Salmon Ruins.

12. A Certification Statement by Benson Mineral Group, Inc.'s Representative is included.

RECEIVED
SEP 5 1978

U. S. GEOLOGICAL SURVEY
DURANGO, COLO.

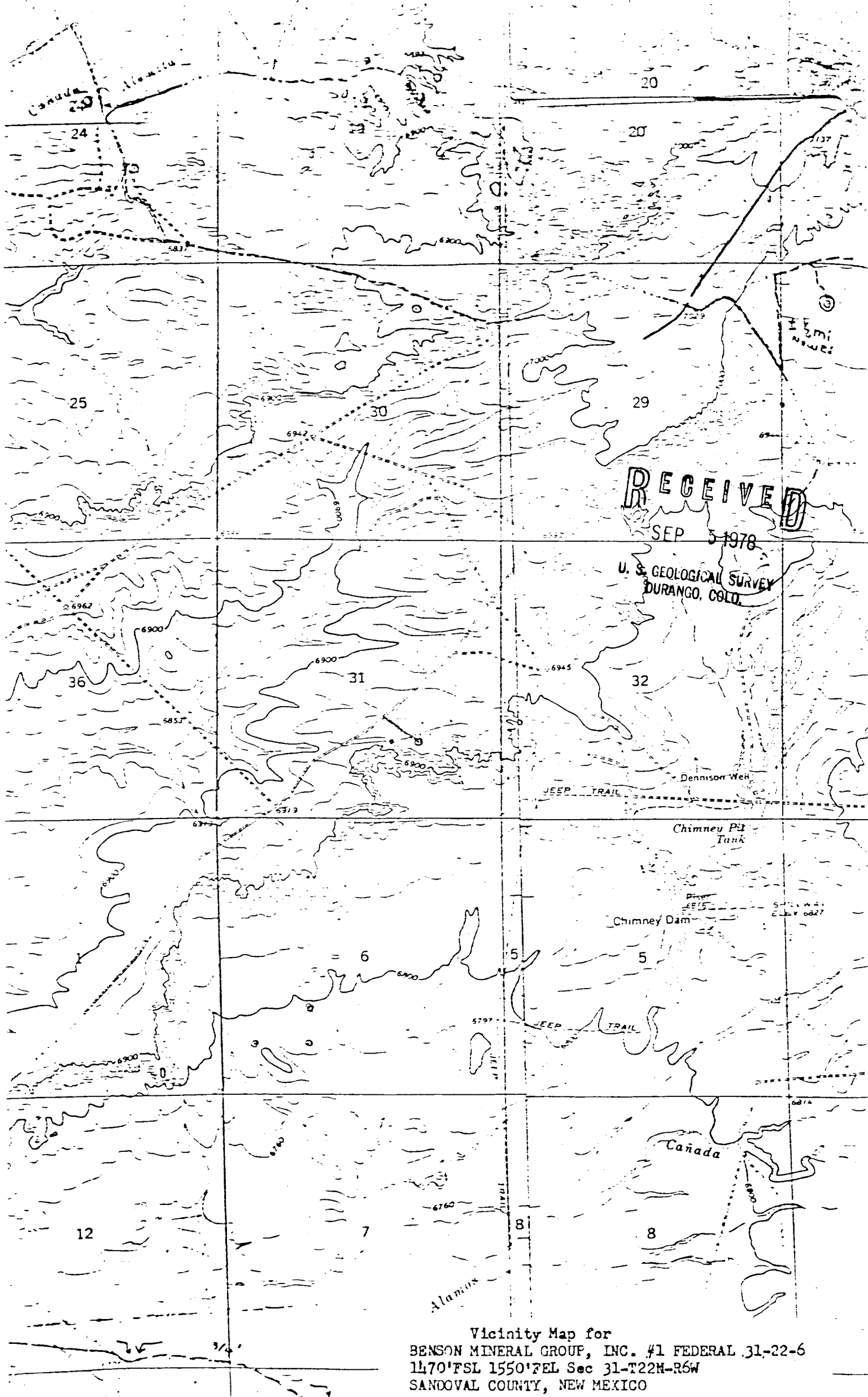

Vicinity Map for
BENSON MINERAL GROUP, INC. #1 FEDERAL 31-22-6
1470'FSL 1550'FEL Sec 31-T22N-R6W
SANDOVAL COUNTY, NEW MEXICO

RECEIVED

SEP 5 1978

U. S. GEOLOGICAL SURVEY
DURANGO, COLO.

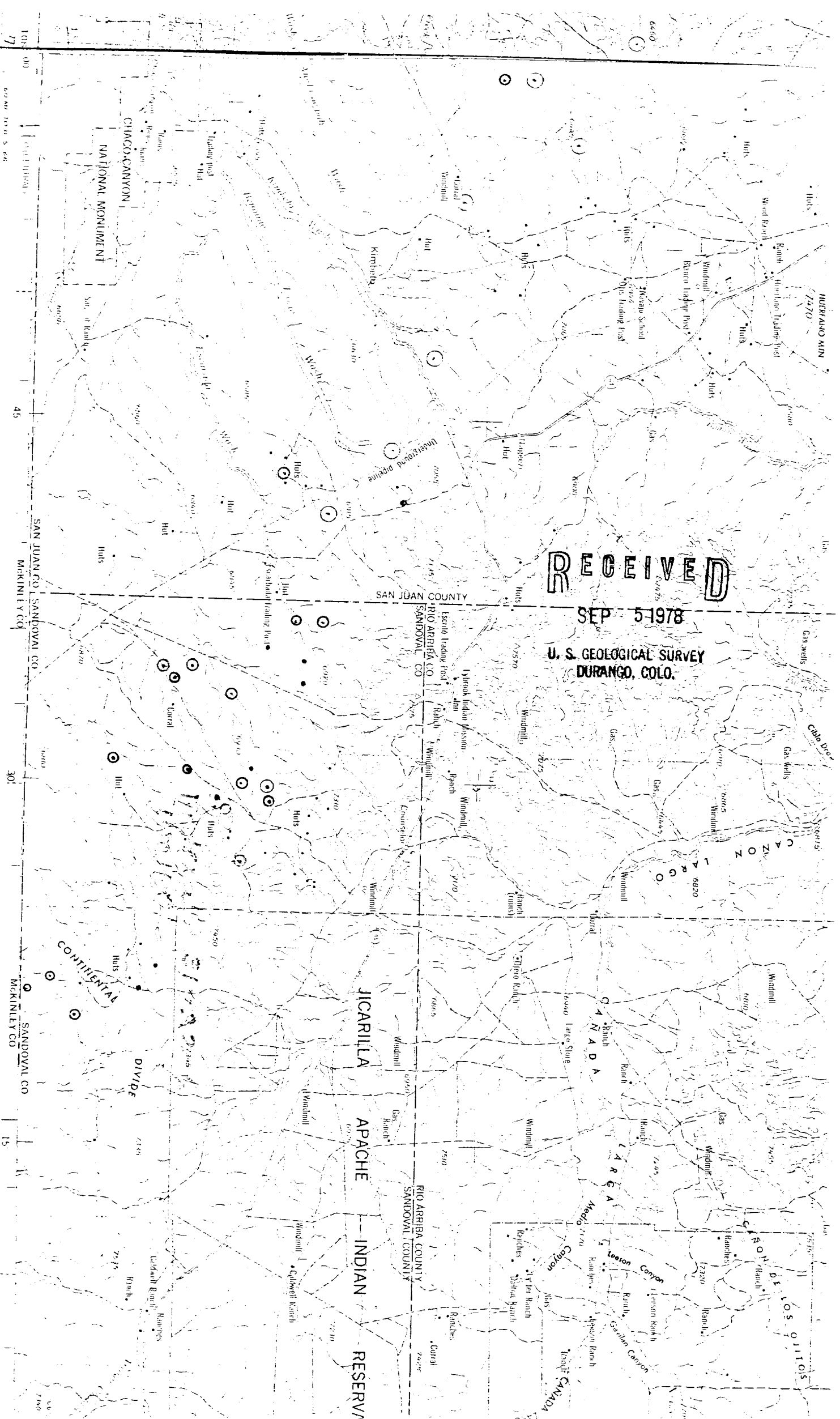

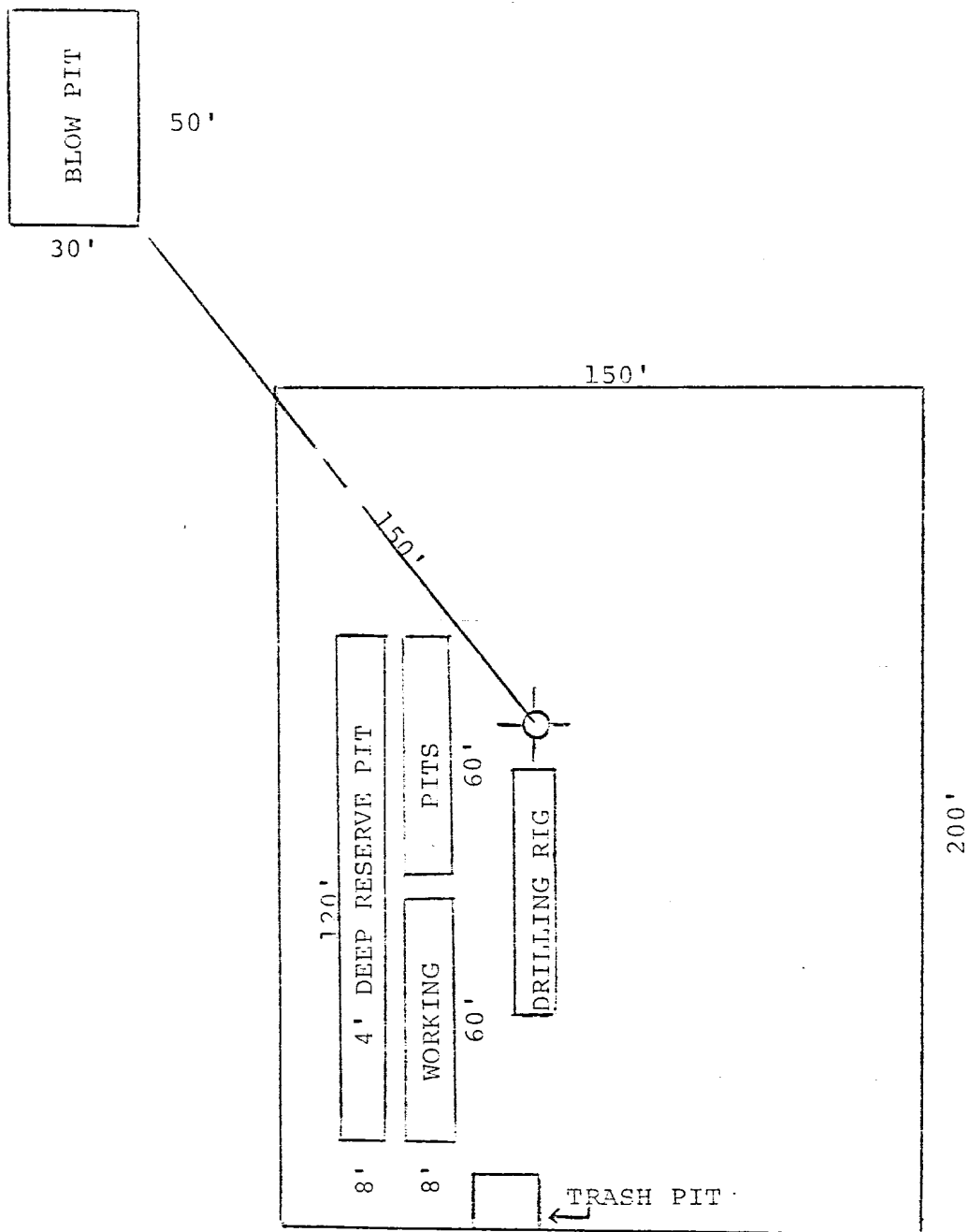

RECEIVED

SEP 5 1978

U. S. GEOLOGICAL SURVEY
DURANGO, COLO.

**BENSON
MINERAL
GROUP, INC.**

3200 Anaconda Tower
555 17th Street
Denver, Colorado 80202

PROPOSED LOCATION
DIAGRAM

GEOLOGY BY:	DATE:	POSTED:	APPROVED BY:	DRAFTING BY:
-------------	-------	---------	--------------	--------------

Federal 31-22-6 Well #1
1470' FSL & 1550' FEL Section 31-T22N-R6W
Sandoval County, New Mexico

CERTIFICATION

I hereby certify that I, or persons under my direct supervision, have inspected the proposed drillsite and access route, that I am familiar with the conditions which presently exist; that the statements made in this plan are, to the best of my knowledge, true and correct; and, that the work associated with the operations proposed herein will be performed by BENSON MINERAL GROUP, INC. and its contractors and sub-contractors in conformity with this plan and the terms and conditions under which it is approved.

August 30, 1978
Date



Paul C. Ellison
Production Manager

Benson Mineral Group Inc.'s Representative:

Paul C. Ellison
Phone: Office: 303-893-0883; Home: 303-979-9021
Address: 3200 Anaconda Tower
555 17th Street
Denver, Colorado 80202

RECEIVED
SEP 5 1978
U. S. GEOLOGICAL SURVEY
DURANGO, COLO.