

NO. OF COPIES RECEIVED	6
DISTRIBUTION	
SANTA FE	1
FILE	1
U.S.G.S.	2
LAND OFFICE	1
OPERATOR	1

# NEW MEXICO OIL CONSERVATION COMMISSION

30-043-20385  
Form C-101  
Revised 1-1-65

5A. Indicate Type of Lease	
STATE <input checked="" type="checkbox"/>	FEE <input type="checkbox"/>
5. State Oil & Gas Lease No.	
St. NM-L-1560	

## APPLICATION FOR PERMIT TO DRILL, DEEPEN, OR PLUG BACK

1a. Type of Work		7. Unit Agreement Name	
b. Type of Well OIL WELL <input type="checkbox"/> GAS WELL <input checked="" type="checkbox"/> OTHER <input type="checkbox"/>		8. Farm or Lease Name	
DRILL <input checked="" type="checkbox"/> DEEPEN <input type="checkbox"/> PLUG BACK <input type="checkbox"/>		State 36-21-6	
2. Name of Operator		9. Well No.	
Benson Mineral Group, Inc.		1	
3. Address of Operator		10. Field and Pool or Wildcat	
3200 Anaconda Tower, 555 17th St., Denver, CO 80202		Wildcat <i>Pictured Cliffs</i>	
4. Location of Well		12. County	
UNIT LETTER <u>L</u> LOCATED <u>1650</u> FEET FROM THE <u>South</u> LINE		Sandoval	
AND <u>1155</u> FEET FROM THE <u>West</u> LINE OF SEC. <u>36</u> TWP. <u>21N</u> RGE. <u>6W</u> NMPM			
19. Proposed Depth		19A. Formation	
1000		Pictured Cliffs Rotary	
21. Elevations (Show whether DF, RT, etc.)		22. Approx. Date Work will start	
6859 GR		As soon as permitted	
21A. Kind & Status Plug. Bend		21B. Drilling Contractor	
State-wide		B & N Drilling	

## PROPOSED CASING AND CEMENT PROGRAM

SIZE OF HOLE	SIZE OF CASING	WEIGHT PER FOOT	SETTING DEPTH	SACKS OF CEMENT	EST. TOP
9-5/8	7" used	23	100	50 sx. circ.	
6 1/2	4 1/2" new	9.5	1000	110 sx. circ.	

Benson Mineral Group, Inc. intends to drill the above well to evaluate the Pictured Cliffs formation. A blowout preventer diagram is attached.  
The gas is not dedicated.

APPROVAL VALID  
FOR 90 DAYS UNLESS  
DRILLING COMMENCED,

EXPIRES 12-12-78

IN ABOVE SPACE DESCRIBE PROPOSED PROGRAM: IF PROPOSAL IS TO DEEPEN OR PLUG BACK, GIVE DATA ON PRESENT PRODUCTIVE ZONE AND PROPOSED NEW PRODUCTIVE ZONE. GIVE BLOWOUT PREVENTER PROGRAM, IF ANY.

I hereby certify that the information above is true and complete to the best of my knowledge and belief.

Signed Paul C. Ellison Title Production Manager Date 9-8-78  
(This space for State Use)

APPROVED BY Frank E. Chang TITLE DEPUTY COMMISSIONER DATE 9-8-78

CONDITIONS OF APPROVAL, IF ANY:

NEW MEXICO OIL CONSERVATION COMMISSION  
WELL LOCATION AND ACREAGE DEDICATION PLAT

Form O-10,  
Supersedes O-10B  
Effective 1-1-67

All distances must be from the outer boundaries of the Section.

Owner <b>BENSON MINERAL GROUP, INC.</b>			Location <b>STATE 36-21-6</b>		Well No. <b>1</b>
Section <b>L</b>	Township <b>36</b>	Range <b>21N</b>	Quarter <b>6W</b>	County <b>SANDOVAL</b>	
Actual Footage Location of Well: <b>1650</b> feet from the <b>South</b> line and <b>1155</b> feet from the <b>West</b> line					
Ground Level Elev. <b>6859</b>	Producing Formation <b>Pictured Cliffs</b>		Pool <b>Wildcat</b>		Dedicated Acreage <b>160</b>

1. Outline the acreage dedicated to the subject well by colored pencil or hatchure marks on the plat below.
2. If more than one lease is dedicated to the well, outline each and identify the ownership thereof (both as to working interest and royalty).
3. If more than one lease of different ownership is dedicated to the well, have the interests of all owners been consolidated by communitization, unitization, force-pooling, etc?

☐ Yes ☐ No If answer is "yes," type of consolidation \_\_\_\_\_

If answer is "no," list the owners and tract descriptions which have actually been consolidated. (Use reverse side of this form if necessary.) \_\_\_\_\_

No allowable will be assigned to the well until all interests have been consolidated (by communitization, unitization, forced-pooling, or otherwise) or until a non-standard unit, eliminating such interests, has been approved by the Commission.

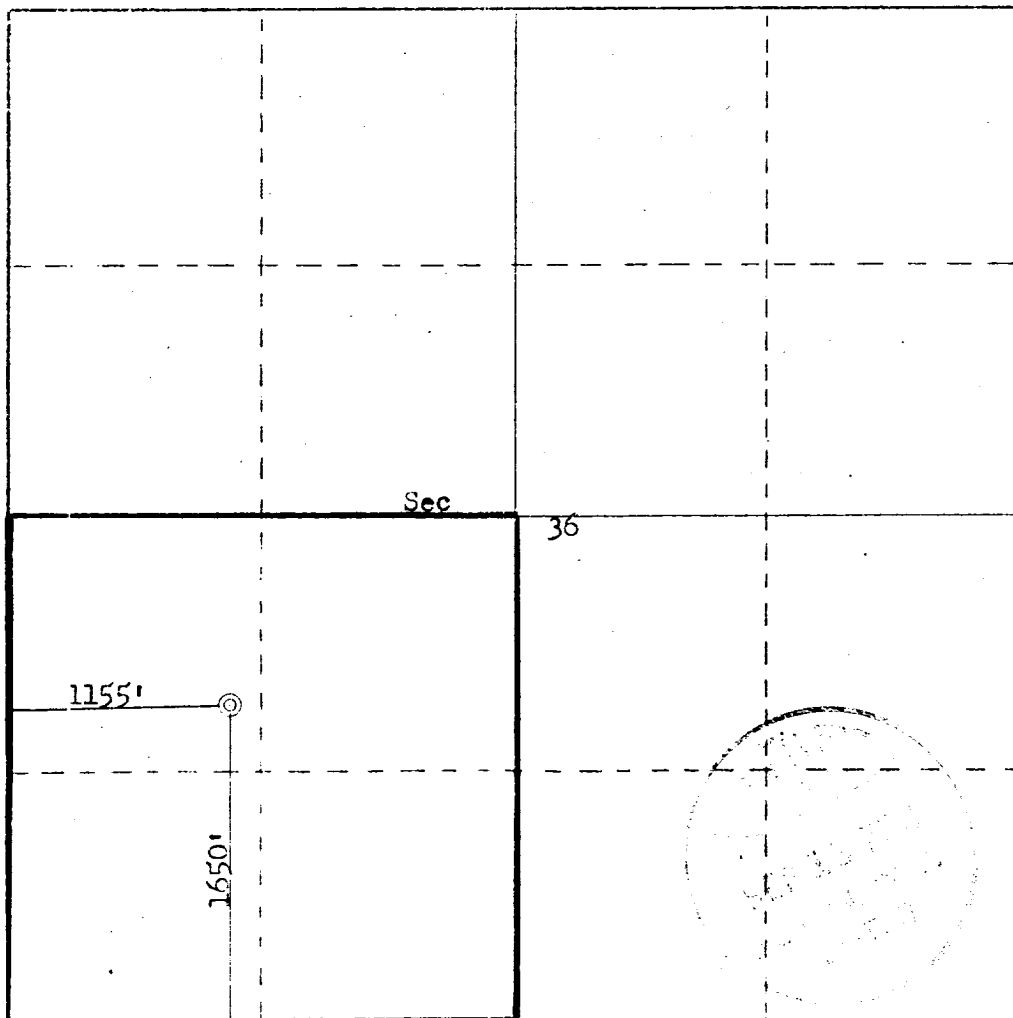

CERTIFICATION

I hereby certify that the information contained herein is true and complete to the best of my knowledge and belief.

*Paul C. Ellison*

Name

Paul C. Ellison

Position

Production Manager

Company

Benson Mineral Group, Inc.

Date

September 8, 1978

I hereby certify that the well location shown on this plat was plotted from field notes of actual surveys made by me or under my supervision, and that the same is true and correct to the best of my knowledge and belief.

Date Surveyed

September 8, 1978

Registered Professional Engineer  
No. 1444

*Fred B. Kerr Jr.*

Fred B. Kerr Jr.

3950