

NO. OF COPIES RECEIVED	5
DISTRIBUTION	
SANTA FE	1
FILE	1
U.S.G.S.	2
LAND OFFICE	
OPERATOR	1

NEW MEXICO OIL CONSERVATION COMMISSION

30-043-20402
Form C-101
Revised 1-1-65

5A. Indicate Type of Lease	
STATE <input type="checkbox"/>	FEE <input checked="" type="checkbox"/>
5. State Oil & Gas Lease No.	

APPLICATION FOR PERMIT TO DRILL, DEEPEN, OR PLUG BACK

1a. Type of Work DRILL <input checked="" type="checkbox"/> DEEPEN <input type="checkbox"/> PLUG BACK <input type="checkbox"/>		7. Unit Agreement Name	
b. Type of Well OIL WELL <input checked="" type="checkbox"/> GAS WELL <input type="checkbox"/> OTHER <input type="checkbox"/>		8. Farm or Lease Name Tilford	
2. Name of Operator William M. Kaiser		9. Well No. 1	
3. Address of Operator 444 Lincoln Loop Tijeras, New Mexico 87059		10. Field and Pool, or Wildcat Wildcat Gallup	
4. Location of Well UNIT LETTER K LOCATED 360 FEET FROM THE West LINE 2090 South 6 15 3W AND FEET FROM THE LINE OF SEC. TWP. RGE. NMMPM		12. County Sandoval	
21. Elevations (Show whether DE, RT, etc.) 6252 Cr.		19. Proposed Depth 450'	19A. Formation Hospah Gallup
21A. Kind & Status Plug. Bond 1-well	21B. Drilling Contractor Self	20. Rotary or C.T. Rotary	
22. Approx. Date Work will start 10-15-1978			

PROPOSED CASING AND CEMENT PROGRAM

SIZE OF HOLE	SIZE OF CASING	WEIGHT PER FOOT	SETTING DEPTH	SACKS OF CEMENT	EST. TOP
5	5		45	25	01 NO
6	4 1/2	9.5	450	125	02 NO

PROPOSED PROGRAM

1. Set surface as above.
2. Drill to TD 450.
3. Run logs.
4. Run 4 1/2 casing, perforate, POP.
5. If non-commercial, plug in accordance with O.C.C. instructions and restore location.

USOCB approval of this application is not required since the well is being drilled on fee lands.

IN ABOVE SPACE DESCRIBE PROPOSED PROGRAM; IF PROPOSAL IS TO DEEPEN OR PLUG BACK, GIVE DATA ON PRESENT PRODUCTIVE ZONE AND PROPOSED NEW PRODUCTIVE ZONE. GIVE BLOWOUT PREVENTER PROGRAM, IF ANY.

I hereby certify that the information above is true and complete to the best of my knowledge and belief.

Original Signed By:

Agent

10-1-1978

Signed CLAUDE C. KENNEDY

Title

Date

(This space for State Use)

APPROVED BY

TITLE

DATE

CONDITIONS OF APPROVAL, IF ANY:

10-1-1978

OCT 23 1978

NEW MEXICO OIL CONSERVATION COMMISSION
WELL LOCATION AND ACREAGE DEDICATION PLAT

Form C-102
Supersedes C-128
Effective 1-1-65

All distances must be from the outer boundaries of the Section.

Operator WILLIAM M. KAISER		Lease TILFORD		Well No. 1
Unit Letter K (Lot 3)	Section 6	Township 15N	Range 3W	County SANDOVAL
Actual Footage Location of Well: 2090 feet from the South line and 360 feet from the West line				
Ground Level Elev. 6252	Producing Formation Hospah Gallup	Pool Wildcat	Dedicated Acreage: 4057.31 Acres	

1. Outline the acreage dedicated to the subject well by colored pencil or hachure marks on the plat below.
2. If more than one lease is dedicated to the well, outline each and identify the ownership thereof (both as to working interest and royalty).
3. If more than one lease of different ownership is dedicated to the well, have the interests of all owners been consolidated by communitization, unitization, force-pooling, etc?

☐ Yes ☐ No If answer is "yes," type of consolidation _____

If answer is "no," list the owners and tract descriptions which have actually been consolidated. (Use reverse side of this form if necessary.) _____

No allowable will be assigned to the well until all interests have been consolidated (by communitization, unitization, forced-pooling, or otherwise) or until a non-standard unit, eliminating such interests, has been approved by the Commission.

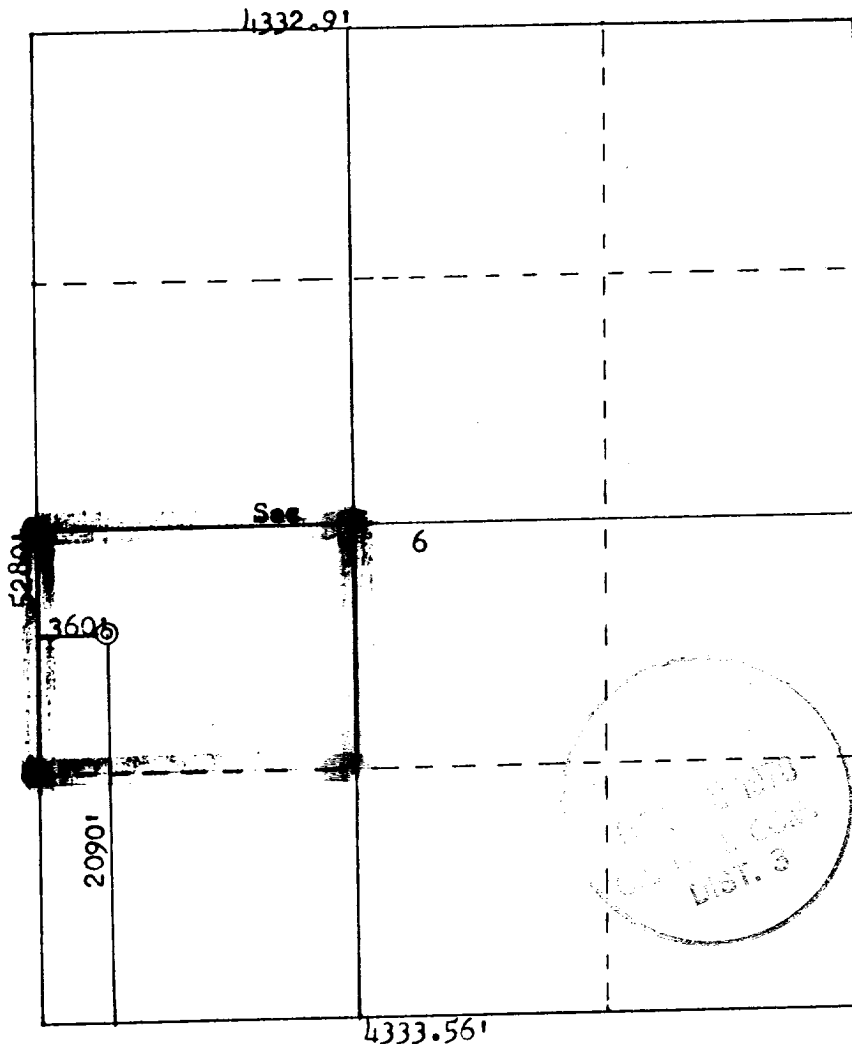

CERTIFICATION

I hereby certify that the information contained herein is true and complete to the best of my knowledge and belief.

Original Signed By:

Name **CLAUDE C. KENNEDY**
Claude C. Kennedy

Position
Agent

Company
William M. Kaiser

Date
Sept. 26, 1978

I hereby certify that the well location shown on this plat was plotted from field notes of actual surveys made by me or under my supervision, and that the same is true and correct to the best of my knowledge and belief.

Date Surveyed
September 18, 1978

Registered Professional Engineer and Land Surveyor

Fred B. Kerr Jr.

Certificate No. **3950**