

UNITED STATES
DEPARTMENT OF THE INTERIOR
GEOLOGICAL SURVEY

APPLICATION FOR PERMIT TO DRILL, DEEPEN, OR PLUG BACK

1a. TYPE OF WORK

DRILL ☒DEEPEN ☐PLUG BACK ☐

b. TYPE OF WELL

OIL
WELL ☐GAS
WELL ☒

OTHER

SINGLE
ZONE ☒MULTIPLE
ZONE ☐

2. NAME OF OPERATOR

Dome Petroleum Corp.

3. ADDRESS OF OPERATOR

501 Airport Drive, Suite 107, Farmington, NM 87401

4. LOCATION OF WELL (Report location clearly and in accordance with any State requirements.)

At surface

1190' FNL, 1450' FWL Sec. 25, 22N, R7W

At proposed prod. zone

14. DISTANCE IN MILES AND DIRECTION FROM NEAREST TOWN OR POST OFFICE*

12 miles West of Councilors Trading Post

15. DISTANCE FROM PROPOSED*

LOCATION TO NEAREST
PROPERTY OR LEASE LINE, FT.
(Also to nearest drig. unit line, if any)

16. NO. OF ACRES IN LEASE

1845.24

18. DISTANCE FROM PROPOSED LOCATION*
TO NEAREST WELL, DRILLING, COMPLETED,
OR APPLIED FOR, ON THIS LEASE, FT.

19. PROPOSED DEPTH

1900'

17. NO. OF ACRES ASSIGNED
TO THIS WELL

160

20. ROTARY OR CABLE TOOLS

Rotary

21. ELEVATIONS (Show whether DF, RT, GR, etc.)

6802 GR

22. APPROX. DATE WORK WILL START*

November 1, 1978

23.

PROPOSED CASING AND CEMENTING PROGRAM

SIZE OF HOLE	SIZE OF CASING	WEIGHT PER FOOT	SETTING DEPTH	QUANTITY OF CEMENT
9-7/8"	7"	20#	90'	50 Sacks Circ.
6-1/4"	4-1/2"	9.5# or 10.5#	1900'	By Caliper Log

Dome Petroleum Corp. proposes to drill an Upper Cretaceous test to 1900'. Completion will be determined from logs. A Series 900 (3000 psi W.P.) Blowout Preventer will be used. The BOP will be tested to 500 psi before drilling surface plug. The geologic name of the surface formation is Tertiary Nacimiento. Pertinent formation tops are estimated as Chacra 1555. Drill stem test will be taken when necessary for evaluation. No abnormal pressures or temperatures are anticipated. Drilling should require approximately 4 days.

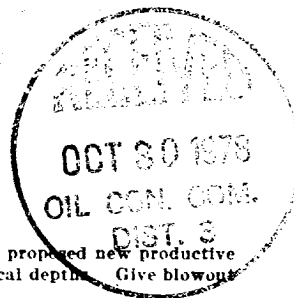
gas not dedicated

IN ABOVE SPACE DESCRIBE PROPOSED PROGRAM: If proposal is to deepen or plug back, give data on present productive zone and proposed new productive zone. If proposal is to drill or deepen directionally, give pertinent data on subsurface locations and measured and true vertical depths. Give blowout preventer program, if any.

24.

SIGNED *H. D. Hollingsworth*

TITLE Drilling Foreman

DATE 10/9/78

(This space for Federal or State office use)

PERMIT NO.

APPROVAL DATE

APPROVED BY

TITLE

CONDITIONS OF APPROVAL, IF ANY:

ok Brook

RECEIVED

OCT 27 1978

U. S. GEOLOGICAL SURVEY
DURANGO, COLO.

**NEW MEXICO OIL CONSERVATION COMMISSION
WELL LOCATION AND ACREAGE DEDICATION PLAT**

Form O-110
Supersedes O-128
Effective 1-1-65

All distances must be from the outer boundaries of the Section.

Operator DOMO PETROLEUM CORPORATION			Lease <i>Dome</i> FEDERAL 25-22-7		Well No. 22-1
Section C	Section 25	Township 22N	Range 7W	County SANDOVAL	
Actual Footage Location of Well:					
1190	feet from the	North	line and	1450	feet from the West line
Ground Level Elev. 6802	Producing Formation Cretaceous - Chacra		Pool Rusty Chacra Extension		Dedicated Acreage/ 160

1. Outline the acreage dedicated to the subject well by colored pencil or hatchure marks on the plat below.
2. If more than one lease is dedicated to the well, outline each and identify the ownership thereof (both as to working interest and royalty).
3. If more than one lease of different ownership is dedicated to the well, have the interests of all owners been consolidated by communitization, unitization, force-pooling, etc?

☐ Yes ☐ No If answer is "yes," type of consolidation _____

If answer is "no," list the owners and tract descriptions which have actually been consolidated. (Use reverse side of this form if necessary.) _____

No allowable will be assigned to the well until all interests have been consolidated (by communitization, unitization, forced-pooling, or otherwise) or until a non-standard unit, eliminating such interests, has been approved by the Commission.

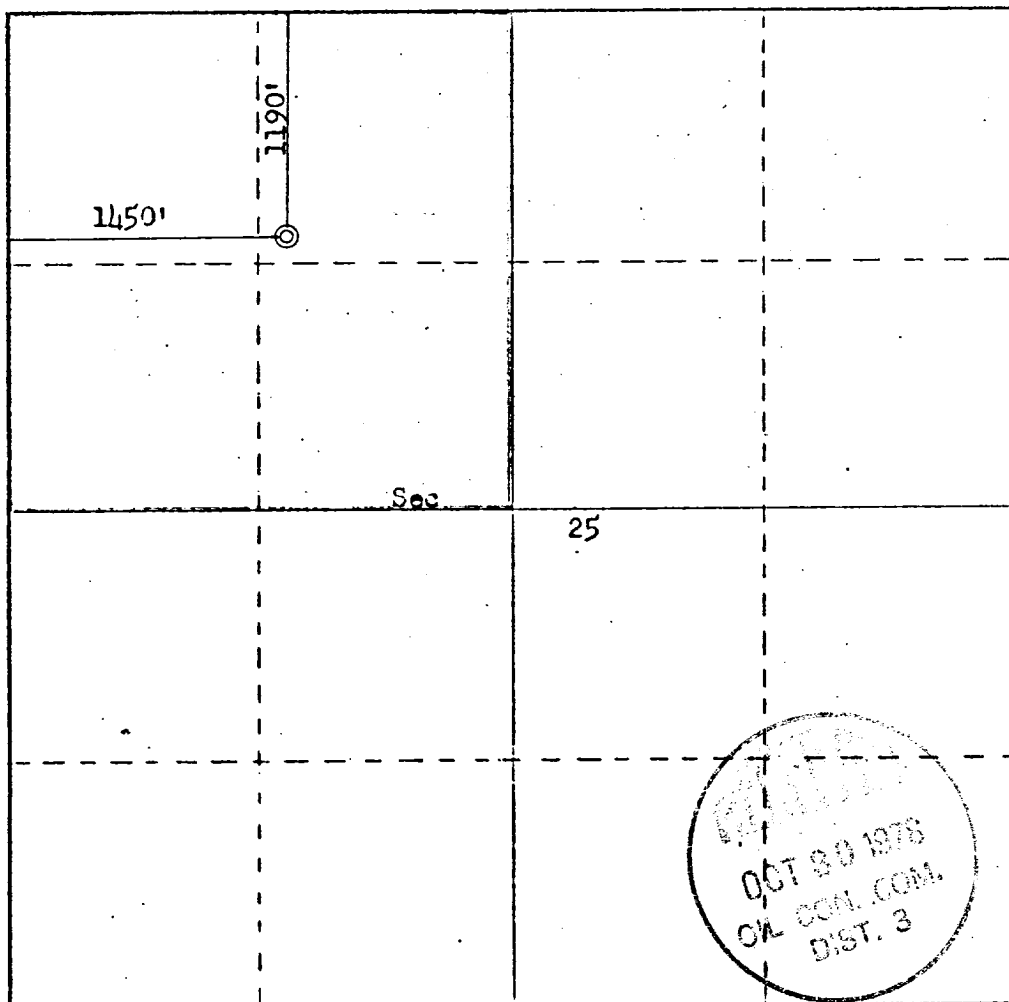

CERTIFICATION

I hereby certify that the information contained herein is true and complete to the best of my knowledge and belief.

H. D. Hollingsworth
Name

H. D. Hollingsworth

Position

Drilling Foreman

Company

Dome Petroleum Corp.

Date

October 6, 1978

I hereby certify that the well location shown on this plat was plotted from field notes of actual surveys made by me or under my supervision, and that the same is true and correct to the best of my knowledge and belief.

Date Surveyed

October 3, 1978

Registered Professional Land Surveyor

Fred B. Kerr Jr.
Fred B. Kerr Jr.

3950

