

UNITED STATES
DEPARTMENT OF THE INTERIOR
GEOLOGICAL SURVEY

APPLICATION FOR PERMIT TO DRILL, DEEPEN, OR PLUG BACK

1a. TYPE OF WORK

DRILL ☒DEEPEN ☐PLUG BACK ☐

b. TYPE OF WELL

OIL
WELL ☒GAS
WELL ☐

OTHER

SINGLE
ZONE ☐MULTIPLE
ZONE ☐

2. NAME OF OPERATOR

DAVE M. THOMAS, JR.

3. ADDRESS OF OPERATOR

P. O. Box 2026 Farmington, New Mexico 87401

4. LOCATION OF WELL (Report location clearly and in accordance with any State requirements.)*

At surface

990'FNL, 790'FWL

At proposed prod. zone Same

14. DISTANCE IN MILES AND DIRECTION FROM NEAREST TOWN OR POST OFFICE*

Not Applicable

15. DISTANCE FROM PROPOSED*
LOCATION TO NEAREST
PROPERTY OR LEASE LINE, FT.
(Also to nearest drlg. unit line, if any)

990'

16. NO. OF ACRES IN LEASE

--

17. NO. OF ACRES ASSIGNED
TO THIS WELL

160.02

18. DISTANCE FROM PROPOSED LOCATION*
TO NEAREST WELL, DRILLING, COMPLETED,
OR APPLIED FOR, ON THIS LEASE, FT.

3500'

19. PROPOSED DEPTH

7660'

20. ROTARY OR CABLE TOOLS

Rotary

21. ELEVATIONS (Show whether DF, RT, GR, etc.)

7403'GR, 7416'DF, 7417'KB

22. APPROX. DATE WORK WILL START*

7/15/79

23.

PROPOSED CASING AND CEMENTING PROGRAM

SIZE OF HOLE	SIZE OF CASING	WEIGHT PER FOOT	SETTING DEPTH	QUANTITY OF CEMENT
12-1/4"	8-5/8"	24.0	250'	250 Sacks
7-7/8"	4-1/2"	10.50 & 11.60	7660'	To be determined

It is proposed to drill this well with rotary tools, using oil base mud as circulation medium, through the Dakota Formation. Possible productive zones in the Dakota Formation will be completed. Production casing will be cemented in such a manner as to protect the Pictured Cliffs Formation.

Estimated Formation Tops

Pictured Cliffs	3056'	Green Horn	7188'
Cliff House	4606'	Graneros	7252'
Gallup	6198'	Dakota	7268'

The NW/4 Section 25 is dedicated to this well.

The natural gas produced from this well is committed

IN ABOVE SPACE DESCRIBE PROPOSED PROGRAM: If proposal is to deepen or plug back, give data on present productive zone and proposed new productive zone. If proposal is to drill or deepen directionally, give pertinent data on subsurface locations and measured and true vertical depths. Give blowout preventer program, if any.

24. FOR: DAVE M. THOMAS, JR.

President, Walsh Engin.
& Prod. Corp.

DATE 5/10/79

SIGNATURE

TITLE

DATE

Ewell N. Walsh, P.E.

(This space for Federal or State office use)

PERMIT NO.

APPROVAL DATE

APPROVED BY

TITLE

DATE

CONDITIONS OF APPROVAL, IF ANY:

*See Instructions On Reverse Side

All distances must be from the outer boundaries of the Section.

Operator DAVE M. THOMAS JR.			Lease CHACON JICARILLA APACHE "D"		Well No. 107
Unit Letter D	Section 25	Township 23N	Range 3W	County Sandoval	
Actual Footage Location of Well: 990 feet from the North line and 790 feet from the West line					
Ground Level Elev. 7403	Producing Formation Dakota		Pool Chacon Dakota Associated		Dedicated Acreage: 160.02 Acres

1. Outline the acreage dedicated to the subject well by colored pencil or hatchure marks on the plat below.
2. If more than one lease is dedicated to the well, outline each and identify the ownership thereof (both as to working interest and royalty).
3. If more than one lease of different ownership is dedicated to the well, have the interests of all owners been consolidated by communitization, unitization, force-pooling, etc?

☐ Yes ☐ No If answer is "yes;" type of consolidation _____

If answer is "no," list the owners and tract descriptions which have actually been consolidated. (Use reverse side of this form if necessary.) _____

No allowable will be assigned to the well until all interests have been consolidated (by communitization, unitization, forced-pooling, or otherwise) or until a non-standard unit, eliminating such interests, has been approved by the Commission.

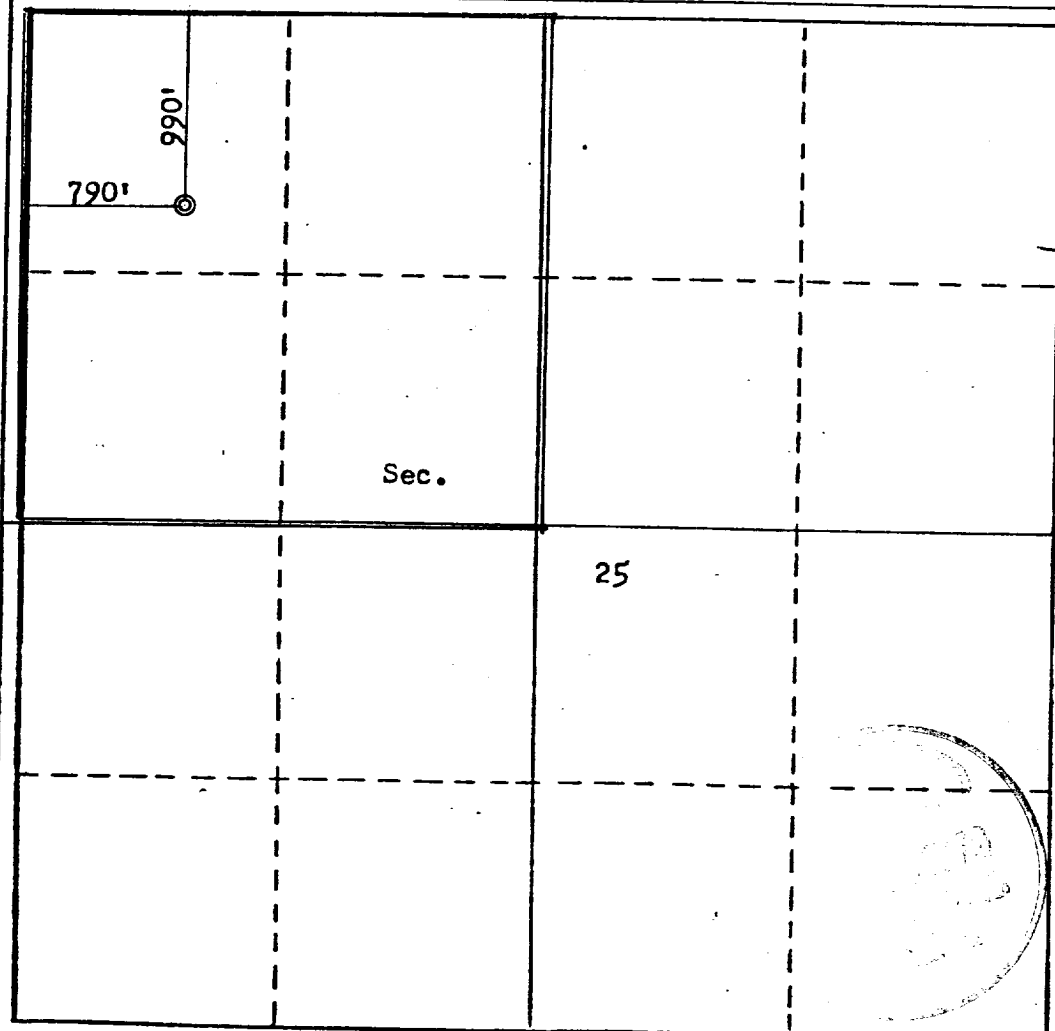

CERTIFICATION

I hereby certify that the information contained herein is true and complete to the best of my knowledge and belief.

FOR: **DAVE M. THOMAS JR.**

Name
Ewell N. Walsh, P.E.

Position

President

Company

Walsh Engineering & Prod. Corp.

Date

5/10/79

I hereby certify that the well location shown on this plat was plotted from field notes of actual surveys made by me or under my supervision, and that the same is true and correct to the best of my knowledge and belief.

Date Surveyed

May 8, 1979

Registered Professional Engineer and/or Lead Surveyor

Fred B. Kerr Jr.

Certificate No. **3950**
FRED B. KERR JR.

